

NO. OF COPIES RECEIVED	2
DISTRIBUTION	
SANTA FE	1
FILE	1
U.S.G.S.	
LAND OFFICE	
OPERATOR	1

NEW MEXICO OIL CONSERVATION COMMISSION

JAN 27 1982

O. C. D.  
ARTS & SCIENCES

Form O-101  
Revised 10-75

5A. Indicate Type of Land	STATE <input type="checkbox"/>	FED <input checked="" type="checkbox"/>
5. Time Est. & Area Designated		

## APPLICATION FOR PERMIT TO DRILL, DEEPEN, OR PLUG BACK

1a. Type of Work DRILL <input checked="" type="checkbox"/> DEEPEN <input type="checkbox"/> PLUG BACK <input type="checkbox"/>		7. Unit Agreement Name
b. Type of Well OIL WELL <input type="checkbox"/> GAS WELL <input type="checkbox"/> STRATIGRAPHIC TEST HOLE <input type="checkbox"/> SINGLE ZONE <input type="checkbox"/> MULTIPLE ZONE <input type="checkbox"/>		8. Farm or Lease Name Cibola
c. Name of Operator Cibola Energy Corporation		9. Well No. 30-0
d. Address of Operator P.O. Box 1668, Albuquerque, New Mexico 87103		10. Field and Sect. of Interest N/A
e. Location of Well UNIT LETTER 0 LOCATED 1980 FEET FROM THE East LINE AND 660 FEET FROM THE South LINE OF SEC. 28 TWP. 10S RGE. 28E NMDM		11. County Chaves
19. Proposed Depth		19A. Formation
20. Rotary or C.T.		Rotary
21A. Kind & Status Plug. Bond Statewide	21B. Drilling Contractor Harry Bevers	22. Approx. Date Work will start 1-27-82

23.

## PROPOSED CASING AND CEMENT PROGRAM

SIZE OF HOLE	SIZE OF CASING	WEIGHT PER FOOT	SETTING DEPTH	SACKS OF CEMENT	EST. TOP
4 1/2"	N/A	N/A	N/A	N/A	N/A

We plan to drill a 4 1/2" hole 20' into Yates formation. A Gamma Ray log will be run to determine the top of the Yates. A suitable cement plug will be pumped into the hole to plug from TD to the top of the water zone. Location will be cleaned and marker set.

THIS IS A STRATIGRAPHIC  
EXPLORATION ONLY  
NO PRODUCTION WILL BE  
PRODUCED

IN ABOVE SPACE DESCRIBE PROPOSED PROGRAM: IF PROPOSAL IS TO DEEPEN OR PLUG BACK, GIVE DATA ON PRESENT PRODUCTIVE ZONE AND PROPOSED NEW PRODUCTIVE ZONE. GIVE BLOWOUT PREVENTER PROGRAM, IF ANY.

I hereby certify that the information above is true and complete to the best of my knowledge and belief.

Signed Artha Wigil Title Drilling Secretary Date 1-25-82

(This space for State Use)

APPROVED BY Mike Williams TITLE OIL AND GAS INSPECTOR DATE JAN 29 1982

CONDITIONS OF APPROVAL, IF ANY:

NEW MEXICO OIL CONSERVATION COMMISSION  
WELL LOCATION AND ACREAGE DEDICATION PLAT

Form C-102  
Supersedes C-128  
Effective 1-1-65

All distances must be from the outer boundaries of the Section.

Operator <b>Cibola Energy</b>			Lease <b>Cibola Start Test</b>		Well No. <b>Cibola Start 30-0</b>
Unit Letter <b>0</b>	Section <b>28</b>	Township <b>10 South</b>	Range <b>28 East</b>	County <b>Chaves</b>	
Actual Footage Location of Well:					
<b>1980.0'</b> feet from the <b>east</b> line and		<b>660.0</b> feet from the <b>south</b> line			
Ground Level Elev. <b>3772.0</b>	Producing Formation		Feet	Dedicated Acreage	

1. Outline the acreage dedicated to the subject well by colored pencil or hatchure marks on the plat below.
2. If more than one lease is dedicated to the well, outline each and identify the ownership thereof (both as to working interest and royalty).
3. If more than one lease of different ownership is dedicated to the well, have the interests of all owners been consolidated by communitization, unitization, force-pooling, etc?

☐ Yes ☐ No If answer is "yes," type of consolidation \_\_\_\_\_

If answer is "no," list the owners and tract descriptions which have actually been consolidated. (Use reverse side of this form if necessary.) \_\_\_\_\_

No allowable will be assigned to the well until all interests have been consolidated (by communitization, unitization, forced-pooling, or otherwise) or until a non-standard unit, eliminating such interests, has been approved by the Commission.

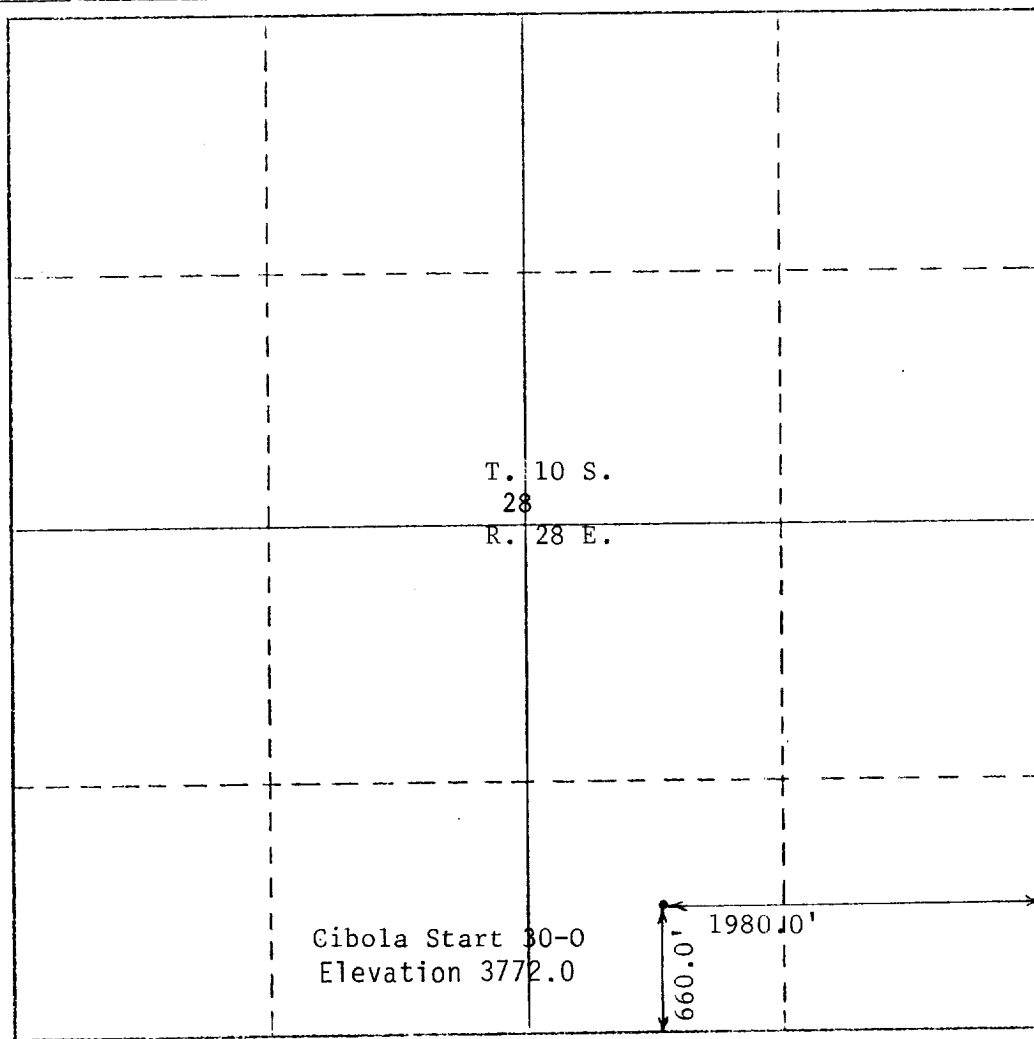

CERTIFICATION

I hereby certify that the information contained herein is true and complete to the best of my knowledge and belief.

Name

**R. B. Wright**

Position

**Agent**

Company

**Cibola Energy Corp.**

Date

**2/1/82**

I hereby certify that the well location shown on this plat was plotted from field notes of actual surveys made by me or under my supervision, and that the same is true and correct to the best of my knowledge and belief.

**2/1/82**

Date Surveyed

Registered Professional Engineer and/or Land Surveyor

**Richard B. Wright**

Certificate No.

**7929**

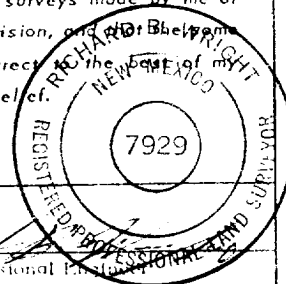

0 330 660 990 1320 1650 1980 2310 2640 2970 3300 3630 3960 4290 4620 4950 5280 5610 5940 6270 6600

NEW MEXICO OIL CONSERVATION COMMISSION  
WELL LOCATION AND ACREAGE DEDICATION PLAT

Form C-102  
Supersedes C-128  
Effective 1-1-65

All distances must be from the outer boundaries of the Section.

Lessor <b>Cibola Energy</b>			Lease <b>Cibola Start Test</b>			Well No. <b>Start 30-0</b>
Section <b>0</b>	Section <b>28</b>	Township <b>10 South</b>	Range <b>28 East</b>	County <b>Chaves</b>		
Total Tract Location of well: <b>1980.0'</b> feet from the <b>East</b> line and <b>660.0</b> feet from the <b>South</b> line <b>3772.0</b> Elevation						

FEB 11 1982

O. C. D.  
ARTESIA OFFICE

- Outline the acreage dedicated to the subject well by colored pencil or hatchure marks on the plat below.
- If more than one lease is dedicated to the well, outline each and identify the ownership thereof (both as to working interest and royalty).
- If more than one lease of different ownership is dedicated to the well, have the interests of all owners been consolidated by communitization, unitization, force-pooling, etc?

☐ Yes ☐ No If answer is "yes" type of consolidation \_\_\_\_\_

If answer is "no" list the owners and tract descriptions which have actually been consolidated. (Use reverse side of this form if necessary.) \_\_\_\_\_

No allowable will be assigned to the well until all interests have been consolidated (by communitization, unitization, forced-pooling, or otherwise) or until a non-standard unit, eliminating such interests, has been approved by the Commission.

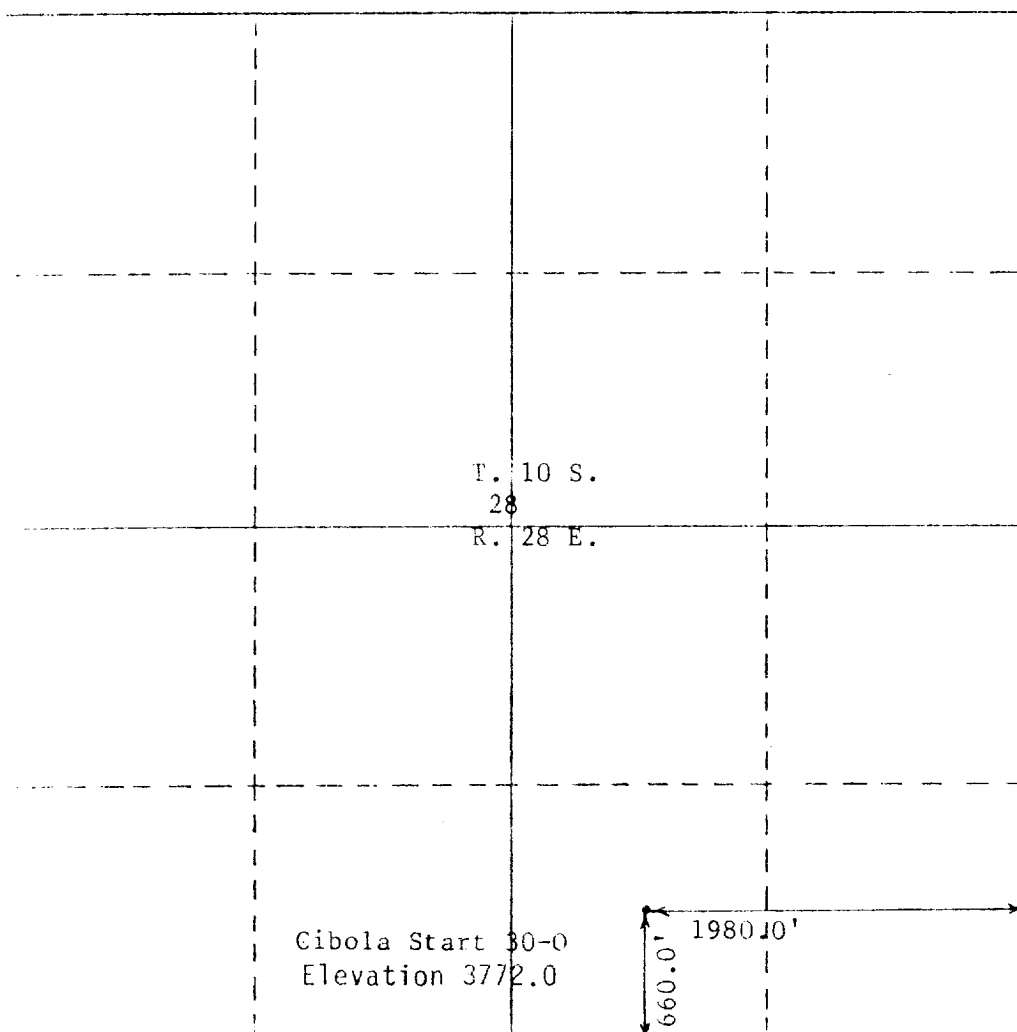

CERTIFICATION

I hereby certify that the information contained herein is true and complete to the best of my knowledge and belief.

Name  
**R. B. Wright**

Position  
**Agent**

Company  
**Cibola Energy Corp.**

Date  
**2/1/82**

I hereby certify that the well location shown on this plat was plotted from field notes of actual surveys made by me or under my supervision, and that the location is true and correct to the best of my knowledge and belief.

Date Surveyed  
**2/1/82**

Registered Professional Engineer and/or Land Surveyor

**Richard B. Wright**

Certificate No.  
**7929**

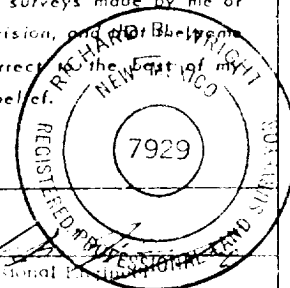

NEW MEXICO OIL CONSERVATION COMMISSION  
WELL LOCATION AND ACREAGE DEDICATION PLAT

Form C-192  
Supersedes C-128  
Effective 1-1-65

All distances must be from the outer boundaries of the Section.

Owner <b>Cibola Energy</b>			Lease <b>Cibola Start Test</b>			Well No. <b>Start 30-0</b>		
Section <b>0</b>	Section <b>28</b>	Township <b>10 South</b>	Range <b>28 East</b>	County <b>Chaves</b>				
Well Location of Well:								
1980.0' feet from the east line and			660.0' feet from the south line			Elevation <b>3772.0</b>		
Dedicated Acreage								

- Outline the acreage dedicated to the subject well by colored pencil or hatchure marks on the plat below.
- If more than one lease is dedicated to the well, outline each and identify the ownership thereof (both as to working interest and royalty).
- If more than one lease of different ownership is dedicated to the well, have the interests of all owners been consolidated by communitization, unitization, force-pooling, etc?

☐ Yes ☐ No If answer is "yes" type of consolidation \_\_\_\_\_

If answer is "no," list the owners and tract descriptions which have actually been consolidated. (Use reverse side of this form if necessary.) \_\_\_\_\_

No allowable will be assigned to the well until all interests have been consolidated (by communitization, unitization, forced-pooling, or otherwise) or until a non-standard unit, eliminating such interests, has been approved by the Commission.

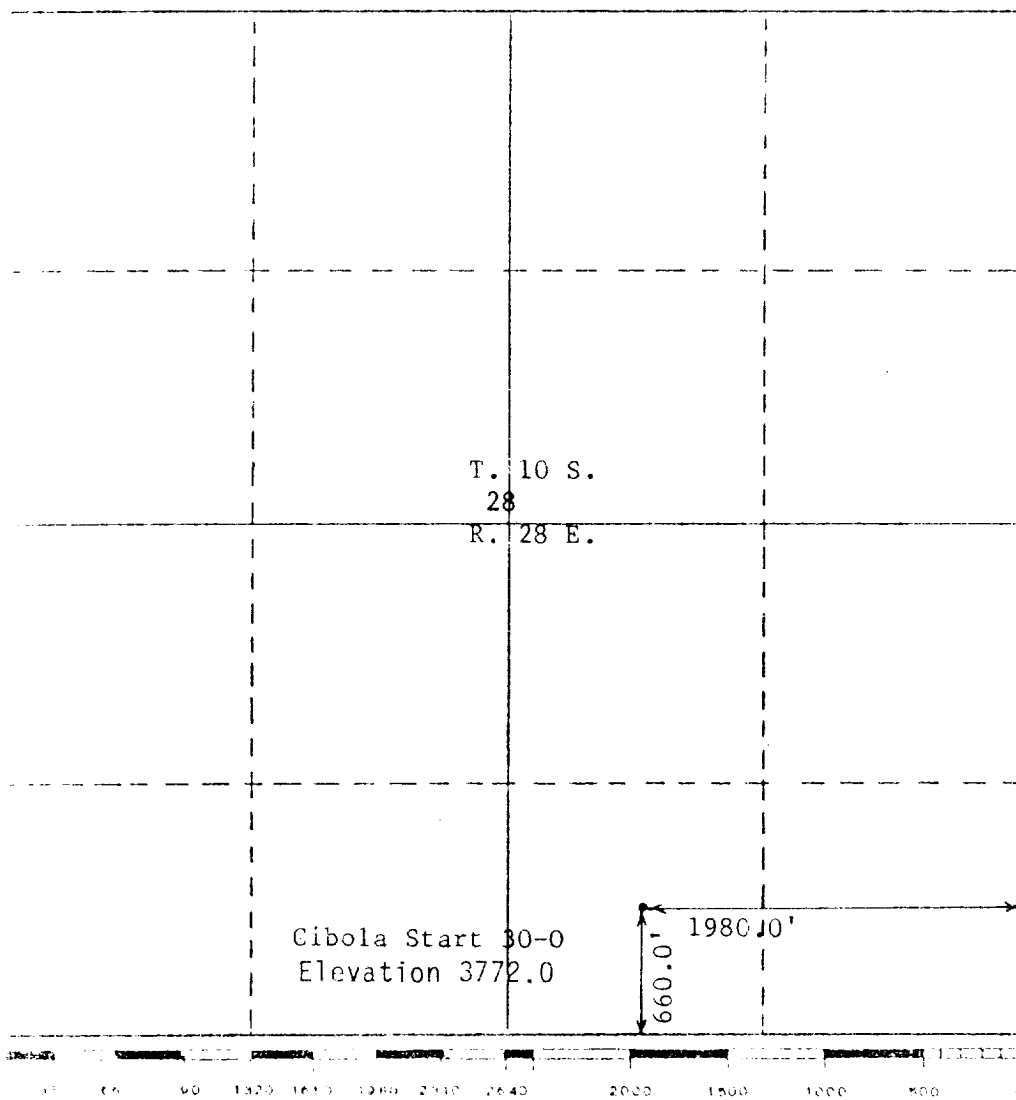

CERTIFICATION

I hereby certify that the information contained herein is true and complete to the best of my knowledge and belief.

Name  
**R. B. Wright**

Position  
**Agent**

Company  
**Cibola Energy Corp.**

Date  
**2/1/82**

I hereby certify that the well location shown on this plat was plotted from field notes of actual surveys made by me or under my supervision, and the location is true and correct to the best of my knowledge and belief.

Date Surveyed  
**2/1/82**

Registered Professional Engineer and/or Land Surveyor

**Richard B. Wright**

Certificate No.  
**7929**

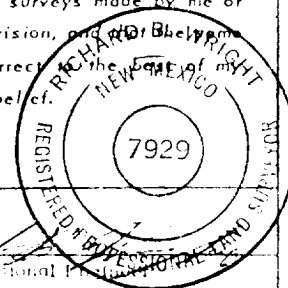

NEW MEXICO OIL CONSERVATION COMMISSION  
WELL LOCATION AND ACREAGE DEDICATION PLAT

Form C-102  
Supersedes C-128  
Effective 1-1-65

All distances must be from the outer boundaries of the Section.

Operator <b>Cibola Energy</b>			Lease <b>Cibola Start Test</b>		Well No. <b>Cibola Start 30-0</b>
Section <b>0</b>	Section <b>28</b>	Township <b>10 South</b>	Range <b>28 East</b>	County <b>Chaves</b>	
Section 10 North of Well:					
1980.0' feet from the <b>east</b> line and		660.0' feet from the <b>south</b> line		Dedicated Acreage	
3772.0'		Feet			

- Outline the acreage dedicated to the subject well by colored pencil or machine marks on the plat below.
- If more than one lease is dedicated to the well, outline each and identify the ownership thereof (both as to working interest and royalty).
- If more than one lease of different ownership is dedicated to the well, have the interests of all owners been consolidated by communitization, unitization, force-pooling, etc?

☒ Yes ☐ No If answer is "yes" type of consolidation \_\_\_\_\_

If answer is "no," list the owners and tract descriptions which have actually been consolidated. (Use reverse side of this form if necessary.) \_\_\_\_\_

No allowable will be assigned to the well until all interests have been consolidated (by communitization, unitization, force-pooling, or otherwise) or until a non-standard unit, eliminating such interests, has been approved by the Commission.

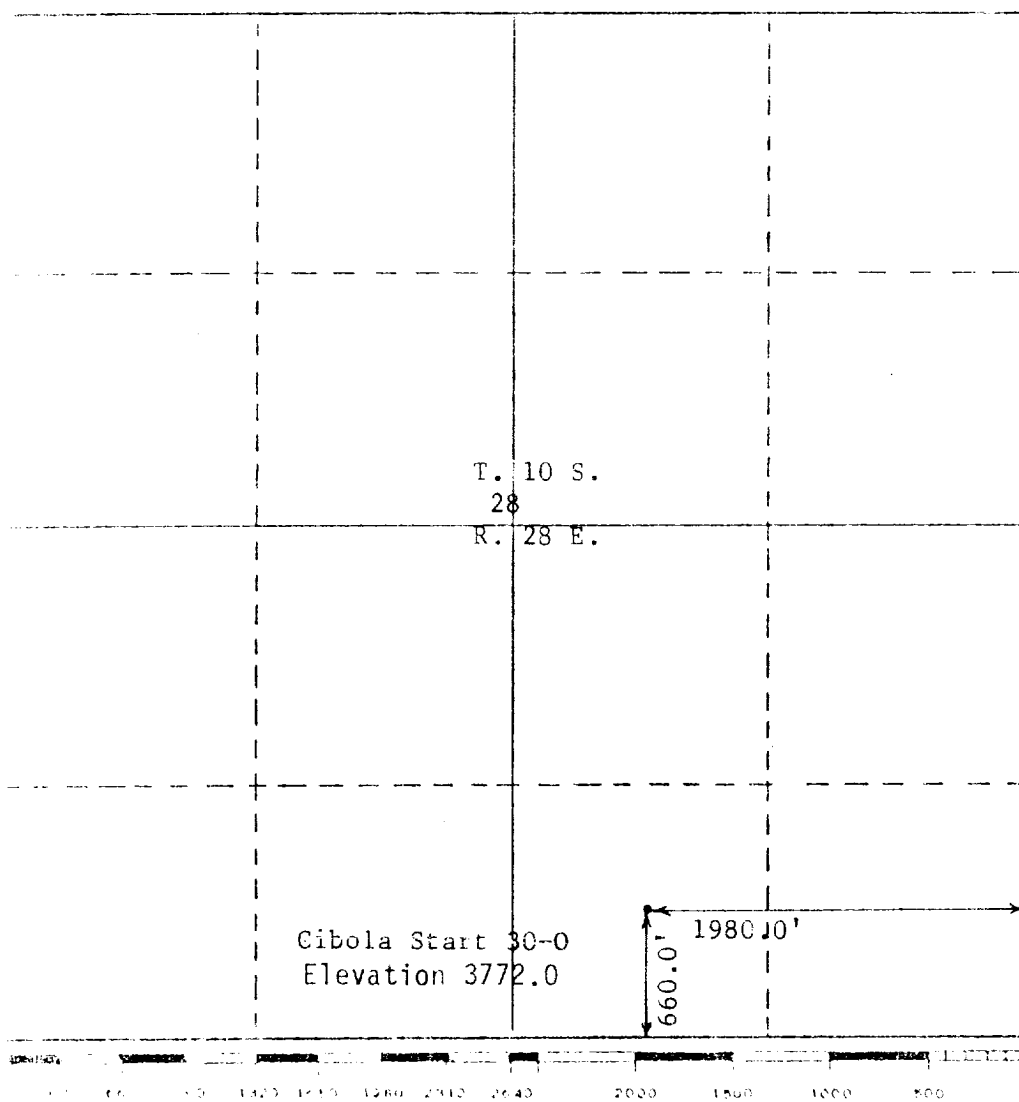

CERTIFICATION

I hereby certify that the information contained herein is true and complete to the best of my knowledge and belief.

Name  
**R. B. Wright**

Position  
**Agent**

Company  
**Cibola Energy Corp.**

Date  
**2/1/82**

I hereby certify that the well location shown on this plat was plotted from field notes of actual surveys made by me or under my supervision, and the same is true and correct to the best of my knowledge and belief.

Date Surveyed  
**2/1/82**

Registered Professional Engineer and/or Land Surveyor

**Richard B. Wright**

Certification No.  
**7929**

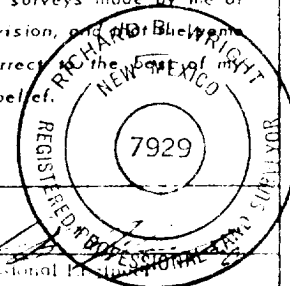

NEW MEXICO OIL CONSERVATION COMMISSION  
WELL LOCATION AND ACREAGE DEDICATION LAT

Form C-102  
Supersedes C-128  
Effective 1-1-65

All distances must be from the outer boundaries of the Section

Owner <b>Cibola Energy</b>		Lease <b>Cibola Start Test</b>		Well No. <b>Cibola Start 30-0</b>
Section <b>0</b>	Section <b>28</b>	Township <b>10 South</b>	Range <b>28 East</b>	County <b>Chaves</b>
1980.0' feet from the <b>east</b> line and 660.0 feet from the <b>south</b> line Elevation 3772.0 Dedicated to <b>O.C.D.</b> <b>ARTESIA OFFICE</b>				

FEB 1 1982

1. Outline the acreage dedicated to the subject well by colored pencil or hatchure marks on the plat below.
2. If more than one lease is dedicated to the well, outline each and identify the ownership thereof (both as to working interest and royalty).
3. If more than one lease of different ownership is dedicated to the well, have the interests of all owners been consolidated by communitization, unitization, force-pooling, etc?

☐ Yes ☐ No If answer is "yes," type of consolidation \_\_\_\_\_

If answer is "no," list the owners and tract descriptions which have actually been consolidated. (Use reverse side of this form if necessary.) \_\_\_\_\_

No allowance will be assigned to the well until all interests have been consolidated (by communitization, unitization, force-pooling, or otherwise) or until a non-standard unit, eliminating such interests, has been approved by the Commission.

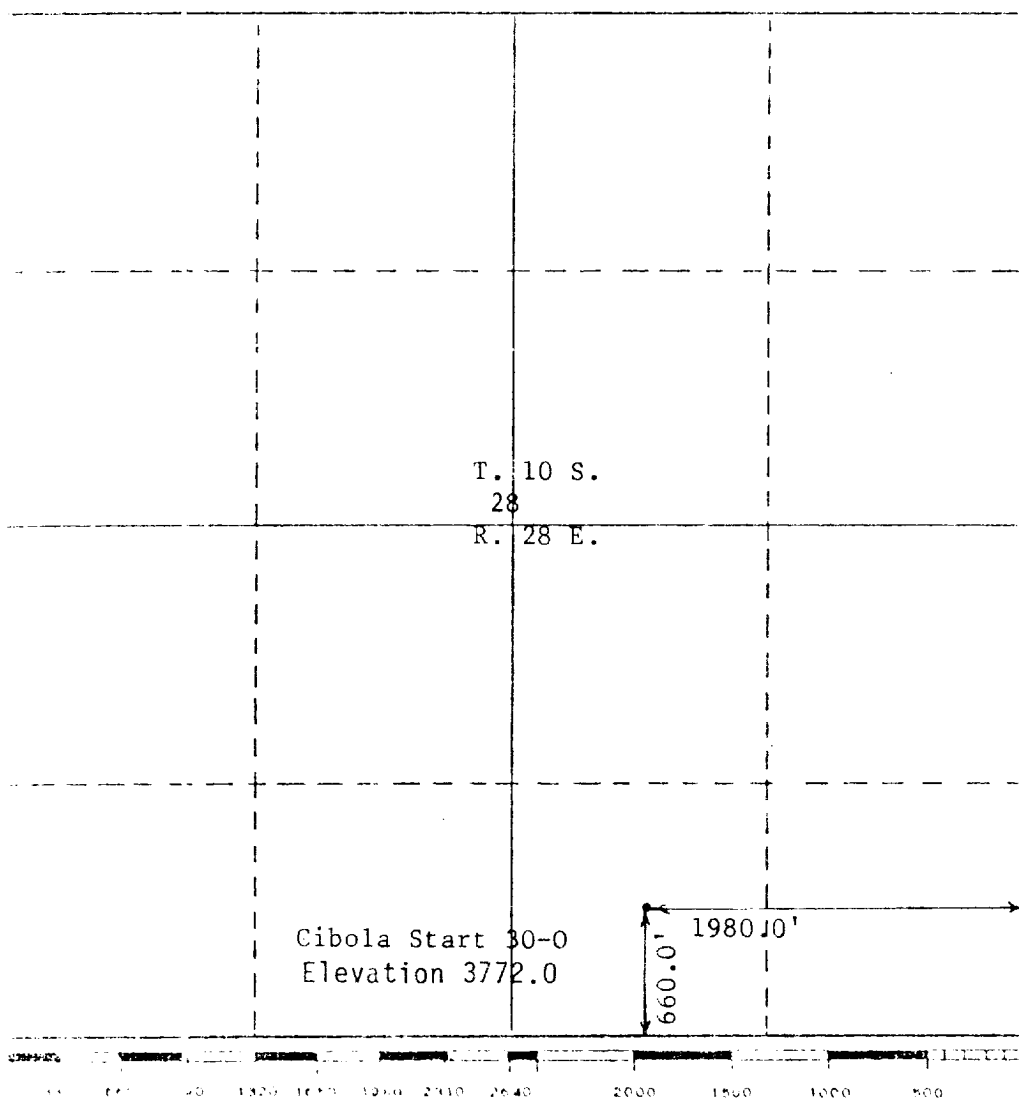

CERTIFICATION

I hereby certify that the information contained herein is true and complete to the best of my knowledge and belief.

Name  
**R. B. Wright**

Position  
**Agent**

Company  
**Cibola Energy Corp.**

Date  
**2/1/82**

I hereby certify that the well location shown on this plat was plotted from field notes of actual surveys made by me or under my supervision, and the location is true and correct to the best of my knowledge and belief.

Date Surveyed  
**2/1/82**

Registered Professional Engineer and/or Land Surveyor

**Richard B. Wright**

Certificate No.  
**7929**

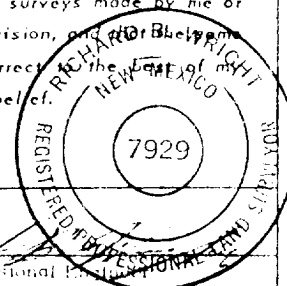

NEW MEXICO OIL CONSERVATION COMMISSION  
WELL LOCATION AND ACREAGE DEDICATION PLAT

Form C-107  
Supersedes C-128  
Effective 1-1-65

All distances must be from the outer boundaries of the Section

Owner <b>Cibola Energy</b>			Lease <b>Cibola Start Test</b>			Well No. <b>Start 30-0</b>		
Section <b>0</b>	Section <b>28</b>	Township <b>10 South</b>	Range <b>28 East</b>	County <b>Chaves</b>		Elev. <b>3772.0</b>		
Type Location of Well:								
1980.0' feet from the <b>east</b> line and			660.0' feet from the <b>south</b> line			Elev. <b>3772.0</b>		

- Outline the acreage dedicated to the subject well by colored pencil or hatchure marks on the plat below.
- If more than one lease is dedicated to the well, outline each and identify the ownership thereof (both as to working interest and royalty).
- If more than one lease of different ownership is dedicated to the well, have the interests of all owners been consolidated by communitization, unitization, force-pooling, etc?

☐ Yes ☐ No If answer is "yes," type of consolidation \_\_\_\_\_

If answer is "no," list the owners and tract descriptions which have actually been consolidated. (Use reverse side of this form if necessary.) \_\_\_\_\_

No allowance will be assigned to the well until all interests have been consolidated (by communitization, unitization, force-pooling, or otherwise) or until a non-standard unit, eliminating such interests, has been approved by the Commission.

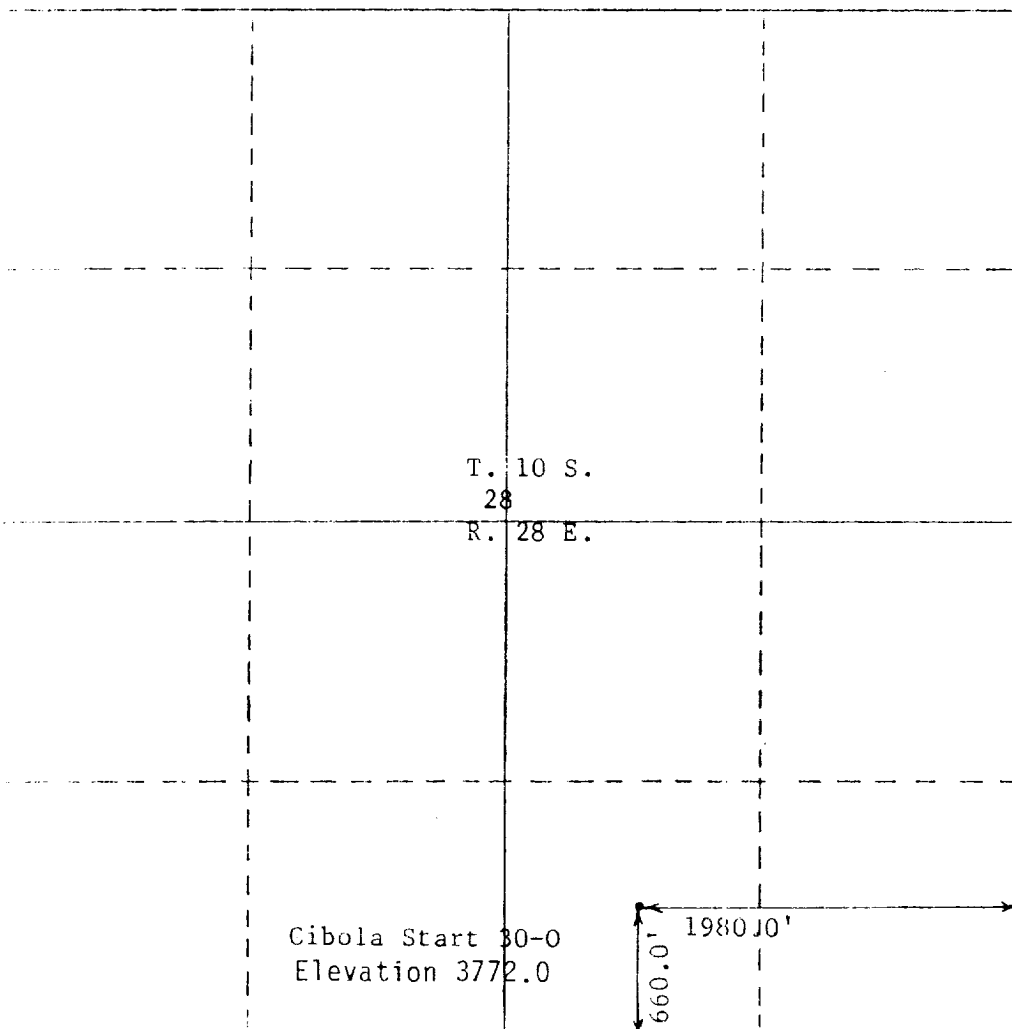

CERTIFICATION

I hereby certify that the information contained herein is true and complete to the best of my knowledge and belief.

Name **R. B. Wright**  
Position **Agent**  
Company **Cibola Energy Corp.**  
Date **2/1/82**

I hereby certify that the well location shown on this plat was plotted from field notes of actual surveys made by me or under my supervision, and the same is true and correct to the best of my knowledge and belief.

**2/1/82**

Date Surveyed

Registered Professional Engineer and/or Land Surveyor

**Richard B. Wright**

Certificate No.

**7929**

