

NO. OF COPIES RECEIVED	5
DISTRIBUTION	
SANTA FE	/
FILE	/
U.S.G.S.	2
LAND OFFICE	
OPERATOR	/

NEW MEXICO OIL CONSERVATION COMMISSION  
RECEIVED

JUL 6 1977

Form C-101  
Revised 1-4-65

5A. Indicate Type of Lease  
STATE ☐ FEE ☒  
5. State Oil & Gas Lease No.

APPLICATION FOR PERMIT TO DRILL, DEEPEN, OR PLUG BACK

1a. Type of Work b. Type of Well OIL WELL <input type="checkbox"/> GAS WELL <input checked="" type="checkbox"/> OTHER <input type="checkbox"/> DRILL <input checked="" type="checkbox"/> DEEPEN <input type="checkbox"/> PLUG BACK <input type="checkbox"/> SINGLE ZONE <input type="checkbox"/> MULTIPLE ZONE <input type="checkbox"/>		7. Unit Agreement Name
2. Name of Operator Texas Oil & Gas Corp.		8. Farm or Lease Name O'Brien "D"
3. Address of Operator 900 Wilco Bldg., Midland, Texas 79701		9. Well No. 1
4. Location of Well UNIT LETTER I LOCATED 660 FEET FROM THE East LINE AND 1980 FEET FROM THE South LINE OF SEC. 10 TWP. 9 S RGE. 29E NMPM		10. Field and Pool, or Wildcat Undesignated Strawn
		12. County Chaves
19. Proposed Depth 9600		19A. Formation Strawn
20. Rotary or C.T. Rotary		
21. Elevations (Show whether DF, RT, etc.) Unknown	21A. Kind & Status Plug. Bond Statewide	21B. Drilling Contractor Warton
		22. Approx. Date Work will start 7-15-1977

23. PROPOSED CASING AND CEMENT PROGRAM

SIZE OF HOLE	SIZE OF CASING	WEIGHT PER FOOT	SETTING DEPTH	SACKS OF CEMENT	EST. TOP
17 1/2	12 3/4	40	300'	300	Surface
11	8 5/8	24	2600'	300	2,000'
7 7/8	5 1/2	15.5 & 17	9600'	As calipers indicate	

DRILLING PROCEDURE

1. Drill 17 1/2" hole to 300' and set 12 3/4" casing. Install BOP.
2. Drill out with fresh water to 2600'. (Top San Andres). Water will become saturated through salt section at 900'.
3. Set 8 5/8" casing.
4. Drill out with fresh water to 6000' (Top Abo). Add brine water to bring chlorides to 100,000 PPM, 9.0 PPG. If test in San Andres, sweep hole with flosal.
5. Drill to 7000' add starch and gel before Woodford for 35-38 viscosity, 20 or less water loss.
6. Drill to TD 9600'.
7. DST as required.
8. Run open hole logs.
9. Run 5 1/2" casing for completion through perforations.  
Gas is not dedicated.

APPROVAL VALID  
FOR 90 DAYS UNLESS  
DRILLING COMMENCED,

EXP. RES. 10-13-77

IN ABOVE SPACE DESCRIBE PROPOSED PROGRAM: IF PROPOSAL IS TO DEEPEN OR PLUG BACK, GIVE DATA ON PRESENT PRODUCTIVE ZONE AND PROPOSED NEW PRODUCTIVE ZONE. GIVE BLOWOUT PREVENTER PROGRAM, IF ANY.

I hereby certify that the information above is true and complete to the best of my knowledge and belief.

Signed J.R. Colter Title Staff Engineer Date 7-1-1977

(This space for State Use)

APPROVED BY Libert M. Morris TITLE OIL AND GAS INSPECTOR

DATE JUL 13 1977

CONDITIONS OF APPROVAL, IF ANY:

Minimum 300' to 1980' D.A. & P.L. 12-1-77

RECEIVED

JUL 1 1977

OIL CONSERVATION

HOURS: 8 A.M. - 5 P.M.

**N MEXICO OIL CONSERVATION COMMISS**  
**WELL LOCATION AND ACREAGE DEDICATION PLAT**

Form O-128  
 Supersedes O-128  
 Effective 4-1-68

All distances must be from the outer boundaries of the Section

Operator <b>Texas Oil &amp; Gas Corp.</b>			Lease <b>O'Brien D</b>		Well No. <b>1</b>
Section <b>10</b>	Township <b>9 South</b>	Range <b>29 East</b>	County <b>Chaves</b>		
Average Well Location of Well: <b>660</b> feet from the <b>East</b> line and <b>1980</b> feet from the <b>South</b> line					
Ground Level Elev. <b>3945.3</b>	Producing Formation <b>Strawn</b>	Pool <b>Undesignated</b>	Dedicated Acreage <b>320</b>		

1. Outline the acreage dedicated to the subject well by colored pencil or hatchure marks on the plat below.
2. If more than one lease is dedicated to the well, outline each and identify the ownership thereof (both as to working interest and royalty).
3. If more than one lease of different ownership is dedicated to the well, have the interests of all owners been consolidated by communitization, unitization, force-pooling, etc?

☐ Yes ☐ No If answer is "yes," type of consolidation \_\_\_\_\_

If answer is "no," list the owners and tract descriptions which have actually been consolidated. (Use reverse side of this form if necessary.) \_\_\_\_\_

No allowable will be assigned to the well until all interests have been consolidated (by communitization, unitization, forced-pooling, or otherwise) or until a non-standard unit, eliminating such interests, has been approved by the Commission.

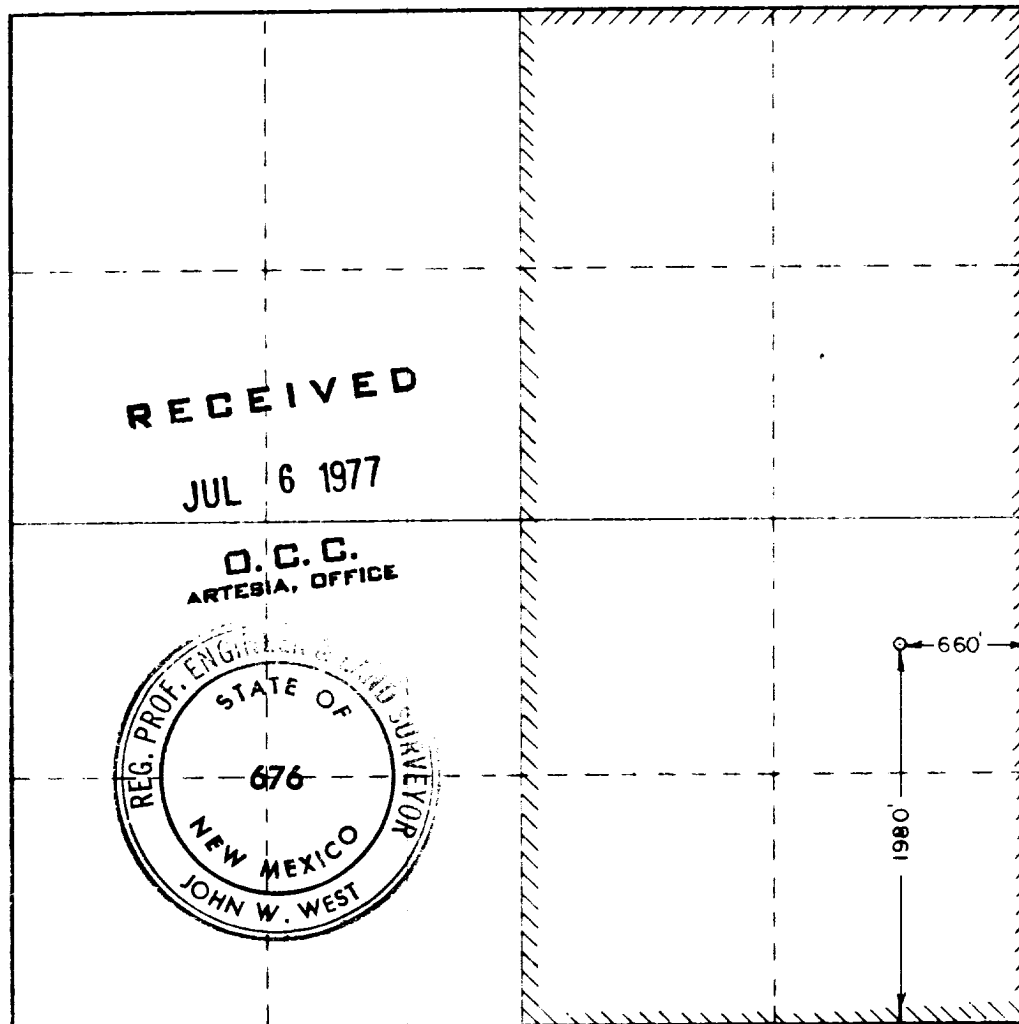

**CERTIFICATION**

I hereby certify that the information contained herein is true and complete to the best of my knowledge and belief

*John W. West*  
 Name **Agent**

Position  
**Texas Oil & Gas Corp.**

Company  
**7-2-77**

Date

I hereby certify that the well location shown on this plat was plotted from field notes of actual surveys made by me or under my supervision, and that the same is true and correct to the best of my knowledge and belief.

**6-30-77**

Date Surveyed

Registered Professional Engineer and/or Land Surveyor

*John W. West*  
 Certificate No **676**



RECEIVED

JUL 13 1977

O. C. C.  
ARTESIA, OFFICE

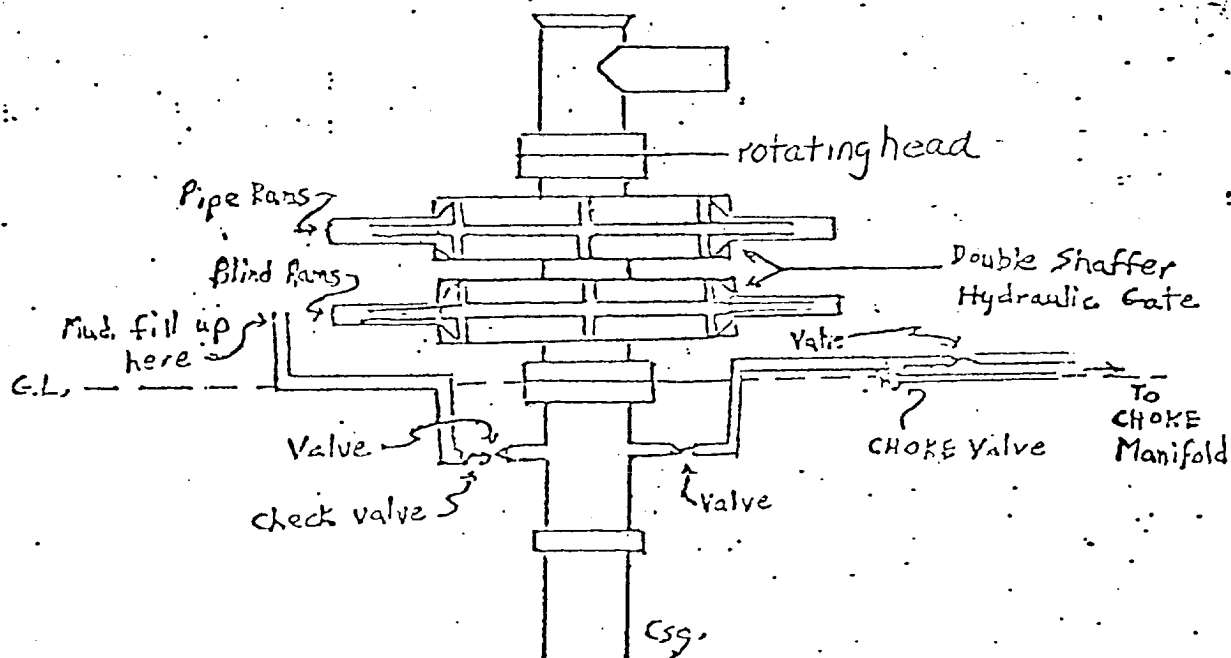
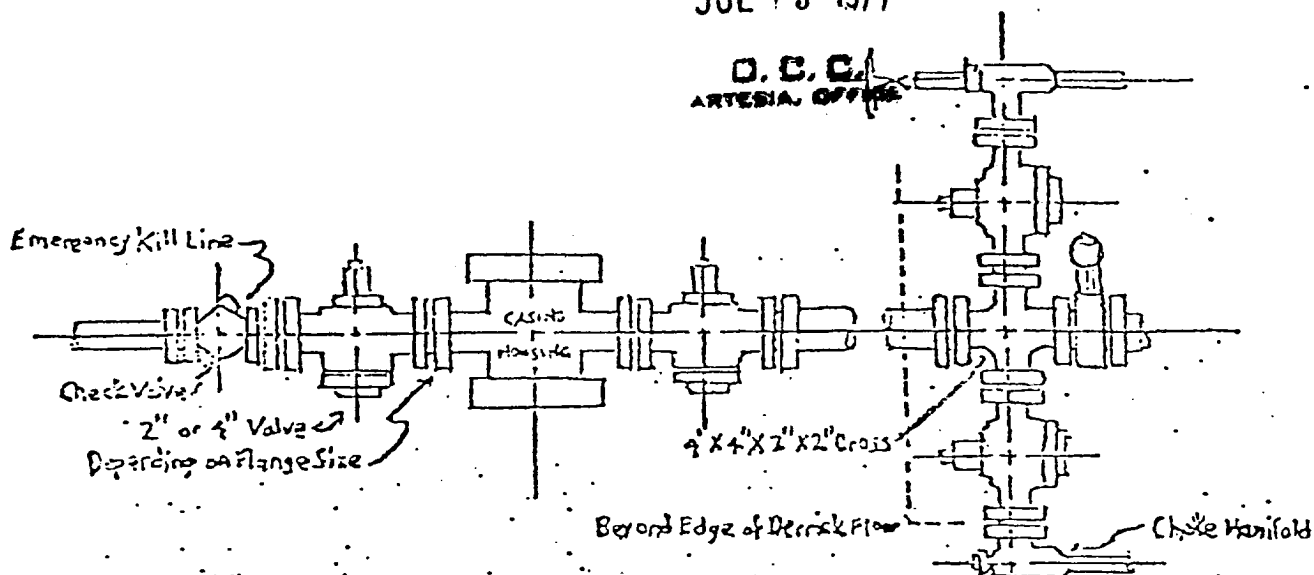

BLOWOUT PREVENTOR - 10" - 3000 SERIES  
TEXAS OIL & GAS CORP.

O'Brien "D" Lease

I 660' FEL & 1980' FSL, Sec. 10, Twp 9S 29E, Chaves County

Heads & preventor equipment will all be 3000# WP.