

NO. OF COPIES RECEIVED	
DISTRIBUTION	
SANTA FE	1
FILE	1
U.S.G.S.	1
LAND OFFICE	
OPERATOR	1

NEW MEXICO OIL CONSERVATION COMMISSION
RECEIVED

APR 21 1980

O. C. D.

30-005-60706

Form C-101
Revised 1-1-65

5A. Indicate Type of Lease
STATE ☐ FEE ☒

5. State Oil & Gas Lease No.

APPLICATION FOR PERMIT TO DRILL, DEEPEN, OR PLUG BACK

1a. Type of Work DRILL <input checked="" type="checkbox"/> DEEPEN <input type="checkbox"/> PLUG BACK <input type="checkbox"/>		7. Unit Agreement Name
b. Type of Well OIL WELL <input checked="" type="checkbox"/> GAS WELL <input type="checkbox"/> OTHER <input type="checkbox"/> SINGLE ZONE <input type="checkbox"/> MULTIPLE ZONE <input type="checkbox"/>		8. Farm or Lease Name Pinkie
2. Name of Operator Ralph Nix		9. Well No. 2
3. Address of Operator P. O. Box 617, Artesia, New Mexico 88210		10. Field and Pool, or Wildcat Full 15 Eye San Andres
4. Location of Well UNIT LETTER G LOCATED 1650 FEET FROM THE North LINE AND 1650 FEET FROM THE East LINE OF SEC. 12 TWP. 8-S RGE. 28-E NMPM		12. County Chaves
19. Proposed Depth 2800'		19A. Formation San Andres
20. Rotary or C.T. Rotary		21. Elevations (Show whether DF, RT, etc.) 4086' GL
21A. Kind & Status Plug. Bond Blanket		21B. Drilling Contractor LaRue Drilling
22. Approx. Date Work will start As soon as approved		

23. PROPOSED CASING AND CEMENT PROGRAM

SIZE OF HOLE	SIZE OF CASING	WEIGHT PER FOOT	SETTING DEPTH	SACKS OF CEMENT	EST. TOP
12 1/4"	8 5/8"	24#	250'	200	Circ. to top
7 7/8"	4 1/2"	10.5#	2800'	200	1900'

Adequate blowout prevention equipment will be utilized.

APPROVAL VAND
FOR 90 DAYS UNLESS
DRILLING COMMENCED,

EXPIRES 7-23-80

IN ABOVE SPACE DESCRIBE PROPOSED PROGRAM: IF PROPOSAL IS TO DEEPEN OR PLUG BACK, GIVE DATA ON PRESENT PRODUCTIVE ZONE AND PROPOSED NEW PRODUCTIVE ZONE. GIVE BLOWOUT PREVENTER PROGRAM, IF ANY.

I hereby certify that the information above is true and complete to the best of my knowledge and belief.

Signed William J. McLean Title Operations Manager Date April 21, 1980

(This space for State Use)

APPROVED BY W. A. Gussott TITLE SUPERVISOR, DISTRICT 8 DATE APR 23 1980

CONDITIONS OF APPROVAL, IF ANY:

NEW MEXICO OIL CONSERVATION COMMISSION
WELL LOCATION AND ACREAGE DEDICATION PLAT

Form C-102
Supersedes C-128
Effective 1-1-65

All distances must be from the outer boundaries of the Section.

Operator Ralph Nix			Lease Pinkie		Well No. 2
Unit Letter G	Section 12	Township 8 South	Range 28 East	County Chaves	
Actual Footage Location of Well: 1650 feet from the North line and 1650 feet from the East line					
Ground Level Elev: 4086	Producing Formation San Andres		Pool Bull's Eye - SA	Dedicated Acreage: 40 Acres	

1. Outline the acreage dedicated to the subject well by colored pencil or hachure marks on the plat below.
2. If more than one lease is dedicated to the well, outline each and identify the ownership thereof (both as to working interest and royalty).
3. If more than one lease of different ownership is dedicated to the well, have the interests of all owners been consolidated by communitization, unitization, force-pooling, etc?

☐ Yes ☐ No If answer is "yes," type of consolidation _____

If answer is "no," list the owners and tract descriptions which have actually been consolidated. (Use reverse side of this form if necessary.) _____

No allowable will be assigned to the well until all interests have been consolidated (by communitization, unitization, forced-pooling, or otherwise) or until a non-standard unit, eliminating such interests, has been approved by the Commission.

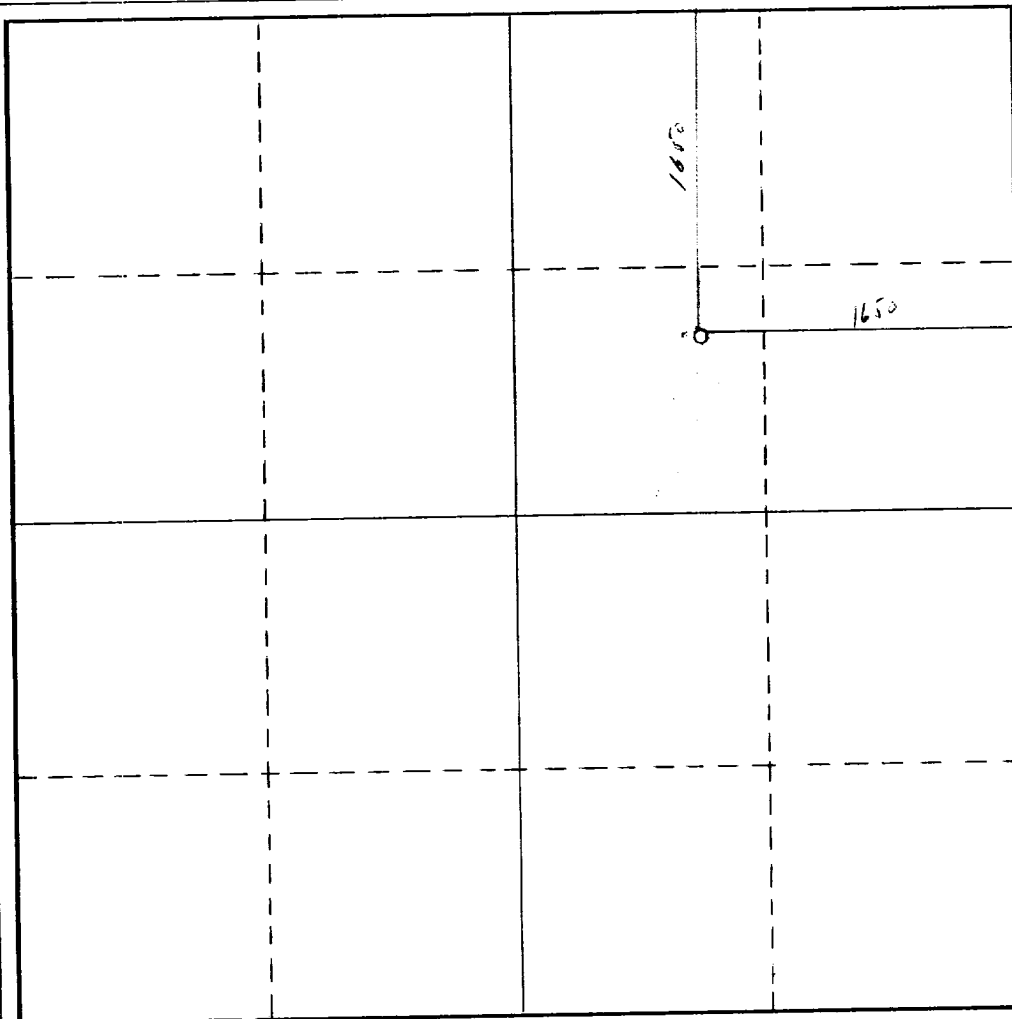

CERTIFICATION

I hereby certify that the information contained herein is true and complete to the best of my knowledge and belief.

Name _____
Position **Operations Manager**
Company **Ralph Nix Oil**
Date **April 21, 1980**

I hereby certify that the well location shown on this plat was plotted from field notes of actual surveys made by me or under my supervision, and that the same is true and correct to the best of my knowledge and belief.

Date Surveyed **April 19, 1980**
Registered Professional Engineer and/or Land Surveyor

John A. Mathis Jr.
Certificate No. **1502**