

UNITED STATES  
DEPARTMENT OF THE INTERIOR  
GEOLOGICAL SURVEY

30-005-60882

APPLICATION FOR PERMIT TO DRILL, DEEPEN, OR PLUG BACK

1a. TYPE OF WORK  
 DRILL  DEEPEN  PLUG BACK   
 b. TYPE OF WELL  
 OIL WELL  GAS WELL  OTHER  SINGLE ZONE  MULTIPLE ZONE

2. NAME OF OPERATOR  
 Coastal Oil & Gas Corporation ✓

3. ADDRESS OF OPERATOR  
 Box 1332, Amarillo, Texas 79189

4. LOCATION OF WELL (Report location clearly and in accordance with any State requirements.)\*  
 At surface 330' FSL & 1650' FEL  
 At proposed prod. zone Same

14. DISTANCE IN MILES AND DIRECTION FROM NEAREST TOWN OR POST OFFICE  
 18 miles east-northeast of Artesia, New Mexico

15. DISTANCE FROM PROPOSED\* LOCATION TO NEAREST PROPERTY OR LEASE LINE, FT. (Also to nearest drlg. unit line, if any)  
 330'

18. DISTANCE FROM PROPOSED LOCATION\* TO NEAREST WELL, DRILLING, COMPLETED, OR APPLIED FOR, ON THIS LEASE, FT.  
 660'

21. ELEVATIONS (Show whether DF, RT, GR, etc.)  
 3558' GR

23. PROPOSED CASING AND CEMENTING PROGRAM

SIZE OF HOLE	SIZE OF CASING	WEIGHT PER FOOT	SETTING DEPTH	QUANTITY OF CEMENT
12 1/4"	8 5/8"	24#	350'	225 sx Class 'H' w/2% CaCL Circulated
7 7/8"	5 1/2"	14#	1300'	100 sx Class 'C' w/2% CaCL

Mud Program: See Exhibit E

BOP Program: Rotating head and diverter line to be installed after surface pipe is set. Diverter line will have a closing valve in it.

IN ABOVE SPACE DESCRIBE PROPOSED PROGRAM: If proposal is to deepen or plug back, give data on present productive zone and proposed new productive zone. If proposal is to drill or deepen directionally, give pertinent data on subsurface locations and measured and true vertical depths. Give blowout preventer program, if any.

24. SIGNED Paul D. Robert TITLE Petroleum Engineer DATE Sept. 5, 1980

(This space for Federal or State office use)

PERMIT NO. \_\_\_\_\_ APPROVAL DATE \_\_\_\_\_

APPROVED BY (Orig. Sgd.) PETER W. CHESTER TITLE ADJ. DISTRICT ENGINEER DATE FEB 23 1981

CONDITIONS OF APPROVAL, IF ANY:

\*See Instructions On Reverse Side

RECEIVED  
 SEP 18 1980  
 U.S. GEOLOGICAL SURVEY  
 ARTESIA, NEW MEXICO

5. LEASE DESIGNATION AND SERIAL NO.  
 NM-29827  
 6. IF INDIAN, ALLOTTEE OR TRIBE NAME  
 -----  
 7. UNIT AGREEMENT NAME  
 ----- RECEIVED  
 8. FARM OR LEASE NAME  
 Hall Federal  
 9. WELL NO.  
 2  
 10. FIELD AND POOL, OR WILDCAT  
 Wildcat Queen  
 11. SEC., T., R., M., OR BLK. AND SURVEY OR AREA  
 33-15S-28E  
 12. COUNTY OR PARISH  
 Chaves  
 13. STATE  
 New Mexico

NEW MEXICO OIL CONSERVATION COMMISSION  
WELL LOCATION AND ACREAGE DEDICATION PLAT

Form C-102  
Supersedes C-128  
Effective 1-1-65

All distances must be from the outer boundaries of the Section.

Operator <b>Coastal Oil &amp; Gas</b>		Lease <b>HALL FEDERAL</b>			Well No. <b>2</b>
Unit Letter <b>0</b>	Section <b>33</b>	Township <b>15 S</b>	Range <b>28 E</b>	County <b>CHAVES</b>	
Actual Footage Location of Well: <b>330</b> feet from the <b>SOUTH</b> line and <b>1650</b> feet from the <b>EAST</b> line					
Ground Level Elev. <b>3558'</b>	Producing Formation <b>Queen</b>	Pool <b>Wildcat</b>		Dedicated Acreage: <b>40</b> Acres	

1. Outline the acreage dedicated to the subject well by colored pencil or hachure marks on the plat below.
2. If more than one lease is dedicated to the well, outline each and identify the ownership thereof (both as to working interest and royalty).
3. If more than one lease of different ownership is dedicated to the well, have the interests of all owners been consolidated by communitization, unitization, force-pooling, etc?

Yes  No If answer is "yes," type of consolidation \_\_\_\_\_

If answer is "no," list the owners and tract descriptions which have actually been consolidated. (Use reverse side of this form if necessary.) \_\_\_\_\_ NA \_\_\_\_\_

No allowable will be assigned to the well until all interests have been consolidated (by communitization, unitization, forced-pooling, or otherwise) or until a non-standard unit, eliminating such interests, has been approved by the Commission.

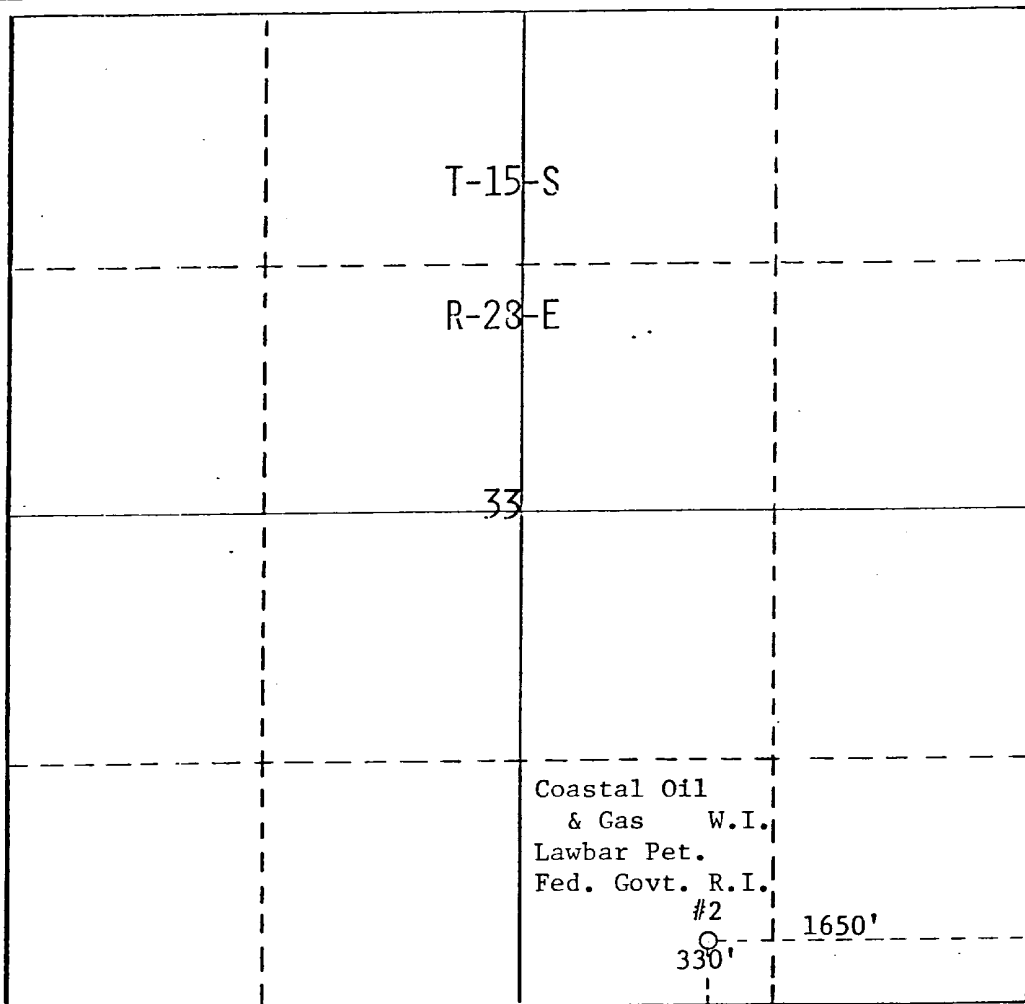

CERTIFICATION

I hereby certify that the information contained herein is true and complete to the best of my knowledge and belief.

Name  
**Paul D. Roberts**  
Position  
**Petroleum Engineer**  
Company  
**Coastal Oil & Gas Corp.**  
Date  
**Sept. 5, 1980**

I hereby certify that the well location shown on this plat as plotted in the field notes of the surveys made by me or under my supervision and that the same is true and correct to the best of my knowledge and belief.

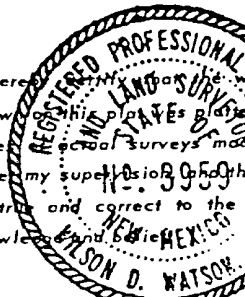

**July 18, 1980**  
Date Surveyed  
Registered Professional Engineer and/or Land Surveyor  
*Wilson D. Watson*  
Certificate No.  
**3959**

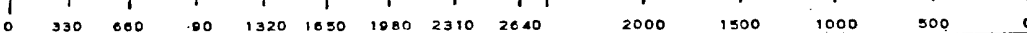

SUPPLEMENTAL DRILLING DATA

COASTAL OIL & GAS CORPORATION  
 HALL FEDERAL LEASE  
 SECTION 33-15S-28E  
 CHAVES COUNTY, NEW MEXICO

1. SURFACE FORMATION: Tansil
  
2. ESTIMATED TOPS OF GEOLOGIC MARKERS:

Base Salt	300'
Yates	423'
Seven Rivers	643'
Queen	1130'
  
3. ANTICIPATED POROSITY ZONES:

Water	50-100'
Oil	1200'
  
4. CASING DESIGN:

<u>Size</u>	<u>Interval</u>	<u>Weight</u>	<u>Grade</u>	<u>Joint</u>	<u>Condition</u>
8 5/8"	0-350'	24#	H-40	STC	New
5 1/2"	0-TD	14#	K-55	STC	New
  
5. SURFACE CONTROL EQUIPMENT: Rotating Control Head with a diverter line
  
6. CIRCULATING MEDIUM: Drilling Mud
  
7. AUXILIARY EQUIPMENT: None considered necessary on shallow development well.
  
8. TESTING, LOGGING AND CORING PROGRAMS: Logs will be run to TD.
  
9. ABNORMAL PRESSURES, TEMPERATURES OR HYDROGEN SULFIDE GAS: None.
  
10. ANTICIPATED STARTING DATE: It is planned that operations will commence about November 1, 1980. Duration of drilling and completion operations should be 4 to 10 days.

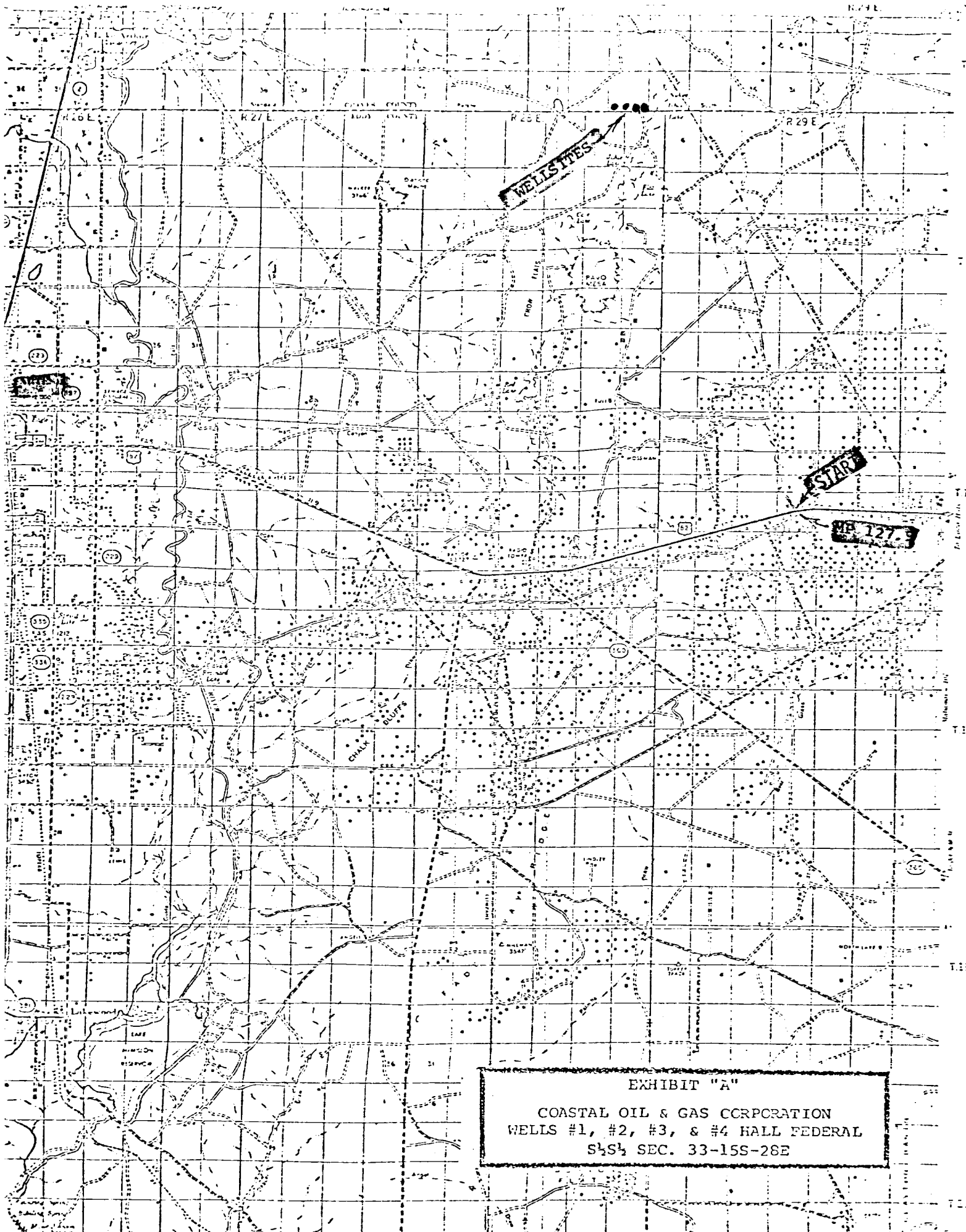
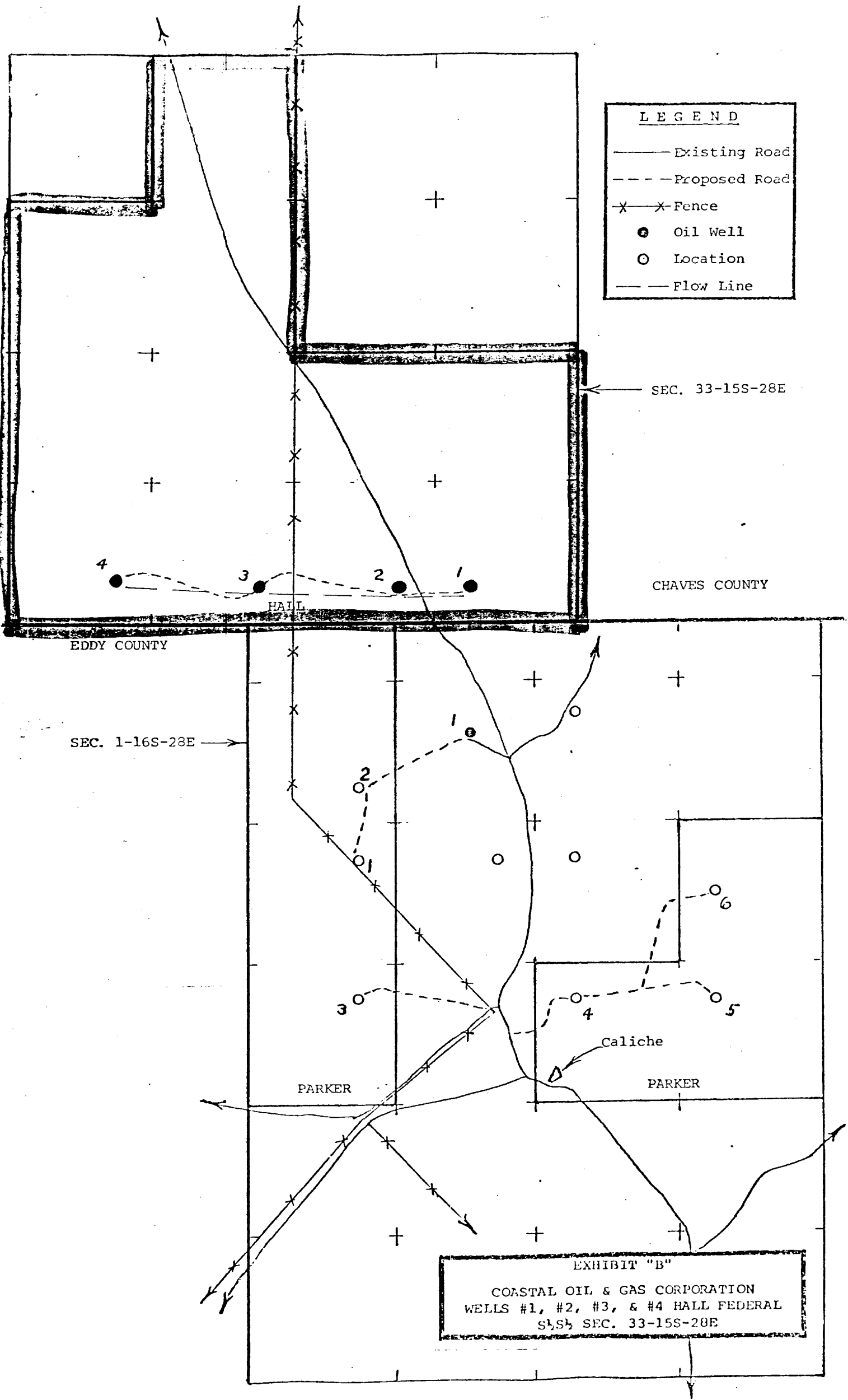

EXHIBIT "A"  
COASTAL OIL & GAS CORPORATION  
WELLS #1, #2, #3, & #4 HALL FEDERAL  
S $\frac{1}{2}$ S $\frac{1}{2}$  SEC. 33-15S-28E



LEGEND	
—	Existing Road
- - -	Proposed Road
X X	Fence
●	Oil Well
○	Location
—	Flow Line

SEC. 33-15S-28E

CHAVES COUNTY

EDDY COUNTY

SEC. 1-16S-28E

HALL

PARKER

PARKER

Caliche

EXHIBIT "B"  
 COASTAL OIL & GAS CORPORATION  
 WELLS #1, #2, #3, & #4 HALL FEDERAL  
 S1S1 SEC. 33-15S-28E