

UNITED STATES
DEPARTMENT OF THE INTERIOR
GEOLOGICAL SURVEYSUBMIT IN TRIPLICATE
(other instruction
reverse side)Form approved.
Budget Bureau No. 42-R1425.

30-005-60883

5. LEASE DESIGNATION AND SERIAL NO.

NM-29827

6. IF INDIAN, ALLOTTEE OR TRIBE NAME

7. UNIT AGREEMENT NAME

8. FARM OR LEASE NAME

Hall Federal

9. WELL NO.

3

10. FIELD AND POOL, OR WILDCAT

Wildcat Queen
11. SEC., T., R., M., OR BLK.
AND SURVEY OR AREA

Sec. 33-15S-28E

12. COUNTY OR PARISH 13. STATE

Chaves

New Mexico

1a. TYPE OF WORK

DRILL ☒DEEPEN ☐PLUG BACK ☐

b. TYPE OF WELL

OIL
WELL ☒GAS
WELL ☐

OTHER

SINGLE
ZONE ☒MULTIPLE
ZONE ☐

2. NAME OF OPERATOR

Coastal Oil & Gas Corporation

3. ADDRESS OF OPERATOR

Box 1332, Amarillo, Texas 79189

4. LOCATION OF WELL (Report location clearly and in accordance with any State requirements.)*

At surface

330' FSL & 2310' FWL

At proposed prod. zone

Same

14. DISTANCE IN MILES AND DIRECTION FROM NEAREST TOWN OR POST OFFICE*

18 miles east-northeast of Artesia, New Mexico

15. DISTANCE FROM PROPOSED*

LOCATION TO NEAREST
PROPERTY OR LEASE LINE, FT.
(Also to nearest drlg. unit line, if any)

330'

16. NO. OF ACRES IN LEASE

440

18. DISTANCE FROM PROPOSED LOCATION*
TO NEAREST WELL, DRILLING, COMPLETED,
OR APPLIED FOR, ON THIS LEASE, FT.

1320'

19. PROPOSED DEPTH

1330'

17. NO. OF ACRES ASSIGNED
TO THIS WELL

40

20. ROTARY OR CABLE TOOLS

Rotary

21. ELEVATIONS (Show whether DF, RT, GR, etc.)

3577' GR

22. APPROX. DATE WORK WILL START*

Nov. 1, 1980

23. PROPOSED CASING AND CEMENTING PROGRAM

SIZE OF HOLE	SIZE OF CASING	WEIGHT PER FOOT	SETTING DEPTH	QUANTITY OF CEMENT
12 1/4"	8 5/8"	24#	350'	225 sx Class 'H' w/2% CaCL Circulated
7 7/8"	5 1/2"	14#	1300'	100 sx Class 'C' w/2% CaCL

Mud Program: See Exhibit E

BOP Program: Rotating head and diverter line to be installed after surface
pipe is set. Diverter line will have a closing valve in it.RECEIVED
SEP 18 1980
U.S. GEOLOGICAL SURVEY
ARTESIA, NEW MEXICO

IN ABOVE SPACE DESCRIBE PROPOSED PROGRAM: If proposal is to deepen or plug back, give data on present productive zone and proposed new productive zone. If proposal is to drill or deepen directionally, give pertinent data on subsurface locations and measured and true vertical depths. Give blowout preventer program, if any.

24.

SIGNED

TITLE Petroleum Engineer

DATE Sept. 5, 1980

(This space for Federal or State office use)

PERMIT NO.

APPROVAL DATE

APPROVED BY (Orig. Sgd.) PETER W. CHESTER

TITLE ACTING DISTRICT ENGINEER

DATE FEB 23 1981

CONDITIONS OF APPROVAL, IF ANY:

*See Instructions On Reverse Side

NEW-MEXICO OIL CONSERVATION COMMISSION
WELL LOCATION AND ACREAGE DEDICATION PLAT

Form C-102
Supersedes C-128
Effective 1-1-65

All distances must be from the outer boundaries of the Section.

Operator Coastal Oil & Gas Corporation			Lease HALL FEDERAL		Well No. 3
Unit Letter N	Section 33	Township 15 S	Range 28 E	County CHAVES	
Actual Footage Location of Well: 330 feet from the SOUTH line and 2310 feet from the WEST line					
Ground Level Elev. 3577'	Producing Formation Queen		Pool Wildcat		Dedicated Acreage: 40 Acres

1. Outline the acreage dedicated to the subject well by colored pencil or hachure marks on the plat below.
2. If more than one lease is dedicated to the well, outline each and identify the ownership thereof (both as to working interest and royalty).
3. If more than one lease of different ownership is dedicated to the well, have the interests of all owners been consolidated by communitization, unitization, force-pooling, etc?

☐ Yes ☒ No If answer is "yes," type of consolidation _____

If answer is "no," list the owners and tract descriptions which have actually been consolidated. (Use reverse side of this form if necessary.) NA

No allowable will be assigned to the well until all interests have been consolidated (by communitization, unitization, forced-pooling, or otherwise) or until a non-standard unit, eliminating such interests, has been approved by the Commission.

RECEIVED
SEP 18 1980
U.S. GEOLOGICAL SURVEY
ARRESTA, NEW MEXICO

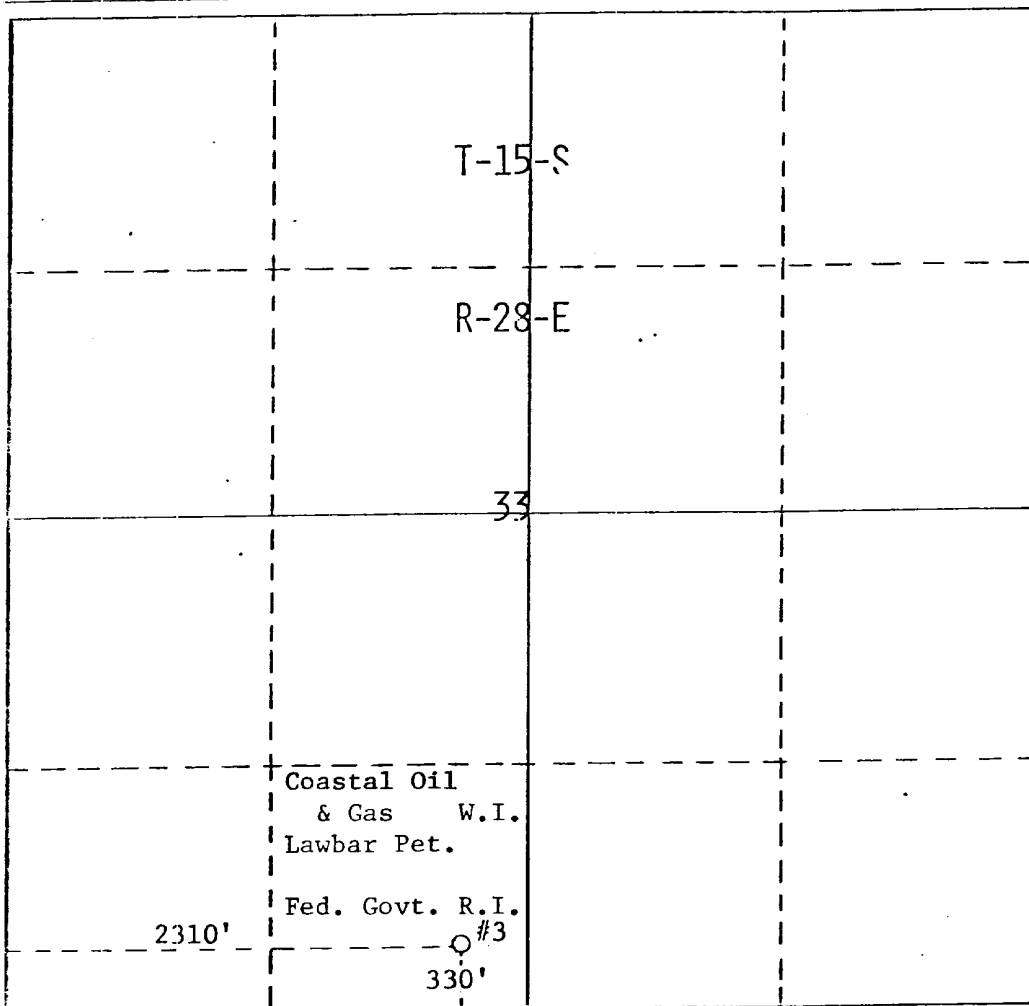

CERTIFICATION

I hereby certify that the information contained herein is true and complete to the best of my knowledge and belief.

Name
Paul D. Roberts
Position
Petroleum Engineer
Company
Coastal Oil & Gas Corp.
Date
Sept. 5, 1980

I hereby certify that the location shown on this plat was plotted from field notes of actual surveys made by me or under my supervision and that the same is true and correct to the best of my knowledge and belief.

July 17, 1980

Date Surveyed

Registered Professional Engineer and/or Land Surveyor

Certificate No.

3959

-0

SUPPLEMENTAL DRILLING DATA

COASTAL OIL & GAS CORPORATION
HALL FEDERAL LEASE
SECTION 33-15S-28E
CHAVES COUNTY, NEW MEXICO

1. SURFACE FORMATION: Tansil

2. ESTIMATED TOPS OF GEOLOGIC MARKERS:

Base Salt	300'
Yates	423'
Seven Rivers	643'
Queen	1130'

3. ANTICIPATED POROSITY ZONES:

Water	50-100'
Oil	1200'

4. CASING DESIGN:

<u>Size</u>	<u>Interval</u>	<u>Weight</u>	<u>Grade</u>	<u>Joint</u>	<u>Condition</u>
8 5/8"	0-350'	24#	H-40	STC	New
5 1/2"	0-TD	14#	K-55	STC	New

5. SURFACE CONTROL EQUIPMENT: Rotating Control Head with a diverter line

6. CIRCULATING MEDIUM: Drilling Mud

7. AUXILIARY EQUIPMENT: None considered necessary on shallow development well.

8. TESTING, LOGGING AND CORING PROGRAMS: Logs will be run to TD.

9. ABNORMAL PRESSURES, TEMPERATURES OR HYDROGEN SULFIDE GAS: None.

10. ANTICIPATED STARTING DATE: It is planned that operations will commence about November 1, 1980. Duration of drilling and completion operations should be 4 to 10 days.

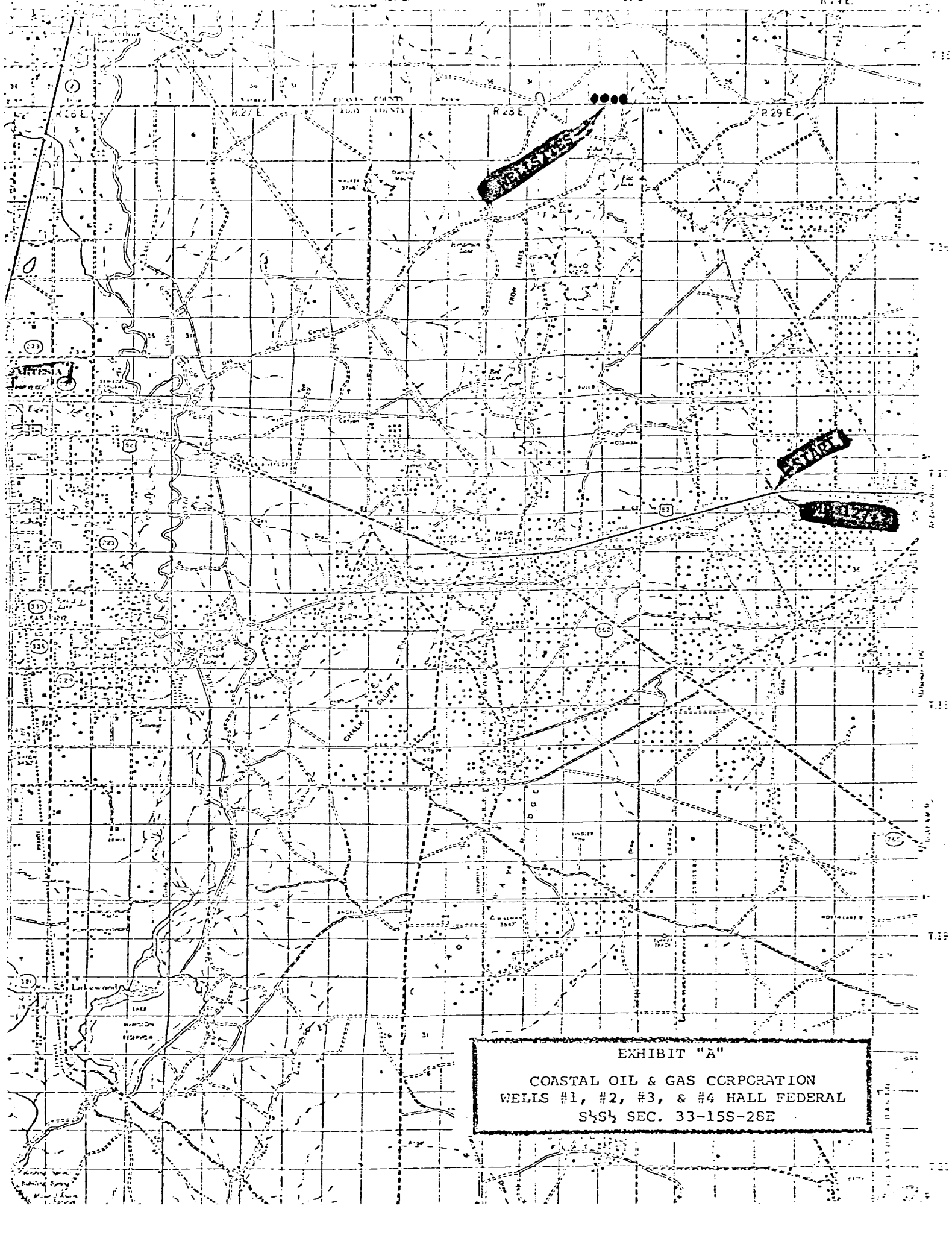
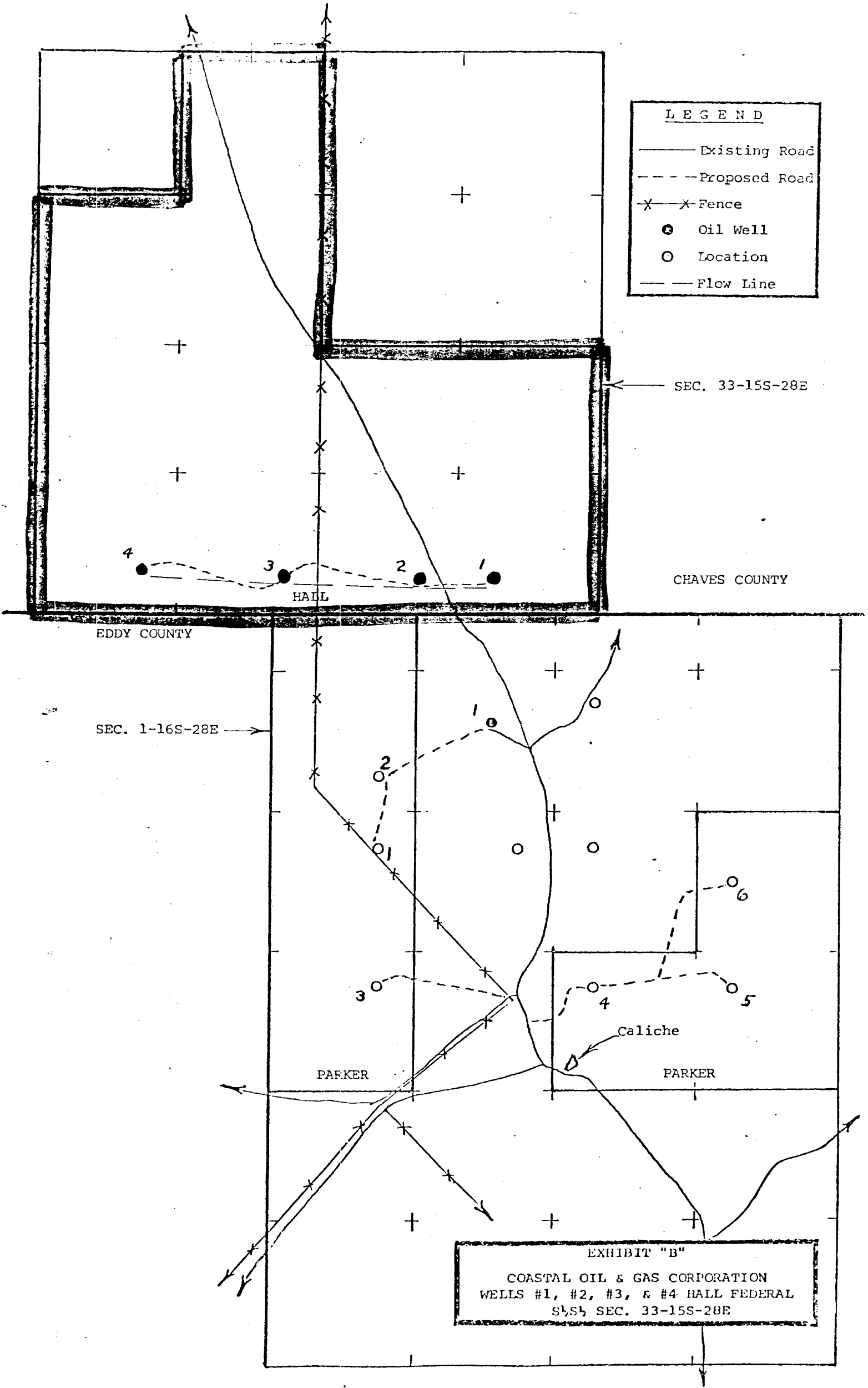

EXHIBIT "A"

COASTAL OIL & GAS CORPORATION
WELLS #1, #2, #3, & #4 HALL FEDERAL
S&S SEC. 33-15S-28E



LEGEND

- Existing Road
- Proposed Road
- X-X Fence
- Oil Well
- Location
- Flow Line