

NO	COPIES RECEIVED
D. TRIBUTION	
SANTA FE	1
FILE	1
U.S.G.S.	1
LAND OFFICE	1
OPERATOR	1

NEW MEXICO OIL CONSERVATION COMMISSION **RECEIVED**

30-005-61000
Form C-101
Revised 1-1-65

AMENDED LOCATION

AUG 03 1981

O. C. D.
ARTESIA, OFFICE

5A. Indicate Type of Lease	
STATE <input checked="" type="checkbox"/>	FEE <input type="checkbox"/>

5. State Oil & Gas Lease No.
LG 6693

APPLICATION FOR PERMIT TO DRILL, DEEPEN, OR PLUG BACK

1a. Type of Work DRILL <input checked="" type="checkbox"/> DEEPEN <input type="checkbox"/> PLUG BACK <input type="checkbox"/>		7. Unit Agreement Name
b. Type of Well OIL WELL <input type="checkbox"/> GAS WELL <input checked="" type="checkbox"/> OTHER <input type="checkbox"/>		8. Farm or Lease Name NED STATE
2. Name of Operator MESA PETROLEUM CO. /		9. Well No. 4
3. Address of Operator 1000 VAUGHN BUILDING/MIDLAND, TEXAS 79701		10. Field and Pool, or Wildcat UNDESIGNATED ABO
4. Location of Well UNIT LETTER J LOCATED 1980 FEET FROM THE SOUTH LINE AND 1980 FEET FROM THE EAST LINE OF SEC. 8 TWP. 9S RGE. 23E NMPM		12. County CHAVES
19. Proposed Depth 3800'		19A. Formation ABO
20. Rotary or C.T. ROTARY		21. Elevations (Show whether DE, RT, etc.) 3905.08'
21A. Kind & Status Plug. Bond BLANKET		21B. Drilling Contractor DUAL DRILLING
22. Approx. Date Work will start SEPTEMBER 10, 1981		

23. PROPOSED CASING AND CEMENT PROGRAM					
SIZE OF HOLE	SIZE OF CASING	WEIGHT PER FOOT	SETTING DEPTH	SACKS OF CEMENT	EST. TOP
12 1/4"	8 5/8"	24#	1400'	500	SURFACE
7 7/8"	4 1/2"	10.5#	3700'	500	SUFFICIENT TO ISOLATE WTR, O&G

Propose to drill 12 1/4" hole to 1400' or deeper to set 8 5/8" surface casing and cement to surface. Will reduce hole to 7 7/8" nipple up ram type BOPs and drill to total depth. Drilling medium will be air, foam, or mud as required. After log evaluation, 4 1/2" casing may be run and cemented with sufficient kinds and amounts to isolate and seal off any fresh water, oil, or gas zones encountered.

Gas Sales Are Dedicated To Transwestern Pipeline Company.

APPROVAL VALID FOR 180 DAYS
PERMIT EXPIRES 2-4-82
UNLESS DRILLING UNDERWAY

XC: NMOC (6), TLS, CEN RCDS, ACCTG, ROSWELL, MEC, LAND, PARTNERS, FILE

IN ABOVE SPACE DESCRIBE PROPOSED PROGRAM: IF PROPOSAL IS TO DEEPEN OR PLUG BACK, GIVE DATA ON PRESENT PRODUCTIVE ZONE AND PROPOSED NEW PRODUCTIVE ZONE, GIVE BLOWOUT PREVENTER PROGRAM, IF ANY.

I hereby certify that the information above is true and complete to the best of my knowledge and belief.

Signed R. E. Mathis Title REGULATORY COORDINATOR Date JULY 31, 1981

(This space for State Use)

APPROVED BY W. A. Gressett TITLE SUPERVISOR, DISTRICT II DATE AUG 04 1981

CONDITIONS OF APPROVAL, IF ANY:

Notify N.M.O.C.C. in sufficient time to witness cementing

N MEXICO OIL CONSERVATION COMMISSION
WELL LOCATION AND ACREAGE DEDICATION PLAT

Form C-102
Supersedes C-128
Effective 1-1-65

All distances must be from the outer boundaries of the Section

Operator MESA PETROLEUM COMPANY		Lease NED STATE		Well No. 4
Tract Letter J	Section 8	Township 9 South	Range 23 East	County Chaves
Actual Footage Location of Well: 1980 feet from the South line and 1980 feet from the East line				
Ground Level Elev. 3905.8	Producing Formation ABO	Pool UNDESIGNATED	Dedicated Acreage: SE/4 160 Acres	

1. Outline the acreage dedicated to the subject well by colored pencil or hachure marks on the plat below.
2. If more than one lease is dedicated to the well, outline each and identify the ownership thereof (both as to working interest and royalty).
3. If more than one lease of different ownership is dedicated to the well, have the interests of all owners been consolidated by communitization, unitization, force-pooling, etc?

☐ Yes ☐ No If answer is "yes," type of consolidation _____

If answer is "no," list the owners and tract descriptions which have actually been consolidated. (Use reverse side of this form if necessary.) _____

No allowable will be assigned to the well until all interests have been consolidated (by communitization, unitization, forced-pooling, or otherwise) or until a non-standard unit, eliminating such interests, has been approved by the Commission.

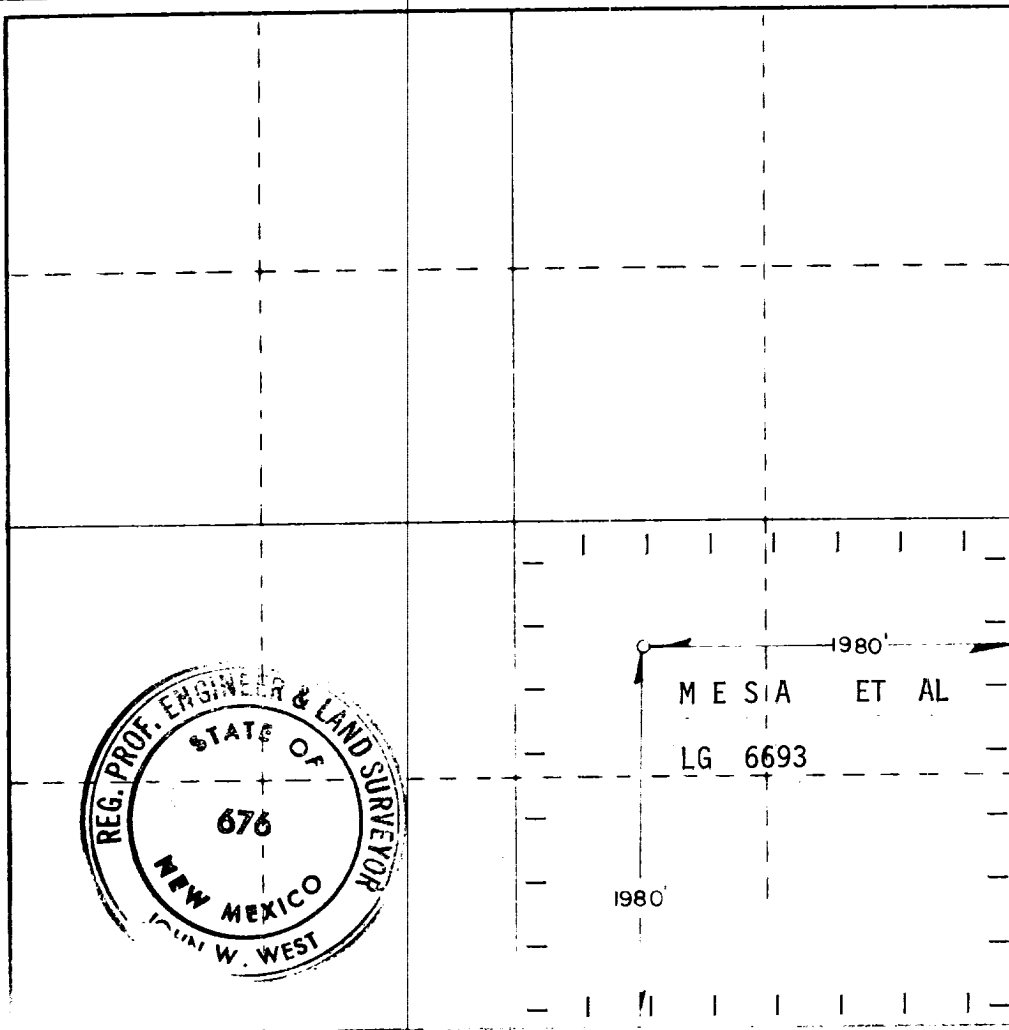

CERTIFICATION

I hereby certify that the information contained herein is true and complete to the best of my knowledge and belief

R. E. Mathis

Name

R. E. MATHIS

Position

REGULATORY COORDINATOR

Company

MESA PETROLEUM CO.

Date

JULY 31, 1981

I hereby certify that the well location shown on this plat was plotted from field notes of actual surveys made by me or under my supervision, and that the same is true and correct to the best of my knowledge and belief

Date Surveyed

7/7/81

Registered Professional Engineer

No. _____

John W. West

JOHN W. WEST

REGISTERED PROFESSIONAL ENGINEER