

NO. OF COPIES RECEIVED	
DISTRIBUTION	
SANTA FE	
FILE	
U.S.G.S.	
LAND OFFICE	
OPERATOR	

NEW MEXICO OIL CONSERVATION COMMISSION

JUL 30 1981

O. C. D.
ARTESIA, OFFICE

30-005-61055

Form C-101
Revised 1-1-65

A. Indicate Type of Lease	
STATE <input checked="" type="checkbox"/>	FEE <input type="checkbox"/>
State Oil & Gas Lease No.	
LG 6692	

APPLICATION FOR PERMIT TO DRILL, DEEPEN, OR PLUG BACK

1a. Type of Work		7. Unit Agreement Name	
b. Type of Well OIL WELL <input type="checkbox"/> GAS WELL <input checked="" type="checkbox"/> OTHER <input type="checkbox"/>		8. Farm or Lease Name PANTHER STATE	
2. Name of Operator MESA PETROLEUM CO.		9. Well No. 3	
3. Address of Operator 1000 VAUGHN BUILDING/MIDLAND, TEXAS 79701		10. Field and Pool, or Wildcat UNDESIGNATED ABO	
4. Location of Well UNIT LETTER N LOCATED 660 FEET FROM THE SOUTH LINE AND 1650 FEET FROM THE WEST LINE OF SEC. 3 TWP. 9S RGE. 23E NMPM		12. County CHAVES	
19. Proposed Depth 3600'		19A. Formation ABO	
20. Rotary or C.T. ROTARY		21. Elevations (Show whether DF, RT, etc.) 3827.9' GR	
21A. Kind & Status Plug. Bond BLANKET		21B. Drilling Contractor DUAL DRILLING	
22. Approx. Date Work will start OCTOBER 6, 1981			

PROPOSED CASING AND CEMENT PROGRAM

SIZE OF HOLE	SIZE OF CASING	WEIGHT PER FOOT	SETTING DEPTH	SACKS OF CEMENT	EST. TOP
12 1/4"	8 5/8"	24#	1800'	750	SURFACE
7 7/8"	4 1/2"	10.5#	3600'	500	SUFFICIENT TO ISOLATE WTR, O&G

Propose to drill 12 1/4" hole to approximately 1800' to set 8 5/8" surface casing and cement to surface. Will reduce hole to 7 7/8", nipple up RAM type BOPs and drill to total depth. Drilling medium will be air, foam, or mud as required.

Gas Sales Are Dedicated.

APPROVAL VALID FOR 180 DAYS
PERMIT EXPIRES 2-4-82
UNLESS DRILLING COMPLETION

XC: NMOCD (6), TLS, CEN RCDS, ACCTG, ROSWELL, MEC, LAND, PARTNERS, FILE

IN ABOVE SPACE DESCRIBE PROPOSED PROGRAM: IF PROPOSAL IS TO DEEPEN OR PLUG BACK, GIVE DATA ON PRESENT PRODUCTIVE ZONE AND PROPOSED NEW PRODUCTIVE ZONE. GIVE BLOWOUT PREVENTER PROGRAM, IF ANY.

I hereby certify that the information above is true and complete to the best of my knowledge and belief.

Signed R. P. Mathis Title REGULATORY COORDINATOR Date JULY 29, 1981

(This space for State Use)

PROVED BY N. A. Gussert TITLE SUPERVISOR, DISTRICT II DATE AUG 04 1981

CONDITIONS OF APPROVAL, IF ANY:

Notify N.M.O.C.C. in sufficient time to witness cementing

05/4'

**N MEXICO OIL CONSERVATION COMMISSION
WELL LOCATION AND ACREAGE DEDICATION PLAT**

Form C-102
Supersedes C-128
Effective 1-1-65

All distances must be from the outer boundaries of the Section

Operator Mesa Petroleum Co.			Lease Panther State		Well No. 3
Unit Letter N	Section 3	Township 9 South	Range 23 East	County Chaves	
Actual Footage Location of Well: <div style="display: flex; justify-content: space-between;"> 660 feet from the south line and 1650 feet from the west line </div>					
Ground Level Elev. 3827.9	Producing Formation ABO	Pool UNDESIGNATED <i>ABO</i>		Dedicated Acreage: SW/4 160 Acres	

1. Outline the acreage dedicated to the subject well by colored pencil or hachure marks on the plat below.
2. If more than one lease is dedicated to the well, outline each and identify the ownership thereof (both as to working interest and royalty).
3. If more than one lease of different ownership is dedicated to the well, have the interests of all owners been consolidated by communitization, unitization, force-pooling, etc?

☐ Yes ☐ No If answer is "yes," type of consolidation _____

If answer is "no," list the owners and tract descriptions which have actually been consolidated. (Use reverse side of this form if necessary.) _____

No allowable will be assigned to the well until all interests have been consolidated (by communitization, unitization, forced-pooling, or otherwise) or until a non-standard unit, eliminating such interests, has been approved by the Commission.

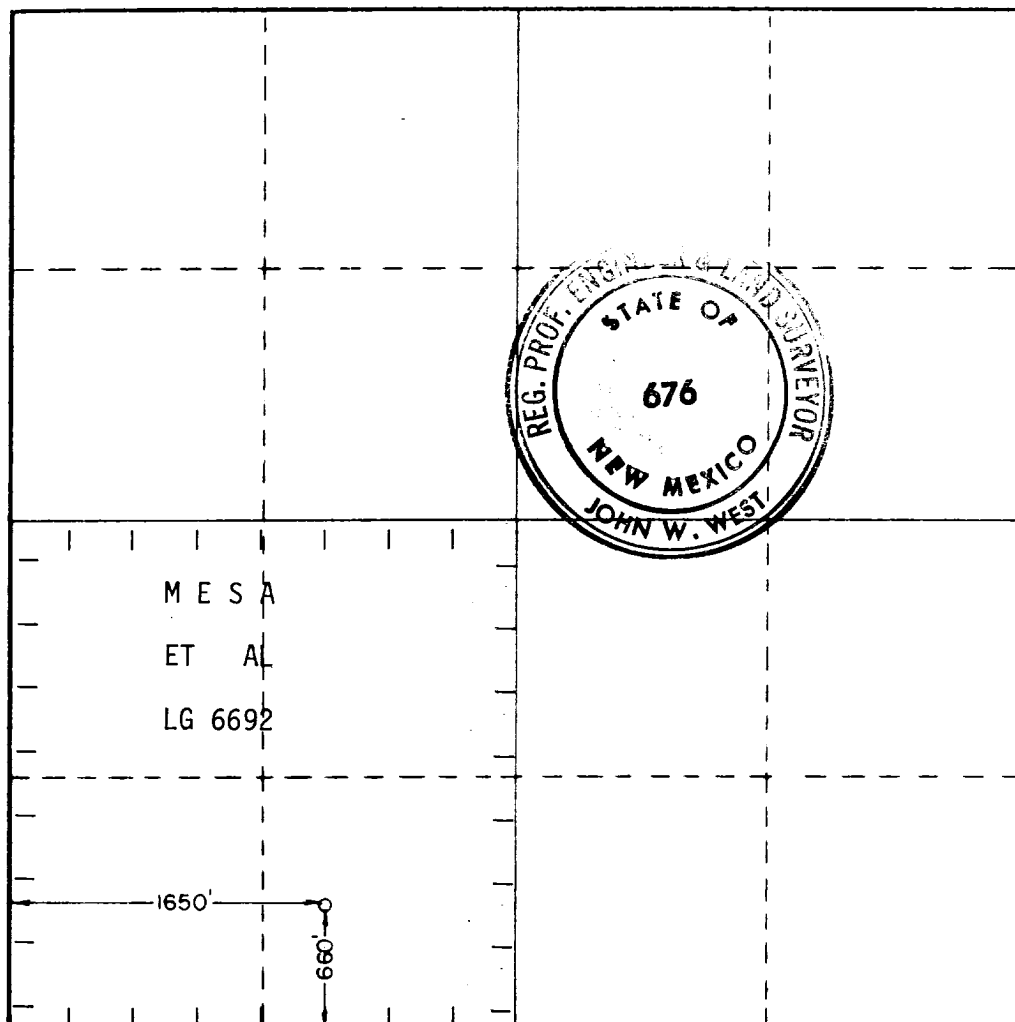

CERTIFICATION

I hereby certify that the information contained herein is true and complete to the best of my knowledge and belief.

R. E. Mathis

Name

R. E. MATHIS

Position

REGULATORY COORDINATOR

Company

MESA PETROLEUM CO.

Date

JULY 29, 1981

I hereby certify that the well location shown on this plat was plotted from field notes of actual surveys made by me or under my supervision, and that the same is true and correct to the best of my knowledge and belief.

Date Surveyed

April 11, 1981

Registered Professional Engineer and/or Land Surveyor

John W. West

Certificate No. **JOHN W. WEST 676**
PATRICK A. ROMERO 6668
Ronald J. Eidson 3239

330 660 990 1320 1650 1980 2310 2640 2970 3300 3630 3960 4290 4620 4950 5280 5610 5940 6270 6600 6930 7260 7590 7920 8250 8580 8910 9240 9570 9900