

30-005-61250

Form C-101
Revised 10-85

NEW MEXICO OIL CONSERVATION COMMISSION

RECEIVED

DEC - 1 1981

O. C. D.
ARTESIA, OFFICE

3A. Inflow Type of Lease
STATE FEE

3B. State Oil & Gas Lease No.

COPIES RECEIVED	
DISTRIBUTION	
SANTA FE	1
FILE	1
U.S.G.S.	2
LAND OFFICE	
OPERATOR	1

APPLICATION FOR PERMIT TO DRILL, DEEPEN, OR PLUG BACK

1a. Type of Work
DRILL DEEPEN PLUG BACK

b. Type of Well
OIL WELL GAS WELL OTHER SINGLE ZONE MULTIPLE ZONE

2. Name of Operator
CIBOLA ENERGY CORPORATION ✓

3. Address of Operator
P. O. BOX 1668, ALBUQUERQUE, NM 87103

4. Location of Well
UNIT LETTER G LOCATED 1650 FEET FROM THE North LINE
AND 1650 FEET FROM THE East LINE OF SEC. 30 TWP. 10S RGE. 28E NMPM

7. Unit Agreement Name

8. Farm or Lease Name
Mabel

9. Well No.
4

10. Field and Pool, or Wildcat
Race Track SA

11. County
Chaves

19. Proposed Depth
2250'

19A. Formation
San Andres

20. Policy or C.T.
Cable Tool

21. Elevations (Show whether DT, HI, etc.)
3738.7'

21A. Kind & Status Plug. Bond
Statewide

21B. Drilling Contractor
Comanche Drilling

22. Approx. Date Work will start
December 27, 1981

23. PROPOSED CASING AND CEMENT PROGRAM

SIZE OF HOLE	SIZE OF CASING	WEIGHT PER FOOT	SETTING DEPTH	SACKS OF CEMENT	EST. TOP
10"	8 5/8"	20#	400'	85	Circ.
8"	7"	20#	2250'	150	2000'

We propose to:

Drill a 10" hole and set 8 5/8" casing to 350'. Circulate cement to surface, WOC 18 hours. Test hole for fluid entry. If bailed dry, will commence drilling an 8" hole to 2250'. Run DLL with Mirroloaterolog, CNL-FDC-GR. We will set 7" casing to either TD or above P-1 zone depending on the outcome of the logs. In latter case, open hole completion will be attempted, in former case, casing will be perforated.

*Noted ID-1
API + ML-B
12-4-81*

APPROVAL VALID FOR 180 DAYS
6-3-82
C. J. ...

IN ABOVE SPACE DESCRIBE PROPOSED PROGRAM: IF PROPOSAL IS TO DEEPEN OR PLUG BACK, GIVE DATA ON PRESENT PRODUCTIVE ZONE AND PROPOSED NEW PRODUCTIVE ZONE. GIVE BLOWOUT PREVENTER PROGRAM, IF ANY.

I hereby certify that the information above is true and complete to the best of my knowledge and belief.
Signed Quita Vigil Title Drilling Secretary Date November 27, 1981

(This space for State Use)
APPROVED BY Mike Williams TITLE OIL AND GAS INSPECTOR DATE DEC 9 1981

CONDITIONS OF APPROVAL, IF ANY:
Cement must be circulated to surface behind 8 5/8 casing

NEW MEXICO OIL CONSERVATION COMMISSION
WELL LOCATION AND ACREAGE DEDICATION PLAT

Form C-102
Supersedes C-128
Effective 1-1-65

All distances must be from the outer boundaries of the Section.

Operator Cibola Energy Corp.		Lease Mabel		Well No. 4
Unit Letter G	Section 30	Township 10 South	Range 28 East	County Chaves
Actual Footage Location of Well: 1650 feet from the North line and 1650 feet from the East line				
Ground Level Elev. 3738.7'	Producing Formation San Andres	Pool J & Ranch S A Race Track	Dedicated Acreage: 40 Acres	

1. Outline the acreage dedicated to the subject well by colored pencil or hachure marks on the plat below.
2. If more than one lease is dedicated to the well, outline each and identify the ownership thereof (both as to working interest and royalty).
3. If more than one lease of different ownership is dedicated to the well, have the interests of all owners been consolidated by communitization, unitization, force-pooling, etc?

Yes No If answer is "yes," type of consolidation _____

If answer is "no," list the owners and tract descriptions which have actually been consolidated. (Use reverse side of this form if necessary.) All leases are held by operator and participating parties

No allowable will be assigned to the well until all interests have been consolidated (by communitization, unitization, forced-pooling, or otherwise) or until a non-standard unit, eliminating such interests, has been approved by the Commission.

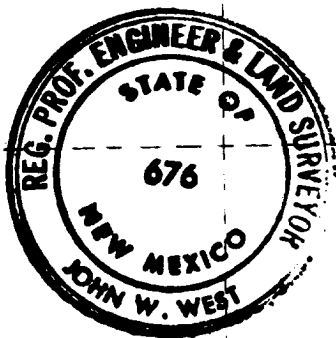
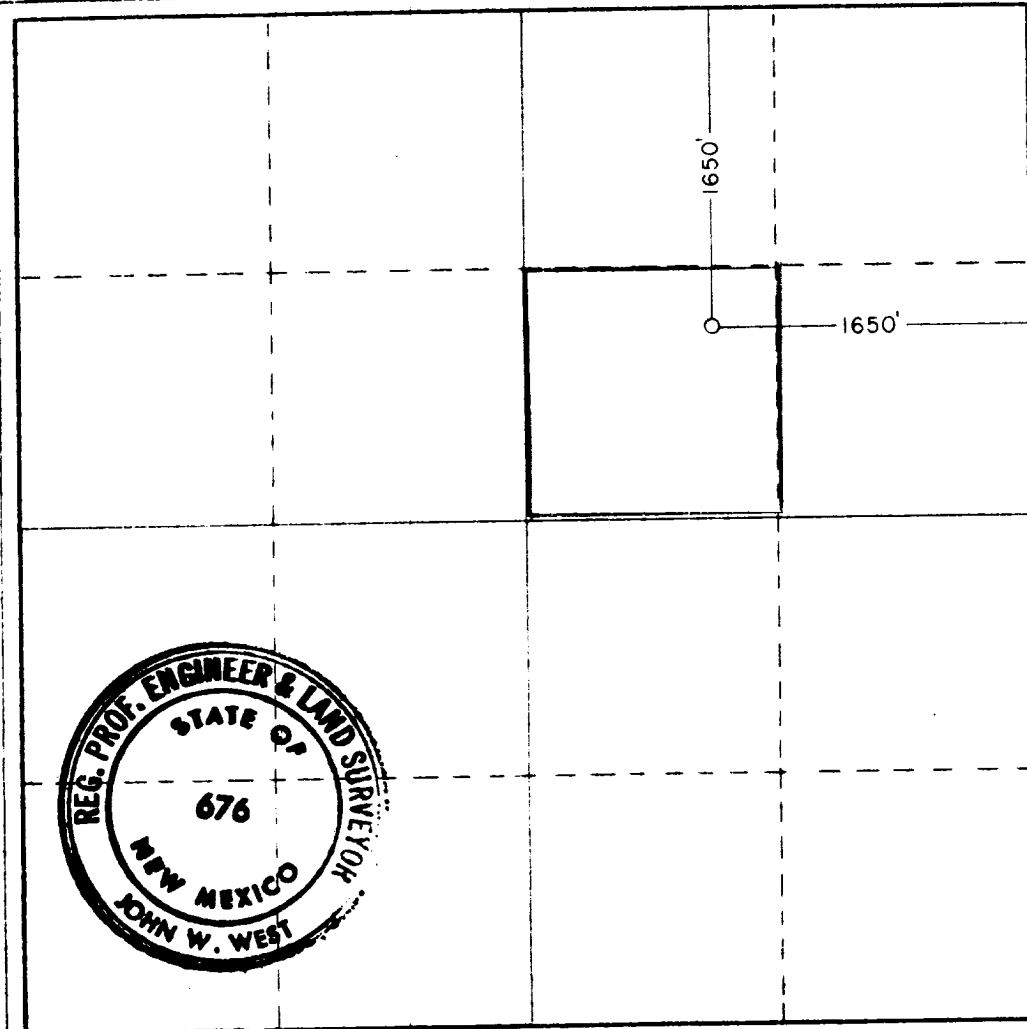

CERTIFICATION

I hereby certify that the information contained herein is true and complete to the best of my knowledge and belief.

Anita Vigil

Name
Anita Vigil

Position
Drilling Secretary

Company
Cibola Energy Corp.

Date
November 27, 1981

I hereby certify that the well location shown on this plat was plotted from field notes of actual surveys made by me or under my supervision, and that the same is true and correct to the best of my knowledge and belief.

Date Surveyed
Nov. 24, 1981

Registered Professional Engineer and/or Land Surveyor

John W. West

Certificate No. **JOHN W. WEST 676**
PATRICK A. ROMERO 6665
Ronald J. Eidson 3239