

COPIES RECEIVED	
DISTRIBUTION	
SANTA FE	
FILE	
U.S.G.S.	
LAND OFFICE	
OPERATOR	

NEW MEXICO OIL CONSERVATION COMMISSION

RECEIVED

DEC - 1 1981

O. C. D.

ARTESIA, OFFICE

30-005-61251
Form O-101
Revised 10-85

5A. Indicate Type of Lease
STATE ☐ FEDERAL ☒
5. State Oil & Gas Lease No.

APPLICATION FOR PERMIT TO DRILL, DEEPEN, OR PLUG BACK

1a. Type of Work DRILL <input checked="" type="checkbox"/> DEEPEN <input type="checkbox"/> PLUG BACK <input type="checkbox"/>		7. Unit Agreement Name
b. Type of Well OIL WELL <input checked="" type="checkbox"/> GAS WELL <input type="checkbox"/> OTHER <input type="checkbox"/> SINGLE ZONE <input type="checkbox"/> MULTIPLE ZONE <input type="checkbox"/>		8. Farm or Lease Name Sally
2. Name of Operator CIBOLA ENERGY CORPORATION		9. Well No. 1
3. Address of Operator P.O. Box 1668, ALBUQUERQUE, NM 87103		10. Field and Foot, or Acreage Race Track SA
4. Location of Well UNIT LETTER I LOCATED 2310 FEET FROM THE South LINE AND 330 FEET FROM THE East LINE OF SEC. 30 TWP. 10S RGE. 28E NMPM		11. County Chaves
15. Proposed Depth 2250		19A. Formation San Andres
16. Elevation (show whether DE, RT, etc.) 3725.7		20. Rotary or C.T. Cable Tool
21A. Kind & Status Plug. Bond Statewide		22. Approx. Date Work will start December 28, 1981
21B. Drilling Contractor Comanche Drilling		

PROPOSED CASING AND CEMENT PROGRAM

SIZE OF HOLE	SIZE OF CASING	WEIGHT PER FOOT	SETTING DEPTH	SACKS OF CEMENT	EST. TOP
10"	8 5/8"	20#	400'	85	Circ.
8"	7"	20#	2250'	150	2000'

We propose to:

Drill a 10" hole and set 8 5/8" casing to 350'. Circulate cement to surface, WOC 18 hours. Test hole for fluid entry. If bailed dry, will commence drilling an 8" hole to 2250'. Run DLL with Mirrolaterolog, CNL-FDC-GR. We will set 7" casing to either TD or above P-1 zone depending on the outcome of the logs. In latter case, open hole completion will be attempted, in former case, casing will be perforated.

APPROVAL VALID FOR 180 DAYS
PERMIT EXPIRES 6-3-82
UNLESS DRILLING UNDERWAY

IN ABOVE SPACE DESCRIBE PROPOSED PROGRAM: IF PROPOSAL IS TO DEEPEN OR PLUG BACK, GIVE DATA ON PRESENT PRODUCTIVE ZONE AND PROPOSED NEW PRODUCTIVE ZONE. GIVE BLOWOUT PREVENTER PROGRAM, IF ANY.

I hereby certify that the information above is true and complete to the best of my knowledge and belief.

Signed Amitha Vigil Title Drilling Secretary Date November 27, 1981

(This space for State Use)

APPROVED BY Mark Williams TITLE State Engineer DATE DEC 3 1981

CONDITIONS OF APPROVAL, IF ANY:

Cement must be circulated to surface behind 8 5/8" casing

NEW MEXICO OIL CONSERVATION COMMISSION
WELL LOCATION AND ACREAGE DEDICATION PLAT

Form C-102
Supersedes C-128
Effective 1-1-65

All distances must be from the outer boundaries of the Section.

Operator Cibola Energy Corp.		Lease Sally		Well No. 1
Unit Letter I	Section 30	Township 10 South	Range 28 East	County Chaves
Actual Footage Location of Well: 2310 feet from the South line and 330 feet from the East line				
Ground Level Elev. 3725.7'	Producing Formation San Andres	Pool and J.E. Renshaw A Base Track	Dedicated Acreage: 40 Acres	

1. Outline the acreage dedicated to the subject well by colored pencil or hachure marks on the plat below.
2. If more than one lease is dedicated to the well, outline each and identify the ownership thereof (both as to working interest and royalty).
3. If more than one lease of different ownership is dedicated to the well, have the interests of all owners been consolidated by communitization, unitization, force-pooling, etc?

☐ Yes ☒ No If answer is "yes," type of consolidation _____

If answer is "no," list the owners and tract descriptions which have actually been consolidated. (Use reverse side of this form if necessary.) All leases are held by operator and participating parties

No allowable will be assigned to the well until all interests have been consolidated (by communitization, unitization, forced-pooling, or otherwise) or until a non-standard unit, eliminating such interests, has been approved by the Commission.

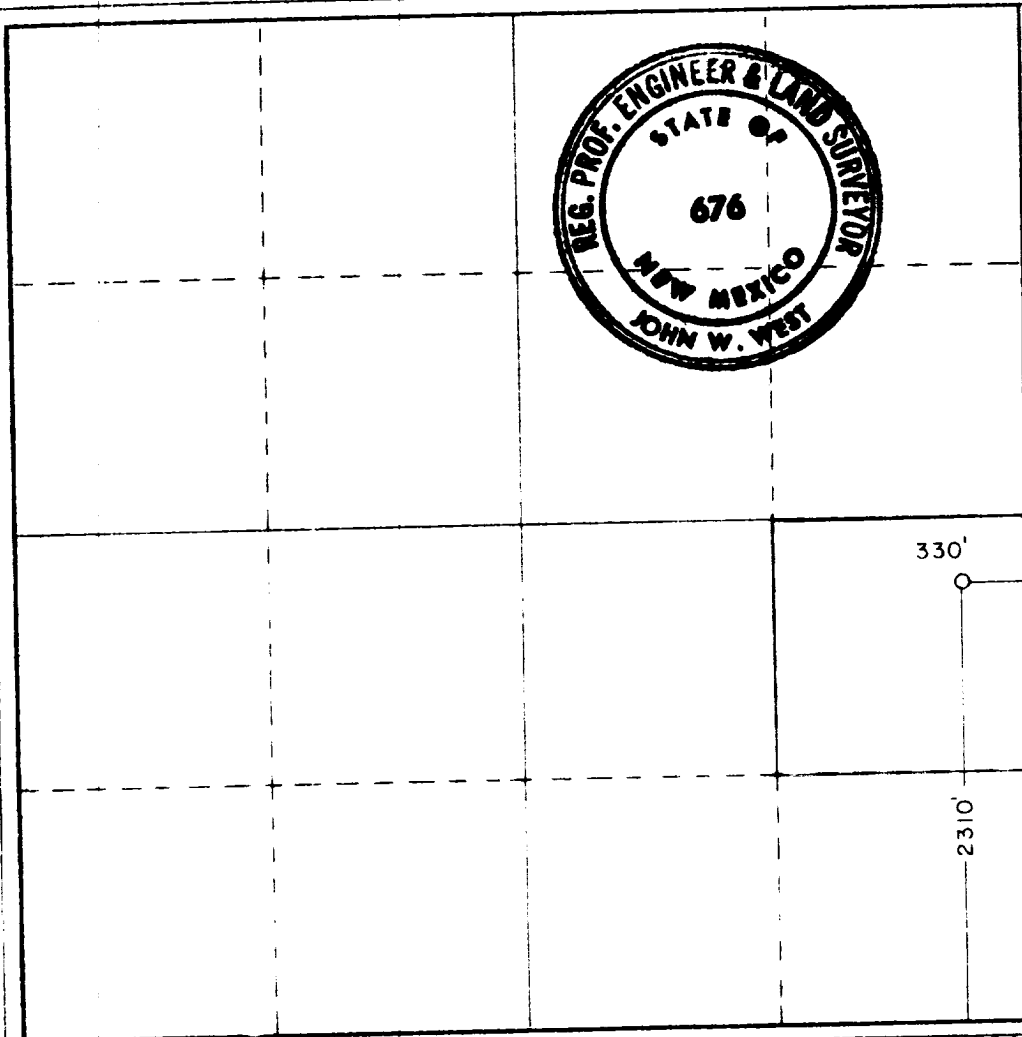

CERTIFICATION

I hereby certify that the information contained herein is true and complete to the best of my knowledge and belief.

Anita Vigil

Name
Anita Vigil

Position
Drilling Secretary

Company
Cibola Energy Corp.

Date
November 27, 1981

I hereby certify that the well location shown on this plat was plotted from field notes of actual surveys made by me or under my supervision, and that the same is true and correct to the best of my knowledge and belief.

Date Surveyed
Nov. 24, 1981

Registered Professional Engineer and Land Surveyor

John W. West

Certificate No. **JOHN W. WEST 676**
PATRICK A. ROMERO 6063
Ronald J. Eidson 3239

330 660 990 1320 1650 1980 2310 2640 2970 3300 3630 3960 4290 4620 4950 5280 5610 5940 6270 6600