

RECEIVED

MAR 16 1982

O. C. D.

ARTESIA, OFFICE

Form C-101  
Revised 10-1-78

NO. OF COPIES RECEIVED	
DISTRIBUTION	
SANTA FE	1
FILE	1
U.S.G.S.	2
LAND OFFICE	
OPERATOR	1

5A. Indicate Type of Lease STATE <input type="checkbox"/> FEE <input checked="" type="checkbox"/>
5. State Oil & Gas Lease No.
7. Unit Agreement Name
8. Farm or Lease Name Western Com
9. Well No. 2
10. Field and Pool, or Wildcat Pecos Slope ABO
12. County Chaves

## APPLICATION FOR PERMIT TO DRILL, DEEPEN, OR PLUG BACK

1a. Type of Work DRILL <input checked="" type="checkbox"/> DEEPEN <input type="checkbox"/> PLUG BACK <input type="checkbox"/>	7. Unit Agreement Name
b. Type of Well OIL WELL <input type="checkbox"/> GAS WELL <input checked="" type="checkbox"/> OTHER <input type="checkbox"/>	8. Farm or Lease Name Western Com
2. Name of Operator MESA PETROLEUM CO. ✓	9. Well No. 2
3. Address of Operator 1000 VAUGHN BUILDING/MIDLAND, TEXAS 79701-4493	10. Field and Pool, or Wildcat Pecos Slope ABO
4. Location of Well UNIT LETTER K LOCATED 1980 FEET FROM THE South LINE AND 1905 FEET FROM THE West LINE OF SEC. 30 TWP. 6S RGE. 25E NMPM	12. County Chaves
19. Proposed Depth 4150'	19A. Formation ABO
20. Rotary or C.T. Rotary	
21. Elevations (show whether DF, RT, etc.) 3797.4'	21A. Kind & Status Plug. Bond Blanket
21B. Drilling Contractor Dual Drilling	22. Approx. Date Work will start May 3, 1982

23.

## PROPOSED CASING AND CEMENT PROGRAM

SIZE OF HOLE	SIZE OF CASING	WEIGHT PER FOOT	SETTING DEPTH	SACKS OF CEMENT	EST. TOP
17 1/2"	13 3/8"	48#	900'	700/300	SURFACE
11" or 12 1/4"	8 5/8"	24#	1600'	700/300	ISOLATE WTR. O&G
7 7/8"	4 1/2"	10.5#	4150'	500	COVER ALL PAY

Propose to drill 17 1/2" hole to approximately 900', set 13 3/8" surface casing and cement to surface. Will reduce hole to 11" or 12 1/4" and drill to 1600' to set 8 5/8" casing. Will reduce hole to 7 7/8", nipple up RAM type BOP's, and drill to total depth. Drilling medium will be air, foam, or mud as required.

Operator's Gas Sales are dedicated.

APPROVAL VALID FOR 180 DAYS  
PERMIT EXPIRES 9-19-82  
UNLESS DRILLING UNDERWAY

xc: NMOCD (6), TLS, CEN RECDS, ACCTG, ROSWELL, MEC, LAND, PARTNERS, FILE, REM

Posted ID-1  
API + NL Book  
3-19-82

IN ABOVE SPACE DESCRIBE PROPOSED PROGRAM; IF PROPOSAL IS TO DEEPEN OR PLUG BACK, GIVE DATA ON PRESENT PRODUCTIVE ZONE AND PROPOSED NEW PRODUCTIVE ZONE. GIVE BLOWOUT PREVENTER PROGRAM, IF ANY.

I hereby certify that the information above is true and complete to the best of my knowledge and belief.

Signed R. S. [Signature] Title REGULATORY COORDINATOR Date 3-15-82

(This space for State Use)

APPROVED BY [Signature] TITLE OIL AND GAS INSPECTOR DATE MAR 19 1982

CONDITIONS OF APPROVAL, IF ANY:

**MEXICO OIL CONSERVATION COMMISSION  
WELL LOCATION AND ACREAGE DEDICATION PLAT**

Form C-102  
Supersedes C-128  
Effective 1-1-65

All distances must be from the outer boundaries of the Section

Operator <b>Mesa Petroleum Company</b>			Lease <b>Western Com.</b>		Well No. <b>2</b>
Section <b>K</b>	Section <b>30</b>	Township <b>6 South</b>	Range <b>25 East</b>	County <b>Chaves</b>	
Acreage (Total) (Section of Well) <b>1980</b> feet from the <b>south</b> line and <b>1905</b> feet from the <b>west</b> line					
Producing Formations <b>3797.4'</b>	Producing Formations <b>ABO</b>		Pool <b>PECOS SLOPE ABO</b>		Dedicated Acreage: <b>SW/4 160</b> Acres

- 1 Outline the acreage dedicated to the subject well by colored pencil or hatchure marks on the plat below.
- 2 If more than one lease is dedicated to the well, outline each and identify the ownership thereof (both as to working interest and royalty).
- 3 If more than one lease of different ownership is dedicated to the well, have the interests of all owners been consolidated by communitization, unitization, force-pooling, etc?

Yes ☐ No ☒ If answer is "yes" type of consolidation Communitization in Progress

If answer is "no" list the owners and tract descriptions which have actually been consolidated. (Use reverse side of this form if necessary.) \_\_\_\_\_

No allowable will be assigned to the well until all interests have been consolidated (by communitization, unitization, forced-pooling, or otherwise) or until a non-standard unit, eliminating such interests, has been approved by the Commission.

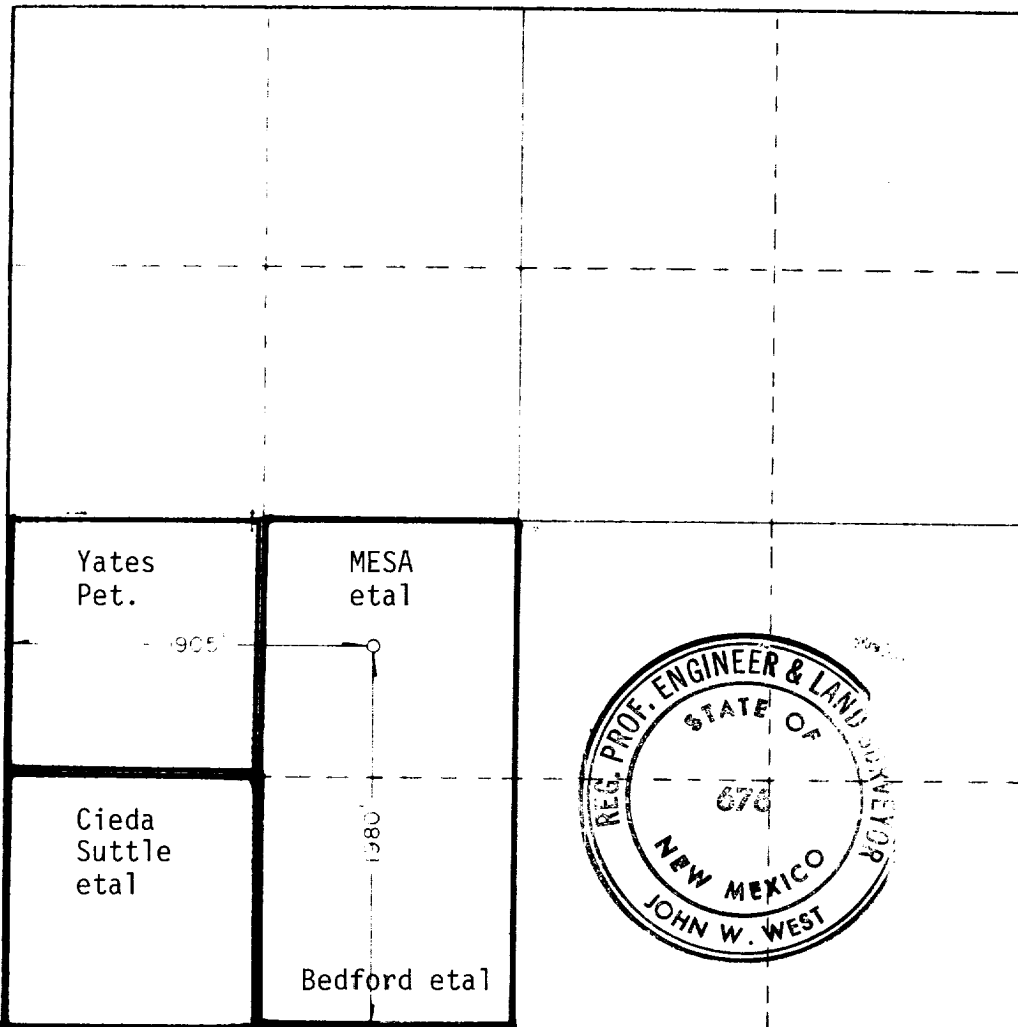

**CERTIFICATION**

I hereby certify that the information contained herein is true and complete to the best of my knowledge and belief.

*R. E. Mathis*

Name

**R. E. MATHIS**

Position

**REGULATORY COORDINATOR**

Company

**MESA PETROLEUM CO.**

Date

**MARCH 15, 1982**

I hereby certify that the well location shown on this plat was plotted from field notes of actual surveys made by me or under my supervision, and that the same is true and correct to the best of my knowledge and belief.

Date Surveyed

**3-4-82**

Registered Professional Engineer and/or Land Surveyor

*John W. West*

Certificate No. **JOHN W. WEST 676**  
**PATRICK A. ROMERO 6863**  
**Ronald J. Eidson 3239**

0 330 660 990 1320 1650 1980 2310 2640 2970 3300 3630 3960 4290 4620 4950 5280 5610 5940 6270 6600 6930 7260 7590 7920 8250 8580 8910 9240 9570 9900