

P. O. BOX 208
SANTA FE, NEW MEXICO 87501

Form C-101
Revised 10-1-78

NO. OF COPIES RECEIVED	
DISTRIBUTION	
SANTA FE	1
FILE	1
U.S.G.S.	2
LAND OFFICE	
OPERATOR	1

OCT 12 1982

O. C. D.

5A. Indicate Type of Lease

STATE ☒ FEE ☐

5. State Oil & Gas Lease No.

LG-3964

APPLICATION FOR PERMIT TO DRILL, DEEPEN, OR PLUG BACK

1a. Type of Work DRILL <input checked="" type="checkbox"/> DEEPEN <input type="checkbox"/> PLUG BACK <input type="checkbox"/>		7. Unit Agreement Name
b. Type of Well OIL WELL <input type="checkbox"/> GAS WELL <input checked="" type="checkbox"/> OTHER <input type="checkbox"/> SINGLE ZONE <input type="checkbox"/> MULTIPLE ZONE <input type="checkbox"/>		8. Farm or Lease Name N.M. State 36 "A"
2. Name of Operator CLEMENTS ENERGY, INC.		9. Well No. 1
3. Address of Operator P. O. Box 20500, Oklahoma City, Oklahoma 73156		10. Field and Pool, or Wildcat Wildcat - Penn
4. Location of Well UNIT LETTER L LOCATED 660 FEET FROM THE West LINE AND 1980 FEET FROM THE South LINE OF SEC. 36 TWP. 14-S RGE. 26-E NMPM		12. County Chaves
19. Proposed Depth 7300'		19A. Formation Penn
20. Rotary or C.T. Rotary		
21. Elevations (Show whether DF, RT, etc.) 3391.7' GL	21A. Kind & Status Plug. Bond Blanket - Active	22. Approx. Date Work will start October 25, 1982

PROPOSED CASING AND CEMENT PROGRAM

SIZE OF HOLE	SIZE OF CASING	WEIGHT PER FOOT	SETTING DEPTH	SACKS OF CEMENT	EST. TOP
17-1/2"	13-3/8"	54.5#	400'	450	Circ to surf
12-1/4"	8-5/8"	24#	1,500'	450	Circ
7-7/8"	4-1/2"	10.5 & 11.6#	7,300'	750	6000'

BOP SCHEDULE: 0' - 400' None
400' - 1500' 3000# WP Double Ram Schaffer-Hydraulic Controlled
1500' - 7300' 5000# WP Double Ram Schaffer-Hydraulic Controlled

SPACING 320 acres

Gas is not dedicated

APPROVAL VALID FOR 180 DAYS
PERMIT EXPIRES 4-13-83
UNLESS DRILLING UNDERWAY

IN ABOVE SPACE DESCRIBE PROPOSED PROGRAM: IF PROPOSAL IS TO DEEPEN OR PLUG BACK, GIVE DATA ON PRESENT PRODUCTIVE ZONE AND PROPOSED NEW PRODUCTIVE ZONE. GIVE BLOWOUT PREVENTER PROGRAM, IF ANY.

I hereby certify that the information above is true and complete to the best of my knowledge and belief.

Signed Colene Aldridge Title Asst. to Vice President Operations Date October 4, 1982

(This space for State Use)

APPROVED BY M. A. Walker TITLE OIL AND GAS INSPECTOR DATE OCT 15 1982

CONDITIONS OF APPROVAL, IF ANY: Notify N.M.O.C.C. in sufficient time to witness cementing

NEW MEXICO OIL CONSERVATION COMMISSION
WELL LOCATION AND ACREAGE DEDICATION PLAT

Form C-102
Supersedes C-128
Effective 1-1-85

All distances must be from the outer boundaries of the Section

Operator Clements Energy			Lease NM State 36 A		Well No. 1
Unit Letter L	Section 36	Township 14 South	Range 26 East	County Chaves	
Actual Footage Location of Well: 1980 feet from the South line and 660 feet from the West line					
Ground Level Elev. 3391.7	Producing Formation Penn	Pool Wildcat - Penn		Dedicated Acreage: 320 Acres	

1. Outline the acreage dedicated to the subject well by colored pencil or hachure marks on the plat below.
2. If more than one lease is dedicated to the well, outline each and identify the ownership thereof (both as to working interest and royalty).
3. If more than one lease of different ownership is dedicated to the well, have the interests of all owners been consolidated by communitization, unitization, force-pooling, etc?

☐ Yes ☐ No If answer is "yes," type of consolidation _____

If answer is "no," list the owners and tract descriptions which have actually been consolidated. (Use reverse side of this form if necessary.) _____

No allowable will be assigned to the well until all interests have been consolidated (by communitization, unitization, forced-pooling, or otherwise) or until a non-standard unit, eliminating such interests, has been approved by the Commission.

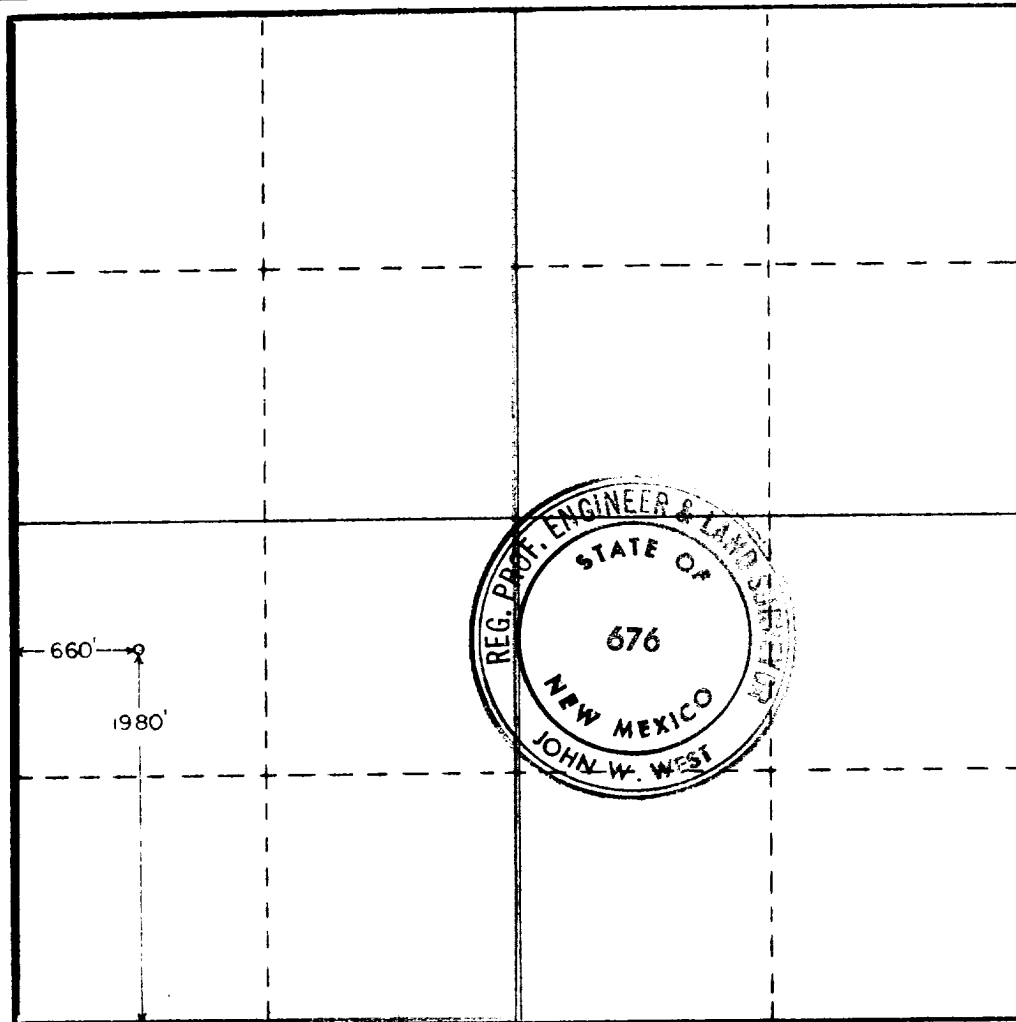

CERTIFICATION

I hereby certify that the information contained herein is true and complete to the best of my knowledge and belief.

Calene Aldridge

Name
Asst. to V.P. Operations
Position
Clements Energy, Inc.
Company
October 7, 1982
Date

I hereby certify that the well location shown on this plat was plotted from field notes of actual surveys made by me or under my supervision, and that the same is true and correct to the best of my knowledge and belief.

Date Surveyed
October 1, 1982
Registered Professional Engineer and Land Surveyor

John W. West
Certificate No. **JOHN W. WEST 676**
PATRICK A. ROMERO 6868
Ronald J. Eidson 3239

