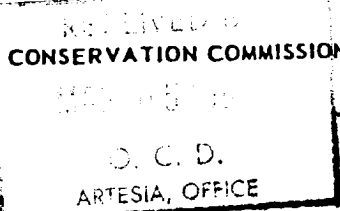

30-005-62129

| | |
|------------------------|---|
| NO. OF COPIES RECEIVED | |
| DISTRIBUTION | |
| SANTA FE | ✓ |
| FILE | ✓ |
| U.S.G.S. | h |
| LAND OFFICE | |
| OPERATOR | ✓ |

NEW MEXICO OIL CONSERVATION COMMISSION

Form C-101
Revised 14-65

| |
|--|
| 5A. Indicate Type of Lease |
| STATE <input type="checkbox"/> FEE <input checked="" type="checkbox"/> |

5. State Oil & Gas Lease No.

APPLICATION FOR PERMIT TO DRILL, DEEPEN, OR PLUG BACK

a. Type of Work

DRILL ☒DEEPEN ☐PLUG BACK ☐

b. Type of Well

OIL WELL ☒GAS WELL ☐

OTHER

SINGLE ZONE ☐MULTIPLE ZONE ☐

2. Name of Operator

Cibola Energy Corporation ✓

3. Address of Operator

P. O. Box 1668, Albuquerque, New Mexico 87103

4. Location of Well

UNIT LETTER F

LOCATED 1980

FEET FROM THE North

LINE

AND 1980 FEET FROM THE West

LINE OF SEC. 29

TWP. 10S

RGE. 28E

NMPM

12. County

Chaves

10. Field and Pool, or Wildcat

Race Track SA

9. Well No.

8

8. Form or Lease Name

Plains 29

7. Unit Agreement Name

19. Proposed Depth

2340'

19A. Formation

San Andres

20. Rotary or C.T.

Rotary

21. Elevations (Show whether DF, RT, etc.)

3728.4

21A. Kind & Status Plug. Bond

Statewide

21B. Drilling Contractor

Pecos Well Service

22. Approx. Date Work will start

March 15, 1984

23.

PROPOSED CASING AND CEMENT PROGRAM

| SIZE OF HOLE | SIZE OF CASING | WEIGHT PER FOOT | SETTING DEPTH | SACKS OF CEMENT | EST. TOP |
|--------------|----------------|-----------------|---------------|-----------------|----------|
| 10" | 8 5/8" | 23# | 320' | 200 sx | surface |
| 7 5/8" | 4 1/2" | 9.5# | 2340' | 120 sx | 1500 |

We plan to drill a 10" hole to 320' and set 8 5/8" casing, texas pattern guide shoe and 2 centralizers. 8 5/8" will be cemented with 200 sacks Class C cement circulated to surface. A 7 5/8" hole will be drilled to approx. 2340'. Density and Induction logs will be run and depending on the outcome of the well, it will be P & A'd or 4 1/2" casing will be run. A deviation survey will be run when the well has reached TD.

APPROVAL VALID FOR 180 DAYS
9-4-84
WELL UNDERWAY

Post ID-2
10-12-84
Exp Int

IN ABOVE SPACE DESCRIBE PROPOSED PROGRAM: IF PROPOSAL IS TO DEEPEN OR PLUG BACK, GIVE DATA ON PRESENT PRODUCTIVE ZONE AND PROPOSED NEW PRODUCTION ZONE. GIVE BLOWOUT PREVENTER PROGRAM, IF ANY.

I hereby certify that the information above is true and complete to the best of my knowledge and belief.

Signed Karen Azar Title Drilling Secretary Date 2-1-84

(This space for State Use)

APPROVED BY Mike Walker TITLE OIL AND GAS INSPECTOR DATE MAR 09 1984

CONDITIONS OF APPROVAL, IF ANY:

Post. a P
80-10-12-84
3-16-84

NEW MEXICO OIL CONSERVATION COMMISSION
WELL LOCATION AND ACREAGE DEDICATION PLAT

Form 1-1-1
Supersedes C-128
1-1-1-1-1-1

All measurements must be from the outer four corners of the Section

| | | | | |
|--------------------------|---------------------|-----------------------|----------------|--------|
| CIBOLA ENERGY CORP. | | PLAINS 29 | | 8 |
| F | 29 | 10S | 28E | CHAVES |
| Actual Location of Well: | | | | |
| 1980 | feet from the | NORTH | line and | 1980 |
| feet from the | WEST | | | |
| Ground Level Elev. | Producing Formation | Field | Section Number | |
| 3728.4 | San Andres | Race Track San Andres | 40 | |

- Outline the acreage dedicated to the subject well by colored pencil or hatchure marks on the plat below
- If more than one lease is dedicated to the well, outline each and identify the ownership thereof (both as to working interest and royalty).
- If more than one lease of different ownership is dedicated to the well, have the interests of all owners been consolidated by communitization, unitization, force-pooling, etc?

☐ Yes ☒ No If answer is "yes," type of consolidation _____

If answer is "no," list the owners and tract descriptions which have actually been consolidated. (Use reverse side of this form if necessary.) All leases held by operator and participating parties

No allowable will be assigned to the well until all interests have been consolidated (by communitization, unitization, forced-pooling, or otherwise) or until a non-standard unit, eliminating such interests, has been approved by the Commission.

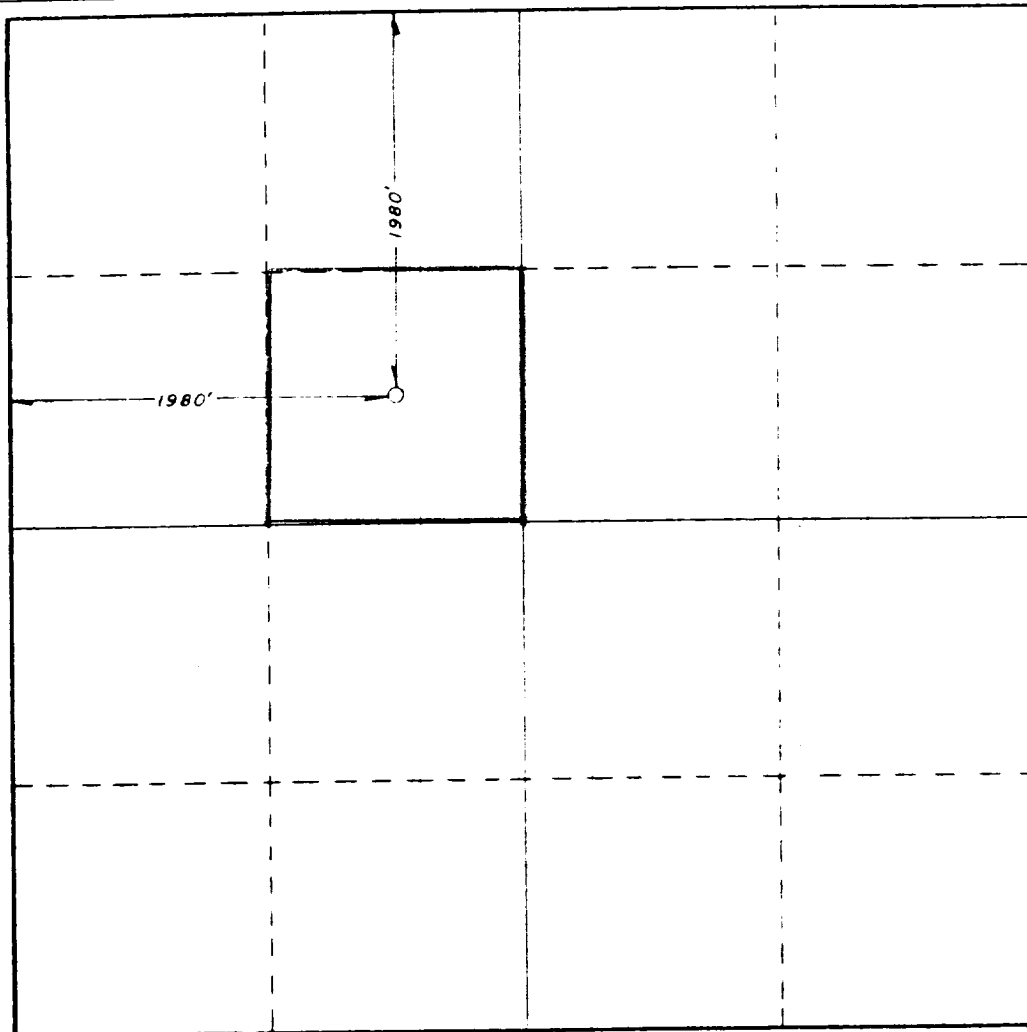

CERTIFICATION

I hereby certify that the information contained herein is true and complete to the best of my knowledge and belief

Karen Azar

Karen Azar

Drilling Secretary

Cibola Energy Corporation

3-2-84

I hereby certify that the well location shown on this plat was plotted from field notes of actual surveys made by me or under my supervision, and that the same is true and correct to the best of my knowledge and belief.

Date Surveyed

2/29/84

Registered Professional Engineer and Land Surveyor

John W. West

Certificate No. JOHN W. WEST, 676

RONALD J. EIDSON, 3229

330 660 990 1320 1650 1980 2310 2640 2970 3300 3630 3960 4290 4620 4950 5280 5610 5940 6270 6600