

STATE OF NEW MEXICO  
ENERGY AND MINERALS DEPARTMENT

NO. OF COPIES RECEIVED	
DISTRIBUTION	
SANTA FE	<input checked="" type="checkbox"/>
FILE	<input checked="" type="checkbox"/>
U.S.G.S.	2
LAND OFFICE	
OPERATOR	<input checked="" type="checkbox"/>

ALL CONSERVATION DIVISION  
RECEIVED BY P.O. BOX 2088  
SANTA FE, NEW MEXICO 87501  
JAN 21 1985  
O. C. D.  
ARTESIA, OFFICE

Form C-101  
Revised 3-1-85  
31-805-63242

5A. Indicate Type of Lease  
STATE ☐ FEE ☒

5. State Oil & Gas Lease No.

APPLICATION FOR PERMIT TO DRILL, DEEPEN, OR PLUG BACK

1a. Type of Work DRILL <input checked="" type="checkbox"/> DEEPEN <input type="checkbox"/> PLUG BACK <input type="checkbox"/>				7. Unit Agreement Name	
b. Type of Well OIL WELL <input checked="" type="checkbox"/> GAS WELL <input type="checkbox"/> OTHER <input type="checkbox"/> SINGLE ZONE <input checked="" type="checkbox"/> MULTIPLE ZONE <input type="checkbox"/>				8. Farm or Lease Name Moon Company 18	
2. Name of Operator Petrus Operating Company, Inc. ✓				9. Well No. 1	
3. Address of Operator 12201 Merit Drive, Suite 900 Dallas, Texas 75251				10. Field and Pool for Wildcat Wildcat - S.M.	
4. Location of Well UNIT LETTER K LOCATED 1980 FEET FROM THE South LINE AND 1980 FEET FROM THE West LINE OF SEC. 18 TWP. 9S RGE. 29E NMPM				12. County Chaves	
19. Proposed Depth 3950		19A. Formation San Andres		20. Rotary or C.T. Rotary	
21. Elevations (Show whether DF, RT, etc.) 3941' GL		21A. Kind & Status Plug. Bond Blanket Bond		21B. Drilling Contractor Salazar Brothers Drilling	
				22. Approx. Date Work will start 2-1-85	

PROPOSED CASING AND CEMENT PROGRAM

SIZE OF HOLE	SIZE OF CASING	WEIGHT PER FOOT	SETTING DEPTH	SACKS OF CEMENT	EST. TOP
12-1/4"	8-5/8"	24	500	450 sx	Surface
7-7/8"	4-1/2"	10.5	3500	400 sx	1000'

Drilling to use conventional mud and rotary drilling methods. Completion to be conventional perforation and treatment. Sketch of type blowout preventor attached.

APPROVED FOR 180 DAYS  
7-23-85  
UNDERWAY  
Postcard ID  
API 4-NL  
1-25-85

IN ABOVE SPACE DESCRIBE PROPOSED PROGRAM: IF PROPOSAL IS TO DEEPEN OR PLUG BACK, GIVE DATA ON PRESENT PRODUCTIVE ZONE AND PROPOSED NEW PRODUCTIVE ZONE. GIVE BLOWOUT PREVENTER PROGRAM, IF ANY.

I hereby certify that the information above is true and complete to the best of my knowledge and belief.

Signed C. L. Hardy Title Drilling & Production Manager Date 1-16-85

(This space for State Use)

APPROVED BY W. L. Williams TITLE OIL AND GAS INSPECTOR DATE JAN 23 1985

CONDITIONS OF APPROVAL, IF ANY:

STATE OF NEW MEXICO  
ENERGY AND MINERALS DEPARTMENT

OIL CONSERVATION DIVISION

P. O. BOX 2088

SANTA FE, NEW MEXICO 8. 01

Form C-102  
Revised 10-1-77

All Distances must be from the outer boundaries of the Section.

Operator <b>Petrus Operating Company, Inc.</b>			Lease <b>Moon Company 18</b>		Well No. <b>#1</b>
Unit Letter <b>K</b>	Section <b>18</b>	Township <b>9 South</b>	Range <b>29 East</b>	County <b>Chaves</b>	
Actual Postage Location of Well					
1980 feet from the South line and		1980 feet from the West line			
Ground Level Elev. <b>3941</b>	Producing Formation <b>San Andres</b>	Pool <b>Wildcat</b>	Dedicated Acreage <b>40</b> Acres		

1. Outline the acreage dedicated to the subject well by colored pencil or hatchure marks on the plat below.
2. If more than one lease is dedicated to the well, outline each and identify the ownership thereof (both as to working interest and royalty).
3. If more than one lease of different ownership is dedicated to the well, have the interests of all owners been consolidated by communitization, unitization, force-pooling, etc?

☐ Yes ☐ No If answer is "yes," type of consolidation \_\_\_\_\_

If answer is "no," list the owners and tract descriptions which have actually been consolidated. (Use reverse side of this form if necessary.) \_\_\_\_\_

No allowable will be assigned to the well until all interests have been consolidated (by communitization, unitization, forced-pooling, or otherwise) or until a non-standard unit, eliminating such interests, has been approved by the Division

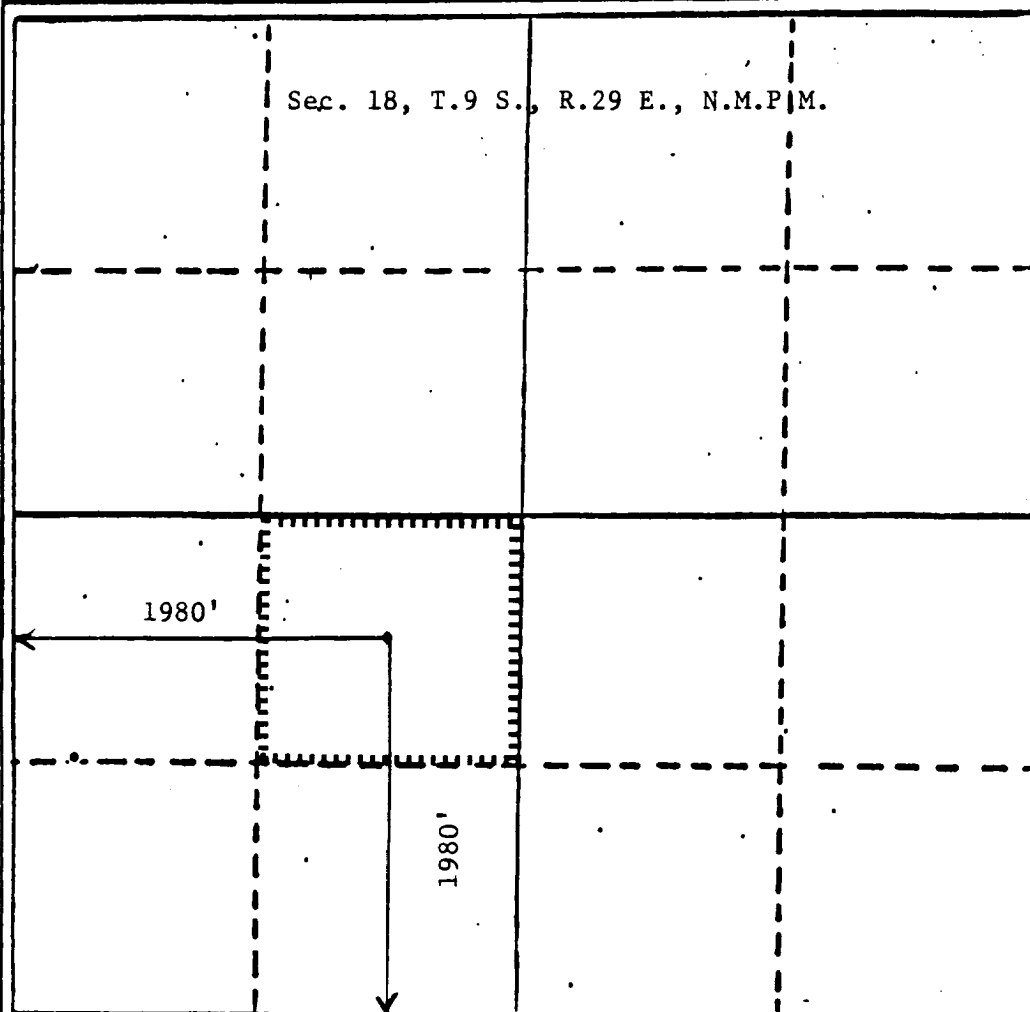

CERTIFICATION

I hereby certify that the information contained herein is true and complete to the best of my knowledge and belief.

Name \_\_\_\_\_

**C. L. Hardy**

Position \_\_\_\_\_

**Drilling & Production Mgr**

Company \_\_\_\_\_

**Petrus Operating Co., Inc**

Date \_\_\_\_\_

**January 16, 1985**

I hereby certify that the well location shown on this plat was plotted from field notes of actual surveys made by me or under my supervision, and that the same is true and correct to the best of my knowledge and belief.

Date Surveyed \_\_\_\_\_  
**December 26, 1984**

Investigator's name, address, telephone and e-mail \_\_\_\_\_

**John D. Jaques, Jr. E. & L.S.**

Certificate No. \_\_\_\_\_  
**6240**

