

UNITED STATES
DEPARTMENT OF THE INTERIOR
GEOLOGICAL SURVEYRECEIVED BY
30-605-62296
OCT 3 1985

5. LAND DESIGNATION AND SERIAL NO.

NM-27071

6. IF INDIAN ALLOTTEE OR TRIBE NAME

C. C. D.

ARTESIA, OFFICE

7. UNIT AGREEMENT NAME

8. FARM OR LEASE NAME

Ann Federal

9. WELL NO.

1

10. FIELD AND POOL, OR WILDCAT

Wildcat - San Andres

11. SEC., T., R., M., OR BLK.
AND SURVEY OR AREA

Sec. 23-T15S-R29E

12. COUNTY OR PARISH 13. STATE

Chaves

New Mexico

APPLICATION FOR PERMIT TO DRILL, DEEPEN, OR PLUG BACK

1a. TYPE OF WORK

DRILL ☒DEEPEN ☐PLUG BACK ☐

b. TYPE OF WELL

OIL WELL ☒GAS WELL ☐

OTHER

SINGLE ZONE ☐MULTIPLE ZONE ☐

2. NAME OF OPERATOR

McClellan Oil Corporation ✓

3. ADDRESS OF OPERATOR

P. O. Dr. 730 Roswell, New Mexico 88202

4. LOCATION OF WELL (Report location clearly and in accordance with any State requirements.)*

At surface

660' FNL & 1980' FWL

At proposed prod. zone

Same

14. DISTANCE IN MILES AND DIRECTION FROM NEAREST TOWN OR POST OFFICE*

14 miles north of Loco Hills, New Mexico

15. DISTANCE FROM PROPOSED*

LOCATION TO NEAREST
PROPERTY OR LEASE LINE, FT.
(Also to nearest drlg. unit line, if any)

660'

16. NO. OF ACRES IN LEASE

80

17. NO. OF ACRES ASSIGNED
TO THIS WELL

40

18. DISTANCE FROM PROPOSED LOCATION*
TO NEAREST WELL, DRILLING, COMPLETED,
OR APPLIED FOR, ON THIS LEASE, FT.

N/A

19. PROPOSED DEPTH

3900'

20. ROTARY OR CABLE TOOLS

Rotary

21. ELEVATIONS (Show whether DF, RT, GR, etc.)

3908 GL

22. APPROX. DATE WORK WILL START*

11/15/85

23.

PROPOSED CASING AND CEMENTING PROGRAM

SIZE OF HOLE	SIZE OF CASING	WEIGHT PER FOOT	SETTING DEPTH	QUANTITY OF CEMENT
10 3/4" / 2 1/2"	8 5/8"	24#	400'	250 Sx Cl "C" Circulate
7 7/8"	4 1/2"	10.5#	3900'	500 Sx Cl. "C"

Propose to drill to approximately 3900 feet in order to test the San Andres formation. If production is indicated will run the 4 1/2" production casing and attempt completion.

Mud Program: Drill the surface hole with fresh water to 400 feet. Will then drill out from the surface casing to total depth with cut brine water. Will sweep hole with viscous mud for logs.

BOP Program: Will use 10" Series 900 Type "E" Shaffer double hydraulic 6000 psi test, 3000 psi working pressure blowout preventer. The BOP will be installed while rigging up and be used full time. See Exhibit "E".

IN ABOVE SPACE DESCRIBE PROPOSED PROGRAM: If proposal is to deepen or plug back, give data on present productive zone and proposed new productive zone. If proposal is to drill or deepen directionally, give pertinent data on subsurface locations and measured and true vertical depths. Give blowout preventer program, if any.

24.

Agent for:

SIGNED

George Smith

TITLE

McClellan Oil Corporation

DATE

October 1, 1985

(This space for Federal or State office use)

PERMIT NO.

APPROVAL DATE

APPROVED BY

S/Homer Meyer, Acting

TITLE

Area Manager

DATE

25 OCT 1985

CONDITIONS OF APPROVAL, IF ANY:

All distances must be from the outer boundaries of the Section.

Operator McClellan Oil Corp.		Lease Ann Federal		Well No. #1
Unit Letter C	Section 23	Township 15 South	Range 29 East	County Chaves
Actual Footage Location of Wells 1980 feet from the West line and 660 feet from the North line				
Ground Level Elev. 3908	Producing Formation San Andres		Pool Wildcat	Dedicated Acreage 40 Acres

1. Outline the acreage dedicated to the subject well by colored pencil or hatchure marks on the plat below.
2. If more than one lease is dedicated to the well, outline each and identify the ownership thereof (both as to working interest and royalty).
3. If more than one lease of different ownership is dedicated to the well, have the interests of all owners been consolidated by communitization, unitization, force-pooling, etc?

☐ Yes ☐ No If answer is "yes," type of consolidation _____

If answer is "no," list the owners and tract descriptions which have actually been consolidated. (Use reverse side of this form if necessary.) _____

No allowable will be assigned to the well until all interests have been consolidated (by communitization, unitization, forced-pooling, or otherwise) or until a non-standard unit, eliminating such interests, has been approved by the Division

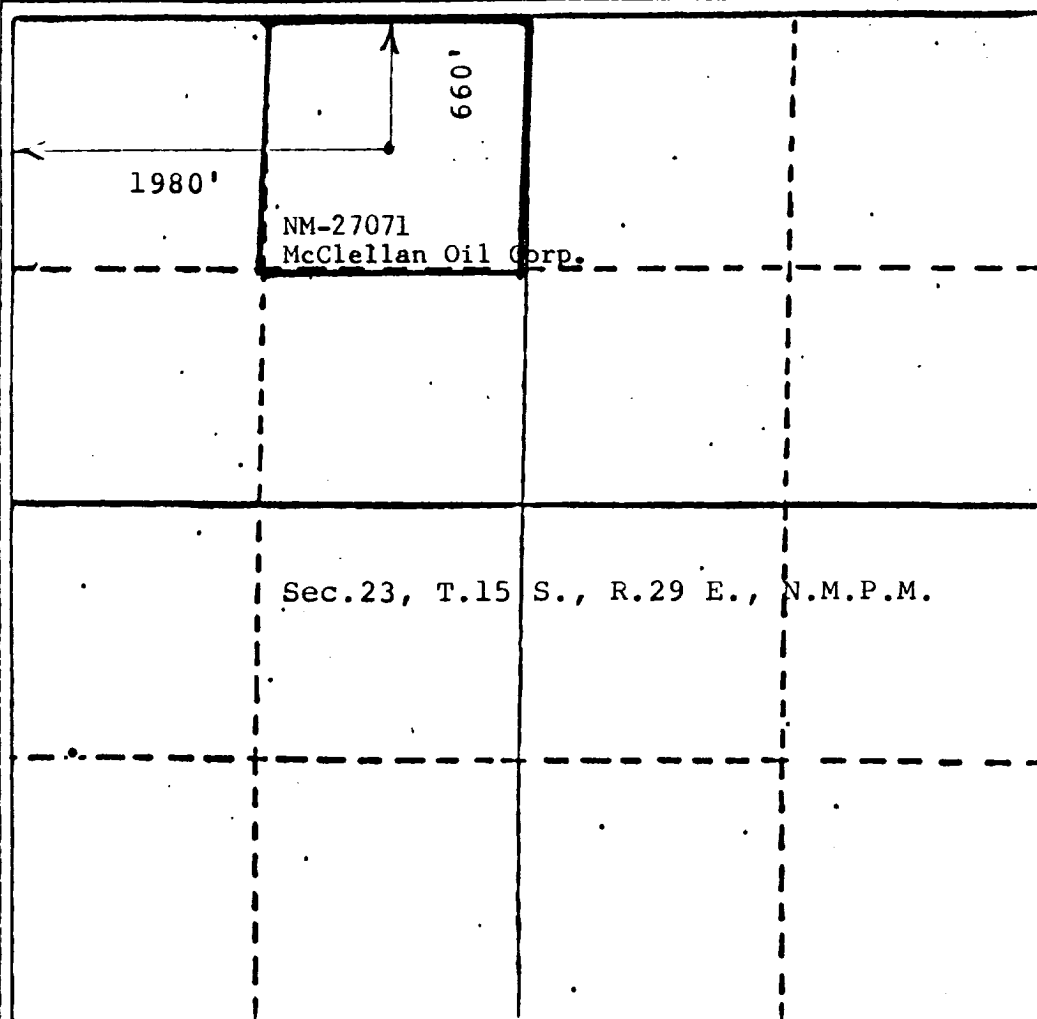

CERTIFICATION

I hereby certify that the information contained herein is true and complete to the best of my knowledge and belief.

George R. Smith

Name
George R. Smith

Position
Agent for

Company
McClellan Oil Corporation

Date

I hereby certify that the well location shown on this plat was plotted from field notes of actual surveys made by me or under my supervision, and that the same is true and correct to the best of my knowledge and belief.

Date Surveyed **September 23, 1985**

Registered Professional Engineer
and/or Land Surveyor

James D. Jones
James D. Jones, P.E. & L.S.

Certification No. **6296**

330 660 990 1320 1650 1980 2310 2640 2970 3300 3630 3960 4290 4620 4950 5280 5610 5940 6270 6600

BECK DRILLING CO., INC. - RIG 1 & 3
BLOWOUT PREVENTER SPECIFICATION

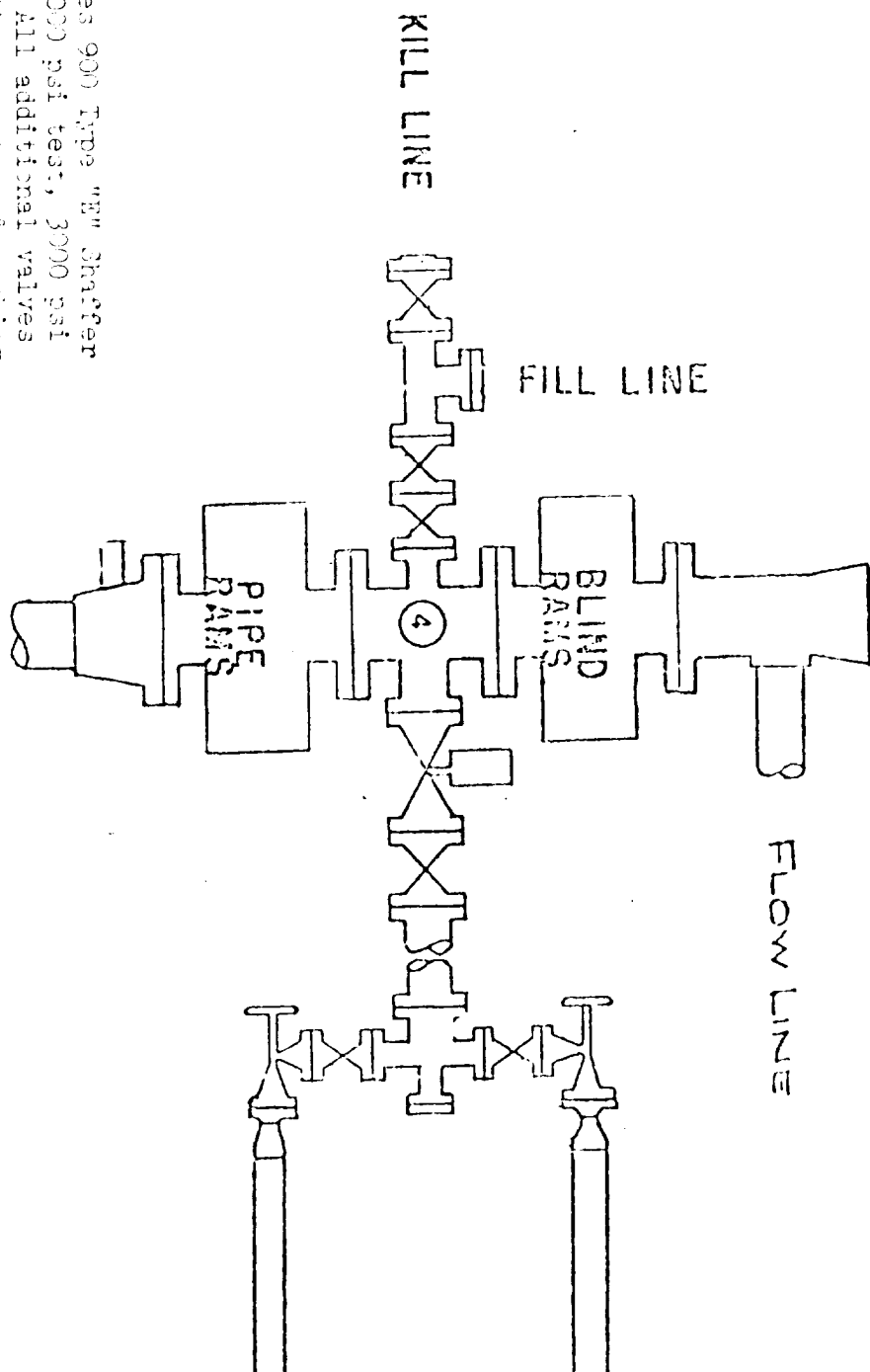

BOP's are 10" Series 900 Type "E" Chaffar Double Hydraulic 6000 psi test, 3000 psi working pressure. All additional valves & connections are the same test & working pressures.

APPLICATION FOR DRILLING

McCLELLAN OIL CORPORATION
Ann Federal, Well No. 1
660' FNL & 1980' FWL, Sec. 23-T15S-R29E
Chaves County, New Mexico
Lease No.: NM-27071
(Exploratory Well)

In conjunction with Form 9-331C, Application for Permit to Drill subject well, McClellan Oil Corporation submits the following items of pertinent information in accordance with BLM requirements:

1. The geologic surface formation is recent Permian with quaternary alluvium and other surficial deposits.

2. The estimated tops of geologic markers are as follows:

Salt	408'	Queen	1884'
Yates	1160'	San Andres	2552'
7-Rivers	1690'	T.D.	3900'

3. The estimated depth at which anticipated water, oil or gas formations are expected to encountered:

Water: Random fresh water sands from surface to 300'+/-.

Gas: None expected.

Oil: Possible in Queen at 1884'.
Possible in San Andres at 2552'

4. Proposed Casing Program: See Form 9-331C.
5. Pressure Control Equipment: See Form 9-331C and Exhibit "E".
6. Mud Program: See Form 9-331C.
7. Auxiliary Equipment: Blowout preventer, gas detector, kelly cock, pit level monitor, flow sensors and stabbing valves.
8. Testing, Logging and Coring Program:

Drill Stem Tests: None planned.

Logging: Dual Ind. Laterolog	Surf. Csg. to T.D.
Litho-Density Comp. Nuetron	Surf. Csg. to T.D.
Micro Log	Surf. Csg. to T.D.

Coring: None.

9. No abnormal pressures or temperatures are anticipated. In the event abnormal pressures are encountered the proposed mud program will be modified to increase the mud weight.
10. Anticipated starting date: November 15, 1985.
Anticipated completion of drilling operations: Two weeks.

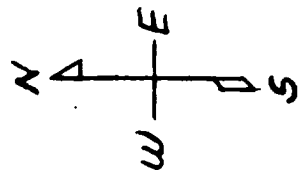

PLOT LAYOUT RIG 3
WEEK DRILLING

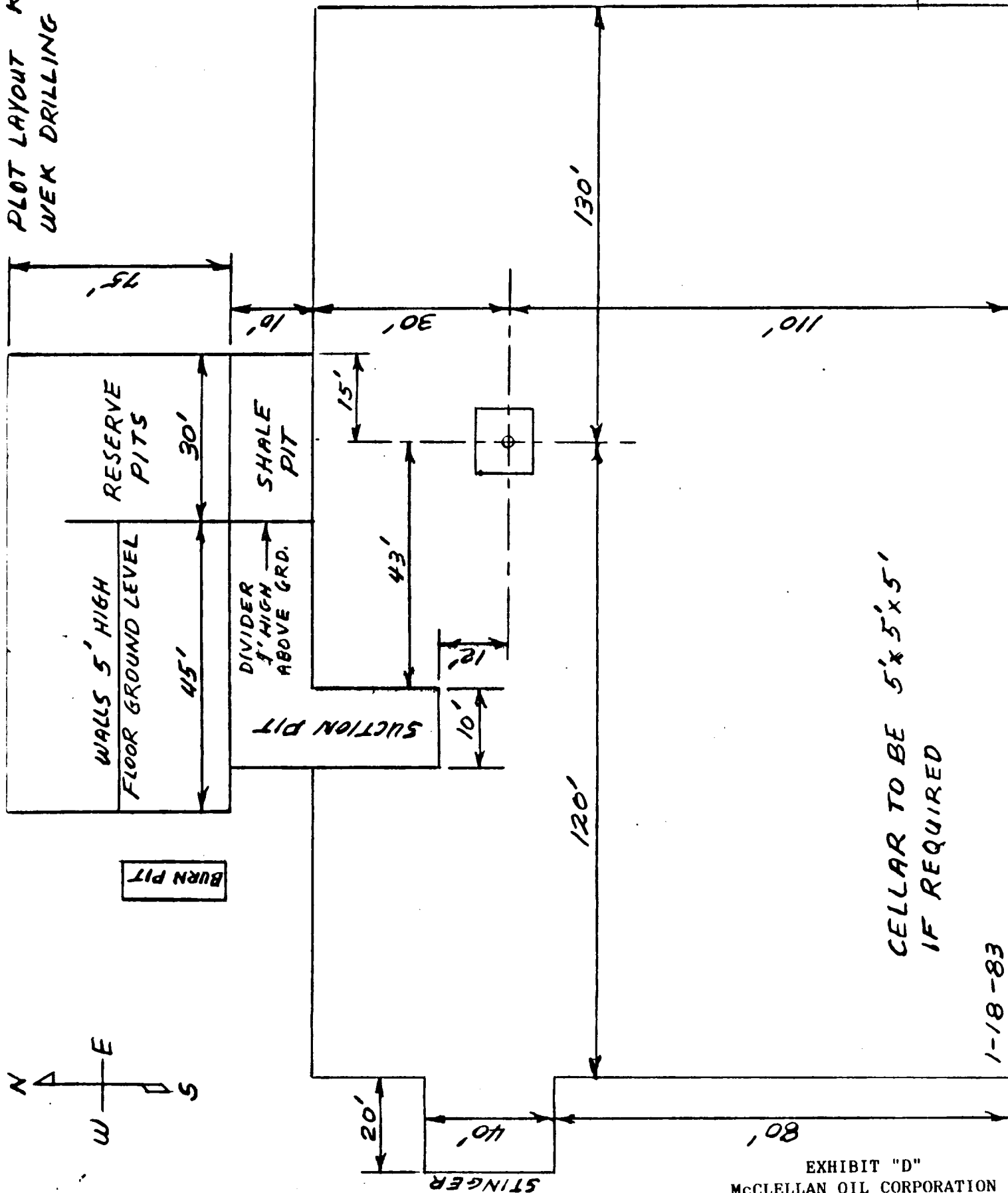

EXHIBIT "D"
McCLELLAN OIL CORPORATION
Ann Federal, Well No. 1
Rig Layout

1-18-83