

NO. OF COPIES RECEIVED	
DISTRIBUTION	
SANTA FE	<input checked="" type="checkbox"/>
FILE	<input checked="" type="checkbox"/>
U.S.G.S.	<input checked="" type="checkbox"/>
LAND OFFICE	<input checked="" type="checkbox"/>
OPERATOR	<input checked="" type="checkbox"/>

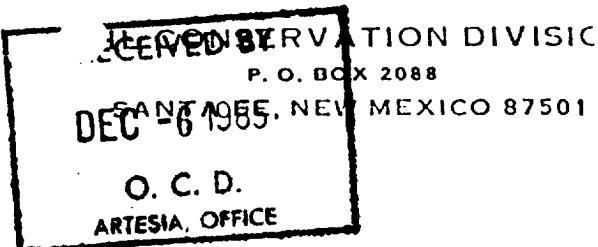

50-005-62508

Form C-101
Revised 10-1-78

5A. Indicate Type of Lease
STATE ☐ FEE ☒

5. State Oil & Gas Lease No.

7. Unit Agreement Name

8. Farm or Lease Name
China Draw Com.

9. Well No.
#4

10. Field and Pool, or Wildcat
West Pecos Slope

12. County
Chaves

APPLICATION FOR PERMIT TO DRILL, DEEPEN, OR PLUG BACK

1a. Type of Work
b. Type of Well
OIL WELL ☐ GAS WELL ☒ OTHER ☐
DRILL ☒ DEEPEN ☐ PLUG BACK ☐
SINGLE ZONE ☒ MULTIPLE ZONE ☐

2. Name of Operator
McKay Oil Corporation

3. Address of Operator
P.O. Box 2014, Roswell, New Mexico 88201

4. Location of Well
UNIT LETTER B LOCATED 960 FEET FROM THE North LINE
AND 1980 FEET FROM THE East LINE OF SEC. 31 TWP. 6S RGE. 23E NMPM

19. Proposed Depth
3400'

19A. Formation
Abo

20. Rotary or C.T.
Rotary

21. Elevations (Show whether DF, RT, etc.)
3995 GR

21A. Kind & Status Plug. Bond
Blanket

21B. Drilling Contractor
Grande Drilling Co.

22. Approx. Date Work will start
ASAP

23.

PROPOSED CASING AND CEMENT PROGRAM

SIZE OF HOLE	SIZE OF CASING	WEIGHT PER FOOT	SETTING DEPTH	SACKS OF CEMENT	EST. TOP
12 1/4"	8 5/8"	24.0 J-55	900±	850 cf	Surface
7 7/8"	4 1/2"	10.5 J-55	TD	1680 cf	circ.

1. Drill 12 1/4" hole to 900' and run 8 5/8" casing and cement to surface.
2. Wait on Cement for 24 hours.
3. Nipple up using Double Ram Blow Out Preventer and pressure test casing to 1000 psi for 30 minutes.
4. Drill 7 7/8" hole to 3400' to adequately test the Abo formation.
5. Run 4 1/2" casing if warranted or plug and abandoned as directed by the Oil Conservation Division of the Energy and Minerals Department.

Rec'd Dec 10 1985
12-13-85

APPROVAL VALID FOR 180 DAYS
DATE 6-10-86
DRILLING UNDERWAY

IN ABOVE SPACE DESCRIBE PROPOSED PROGRAM; IF PROPOSAL IS TO DEEPEN OR PLUG BACK, GIVE DATA ON PRESENT PRODUCTIVE ZONE AND PROPOSED NEW PRODUCTIVE ZONE. GIVE BLOWOUT PREVENTER PROGRAM, IF ANY.

I hereby certify that the information above is true and complete to the best of my knowledge and belief.

Signed James L. Schults Title Landman Date 12-4-85

(This space for State Use)

Original Signed By
Mike Williams

OIL AND GAS INSPECTOR

APPROVED BY Oil & Gas Inspector TITLE DATE DEC 10 1985

CONDITIONS OF APPROVAL, IF ANY:

All distances must be from the outer boundaries of the Section.

Operator McKay Oil Corp.		Lease China Draw Com.		Well No. #4
Unit Letter B	Section 31	Township 6 South	Range 23 East	County Chaves
Actual Well Location of Well				
960 feet from the North line and		1980 feet from the East line		
Ground Level Elev. 3995	Producing Formation Abo	Pool West Pecos Slope		Dedicated Acreage .160 Acres

- Outline the acreage dedicated to the subject well by colored pencil or hachure marks on the plat below.
- If more than one lease is dedicated to the well, outline each and identify the ownership thereof (both as to working interest and royalty).
- If more than one lease of different ownership is dedicated to the well, have the interests of all owners been consolidated by communitization, unitization, force-pooling, etc?

☒ Yes ☐ No If answer is "yes," type of consolidation _____ Designation of Pooled Unit _____
(Will be entered into)

If answer is "no," list the owners and tract descriptions which have actually been consolidated. (Use reverse side of this form if necessary.) _____

No allowable will be assigned to the well until all interests have been consolidated (by communitization, unitization, forced-pooling, or otherwise) or until a non-standard unit, eliminating such interests, has been approved by the Division

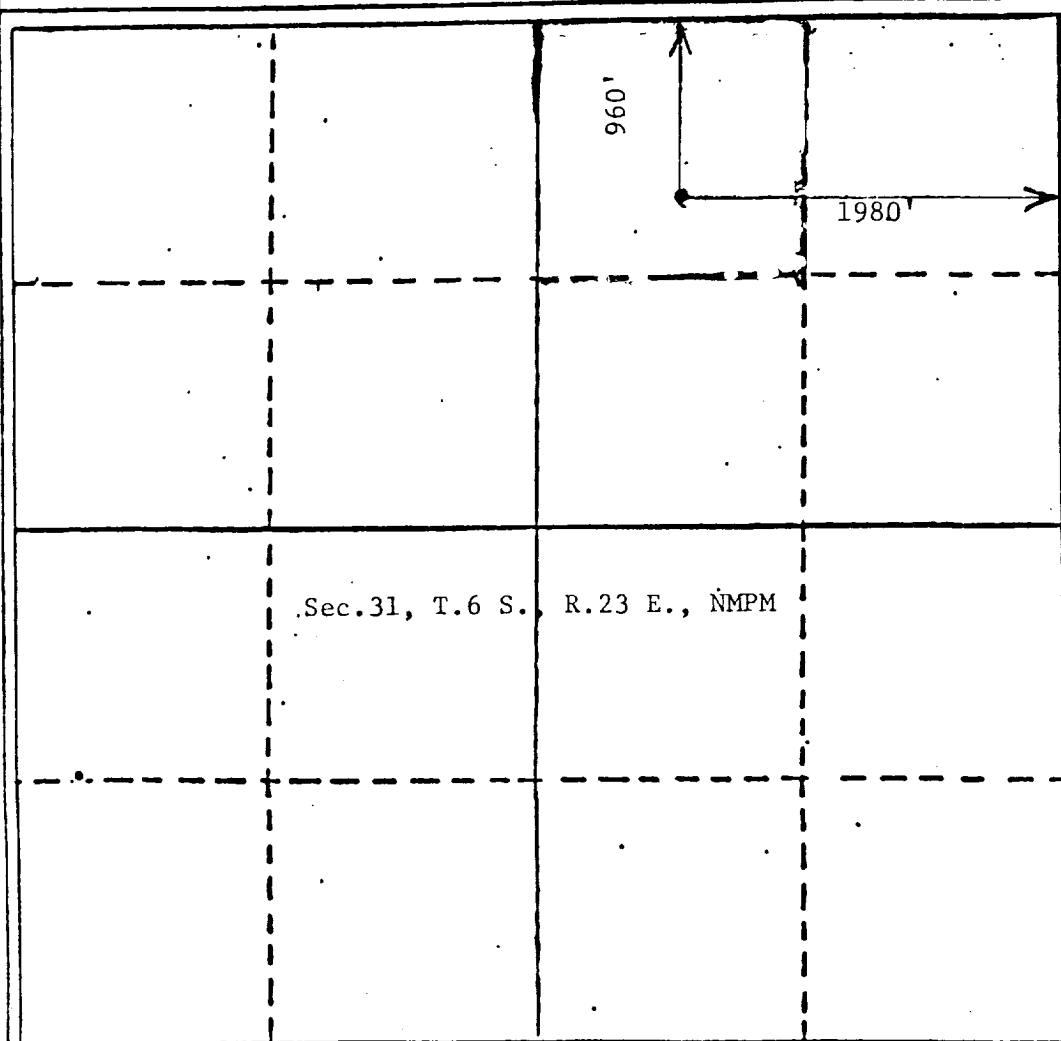

CERTIFICATION

I hereby certify that the information contained herein is true and complete to the best of my knowledge and belief.

James L. Schultz
Name
James L. Schultz

Position
Landman

Company
McKay Oil Corp.

Date
11-27-85

I hereby certify that the well location shown on this plat was plotted from field notes of actual surveys made by me or under my supervision, and that the same is true and correct to the best of my knowledge and belief.

Date Surveyed
November 26, 1985
Registered Professional Engineer
and/or Land Surveyor
JOHN D. JACQUES
Certificate No. 6290
NEW MEXICO
Professional Engineer
F. & L. S.

McKAY OIL CORPORATION
China Draw Com. #4
NW/4NE/4 Sec. 31-6S-23E
Chaves County, New Mexico

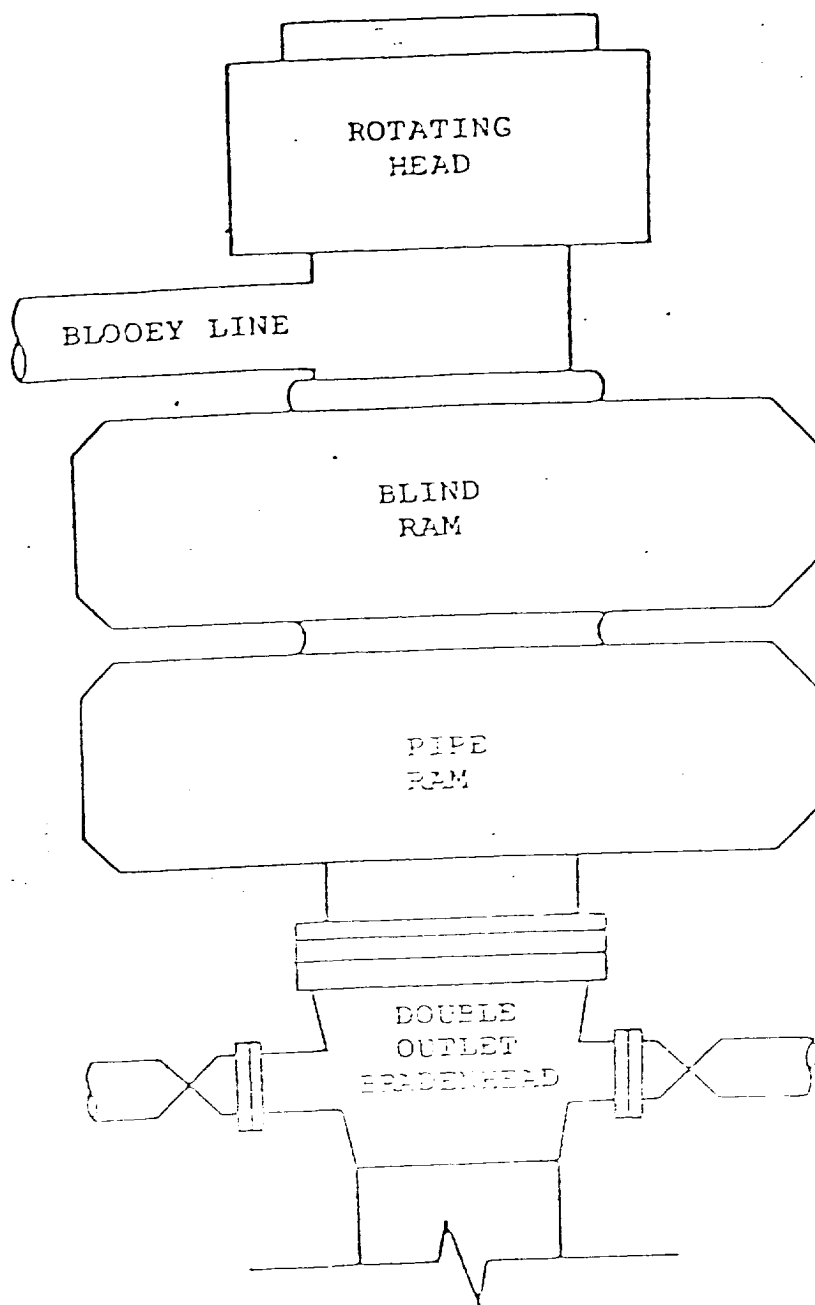

BOP STACK

3000 PSI WORKING PRESSURE

McKAY OIL CORPORATION
China Draw Com. #4
NW/4NE/4 Sec. 31-6S-23E
Chaves County, New Mexico

