

(November 1984)
(Formerly 9-331)

UNITED STATES
DEPARTMENT OF THE INTERIOR
BUREAU OF LAND MANAGEMENT

Interior DD

SUNDRY NOTICES AND REPORTS ON WELLS

(Do not use this form for proposals to drill or to deepen or plug back to a different reservoir.
Use "APPLICATION FOR PERMIT" for such proposals.)

1. OIL ☐ GAS ☒ OTHER ☐
WELL ☐ WELL ☒

2. NAME OF OPERATOR

McKay Oil Corporation

3. ADDRESS OF OPERATOR

P.O. Box 2014, Roswell, New Mexico 88202

4. LOCATION OF WELL (Report location clearly and in accordance with any State requirements.
See also space 17 below.)
At surface

1980' FWL & 1980' FSL

14. PERMIT NO.

15. ELEVATIONS (Show whether DF, RT, GR, etc.)

4243' GR

RECEIVED BY

APR -1 1987

O. C. D.

ARTESIA, OFFICE

LEASE DESIGNATION AND SERIAL

NM-32311

6. IF INDIAN, ALLOTTEE OR TRIBE NAME

7. UNIT AGREEMENT NAME

8. FARM OR LEASE NAME

Inexco Federal

9. WELL NO.

10. FIELD AND POOL OR WILDCAT

W. Pecos Slope-Abo

11. SEC., T., R., M., OR BLK. AND SURVEY OR AREA

Sec. 30, T5S, R22E

12. COUNTY OR PARISH; 13. STATE

Chaves

N.M.

16. Check Appropriate Box To Indicate Nature of Notice, Report, or Other Data

NOTICE OF INTENTION TO:

TEST WATER SHUT-OFF

FRACTURE TREAT

SHOOT OR ACIDIZE

REPAIR WELL

(Other)

PULL OR ALTER CASING

MULTIPLE COMPLETION

ABANDON*

CHANGE PLANS

SUBSEQUENT REPORT OF:

WATER SHUT-OFF

FRACTURE TREATMENT

SHOOTING OR ACIDIZING

(Other)

REPAIRING WELL

ALTERING CASING

ABANDONMENT*

(Note: Report results of multiple completion on Well Completion or Recompletion Report and Log form.)

17. TO BE PROPOSED OR COMPLETED OPERATIONS. Give pertinent details and give pertinent dates, including estimated date of starting any proposed work. If well is directionally drilled, give subsurface locations and measured and true vertical depths for all markers and zones pertinent to this work.*

Operator proposes to construct an access road 14' wide by approximately 1900' in as displayed on the enclosed topographic map. The proposed access road is a re-route due to an archaeological site on the original access road.

An archaeological survey was conducted on the proposed access road by ACA-ENMU, under report #F87-146.

Caliche pit for pad and access road: SE 1/4 Sec. 36, 55 N1E STATE
NE 1/4 Sec. 17, T6S, R23E, private, Bronson
Corn.

18. I hereby certify that the foregoing is true and correct

SIGNED

TITLE

Landman

DATE 2/25/87

(This space for Federal or State office use)

APPROVED BY

S/Phil Kirk

TITLE

Area Manager

DATE MAR 25 1987

CONDITIONS OF APPROVAL, IF ANY:

*See Instructions on Reverse Side

Title 18 U.S.C. Section 1001, makes it a crime for any person knowingly and willfully to make to any department or agency of the United States any false, fictitious or fraudulent statements or representations as to any matter within its jurisdiction.

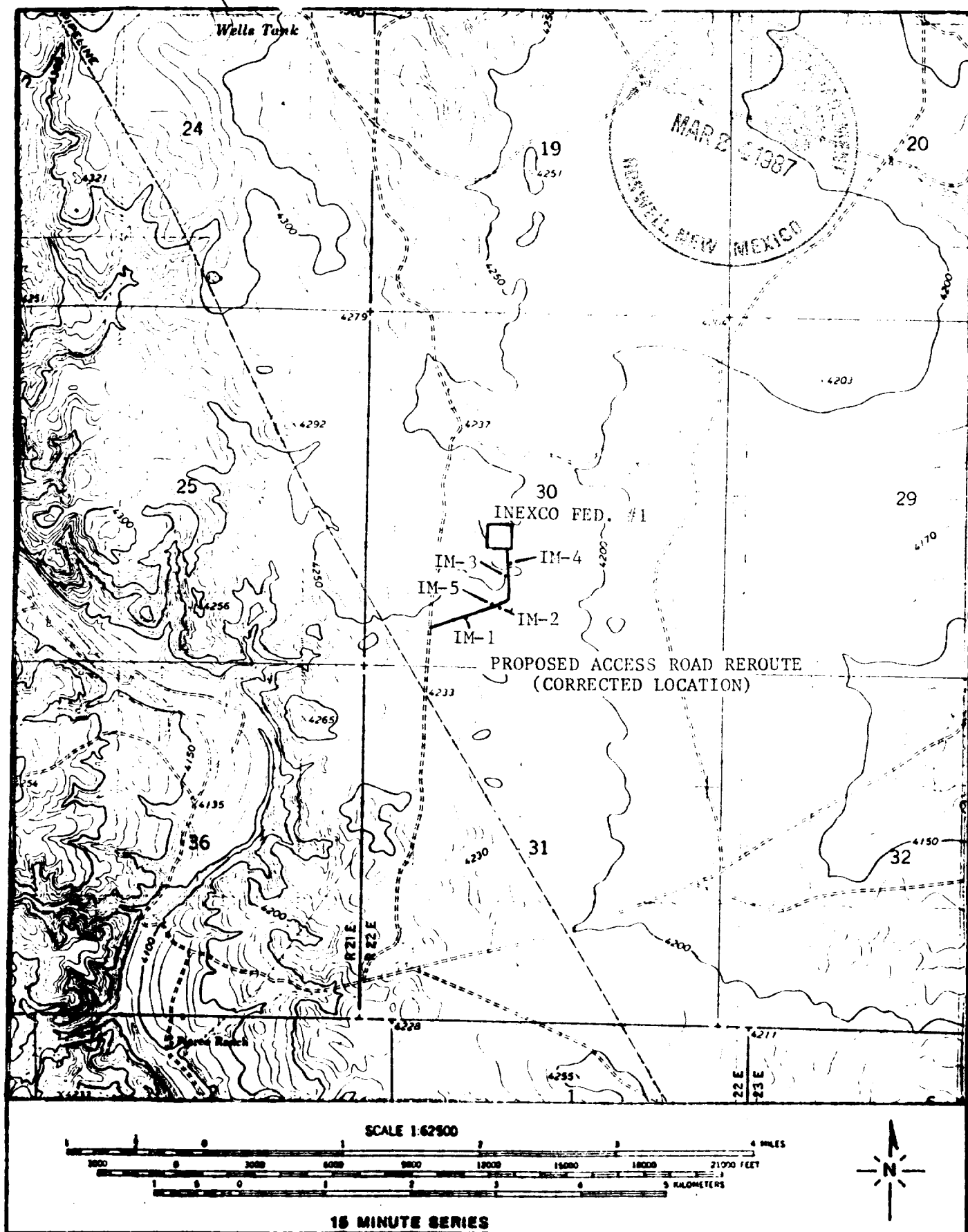

Figure 1a: Location of corrected proposed access road reroute to Inexco Fed. #1.

Map Reference: USGS Mesa SW, N. Mex. Quadrangle, 1967 photorevised 1982.