

UNITED STATES  
DEPARTMENT OF THE INTERIOR  
BUREAU OF LAND MANAGEMENT  
Form 100-1 (Rev. 1-6-74)  
(Other Instructions on Reverse Side)  
Comm. 100

Expires April 1, 1985  
5. LEASE DESIGNATION AND SERIAL NO.  
NM-32311  
6. IF INDIAN, ALLOTTEE OR TRIBE NAME

**SUNDRY NOTICES AND REPORTS ON WELLS** 88210

(Do not use this form for proposals to drill or to deepen or plug back to a different reservoir.  
Use "APPLICATION FOR PERMIT" for such proposals.)

1. OIL WELL <input type="checkbox"/> GAS WELL <input checked="" type="checkbox"/> OTHER <input type="checkbox"/>	7. UNIT AGREEMENT NAME
2. NAME OF OPERATOR	8. FARM OR LEASE NAME
3. ADDRESS OF OPERATOR McKay Oil Corporation P.O. Box 2014, Roswell, New Mexico 88202	9. WELL NO. 7
4. LOCATION OF WELL (Report location clearly and in accordance with any State requirements. See also space 17 below.) At surface 660' FSL & 1650' FEL	10. FIELD AND POOL OR WILDCAT W. Pecos Slope Abo
11. SEC., T., R., N., OR S.E., AND SURVEY OR AREA Sec. 24, T5S, R21E	12. COUNTY OR PARISH Chaves
13. STATE NM	
14. PERMIT NO.	15. ELEVATIONS (Show whether DF, RT, GR, etc.) 4301' GR

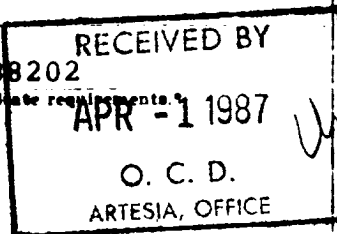

16. Check Appropriate Box To Indicate Nature of Notice, Report, or Other Data

NOTICE OF INTENTION TO:		SUBSEQUENT REPORT OF:	
TEST WATER SHUT OFF	PULL OR ALTER CASING	WATER SHUT OFF	REPAIRING WELL
FRAC TURE TREAT	MULTIPLE COMPLETION	FRAC TURE TREATMENT	ALTERING CASING
SHOOTING OR ACIDIZING	ABANDON*	SHOOTING OR ACIDIZING	ABANDONMENT*
REPAIR WELL	CHANGE PLANS	OTHER:	

17. \*Note: Report results of multiple completion on Well Completion or Recompletion Report and Log form.

18. I hereby certify that the foregoing is true and correct

19. SIGNATURE OF OPERATOR OR COMPLETER OF OPERATIONS (If well is directionally drilled, give subsurface locations and measured and true vertical depths for all markers and zones pertinent to this work.)

20. SIGNATURE OF BUREAU OF LAND MANAGEMENT REPRESENTATIVE

Operator proposes to construct an access road 14' wide by approximately 1100' in length as displayed on the enclosed topographic map.

The initial 100' of proposed access road is situated on federal surface('on lease'), and the remaining portion of the proposed access road is situated on private surface.

Operator-Landowner agreement is filed under the original Permit to Drill.

An archaeological survey on the proposed access road was conducted by ACA-ENMU, under report #F87-141.

*Caliche pit for pad & access road 50/4, Sec 36 55 (State)*

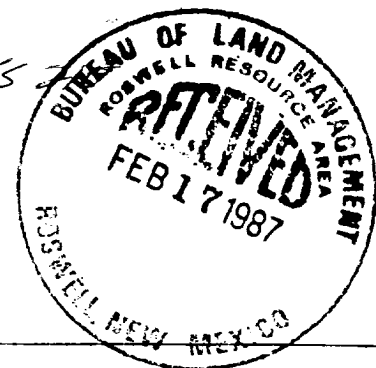

18. I hereby certify that the foregoing is true and correct

SIGNED Terry W. Franklin TITLE Landman DATE 2/16/87

(This space for Federal or State office use)

APPROVED BY S/Phil Kirk TITLE Area Manager DATE MAR 25 1987

CONDITIONS OF APPROVAL, IF ANY:

\*See Instructions on Reverse Side

10-1 1000 1000 1000 1000  
1000 1000 1000 1000  
1000 1000 1000 1000

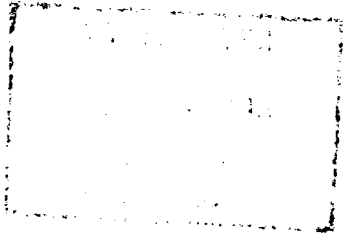

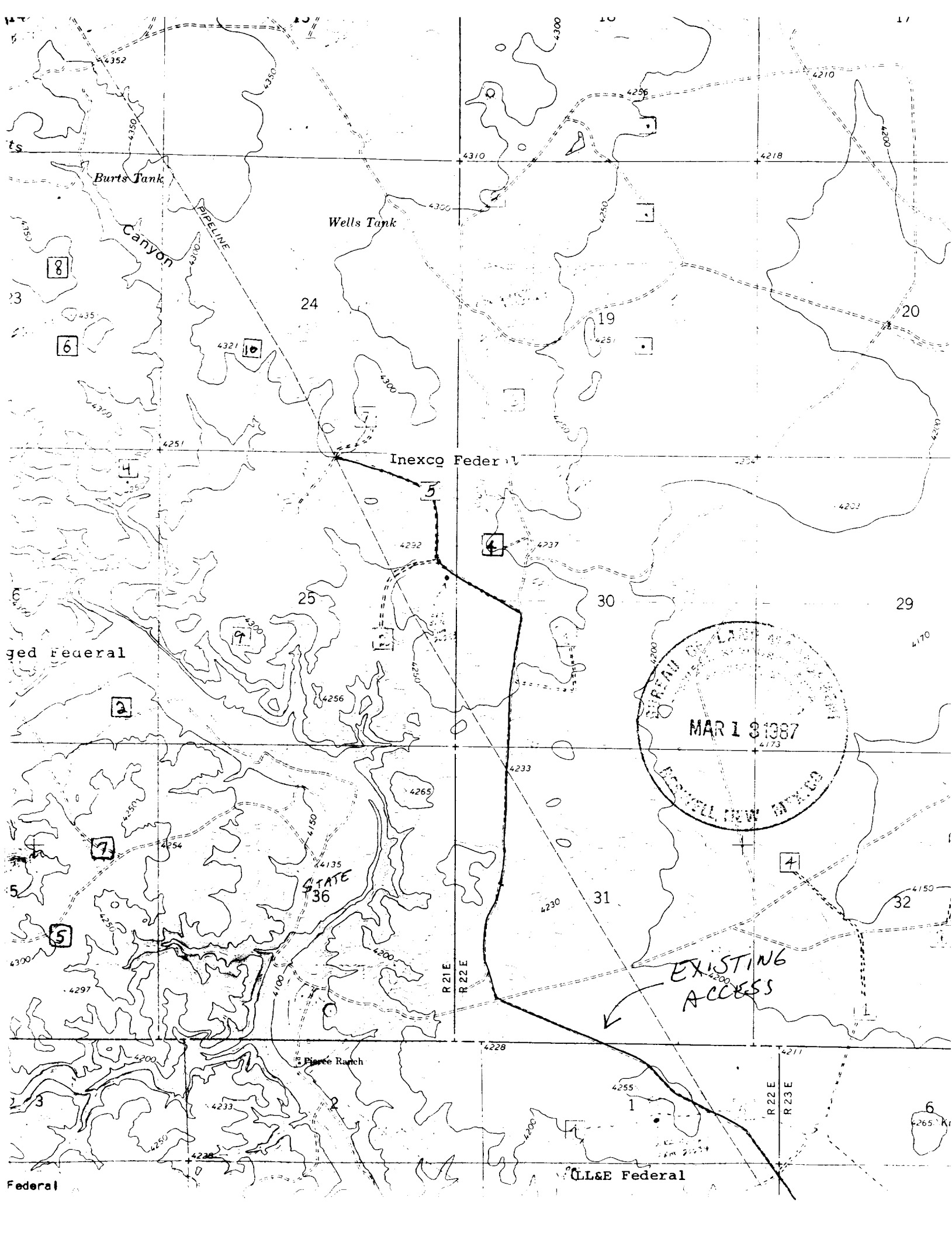

Burts Tank

Wells Tank

Canyon

PIPELINE

Inexco Federal

MAR 13 1987

BUREAU OF LAND MANAGEMENT  
MAR 13 1987  
MONTICELLO, NEW MEXICO

EXISTING ACCESS

STATE 36

Pierce Ranch

LL&E Federal

Federal

Lease No: NM-32311 Well Name and No. Inexco Federal #7  
Subdivision: SE 1/4 Section: 24 T. 5S R. 21E, NMPM  
County: Chaves State: NM  
McKay Oil Corporation intends to drill a well on surface owned by  
J.Y. Ranch, Inc.. The lessee/operator  
agrees to complete the following rehabilitation work if the well  
is a producer:

☒ Yes ☐ No Maintain access road and provide adequate  
drainage from road.  
☒ Yes ☐ No Reshape and seed any area not needed for  
maintenance of the production facilities.  
Other requirements: DRAINAGE ACROSS ROAD

The following work will be completed when the well is abandoned  
or dry hole:

WELL LOCATION

☒ Yes ☐ No Pit will be fenced until dry, then filled  
to conform to surrounding topography.  
☒ Yes ☐ No Water bars will be constructed as deemed  
necessary.  
☒ Yes ☐ No Site will require reshaping to conform to  
surrounding topography.  
☒ Yes ☐ No Entire disturbed area will be seeded with  
the following seed mixture: ALL NATIVE GRASSES

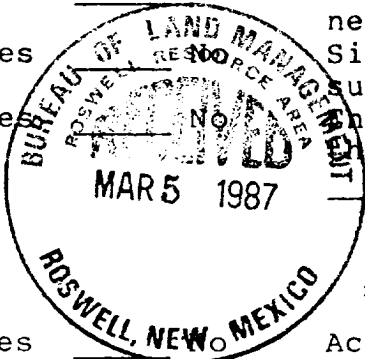

ACCESS ROAD

☒ Yes ☐ No Access road will be closed, rehabilitated  
and seeded using the same mixture as above.  
☒ Yes ☐ No Water bars will be constructed on the  
access road as deemed necessary.  
Other requirements: FOLLOW UP MAINTAINANCE SHOULD  
REHABILITATED AREA WASH OUT OR AWAY

SURFACE OWNER

Name: J.Y. Ranch, Inc.  
Address: P.O. Box 2421  
City: Roswell  
State: New Mexico  
Phone No.: 505-355-7942  
Date: \_\_\_\_\_

OPERATOR/LESSEE

Names: McKay Oil Corp.  
Address: P.O. Box 2014  
City: Roswell  
State: New Mexico  
Phone No.: 505/623-4735  
Date: \_\_\_\_\_

I CERTIFY rehabilitation has been discussed with me, the surface  
owner:

Charlie H. Lewis  
(Surface Owner's Signature)

The plan covers rehabilitation requirements only and does not  
affect any other agreements between the lessee/operator and sur-  
face owner.