

All distances must be from the outer boundaries of the Section.

Operator McKay Oil Corp.			Lease Ruffin State		Well No. #2
Unit Letter I	Section 28	Township 5 South	Range 22 East	County Chaves	
Actual Footage Location of Well: 990 feet from the East line and 1980 feet from the South line					
Ground Level Elev. 4154	Producing Formation Abo		Pool W. Pecos Slope Abo		Dedicated Acres 160

1. Outline the acreage dedicated to the subject well by colored pencil or hatchure marks on the plat below.
2. If more than one lease is dedicated to the well, outline each and identify the ownership thereof (both as to working interest and royalty).
3. If more than one lease of different ownership is dedicated to the well, have the interests of all owners been consolidated by communitization, unitization, force-pooling, etc?

☐ Yes ☐ No If answer is "yes," type of consolidation \_\_\_\_\_

If answer is "no," list the owners and tract descriptions which have actually been consolidated. (Use reverse side of this form if necessary.) \_\_\_\_\_

No allowable will be assigned to the well until all interests have been consolidated (by communitization, unitization, forced-pooling, or otherwise) or until a non-standard unit, eliminating such interests, has been approved by the Division.

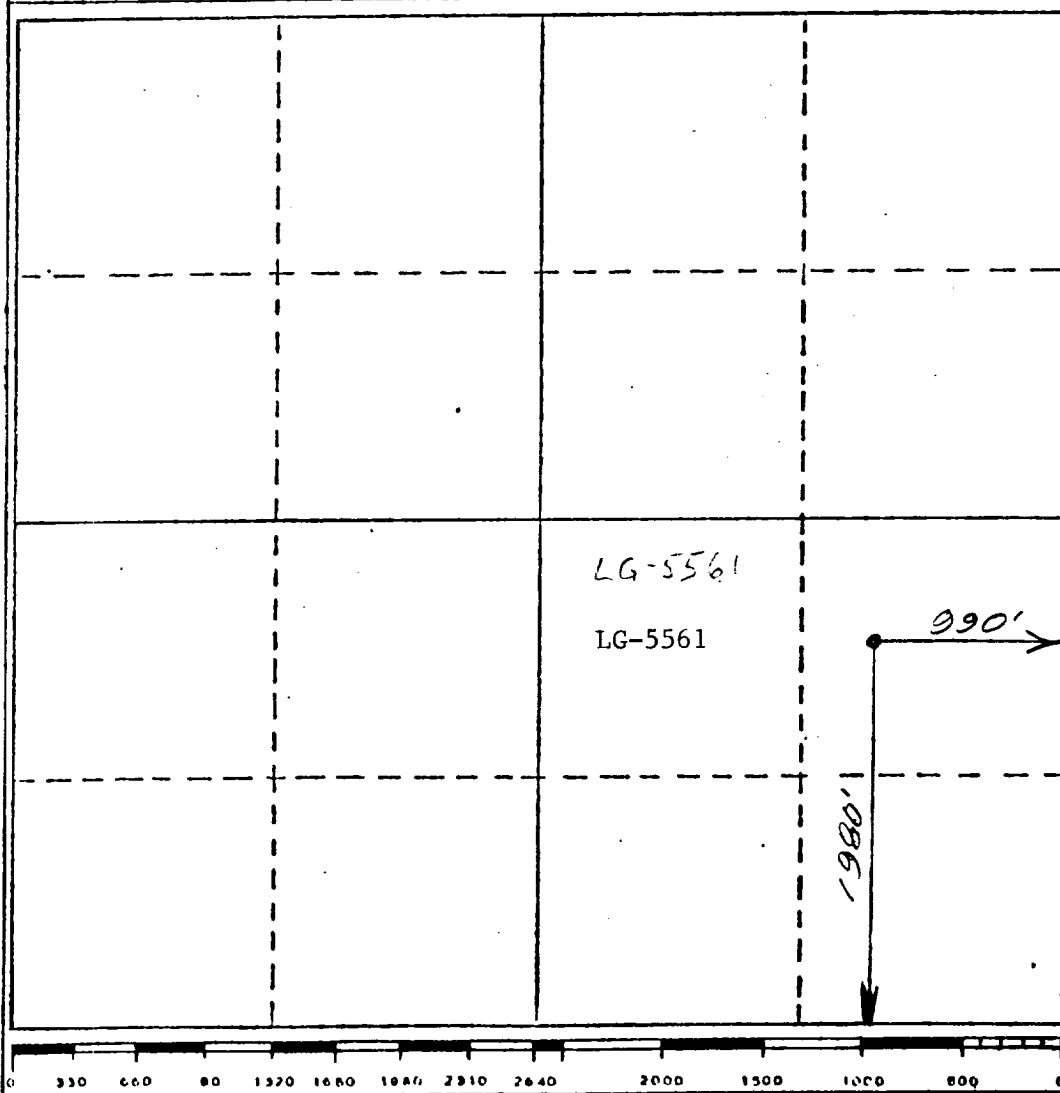

CERTIFICATION

I hereby certify that the information contained herein is true and complete to the best of my knowledge and belief.

Name  
Sam L. Shackelford

Position  
Agent

Company  
McKay Oil Corp.

Date  
3-3-87

I hereby certify that the well location shown on this plat was plotted from field notes of actual surveys made by me or under my supervision, and that the same is true and correct to the best of my knowledge and belief.

JOHN D. JAQUESS  
NEW MEXICO  
January 27, 1987  
6290  
Registered Professional Engineer  
and/or Land Surveyor  
John D. Jaquess  
Professional Engineer & L.S.  
Certificate No. 6290