

All distances must be from the outer boundaries of the Section.

Operator McKay Oil Corp.			Lease Rugged Federal		Well No. #6
Unit Letter J	Section 23	Township 5 South	Range 21 East	County Chaves	
Actual Postage Location of Well: 1850 feet from the South line and 1650 feet from the East line					
Ground Level Elev. 4341	Producing Formation Abo		Pool W. Pecos Slope		Dedicated Acreage: 160 Acres

1. Outline the acreage dedicated to the subject well by colored pencil or hatchure marks on the plat below.
2. If more than one lease is dedicated to the well, outline each and identify the ownership thereof (both as to working interest and royalty).
3. If more than one lease of different ownership is dedicated to the well, have the interests of all owners been consolidated by communitization, unitization, force-pooling, etc?

☐ Yes ☐ No If answer is "yes," type of consolidation \_\_\_\_\_

If answer is "no," list the owners and tract descriptions which have actually been consolidated. (Use reverse side of this form if necessary.) \_\_\_\_\_

No allowable will be assigned to the well until all interests have been consolidated (by communitization, unitization, forced-pooling, or otherwise) or until a non-standard unit, eliminating such interests, has been approved by the Division \_\_\_\_\_

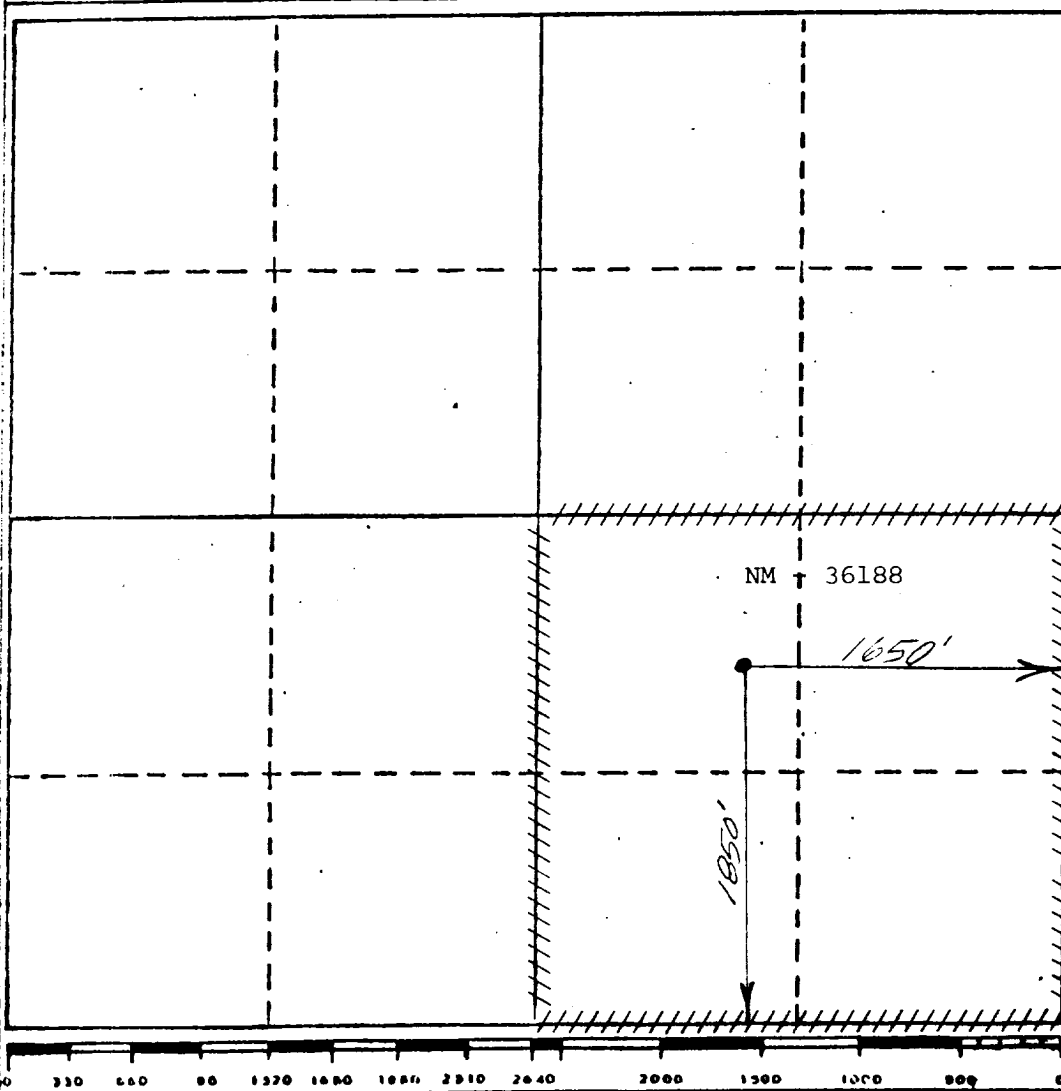

#### CERTIFICATION

I hereby certify that the information contained herein is true and complete to the best of my knowledge and belief.

*Terry W. Franklin*

Name  
Terry W. Franklin  
Position  
Agent  
Company  
McKay Oil Corporation  
Date  
2/20/87

I hereby certify that the well location shown on this plat was plotted from field notes of actual surveys made by me or under my supervision, and that the same is true and correct to the best of my knowledge and belief.

JOHN D. JAQUES  
Data Surveyed  
January 20, 1987  
Registered Professional Engineer  
and/or Land Surveyor  
John D. Jaques  
Professional Engineer & L.S.  
Certificate No. 6290