

NO. OF COPIES RECEIVED	
DISTRIBUTION	
SANTA FE	<input checked="" type="checkbox"/>
FILE	<input checked="" type="checkbox"/>
U.S.G.S.	<input checked="" type="checkbox"/>
LAND OFFICE	<input checked="" type="checkbox"/>
OPERATOR	<input checked="" type="checkbox"/>

NEW MEXICO OIL CONSERVATION COMMISSION

30-005-62572
Form C-101
Revised 1-1-65

DEC 09 '87

O. C. D.
ARTESIA, OFFICE

5A. Indicate Type of Lease STATE <input checked="" type="checkbox"/> FEE <input type="checkbox"/>
5. State Oil & Gas Lease No. IG-7425

APPLICATION FOR PERMIT TO DRILL, DEEPEN, OR PLUG BACK

a. Type of Work

b. Type of Well
DRILL ☒ DEEPEN ☐ PLUG BACK ☐

c. Name of Operator
Hanson Operating Company, Inc.

d. Address of Operator
P. O. Box 1515, Roswell, New Mexico 88202-1515

e. Location of Well
UNIT LETTER E LOCATED 1650 FEET FROM THE North LINE

f. Location of Well
330 FEET FROM THE West LINE OF SEC. 27 TWP. 10S RGE. 27E NMPM

7. Unit Agreement Name
N/A

8. Farm or Lease Name
Hanlad State Battery #2

9. Well No.
8

10. Field and Pool, or Wildcat
Diablo San Andres

12. County
Chaves

1. Elevations (Show whether DF, RT, etc.) 3835' GR	21A. Kind & Status Plug. Bond Statewide	19. Proposed Depth 2150'	19A. Formation San Andres	20. Rotary or C.T. Cable Tool
21B. Drilling Contractor N/A		22. Approx. Date Work will start January, 1988		

PROPOSED CASING AND CEMENT PROGRAM

SIZE OF HOLE	SIZE OF CASING	WEIGHT PER FOOT	SETTING DEPTH	SACKS OF CEMENT	EST. TOP
12-1/4"	8-5/8"	24#	500'	150	Circulate
8"	5-1/2"	15#	2150'	450	Circulate

It is proposed to drill the above-mentioned well with cable tools to a depth sufficient to test the San Andres formation. If commercial production is indicated, pipe would be set. The well will be perforated and stimulated as needed.

1007-1040
1117-1040
1211-1040

12/08/87
Mike Williams
UNDERWAY

ABOVE SPACE DESCRIBE PROPOSED PROGRAM: IF PROPOSAL IS TO DEEPEN OR PLUG BACK, GIVE DATA ON PRESENT PRODUCTIVE ZONE AND PROPOSED NEW PRODUCTIVE ZONE. GIVE BLOWOUT PREVENTER PROGRAM, IF ANY.

I hereby certify that the information above is true and complete to the best of my knowledge and belief.

Signed Brenda L. Godfrey Title Production Analyst Date 12/08/87

(This space for State Use)

Original Signed By
Mike Williams

APPROVED BY _____ TITLE _____ DATE _____

CONDITIONS OF APPROVAL, IF ANY:

DEC 9 1987

OIL CONSERVATION DIVISION

STATE OF NEW MEXICO
ENERGY AND MINERALS DEPARTMENT.

P. O. BOX 2088

SANTA FE, NEW MEXICO 31111

Form C-102
Revised 10-1-79

All distances must be from the outer boundaries of the Section.

Operator Hanson Operating Company			Lease Hanlad State Battery #2		Well No. 8
Unit Letter E	Section 27	Township 10 South	Range 27 East	County Chaves	
Actual Footage Location of Well: 1650 feet from the North line and 330 feet from the West line					
Ground Level Elev. 3835	Producing Formation San Andres		Pool Diablo San Andres		Dedicated Acreage: 4.20 Acres

1. Outline the acreage dedicated to the subject well by colored pencil or hachure marks on the plat below.

2. If more than one lease is dedicated to the well, outline each and identify the ownership thereof (both as to working interest and royalty).

3. If more than one lease of different ownership is dedicated to the well, have the interests of all owners been consolidated by communitization, unitization, force-pooling, etc?

☐ Yes ☐ No If answer is "yes," type of consolidation _____

If answer is "no," list the owners and tract descriptions which have actually been consolidated. (Use reverse side of this form if necessary.) _____

No allowable will be assigned to the well until all interests have been consolidated (by communitization, unitization, forced-pooling, or otherwise) or until a non-standard unit, eliminating such interests, has been approved by the Division.

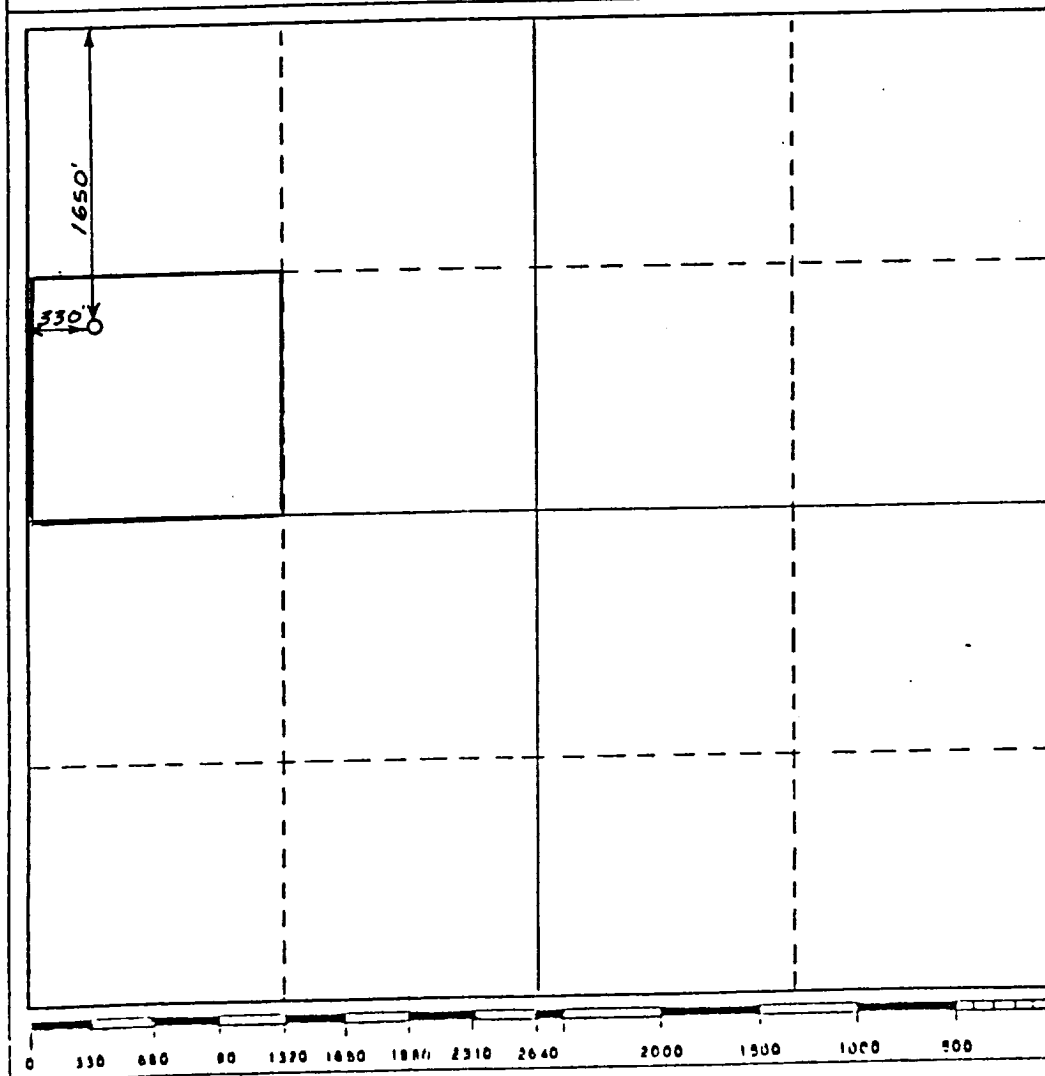

CERTIFICATION

I hereby certify that the information contained herein is true and complete to the best of my knowledge and belief.

Brenda R. Godfrey
Name

Brenda R. Godfrey
Position

Production Analyst
Company

Hanson Operating Company, Inc.
Date

December 8, 1987

I hereby certify that the well location shown on this plat was plotted from field notes of actual surveys made by me or under my supervision, and that the same is true and correct to the best of my knowledge and belief.

December 8, 1987

Date Surveyed
P. R. Patton

Registered Land Surveyor
8112

Certificate No.

