

NO. OF COPIES RECEIVED	
DISTRIBUTION	
SANTA FE	<input checked="" type="checkbox"/>
FILE	<input checked="" type="checkbox"/>
U.S.G.S.	<input checked="" type="checkbox"/>
LAND OFFICE	<input checked="" type="checkbox"/>
OPERATOR	<input checked="" type="checkbox"/>

NEW MEXICO OIL CONSERVATION COMMISSION

APR 05 '88

O. C. D.

ARTESIA, OFFICE

30-005-62608  
Form C-101  
Revised 1-1-65

5A. Indicate Type of Lease STATE <input type="checkbox"/> FEE <input checked="" type="checkbox"/>
5. State Oil & Gas Lease No. Fee
7. Unit Agreement Name
8. Farm or Lease Name Sand Creek 23
9. Well No. 1
10. Field and Pool, or Wildcat Pecos Slope Abo
12. County Chaves
19. Proposed Depth 4850'
19A. Formation Abo
20. Rotary or C.T. Rotary
21. Elevations (Show whether DF, RI, etc.) 3813 GL
21A. Kind & Status Plug. Bond Blanket
21B. Drilling Contractor WEK
22. Approx. Date Work will start May 1, 1988

APPLICATION FOR PERMIT TO DRILL, DEEPEN, OR PLUG BACK

1a. Type of Work b. Type of Well OIL WELL <input type="checkbox"/> GAS WELL <input checked="" type="checkbox"/> OTHER <input type="checkbox"/> DRILL <input checked="" type="checkbox"/> DEEPEN <input type="checkbox"/> PLUG BACK <input type="checkbox"/> SINGLE ZONE <input type="checkbox"/> MULTIPLE ZONE <input type="checkbox"/>	2. Name of Operator Ensourage, Inc.	3. Address of Operator 3000 N. Garfield, Suite 265 Midland, TX 79705-6414
4. Location of Well UNIT LETTER N LOCATED 660' FEET FROM THE south LINE AND 1980' FEET FROM THE west LINE OF SEC. 23 TWP. 7S RGE. 26E NADPM	19. Proposed Depth 4850'	19A. Formation Abo
21. Elevations (Show whether DF, RI, etc.) 3813 GL	21A. Kind & Status Plug. Bond Blanket	21B. Drilling Contractor WEK
22. Approx. Date Work will start May 1, 1988		

PROPOSED CASING AND CEMENT PROGRAM

SIZE OF HOLE	SIZE OF CASING	WEIGHT PER FOOT	SETTING DEPTH	SACKS OF CEMENT	EST. TOP
12 1/4"	8 5/8"	23#	950'	400 sx "C"	circ. to surf.
8 5/8"	4 1/2"	10.5#	4850'	350 sx "C"	cover formation

**Mud Program:** Will drill to top of Abo with fresh water and native mud. Will mud up 100' above Abo with 9.5 lb/gal wt., 40 viscosity mud and 15 cc water loss.

**BOP Specification:** Will install and test daily a 3000# wp Shaffer Type E double hydraulic BOP with 4" pipe and blind rams with koomeg closing unit.

Gas not dedicated.

POST 1D-1  
NL & API  
4-15-88

180  
10/13/88

IN ABOVE SPACE DESCRIBE PROPOSED PROGRAM: IF PROPOSAL IS TO DEEPEN OR PLUG BACK, GIVE DATA ON PRESENT PRODUCTIVE ZONE AND PROPOSED NEW PRODUCTIVE ZONE. GIVE BLOWOUT PREVENTER PROGRAM, IF ANY.

I hereby certify that the information above is true and complete to the best of my knowledge and belief.

Signed George Smith Title Ensourage, Inc. Date April 4, 1988

(This space for State Use)

Original Signed By  
Mike Williams

APPROVED BY Oil & Gas Inspector TITLE DATE APR 13 1988

CONDITIONS OF APPROVAL, IF ANY

All distances must be from the outer boundaries of the Section.

Operator <b>Ensorce, Inc.</b>			Lease <b>Sand Creek "23"</b>		Well No. <b>1</b>
Unit Letter <b>N</b>	Section <b>23</b>	Township <b>7 South</b>	Range <b>26 East</b>	County <b>Chaves</b>	
Actual Footage Location of Well: <b>660</b> feet from the <b>South</b> line and <b>1980</b> feet from the <b>West</b> line					
Ground Level Elev. <b>3813</b>	Producing Formation <b>Abo</b>		Pool <b>Pecos Slope Abo</b>		Dedicated Acreage: <b>160</b> Acres

1. Outline the acreage dedicated to the subject well by colored pencil or hatchure marks on the plat below.
2. If more than one lease is dedicated to the well, outline each and identify the ownership thereof (both as to working interest and royalty).
3. If more than one lease of different ownership is dedicated to the well, have the interests of all owners been consolidated by communitization, unitization, force-pooling, etc?

☐ Yes ☐ No If answer is "yes," type of consolidation \_\_\_\_\_

If answer is "no," list the owners and tract descriptions which have actually been consolidated. (Use reverse side of this form if necessary.) \_\_\_\_\_

No allowable will be assigned to the well until all interests have been consolidated (by communitization, unitization, forced-pooling, or otherwise) or until a non-standard unit, eliminating such interests, has been approved by the Division

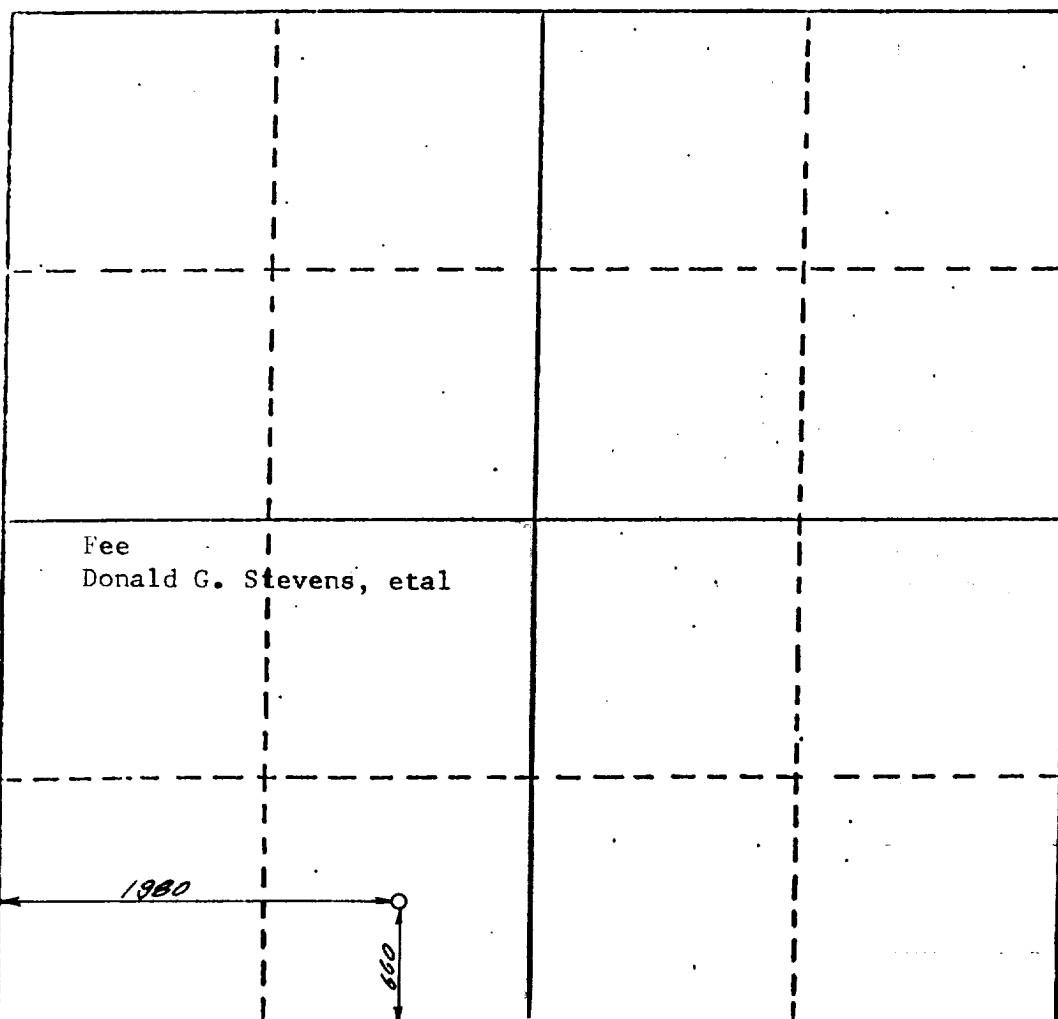

CERTIFICATION

I hereby certify that the information contained herein is true and complete to the best of my knowledge and belief.

Name  
**George R. Smith**  
Position  
**Agent for:**  
Company  
**Ensorce, Inc.**  
Date  
**April 4, 1988**

I hereby certify that the well location shown on this plat was plotted from field notes of actual surveys made by me or under my supervision, and that the same is true and correct to the best of my knowledge and belief.

**23 March 1988**  
Date Surveyed  
**P. R. Patton**  
Registered Professional Engineer  
and/or Land Surveyor  
**8112**  
Certificate No.

