

All distances must be from the outer boundaries of the Section.

Operator McKay Oil Corp.		Lease West Fork Federal Unit		Well No. #10
Unit Letter K	Section 6	Township 5 South	Range 22 East	County Chaves
Actual Footage Location of Well: 1980 feet from the South line and 1980 feet from the West line				
Ground Level Elev. 4357	Producing Formation Abo		Pool W. Pecos Slope-Abo	Dedicated Acreage 160 Ac

1. Outline the acreage dedicated to the subject well by colored pencil or hatchure marks on the plat below.
2. If more than one lease is dedicated to the well, outline each and identify the ownership thereof (both as to work interest and royalty).
3. If more than one lease of different ownership is dedicated to the well, have the interests of all owners been consolidated by communitization, unitization, force-pooling, etc?

☐ Yes ☐ No If answer is "yes," type of consolidation _____

If answer is "no," list the owners and tract descriptions which have actually been consolidated. (Use reverse side this form if necessary.) _____

No allowable will be assigned to the well until all interests have been consolidated (by communitization, unitization, forced-pooling, or otherwise) or until a non-standard unit, eliminating such interests, has been approved by the Division.

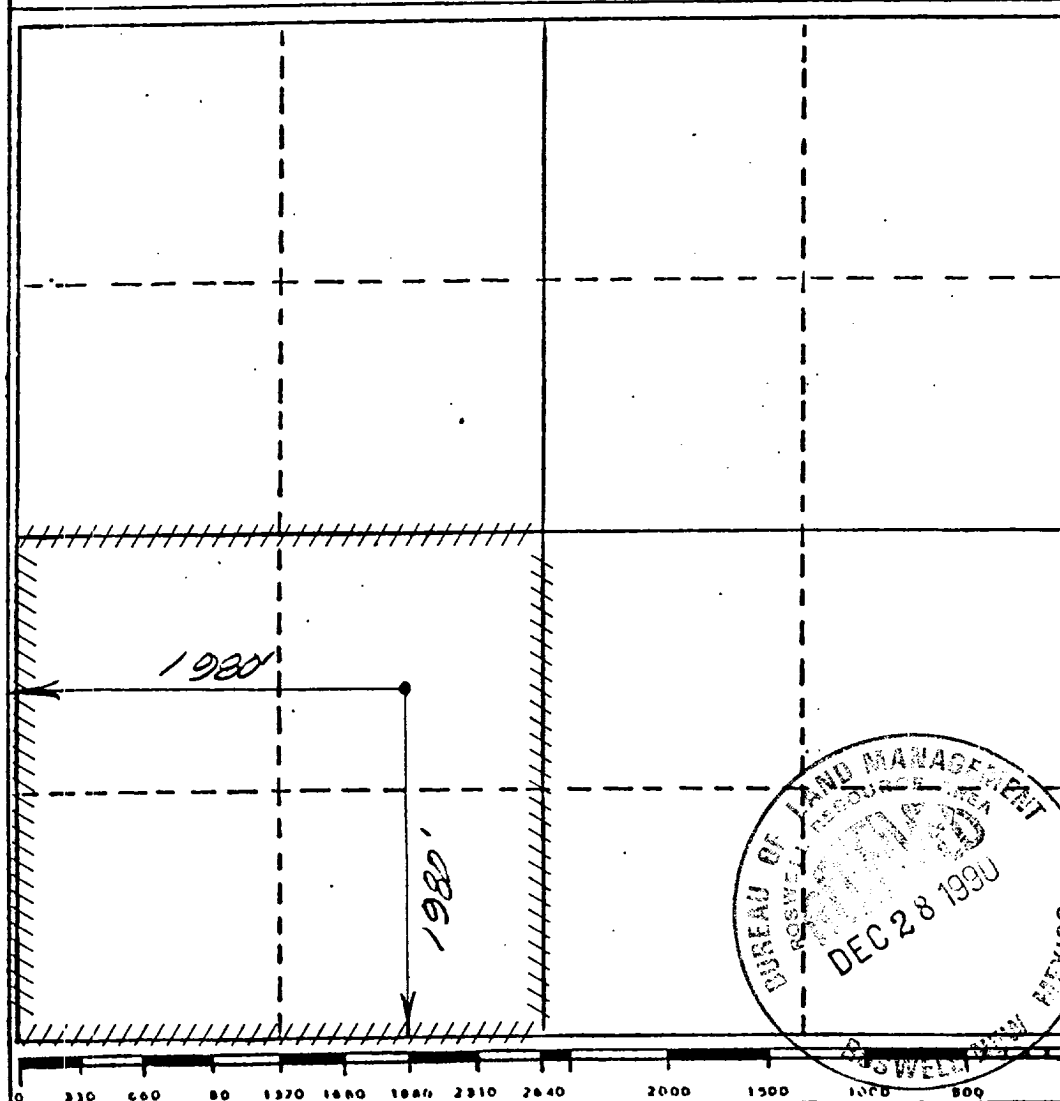

CERTIFICATION

I hereby certify that the information contained herein is true and complete to the best of my knowledge and belief.

Terry W. Franklin
Name

Terry W. Franklin
Position

Agent

Company

McKay Oil Corporation

Date

4/16/87

I hereby certify that the well location shown on this plat was plotted from the notes of actual surveys made by me under my supervision, and that the same is true and correct to the best of my knowledge and belief.

John D. Jaquess
Date Surveyed
March 28, 1987

Registered Professional Engineer
and/or Land Surveyor

John D. Jaquess, P.E., L.S.

Certificate No. 6290