

UNITED STATES
DEPARTMENT OF THE INTERIOR
BUREAU OF LAND MANAGEMENT

APPLICATION FOR PERMIT TO DRILL OR DEEPEN

1a. TYPE OF WORK

DRILL ☒

DEEPEN ☐

b. TYPE OF WELL

OIL WELL ☐

GAS WELL ☒

OTHER

SINGLE ZONE ☐

2. NAME OF OPERATOR

YATES PETROLEUM CORPORATION 25575

3. ADDRESS AND TELEPHONE NO.

105 South Fourth Street, Artesia, NM 88210 748

4. LOCATION OF WELL (Report location clearly and in accordance with any State requirements.)*

At surface

990' FNL and 660' FEL 4A

At proposed prod. zone

Same

14. DISTANCE IN MILES AND DIRECTION FROM NEAREST TOWN OR POST OFFICE*

Approximately 29 miles north of Roswell, New Mexico.

15. DISTANCE FROM PROPOSED*

LOCATION TO NEAREST PROPERTY OR LEASE LINE, FT. (Also to nearest drilg. unit line, if any)

18. DISTANCE FROM PROPOSED LOCATION*

TO NEAREST WELL, DRILLING, COMPLETED, OR APPLIED FOR, ON THIS LEASE, FT.

21. ELEVATIONS (Show whether DF, RT, GR, etc.)

4279' GR

23.

PROPOSED CASING AND CEMENTING PROGRAM

SIZE OF HOLE	GRADE, SIZE OF CASING	WEIGHT PER FOOT	SETTING DEPTH	QUANTITY OF CEMENT
12 1/4"	8 5/8"	24.0#	950'	Circulated
7 7/8"	4 1/2"	10.50#	3150'	As warranted to tie-back to 2000'

Yates Petroleum Corporation proposes to drill and test the Abo and intermediate formations. Approximately 950' of surface casing will be set and cement circulated to the surface. If commercial, production casing will be run and cemented with adequate cover to tie back to 2000', perforated and stimulated as needed for production.

MUD PROGRAM: Spud to 950' FW Gel/LCM; 950' to 2600' Cut Brine; 2600' to 3150' SW Gel Starch.

BOPE PROGRAM: BOPE will be installed on the 8 5/8" casing and tested daily.

NOTE: Off lease ROW is being applied for under using APD.

IN ABOVE SPACE DESCRIBE PROPOSED PROGRAM: If proposal is to deepen, give data on present productive zone and proposed new productive zone. If proposal is to drill or deepen directionally, give pertinent data on subsurface locations and measured and true vertical depths. Give blowout preventer program, if any.

24.

SIGNED

Clifton R. May

TITLE Regulatory Agent

DATE October 28, 1997

(This space for Federal or State office use)

PERMIT NO.

APPROVAL DATE

Application approval does not warrant or certify that the applicant holds legal or equitable title to those rights in the subject lease which would entitle the applicant to conduct operations thereon. CONDITIONS OF APPROVAL, IF ANY:

APPROVED BY

TR / [Signature]

TITLE

Area Manager

DATE

11/20/97

*See Instructions On Reverse Side

11-11-97

11-11-97

RECEIVED
ROOSEVELT OFFICE

1997 NOV -5 A 10:41

RECEIVED

State of New Mexico

Energy, Minerals and Natural Resources Department

DISTRICT I
P.O. Box 1980, Hobbs, NM 88240DISTRICT II
P.O. Drawer DD, Artesia, NM 88210DISTRICT III
1000 Rio Brazos Rd., Aztec, NM 87410

OIL CONSERVATION DIVISION

P.O. Box 2088

Santa Fe, New Mexico 87504-2088

☐ AMENDED REPORT

WELL LOCATION AND ACREAGE DEDICATION PLAT

API Number 30-005-63959	Pool Code 82740	Pool Name W-Pecos Slope Abo
Property Code	Property Name EDDLEMAN DRAW "ASB" FEDERAL	Well Number 1
OGRID No. 025575	Operator Name YATES PETROLEUM CORPORATION	Elevation 4279

Surface Location

UL or lot No.	Section	Township	Range	Lot Idn	Feet from the	North/South line	Feet from the	East/West line	County
A	15	7S	22E		990	NORTH	660	EAST	CHAVES

Bottom Hole Location If Different From Surface

UL or lot No.	Section	Township	Range	Lot Idn	Feet from the	North/South line	Feet from the	East/West line	County

Dedicated Acres 160	Joint or Infill	Consolidation Code	Order No.
-------------------------------	-----------------	--------------------	-----------

NO ALLOWABLE WILL BE ASSIGNED TO THIS COMPLETION UNTIL ALL INTERESTS HAVE BEEN CONSOLIDATED
OR A NON-STANDARD UNIT HAS BEEN APPROVED BY THE DIVISION

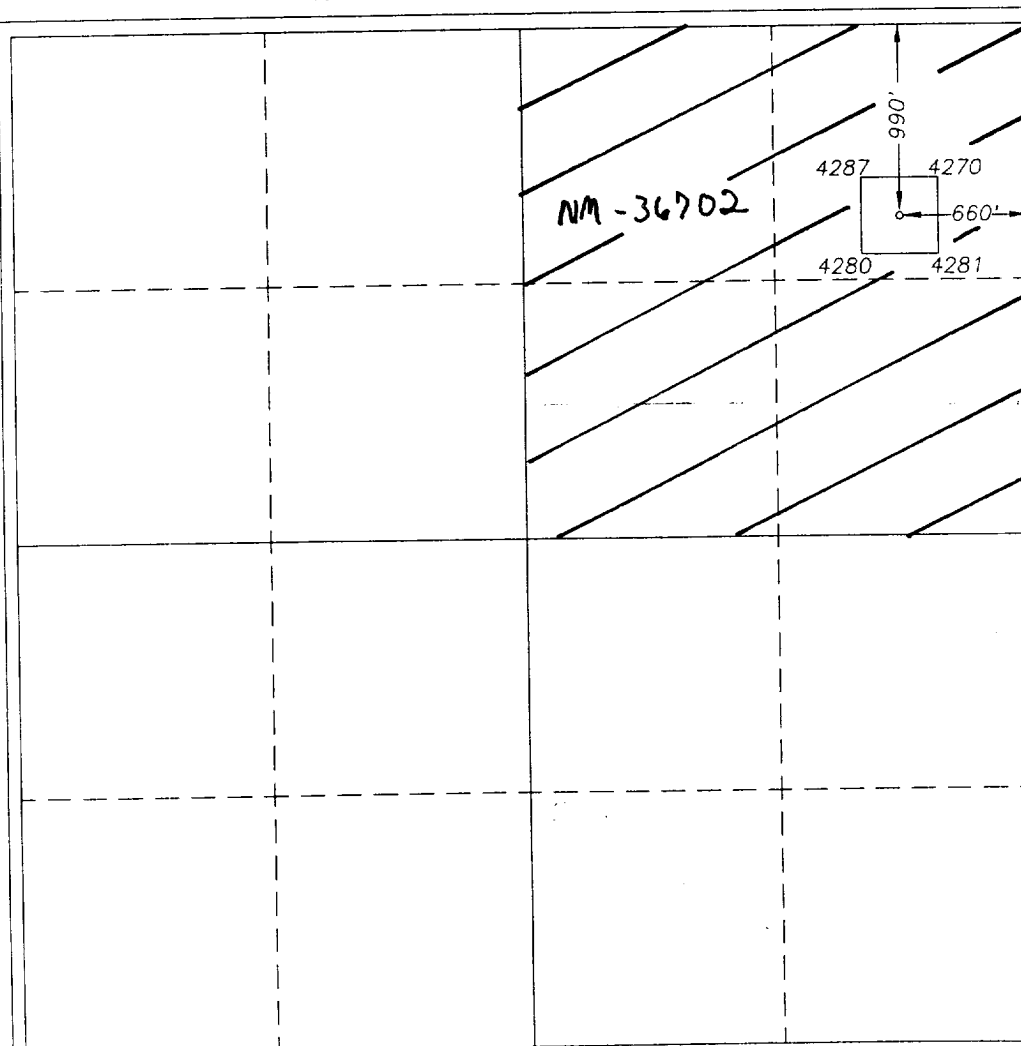

OPERATOR CERTIFICATION

I hereby certify the the information
contained herein is true and complete to the
best of my knowledge and belief.

Clifton R. May
Signature

Clifton R. May
Printed Name

Permit Agent
Title

October 28, 1997
Date

SURVEYOR CERTIFICATION

I hereby certify that the well location shown
on this plat was plotted from field notes of
actual surveys made by me or under my
supervision, and that the same is true and
correct to the best of my belief.

10/27/97

Date Surveyed

Signature

Professional Seal of

Professional Surveyor

NEW MEXICO

3640

Certificate No.

EDLEMAN, DISK-#6

GENERAL SURVEYING COMPANY

YATES PETROLEUM CORPORATION

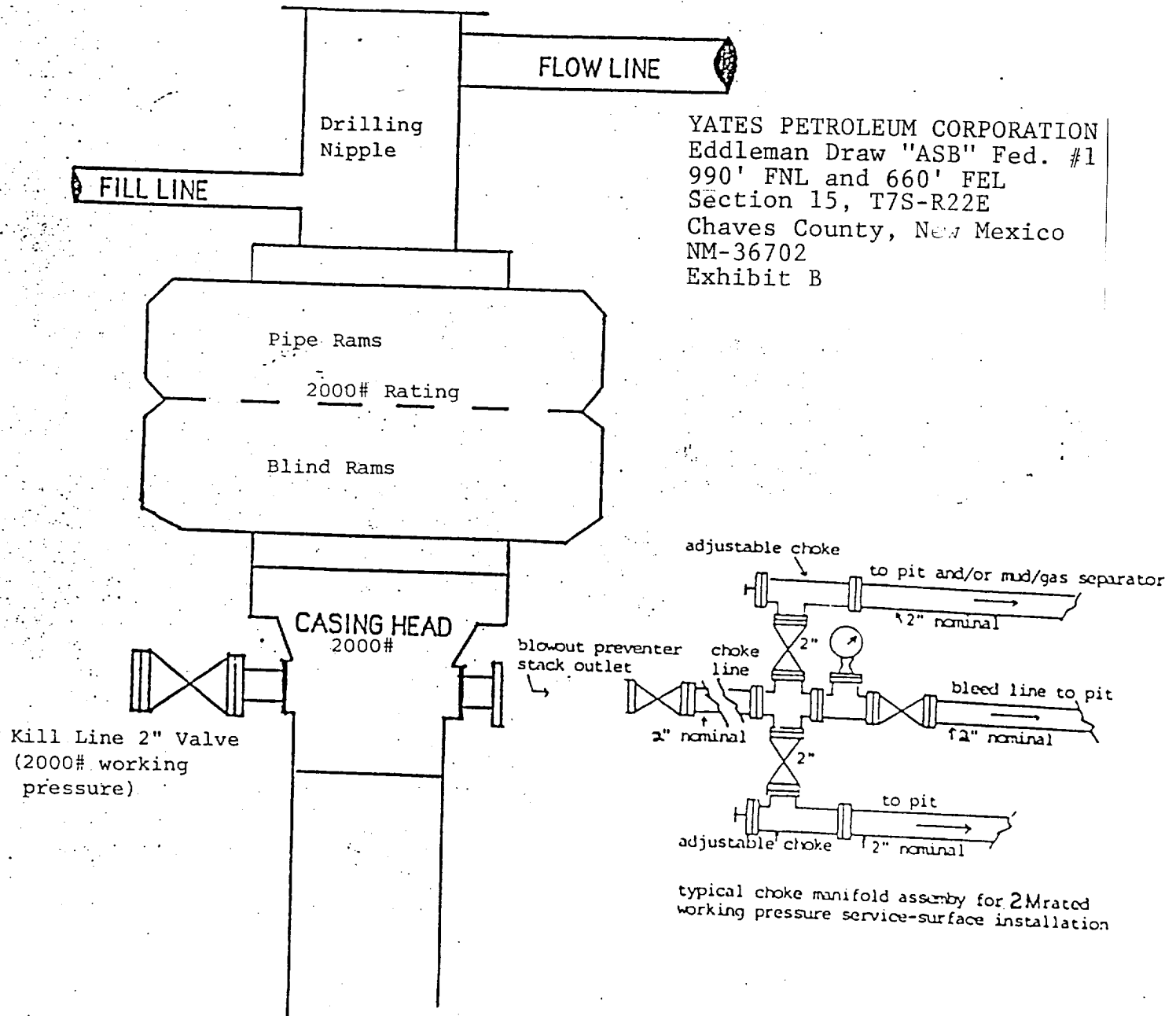

YATES PETROLEUM CORPORATION
Eddleman Draw "ASB" Fed. #1
990' FNL and 660' FEL
Section 15, T7S-R22E
Chaves County, New Mexico
NM-36702
Exhibit B

**BLOWOUT PREVENTER
2M SYSTEM**