

UNITED STATES
DEPARTMENT OF THE INTERIOR
BUREAU OF LAND MANAGEMENT

APPLICATION FOR PERMIT TO DRILL OR DEEPEN

1a. TYPE OF WORK DRILL <input checked="" type="checkbox"/> DEEPEN <input type="checkbox"/>		7. UNIT AGREEMENT NAME	
1b. TYPE OF WELL OIL WELL <input type="checkbox"/> GAS WELL <input checked="" type="checkbox"/> OTHER <input type="checkbox"/> SINGLE ZONE <input checked="" type="checkbox"/> MULTIPLE ZONE <input type="checkbox"/>		8. FARM OR LEASE NAME, WELL NO. Leeman Federal #8	
2. NAME OF OPERATOR Gothic Production Corporation c/o J.O. Easley, Inc.		9. API WELL NO. 23566	
3. ADDRESS AND TELEPHONE NO. 100 N. Penn, Roswell, NM 88201		10. FIELD AND POOL, OR WILDCAT Pecos Slope Abo	
4. LOCATION OF WELL (Report location clearly and in accordance with any State requirements.) 790'FWL & 1850'FNL UNIT E		11. SEC. T., R., M., BLOCK AND SURVEY OR AREA 13, T9S-25E	
14. DISTANCE IN MILES AND DIRECTION FROM NEAREST TOWN OR POST OFFICE 16 miles northeast of Roswell, NM		12. COUNTY OR PARISH Chaves	13. STATE NM
15. DISTANCE FROM PROPOSED LOCATION TO NEAREST PROPERTY OR LEASE LINE, T.O. 790' (Also to nearest drg. unit line, if any)	16. NO. OF ACRES IN LEASE 1,400.0	17. NO. OF ACRES ASSIGNED TO THIS WELL 160.0	
18. DISTANCE FROM PROPOSED LOCATION TO NEAREST WELL, DRILLING COMPLETED, OR APPLIED FOR, ON THIS LEASE, FT. 5000'		19. PROPOSED DEPTH 4200'	
20. ROTARY OR CABLE TOOLS Rotary		21. APPROX. DATE WORK WILL START ASAP	
22. ELEVATIONS (Show whether DF, RT, GR, etc.) 3658'		23. APPROX. DATE WORK WILL START ASAP	

PROPOSED CASING AND CEMENTING PROGRAM

SIZE OF HOLE	GRADE, SIZE OF CASING	WEIGHT PER FOOT	SETTING DEPTH	QUANTITY OF CEMENT
17-1/2"	13-3/8"	48#	40'	Circulate to surface
12-1/4"	8-5/8"	24#	900'	550 sxs
7-7/8"	4-1/2"	10.5#	4200'	485 sxs

Duration of Program: Drilling - Ten (10) days
Completion - Nine (9) days
See attached for complete Drilling Program

The undersigned accepts all applicable terms, conditions, stipulations, and restrictions concerning operations conducted on the leased land or portions thereof, as described.

EXHIBITS

Exhibit "A": Drilling Program
Exhibit "B": Surface Use Plan
Exhibit "C": Land Survey Plat
Exhibit "D": Location Plat
Exhibit "E": Existing Well Plat
Exhibit "F": Rig Layout
Exhibit "G": BOP Program

IN ABOVE SPACE, DESCRIBE PROPOSED PROGRAM: If proposal is to deepen, give data on present productive zone and proposed new productive zone. If proposal is to drill or deepen directionally, give pertinent data on subsurface locations and measured and true vertical depths. Give blowout prevention program, if any.

SIGNED [Signature] TITLE Agent/Gothic Prod. Corp. DATE 4-20-99
(This space for Federal or State office use)

PERMIT No. _____ APPROVAL DATE _____

Application approval does not warrant or certify that the applicant holds legal or equitable title to the land in the subject lease which would entitle the applicant to conduct operations thereon.

CONDITIONS OF APPROVAL, IF ANY:
APPROVED BY [Signature] TITLE Assistant Field Office Manager, Lands and Minerals DATE JUN 15 1999

*See Instructions On Reverse Side

Title 18 U.S.C. Section 1001, makes it a crime for any person knowingly and willfully to make to any department or agency of the United States any false, fictitious or fraudulent statements or representations as to any matter within its jurisdiction.

DISTRICT I
P.O. Box 2088, Hobbs, NM 88241-1088

State of New Mexico

EXHIBIT C

Energy, Minerals and Natural Resources Department

Form C-202
Revised February 10, 1994
Submit to Appropriate District Office
State Lease - 4 Copies
Fee Lease - 3 Copies

DISTRICT II
P.O. Drawer 88, Artesia, NM 88211-0710

DISTRICT III
1000 Rio Brazos Rd., Aztec, NM 87410

OIL CONSERVATION DIVISION

P.O. Box 2088
Santa Fe, New Mexico 87504-2088

DISTRICT IV
P.O. Box 2088, Santa Fe, NM 87504-2088

☐ AMENDED REPORT

WELL LOCATION AND ACREAGE DEDICATION PLAT

API Number	Pool Code 82730	Pool Name Pecos Slope Abo
Property Code	Property Name LEEMAN FEDERAL	Well Number 8
OGRID No.	Operator Name GOTHIC ENERGY CORPORATION	Elevation 3658

Surface Location

UL or lot No. E	Section 13	Township 9 S	Range 25 E	Lot Idn.	Feet from the 1850	North/South line NORTH	Feet from the 790	East/West line WEST	County CHAVES
--------------------	---------------	-----------------	---------------	----------	-----------------------	---------------------------	----------------------	------------------------	------------------

Bottom Hole Location If Different From Surface

UL or lot No.	Section	Township	Range	Lot Idn.	Feet from the	North/South line	Feet from the	East/West line	County
Dedicated Acres 160.0	Joint or Infill	Consolidation Code	Order No.						

NO ALLOWABLE WILL BE ASSIGNED TO THIS COMPLETION UNTIL ALL INTERESTS HAVE BEEN CONSOLIDATED
OR A NON-STANDARD UNIT HAS BEEN APPROVED BY THE DIVISION

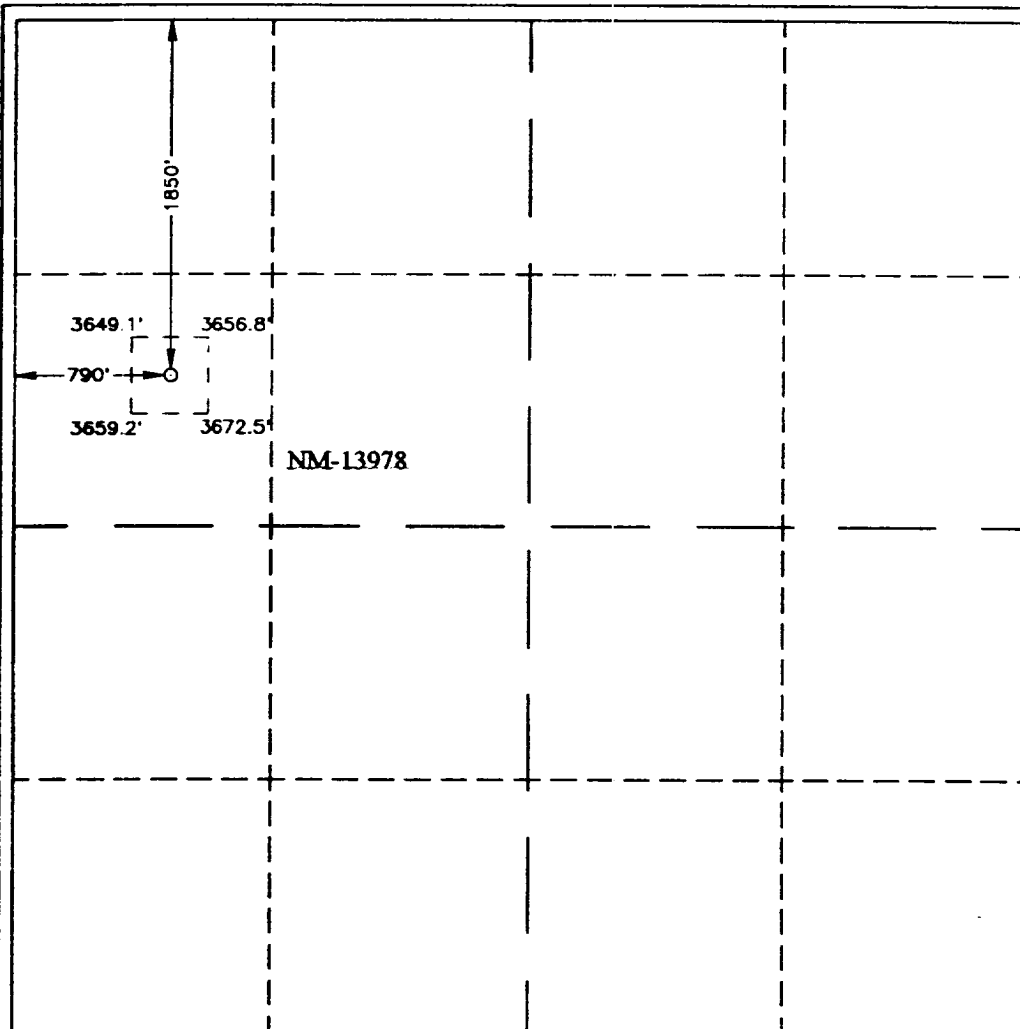

OPERATOR CERTIFICATION

I hereby certify the the information
contained herein is true and complete to the
best of my knowledge and belief.

Signature

James L. Schultz

Printed Name

Agent/Gothic Prod. Corp.

Title

4/19/99

Date

SURVEYOR CERTIFICATION

I hereby certify that the well location shown
on this plat was plotted from field notes of
actual surveys made by me or under my
supervision, and that the same is true and
correct to the best of my belief.

APRIL 12, 1999

Date Surveyed

Signature

Professional Surveyor

RONALD S. EDSON

NEW MEXICO

3229

P.O. Num. 89-14-307

Certified

No. RONALD S. EDSON

3229

EDSON

McDONALD

