

(SUBMIT IN TRIPLICATE)

UNITED STATES
DEPARTMENT OF THE INTERIOR
GEOLOGICAL SURVEY

Land Office **Las Cruces**Lease No. **064894-A**Unit **Poker Lake**

RECEIVED

MAY 20 1963

SUNDRY NOTICES AND REPORTS ON WELLS

NOTICE OF INTENTION TO DRILL	<input checked="" type="checkbox"/>	SUBSEQUENT REPORT OF WATER SHUT-OFF	
NOTICE OF INTENTION TO CHANGE PLANS		SUBSEQUENT REPORT OF SHOOTING OR ACIDIZING	
NOTICE OF INTENTION TO TEST WATER SHUT-OFF		SUBSEQUENT REPORT OF ALTERING CASING	
NOTICE OF INTENTION TO RE-DRILL OR REPAIR WELL		SUBSEQUENT REPORT OF RE-DRILLING OR REPAIR	
NOTICE OF INTENTION TO SHOOT OR ACIDIZE		SUBSEQUENT REPORT OF ABANDONMENT	
NOTICE OF INTENTION TO PULL OR ALTER CASING		SUPPLEMENTARY WELL HISTORY	
NOTICE OF INTENTION TO ABANDON WELL			

(INDICATE ABOVE BY CHECK MARK NATURE OF REPORT, NOTICE, OR OTHER DATA)

RECEIVED

Herzog Federal
Well No. **1** is located: **1980** ft. from **{N}** line and **1980** ft. from **{E}** line of sec. **14**
NE 1/4 **T-25-S** **R-30-E** **N. M. P. M.** **U. S. GEOLOGICAL SURVEY**
(Sec. and Ref. No.) (Twp.) (Range) (Meridian) **ARTESIA, NEW MEXICO**
Undesignated **Eddy** **New Mexico**
(Field) (County or Subdivision) (State or Territory)

The elevation of the derrick floor above sea level is * ft. ***Not yet available. Will be submitted when rig is moved in.**

DETAILS OF WORK

(State names of and expected depths to objective sands; show sizes, weights, and lengths of proposed casings; indicate mudding jobs, cementing points, and all other important proposed work)

Propose to drill and complete a well in the upper portion of the Delaware Sand at an approximate total depth of 3800', to be drilled with rotary tools, using mud.

8-5/8" OD 24 lb. per ft. new casing is to be set in 12 1/4" hole at least 650' below ground level, and cemented back to the surface with 600 sacks of regular neat cement.

5 1/2" OD 14 #/ft. new casing is to be set on bottom of the 7-7/8" drilled hole at approximately 3650', in the barren sandy shale section that occurs below the first prospective pay, and is about 40' below the top of the Delaware Sand. 4-3/4" hole is to be cored below the 5 1/2" OD casing to examine the lower prospective pay. Depending on results of cores and tests, the well may be completed open-hole below the casing, or the lower zone may be squeezed off, and the upper zone perforated and treated in the conventional manner.

I understand that this plan of work must receive approval in writing by the Geological Survey before operations may be commenced.

Company **PERRY R. BASS**Address **Box 1178****Monahans, Texas**

By *Walter D. Powers*
Walter D. Powers
Title **Asst. Div. Mgr.**

NEW MEXICO OIL CONSERVATION COMMISSION
WELL LOCATION AND ACREAGE DEDICATION PLAT

FORM C-128
Revised 5/1/57

SEE INSTRUCTIONS FOR COMPLETING THIS FORM ON THE REVERSE SIDE

SECTION A

Operator PERRY R. BASS		Lease HERZOG FEDERAL		Well No. 1
Unit Letter G	Section 17	Township 25 SOUTH	Range 30 EAST	County EDDY
Actual Footage Location of Well: 1980 feet from the NORTH line and 1980 feet from the EAST line				
Ground Level Elev. 3222	Producing Formation Delaware Sand	Pool Undesignated	Dedicated Acreage: Acres	
<p>1. Is the Operator the only owner in the dedicated acreage outlined on the plat below? YES _____ NO _____. ("Owner" means the person who has the right to drill into and to produce from any pool and to appropriate the production either for himself or for himself and another. (65-3-29 (e) NMSA 1935 Comp.)</p> <p>2. If the answer to question one is "no," have the interests of all the owners been consolidated by communication agreement or otherwise? YES _____ NO _____. If answer is "yes," Type of Consolidation _____</p> <p>3. If the answer to question two is "no," list all the owners and their respective interests below:</p>				
Owner		Land Description MAY 1963		
		ARTESIA, OFFICE		

SECTION B

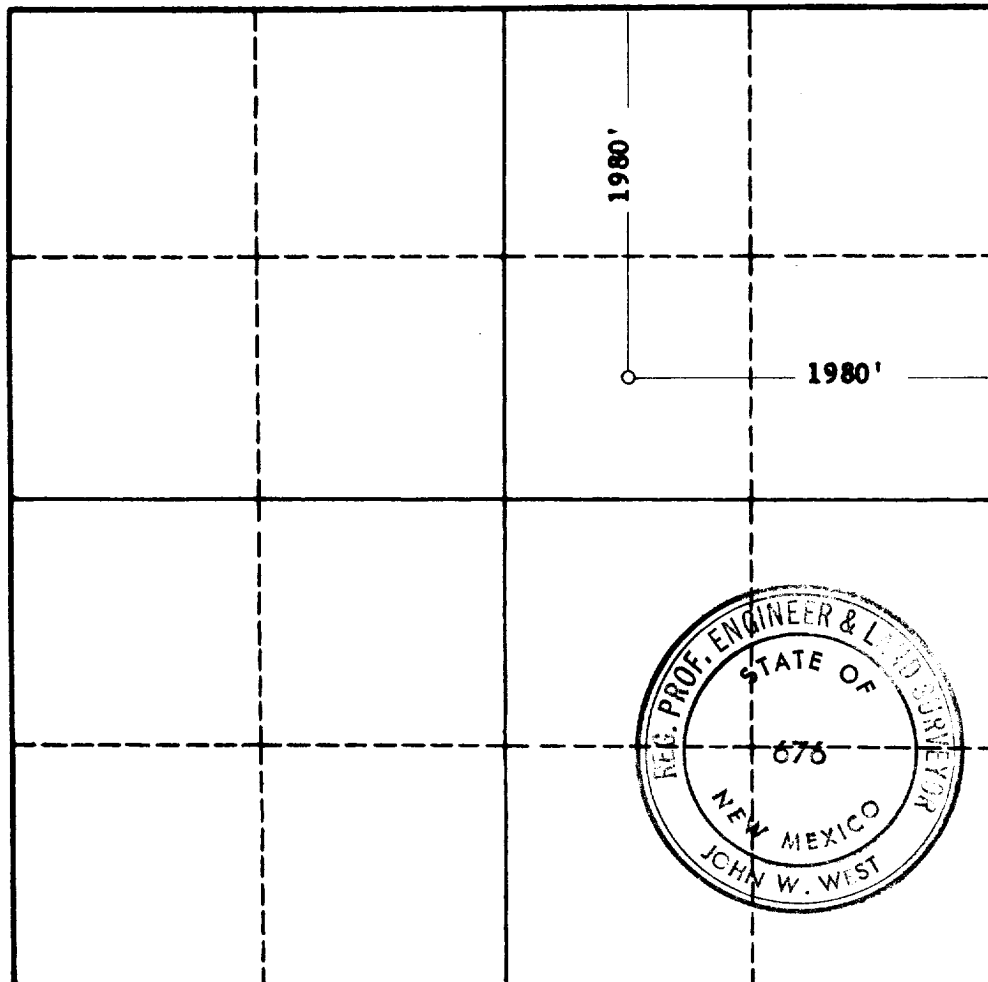

CERTIFICATION

I hereby certify that the information in SECTION A above is true and complete to the best of my knowledge and belief.

Name
Asst. Div. Mgr.
Position
PERRY R. BASS
Company
May 13, 1963
Date

I hereby certify that the well location shown on the plat in SECTION B was plotted from field notes of actual surveys made by me or under my supervision, and that the same is true and correct to the best of my knowledge and belief.

Date Surveyed
5-10-63
Registered Professional Engineer and/or Land Surveyor, **JOHN W. WEST**
John W. West
Certificate No.
N.M. - P.E. & L.S. NO. 676

0 330 660 990 1320 1650 1980 2310 2640 2000 1500 1000 500