

N MEXICO OIL CONSERVATION COMMISSION
WELL LOCATION AND ACREAGE DEDICATION PLAT

Form C-102
Supersedes C-128
Effective 1-1-65

All distances must be from the outer boundaries of the Section

DAVID FASKEN		HOWELL "29" FEDERAL		Well No. 1
K	29	20 South	25 East	Eddy

1980	feet from the South line and	1980	feet from the West line
3566 G.L. Morrow	Undesignated Wildcat	Dedicated Acreage: 640	Acres

- Outline the acreage dedicated to the subject well by colored pencil or hachure marks on the plat.
- If more than one lease is dedicated to the well, outline each and identify the ownership thereof (both to working interest and royalty).
- If more than one lease of different ownership is dedicated to the well, have the interests of the lease consolidated by communitization, unitization, force-pooling, etc?

RECEIVED
JAN 23 1974
U.S. GEOLOGICAL SURVEY
ARTESIA, NEW MEXICO

XX Yes No If answer is "yes," type of consolidation Pooling Form Leases

If answer is "no," list the owners and tract descriptions which have actually been consolidated. (Use reverse side of this form if necessary.)

Consolidation will be assigned to the well until all interests have been consolidated (by communitization, unitization, force-pooling, or otherwise) or until a non-standard unit, eliminating such interests, has been approved by the Commission.

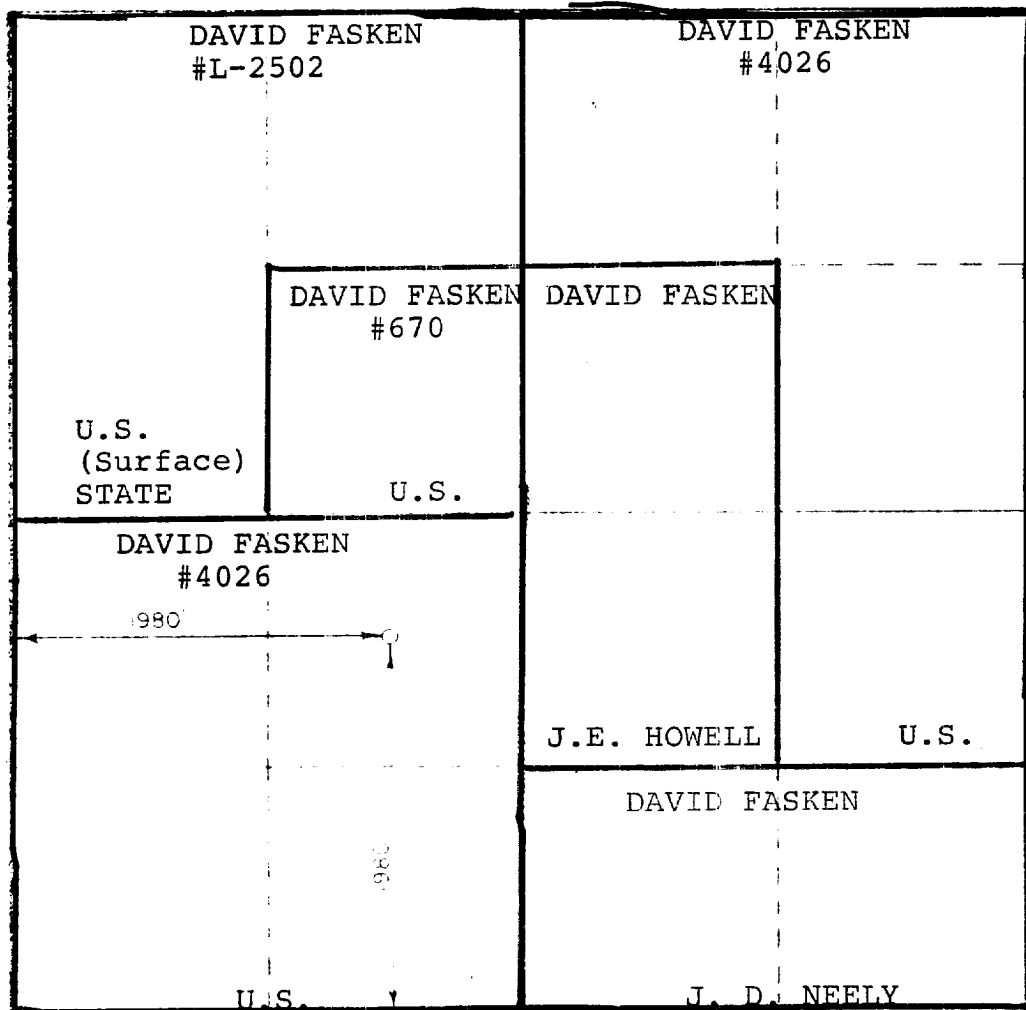

CERTIFICATION

I hereby certify that the information contained herein is true and complete to the best of my knowledge and belief.

Name
James B. Henry

Position
Agent

Company
David Fasken

Date
January 1, 1974

I hereby certify that the well location shown on this plat was plotted from field notes of actual surveys made by me or under my supervision, and that the same is true and correct to the best of my knowledge and belief.

Date surveyed
January 15, 1974

Registered Professional Engineer and/or Land Surveyor

W. W. Neely
Certificate No. 1559