



# United States Department of the Interior

## GEOLOGICAL SURVEY

Post Office Box 113  
Roswell, New Mexico 88201

RECEIVED

SEP 17 1974

September 16, 1974

Mr. William And  
Post Office Box 113  
Roswell, Texas 75701

O. C. C.  
ARTESIA, OFFICE

Dear Mr. And:

Your Application for permit to drill well No. 1-11111 in the 1-11111 sec. 4, T. 12N., R. 31E., S. 4E., Eddy County, New Mexico, lease New Mexico 19-11111, to a depth of 10,000 feet to test the 1-11111 formation in the 1-11111 Area, is hereby approved.

Drilling of the well must be in compliance with the 1-11111 "Drilling Well Control Requirements for Deep Wells Drilled on Federal Oil and Gas Leases in the Artesia District" dated June 2, 1971.

The copy of the Application is returned herewith. Please notify the District Engineer, Geological Survey, Post Office Box 113, Artesia, New Mexico 88201, in sufficient time for a representative to witness all cementing operations. The office phone number is Area Code 909-74-4011.

Sincerely yours,

(Orig. Sigd) RONNIE E. SHOOK

RONNIE E. SHOOK

Acting Area Oil and Gas Supervisor

Attachment

cc:  
Regional Manager, Denver  
Mining Branch (2)  
WMOCC-Artesia (2) (w/cy Notice)  
Artesia (w/cy Notice)  
Roswell (2) (w/cy Notice)  
Roswell (chron.)

UNITED STATES  
DEPARTMENT OF THE INTERIOR  
GEOLOGICAL SURVEY(Other in  
revel  
tions on  
de)

30-015-21372

## APPLICATION FOR PERMIT TO DRILL, DEEPEN, OR PLUG BACK

## 1a. TYPE OF WORK

DRILL ☒DEEPEN ☐PLUG BACK ☐

## b. TYPE OF WELL

OIL  
WELL ☐GAS  
WELL ☒

OTHER

SINGLE  
ZONE ☐MULTIPLE  
ZONE ☐

## 2. NAME OF OPERATOR

Julian Ard

## 3. ADDRESS OF OPERATOR

P. O. Box 1030, Midland, Texas 79701

## 4. LOCATION OF WELL (Report location clearly and in accordance with any State requirements.)\*

At surface

1980 from south and east lines of Section 24, T-19-S, R-30-E

At proposed prod. zone

## 14. DISTANCE IN MILES AND DIRECTION FROM NEAREST TOWN OR POST OFFICE\*

25 miles northeast of Carlsbad, New Mexico

## 15. DISTANCE FROM PROPOSED\*

LOCATION TO NEAREST

PROPERTY OR LEASE LINE, FT.

(Also to nearest drlg. unit line, if any)

1980

## 18. DISTANCE FROM PROPOSED LOCATION\*

TO NEAREST WELL, DRILLING, COMPLETED,  
OR APPLIED FOR, ON THIS LEASE, FT.

3960

## 21. ELEVATIONS (Show whether DF, RT, GR, etc.)

3323 GR

## 23.

## PROPOSED CASING AND CEMENTING PROGRAM

SIZE OF HOLE	SIZE OF CASING	WEIGHT PER FOOT	SETTING DEPTH	QUANTITY OF CEMENT
17-1/2"	13-3/8"	48#	850	650sx. LT WT & 200 Sx Class "C"
11"	8-5/8"	24# & 32#	4250	2-Stage w/900 sx & 600 sx
7-7/8"	5-1/2"	17# & 20#	12,500	600 sx Class "C" 2% CaCl 2

13-3/8" surface casing will be cemented to surface of ground

8-5/8" casing will be cemented in 2-stages w/900 sx Class "C" 2% CaCl 2 on 1st stage and 600 sx Class "C" 2% CaCl 2 on 2nd stage, top of cement should be at approximately 700 feet.

## MUD PROGRAM

See proposed Mud Program attached.

## BLOW-OUT EQUIPMENT

See diagrams attached (2).

IN ABOVE SPACE DESCRIBE PROPOSED PROGRAM: If proposal is to deepen or plug back, give data on present productive zone and proposed new productive zone. If proposal is to drill or deepen directionally, give pertinent data on subsurface locations and measured and true vertical depths. Give blowout preventer program, if any.

24.

SIGNED

TITLE

Owner

DATE 8-21-74

(This space for Federal or State office use)

PERMIT NO.

APPROVAL DATE

APPROVED BY

TITLE

DATE

CONDITIONS OF APPROVAL, IF ANY:

\*See Instructions On Reverse Side

5. LEASE DESIGNATION AND SERIAL NO.

NM 06767 11106766

6. IF INDIAN, ALLOTTEE OR TRIBE NAME

7. UNIT AGREEMENT NAME

8. FARM OR LEASE NAME

Hackberry Unit

9. WELL NO.

31

10. FIELD AND POOL, OR WILDCAT

Wildcat

11. SEC., T., R., M., OR BLM.  
AND SURVEY OR AREA

Sec. 24, T-19-S, R-30-E

12. COUNTY OR PARISH 13. STATE

Eddy

New Mexico

16. NO. OF ACRES IN LEASE

600

17. NO. OF ACRES ASSIGNED

320

19. PROPOSED DEPTH

12,500

20. ROTARY OR CABLE TOOLS

Rotary

22. APPROX. DATE WORK WILL START\*

October 15, 1974

RECEIVED

AUG 22 1974

U. S. GEOLOGICAL SURVEY  
ARTESIA, NEW MEXICO

NEW MEXICO OIL CONSERVATION COMMISSION  
WELL LOCATION AND ACREAGE DEDICATION PLAT

Form C-102  
Supersedes C-128  
Effective 1-1-65

All distances must be from the outer boundaries of the Section.

Operator <b>Julian Ard</b>			Lease <del>Hackberry Unit</del> <i>Holbrook</i>		Well No. <del>1</del> <i>1-</i>
Map Letter <b>J</b>	Section <b>24</b>	Township <b>19 South</b>	Range <b>30 East</b>	County <b>Eddy</b>	
Actual Footage Location of Well: <b>1980</b> feet from the <b>South</b> line and <b>1980</b> feet from the <b>East</b> line					
Ground Level Elev. <b>3323 GR</b>	Producing Formation <b>Morrow Sand</b>	Pool <b>Wildcat</b>	Dedicated Acreage: <b>320</b> Acres		

1. Outline the acreage dedicated to the subject well by colored pencil or hachure marks on the plat below.
2. If more than one lease is dedicated to the well, outline each and identify the ownership thereof (both as to working interest and royalty).
3. If more than one lease of different ownership is dedicated to the well, have the interests of all owners been consolidated by communitization, unitization, force-pooling, etc?

☐ Yes ☒ No If answer is "yes," type of consolidation \_\_\_\_\_

If answer is "no," list the owners and tract descriptions which have actually been consolidated. (Use reverse side of this form if necessary.) \_\_\_\_\_

No allowable will be assigned to the well until all interests have been consolidated (by communitization, unitization, forced-pooling, or otherwise) or until a non-standard unit, eliminating such interests, has been approved by the Commission.

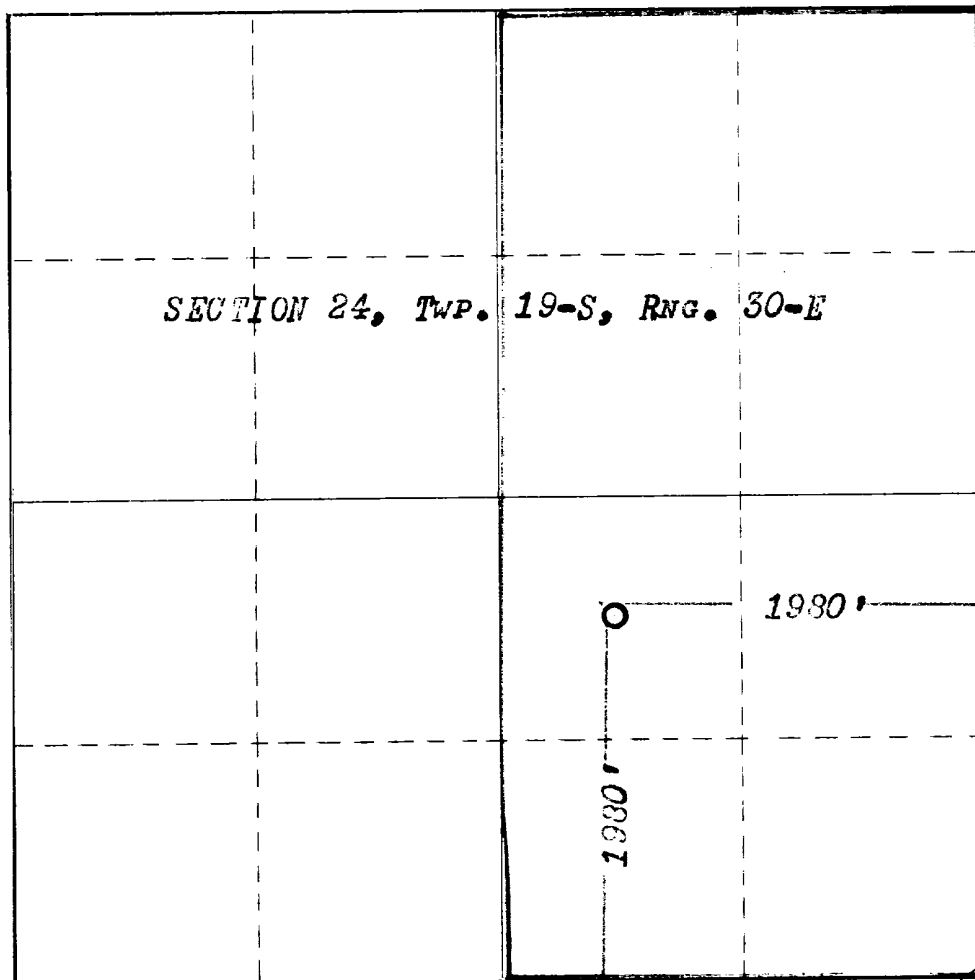

CERTIFICATION

I hereby certify that the information contained herein is true and complete to the best of my knowledge and belief.

Name *Julian Ard*

Position

Owner

Con my

**Julian Ard**

Date

**8-21-74**

**RECEIVED**

I hereby certify that the well location shown on this plat was plotted from field notes of actual surveys made by me or under my supervision, and that the same is true and correct to the best of my knowledge and belief.

Date Surveyed

Registered Professional Engineer and/or Land Surveyor

Certificate No.

**754**

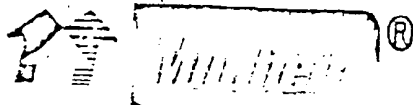

# Drilling Fluids Division

Date August 20, 1974  
Company ARD DRILLING COMPANY Location Sec. 24, T-19-S, R-3  
Well Name Hackberry No. 2 Survey 1-Holler  
County Eddy State New Mexico

## MUD SPECIFICATIONS

## CASING

## FORMATION

Depth  
ft

Mud Weight  
PPG

Viscosity  
sec qt

API Filtrate  
ml

### R E V I S I O N

0-850

8.0-9.4

32-45

No Control

MILGEL<sup>®</sup> and MIL-LIME<sup>™</sup> to spud, maintaining to set  
13-3/8" pipe.

850-4,250

9.0-9.6

28-29

No Control

Brine water. Paper-Ox for seepage.

4,250-8,500

8.3-8.8

28-30

No Control

Fresh water - circulate reserve pit. Use Paper-Ox  
for seepage. Should seepage become excessive, we  
suggest a prehydrated MILGEL<sup>®</sup> sweep.

8,500-10,200

9.5-10.0

28

Start potash brine, using Paper-Ox for seepage.  
Circulate the reserve pit.

10,200-12,500

9.5-10.0

32-35

10-8 ml

While continuing to circulate the reserve pit, add  
Polymer and Drispac to produce the suggested properties.  
Control the pH with Caustic Soda and Soda Ash.

ESTIMATED MUD COST: \$12,000.00

8-5/8" 800

13-3/8"

2 Yates

4

4,250

6

Bone Springs

1st Bone Sp. S

8

2nd Bone Sp. S

3rd Bone Sp. S

Wolfcamp

10

Strawn

Atoka

12

14

Reserve pit

waste pit

30' x 6' x 7 1/2'

30' x 6' x 7 1/2'

30' x 6' x 7 1/2'

Mud house

4 1/2' x 7 1/2'

K x F.G.D.  
700 HP

DH 006  
EMISO D-200

Sub 17' High

61'

Dog house

Regulator

w/ Remote control  
unit on Rig floor

eat walk

Pipe Racks

Pipe Racks

500 bbl  
water tank

500 bbl  
water tank

Diesel tank

LPG tank

Light plant

Trailer house

Caliche Pad 250' x 250'

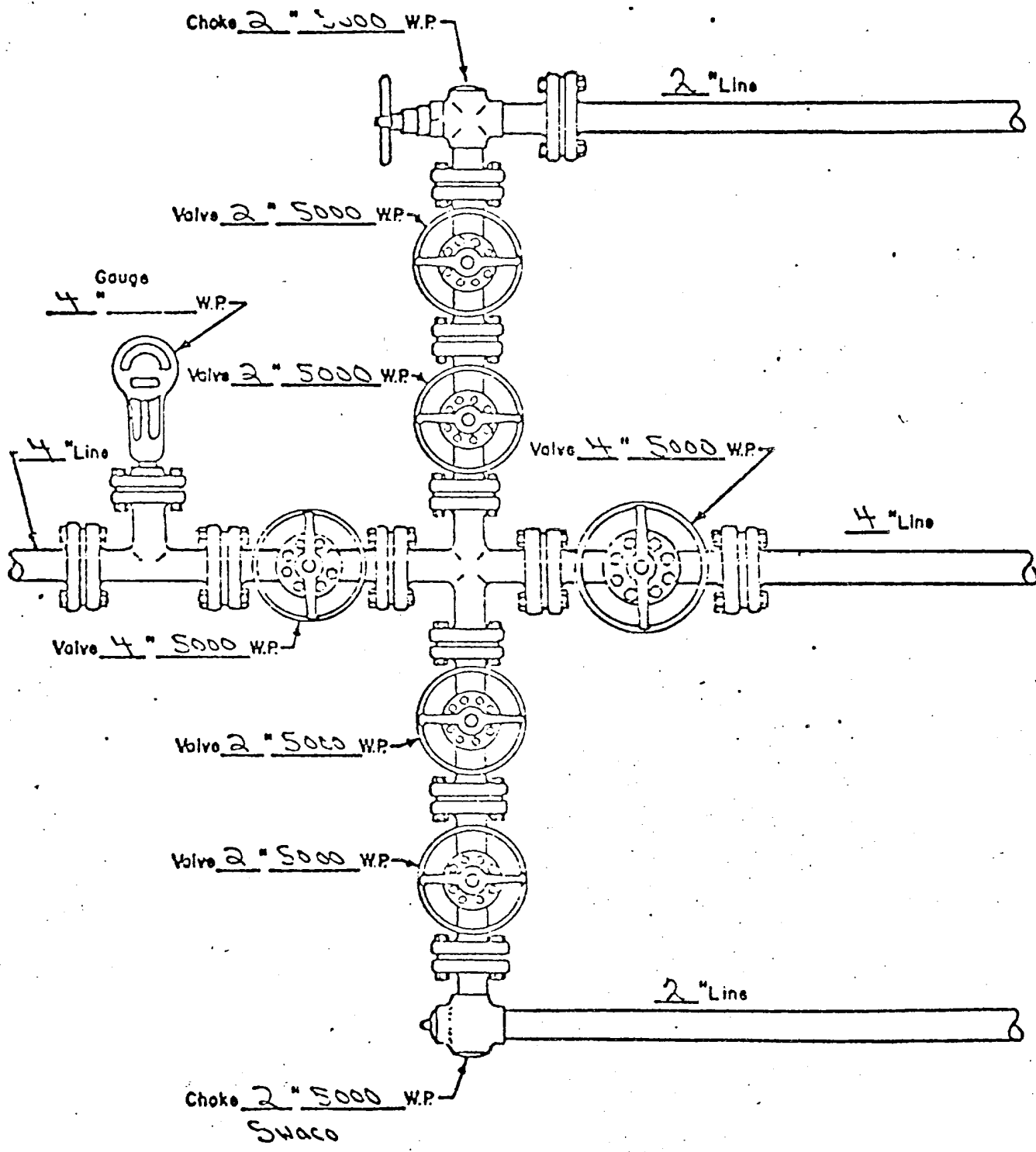

MANIFOLD  
5000 #W.P.

- ☒ Manual
- ☐ Hydraulic

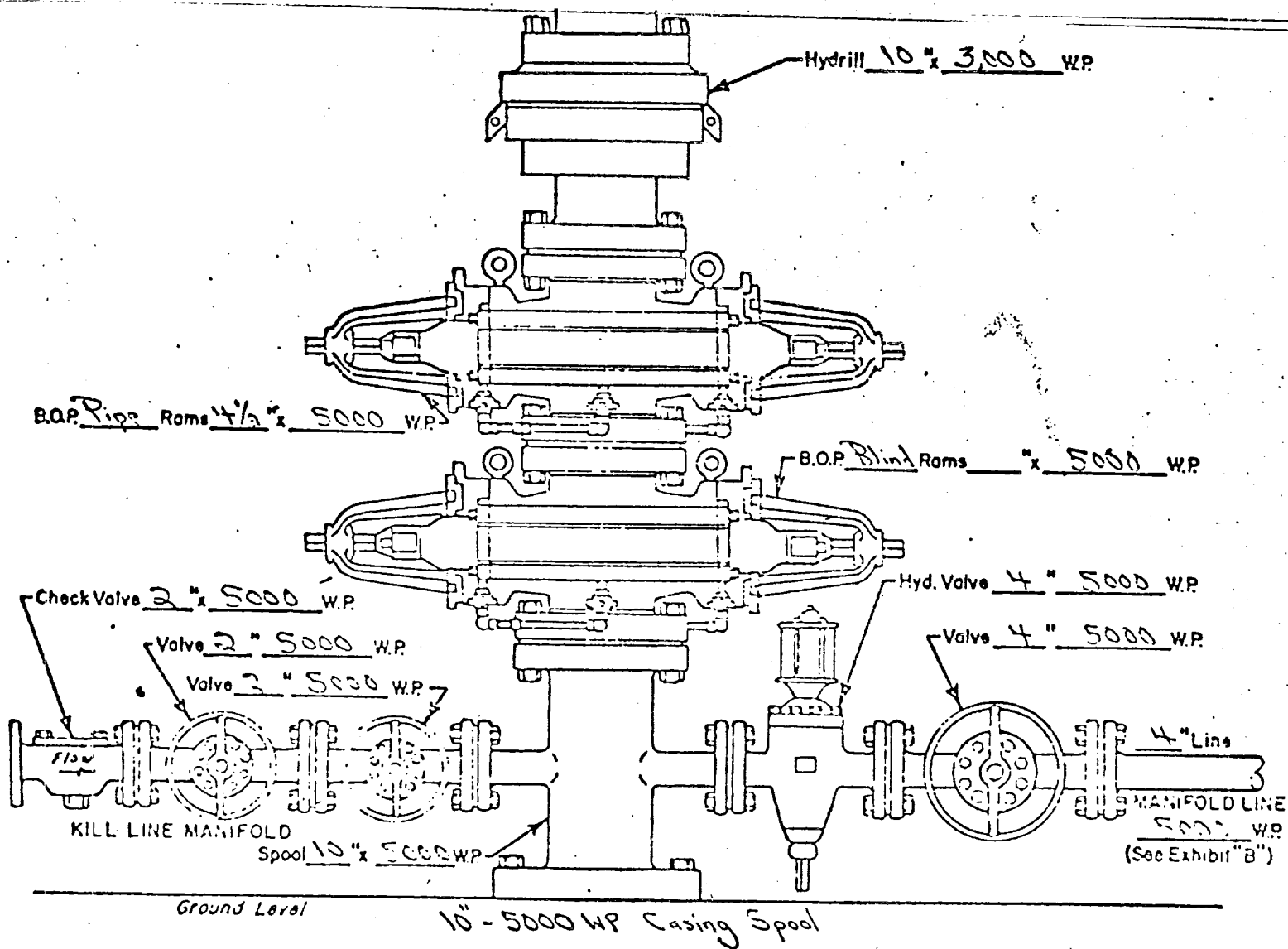

WELL HEAD B.O.P.

5,000 # W.P.

☐ Manual

☒ Hydraulic

DEVELOPMENT PLAN

*1 - Halden*  
Julian Ard No. ~~2, Hackberry Unit~~ Well, located 1980 feet from South and East Lines of Section 24, T-19-S, R-30-E, Eddy County, New Mexico

1. 15.2 miles East of Carlsbad on Highway 62/180, turn North on State Highway No. 31, go 5.7 miles to Junction of Highway 31 and 360, continue NE on Highway 31 for 1.7 miles, turn left in Northeasterly direction on graded road 2.1 miles.
2. Turn east on graded road 3/10 mile to location.
3. Plats enclosed.
4. N/A
5. N/A
6. Water will be hauled.
7. All waste will be put in waste pit and covered.
8. N/A
9. N/A
10. Rig plat enclosed.
11. Surface will be restored to its original condition as near as possible.

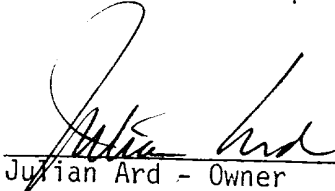
  
\_\_\_\_\_  
Julian Ard - Owner



