

COPIES RECEIVED	5
DISTRIBUTION	
STAFF	1
FILE	1
U.S.G.S.	2
LAND OFFICE	
OPERATOR	1

NEW MEXICO OIL CONSERVATION COMMISSION

8-4-75 10:00 AM.  
city of Carlsbad notified  
this date

RECEIVED

JUL 28 1975

30-015-21601

Form C-101  
Revised 1-1-65

5A. Indicate Type of Lease  
STATE ☐ FEE ☒  
5. State Oil & Gas Lease No.

APPLICATION FOR PERMIT TO DRILL, DEEPEN, OR PLUG BACK

1a. Type of Work DRILL <input checked="" type="checkbox"/> DEEPEN <input type="checkbox"/> PLUG BACK <input type="checkbox"/>		7. Unit Agreement Name	
b. Type of Well GAS WELL <input type="checkbox"/> OTHER <input type="checkbox"/> SINGLE ZONE <input checked="" type="checkbox"/> MULTIPLE ZONE <input type="checkbox"/>		8. Farm or Lease Name Holley Baby	
c. Name of Operator Corinne Grace ✓		9. Well No. 1	
d. Address of Operator P. O. Box 1413, Carlsbad, New Mexico		10. Field and Pool, or Wildcat Undes. So. Carlsbad Delaware	
4. Location of Well UNIT LETTER <u>K</u> LOCATED <u>1650</u> FEET FROM THE <u>South</u> LINE <u>2310</u> FEET FROM THE <u>West</u> LINE OF SEC. <u>24</u> TWP. <u>22S</u> RGE. <u>26E</u> NMPM		12. County Eddy	
19. Proposed Depth 4550		19A. Formation Delaware	
20. Rotary or C.T. Rotary		21. Approx. Date Work will start As soon as possible	
21A. Kind & Status Plug. Bond Blanket		21B. Drilling Contractor Sundance Drilling Co.	
22. Elevations Show whether DE, RT, etc.) 3130.3		22. Approx. Date Work will start As soon as possible	

PROPOSED CASING AND CEMENT PROGRAM

SIZE OF HOLE	SIZE OF CASING	WEIGHT PER FOOT	SETTING DEPTH	SACKS OF CEMENT	EST. TOP
8 1/2"	5 1/8"	10.7	375	200	Surface
8 1/2"	5 1/8"	15.5	4550	500	Approx 1300

Surface casing will be set at approx 375 and cement circulated to surface. WOC time will be approx. 10 hours then a double ram 200 series Shaffer manual operated blow out preventer will be used below surface casing.

APPROVAL VALID  
FOR 90 DAYS UNLESS  
DRILLING COMMENCED,  
EXPIRES 11-4-75

1. ABOVE SPACE DESCRIBE PROPOSED PROGRAM: IF PROPOSAL IS TO DEEPEN OR PLUG BACK, GIVE DATA ON PRESENT PRODUCTIVE ZONE AND PROPOSED NEW PRODUCTION ZONE, AND BLOWOUT PREVENTER PROGRAM, IF ANY.

I hereby certify that the information above is true and complete to the best of my knowledge and belief.

Signature Messiah R. Jones Title Agent Date 7/14/75

This space for State Use

APPROVED BY W. A. Gressett TITLE SUPERVISOR, DISTRICT II DATE AUG 4 1975

FOOTNOTES OF APPROVAL, IF ANY:

**N MEXICO OIL CONSERVATION COMMISS**  
**WELL LOCATION AND ACREAGE DEDICATION PLAT**

Form C-102  
 Supersedes C-128  
 Effective 1-1-65

All distances must be from the outer boundaries of the Section.

Operator <b>Corinne Grace</b>			Lease <del>X SHARKEY 1000 X</del> <b>HOLLEY BABY</b>		Well No. <b>1</b>
Tract Letter <b>K</b>	Section <b>24</b>	Township <b>22 South</b>	Range <b>26 East</b>	County <b>Eddy</b>	
Actual Well Location of Well: <b>1650</b> feet from the <b>South</b> line and <b>2310</b> feet from the <b>West</b> line					
Ground Level Elev. <b>3188.3</b>	Producing Formation <i>Delaware</i>	Pool <i>Und. S. Carlsted Delaware</i>		Dedicated Acreage: <b>40</b> Acres	

1. Outline the acreage dedicated to the subject well by colored pencil or hachure marks on the plat below.
2. If more than one lease is dedicated to the well, outline each and identify the ownership thereof (both as to working interest and royalty).
3. If more than one lease of different ownership is dedicated to the well, have the interests of all owners been consolidated by communitization, unitization, force-pooling, etc?

☐ Yes    ☐ No    If answer is "yes," type of consolidation \_\_\_\_\_

If answer is "no," list the owners and tract descriptions which have actually been consolidated. (Use reverse side of this form if necessary.) \_\_\_\_\_

No allowable will be assigned to the well until all interests have been consolidated (by communitization, unitization, forced-pooling, or otherwise) or until a non-standard unit, eliminating such interests, has been approved by the Commission.

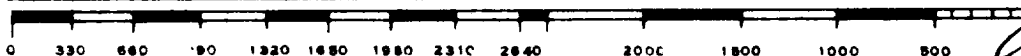
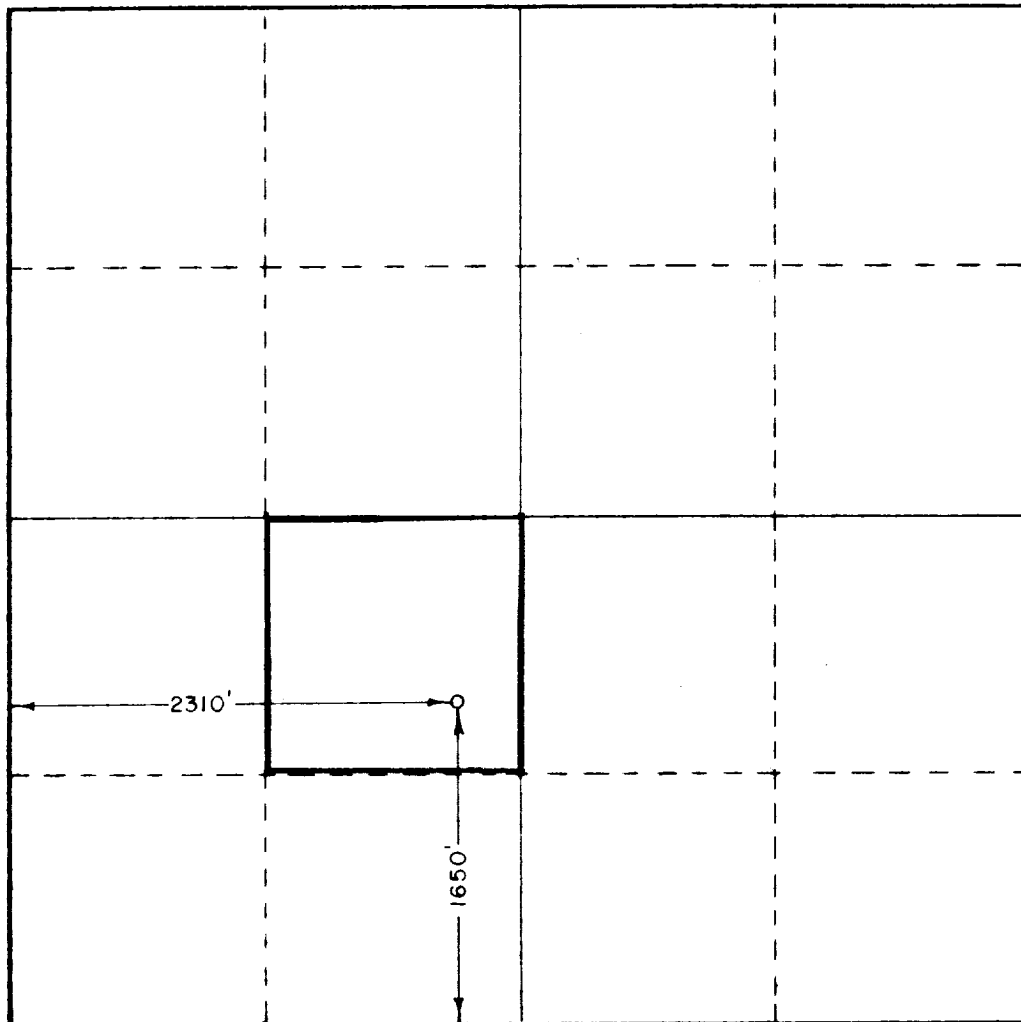

**CERTIFICATION**

I hereby certify that the information contained herein is true and complete to the best of my knowledge and belief.

Name *Francis L. Jones*  
 Position **AGENT**

Company  
**CORINNE GRACE**

Date  
**7/14/75**

I hereby certify that the well location shown on this plat was plotted from field notes of actual surveys made by me or under my supervision, and that the same is true and correct to the best of my knowledge and belief.

Date Signed **JULY 8, 1975**  
 Registered Professional Engineer and/or Land Surveyor  
 Certificate No. **676**  
**JOHN W. WEST**