

NO. OF COPIES RECEIVED	
DISTRIBUTION	
SANTA FE	
FILE	
U.S.G.S.	
LAND OFFICE	
OPERATOR	

NEW MEXICO OIL CONSERVATION COMMISSION
RECEIVED

DEC 22 1975

30-015-21621

Form C-101
Revised 1-1-65

5A. Indicate Type of Lease STATE <input checked="" type="checkbox"/> FEE <input type="checkbox"/>
5. State Oil & Gas Lease No. E 2211

APPLICATION FOR PERMIT TO DRILL, DEEPEN, OR PLUG BACK

1a. Type of Work DRILL <input checked="" type="checkbox"/> DEEPEN <input type="checkbox"/> PLUG BACK <input type="checkbox"/>		7. Unit Agreement Name
b. Type of Well OIL WELL <input checked="" type="checkbox"/> GAS WELL <input type="checkbox"/> OTHER <input type="checkbox"/> SINGLE ZONE <input type="checkbox"/> MULTIPLE ZONE <input type="checkbox"/>		8. Farm or Lease Name State
2. Name of Operator Harvey E. Yates Company, Inc.		9. Well No. #5
3. Address of Operator Suite 1000 Sec. Nat'l Bank Bldg., Roswell, New Mexico 88201		10. Field and Pool, or Wildcat Und. N. Benson Queen Grayburg
4. Location of Well UNIT LETTER <u>H</u> LOCATED <u>660</u> FEET FROM THE <u>south</u> LINE AND <u>1980</u> FEET FROM THE <u>west</u> LINE OF SEC. <u>32</u> TWP. <u>18S</u> RGE. <u>30E</u> NMPM		12. County Eddy
19. Proposed Depth 3300		19A. Formation Queen Grayburg
20. Rotary or C.T. Rotary		21. Elevations (Show whether DF, RT, etc.) 3370 GR
21A. Kind & Status Plug. Bond Blanket		21B. Drilling Contractor McBee
22. Approx. Date Work will start Jan 15, 1976		

PROPOSED CASING AND CEMENT PROGRAM

SIZE OF HOLE	SIZE OF CASING	WEIGHT PER FOOT	SETTING DEPTH	SACKS OF CEMENT	EST. TOP
11"	8 5/8"	20#	465'	circ	
7 3/4"	4 1/2"	9.5#	3,300'	200 sx	

TO RE-INSTATE & AMEND

APPROVAL VALID
FOR 90 DAYS UNLESS
DRILLING COMMENCED,

EXPIRES 3-30-76

IN ABOVE SPACE DESCRIBE PROPOSED PROGRAM: IF PROPOSAL IS TO DEEPEN OR PLUG BACK, GIVE DATA ON PRESENT PRODUCTIVE ZONE AND PROPOSED NEW PRODUCTIVE ZONE. GIVE BLOWOUT PREVENTER PROGRAM, IF ANY.

I hereby certify that the information above is true and complete to the best of my knowledge and belief.

Signed Irvin Yates Title Vice President Date 12/16/75
(This space for State Use)

APPROVED BY W. A. Gussert TITLE SUPERVISOR, DISTRICT II DATE DEC 30 1975

CONDITIONS OF APPROVAL, IF ANY:

Cement back to base of salt on 4 1/2" casing

NO. OF COPIES RECEIVED

DISTRIBUTION

SANTA FE

FILE

U.S.G.S.

LAND OFFICE

OPERATOR

NEW MEXICO OIL CONSERVATION COMMISSION

RECEIVED

SEP 5 1975

O. C. C.

OFFICE

APPLICATION FOR PERMIT TO DRILL, DEEPEN, OR PLUG BACK

1a. Type of Work

b. Type of Well DRILL ☒ DEEPEN ☐ PLUG BACK ☐

c. Name of Operator Harvey E. Yates Company, Inc.

d. Address of Operator 1000 Sec. Nat'l Bank Bldg., Roswell, New Mexico 88201

e. Location of Well UNIT LETTER N LOCATED 660 FEET FROM THE south LINE AND 1980 FEET FROM THE west LINE OF SEC. 32 TWP. 18S RGE. 30E NMPM

f. Name of Landowner Benson Queen Grayburg

g. Proposed Depth 3300

h. Location Queen Grayburg CT

i. Elevation (Show whether DE, RL, etc.) 3370 gr.

j. Kind of State Seal Blanket

k. Drilling Contractor HEYCO

l. Approx. Date Work will start October 1

PROPOSED CASING AND CEMENT PROGRAM

SIZE OF HOLE	SIZE OF CASING	WEIGHT PER FOOT	SETTING DEPTH	SACKS OF CEMENT	EST. TOP
10"	8 5/8"	32#	600'	50	circulate
8"	4 1/2"	9.5#	3300'	200	2300'

APPROVAL VALID
FOR 90 DAYS UNLESS
DRILLING COMMENCED,

EXPIRES 12-8-75

IN ABOVE SPACE DESCRIBE PROPOSED PROGRAM: IF PROPOSAL IS TO DEEPEN OR PLUG BACK, GIVE DATA ON PRESENT PRODUCTIVE ZONE AND PROPOSED NEW PRODUCTIVE ZONE. GIVE BLOWOUT PREVENTER PROGRAM, IF ANY.

I hereby certify that the information above is true and complete to the best of my knowledge and belief.

Signed Fred Yates Title Vice President Date 8/29/75

(This space for State Use)

APPROVED BY W.A. Gressett TITLE SUPERVISOR, DISTRICT II DATE SEP 8 1975

CONDITIONS OF APPROVAL, IF ANY:

Cement must be circulated to
surface behind 8 5/8" casing

RECEIVED 10 AUG 28 1975

NEW MEXICO OIL CONSERVATION COMMISSION
WELL LOCATION AND ACREAGE DEDICATION PLAT

Supersedes O.C. 25
Effective 1-1-75

All distances must be from the outer boundaries of the Section

Hwy 100		100	
N 32	18 1/4	30 East	1/4
2000 South		1700 West	
3370	Queen Grayburg	H. Benson Queen Grayburg	30

1. Outline the acreage dedicated to the subject well by colored pencil or hatchure marks on the plat below.
2. If more than one lease is dedicated to the well, outline each and identify the ownership thereof (both as to working interest and royalty).
3. If more than one lease of different ownership is dedicated to the well, have the interests of all owners been consolidated by communitization, unitization, force-pooling, etc?

☐ Yes ☐ No If answer is "yes" type of consolidation _____

If answer is "no" list the owners and tract descriptions which have actually been consolidated. (Use reverse side of this form if necessary.) _____

No allowance will be assigned to the well until all interests have been consolidated (by communitization, unitization, forced-pooling, or otherwise) or until a non-standard unit, eliminating such interests, has been approved by the Commission.

CERTIFICATION

I hereby certify that the information contained herein is true and complete to the best of my knowledge and belief.

Fred Yates

Vice President

Harvey E. Yates Company

8/29/75

I hereby certify that the well location shown on this plat is plotted from field notes of actual surveys made by me or under my supervision and that the same is true and correct to the best of my knowledge and belief.

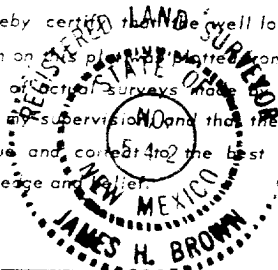

August 22nd 1975

James H. Brown
542

320 660 1320 1660 1980 2310 2640 2970 3300 3630 3960

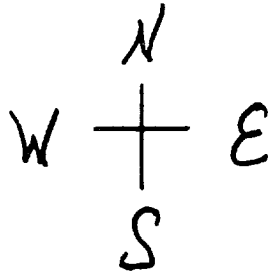

← 100' →

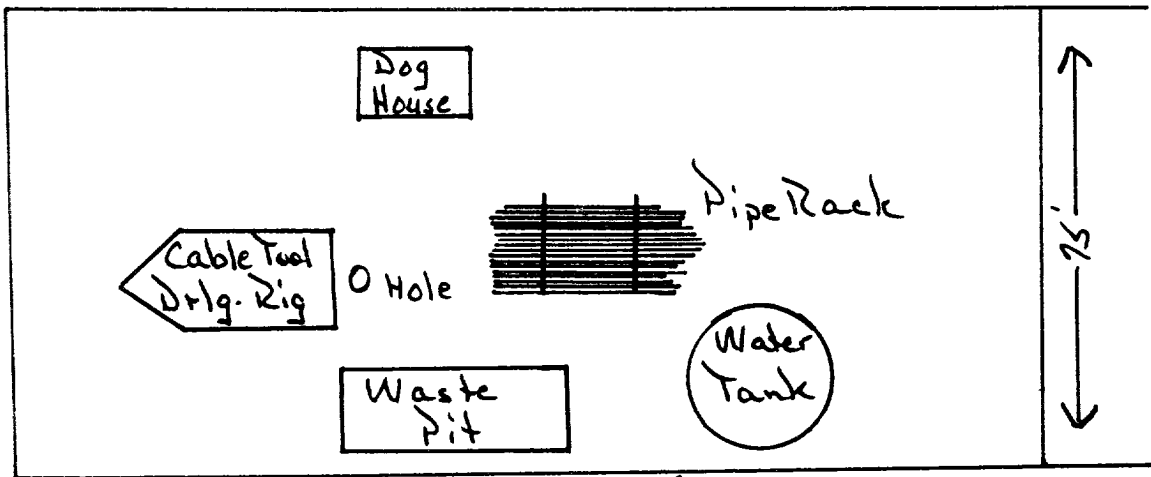

75'

1200'

