

UNITED STATES
DEPARTMENT OF THE INTERIOR
GEOLOGICAL SURVEYN. M. O. C. C. COPY
SURMIT IN TRIPLICATE*
(Other instructions on
reverse side)Form approved. Copy 651
Budget Bureau No. 42-R1425

30-015-21691

5. LEASE DESIGNATION AND SERIAL NO.
LC 029492-A

6. IF INDIAN, ALLOTTEE OR TRIBE NAME

7. UNIT AGREEMENT NAME

8. FARM OR LEASE NAME

Robinson ~~Field~~

9. WELL NO.

9

10. FIELD AND POOL, OR WILDCAT

Grayburg Jackson

11. SEC., T., R., M., OR BLK.

AND SURVEY OR AREA

Section 12-25

T16S, R31E

12. COUNTY OR PARISH

Eddy

13. STATE

N.M.

14. DISTANCE IN MILES AND DIRECTION FROM NEAREST TOWN OR POST OFFICE*

4.5 miles W-NW of Maljamar, New Mexico

15. DISTANCE FROM PROPOSED* 330 FEL, FNL of

LOCATION TO NEAREST

PROPERTY OR LEASE LINE, FT. Unit 0

(Also to nearest drig. unit line, if any)

16. NO. OF ACRES IN LEASE

560

17. NO. OF ACRES ASSIGNED

TO THIS WELL 40

18. DISTANCE FROM PROPOSED LOCATION*

TO NEAREST WELL, DRILLING, COMPLETED, 660 Feet

OR APPLIED FOR, ON THIS LEASE, FT. North

19. PROPOSED DEPTH

4100'

20. ROTARY OR CABLE TOOLS

Rotary

21. ELEVATIONS (Show whether DF, RT, GR, etc.)

4192 G.L.

22. APPROX. DATE WORK WILL START*

December 1, 1975

23.

PROPOSED CASING AND CEMENTING PROGRAM

SIZE OF HOLE

SIZE OF CASING

WEIGHT PER FOOT

SETTING DEPTH

QUANTITY OF CEMENT

12 1/4"

8 5/8"

28.0

425'

330 ft³

7 7/8"

4 1/2"

10.5

4100'

As required.

1) Drill to T.D., log and test.

2) Run 4 1/2" long string to T.D.

3) This well is being drilled to replace Robinson #3 which has junk in

the hole. The #3 well will be utilized in water-flood operations

or abandoned.

RECEIVED

DEC 8 1975

O. C. C.

ARTESIA, OFFICE

RECEIVED

NOV 24 1975

U. S. GEOLOGICAL SURVEY

ARTESIA, NEW MEXICO

IN ABOVE SPACE DESCRIBE PROPOSED PROGRAM: If proposal is to deepen or plug back, give data on present productive zone. If proposal is to drill or deepen directionally, give pertinent data on subsurface locations and measured and true vertical depths. Give flow rate and pressure.

SIGNED

T. M. Boyd

TITLE

Agent

DATE

11/19/75

(This space for Federal or State office use)

PERMIT NO.

APPROVED BY

CONDITIONS OF APPROVAL, IF ANY:

DEC 5 1975

G. C. BEEKMAN

ACTING DISTRICT ENGINEER

THIS APPROVAL IS REFINDED IF OPERATIONS
ARE NOT COMMENCED WITHIN 3 MONTHS
EXPIRES MAR 5 - 1976

*See Instructions On Reverse Side

NEW MEXICO OIL CONSERVATION COMMISSION
WELL LOCATION AND ACREAGE DEDICATION PLAT

Form 1-101
Supersedes 1-100
Effective 1-1-75

All distances must be from the outer boundaries of the Section.

Owner MURPHY MINERALS CORP.				Lease ROBINSON-XXXXXX		Well No. 9	
Tract Letter 0	Section 25	Township 16 S.	Range 31 E.	County Eddy County			
Actual Surface Location of Well: 2310 feet from the EAST line and 990 feet from the SOUTH line.							
Section Corner (Flow) 4192	Produced Formation Premier Lovington		Pool Grayburg-Jackson		Dedicated Acreage 40 Acres		

- Outline the acreage dedicated to the subject well by colored pencil or hatchure marks on the plat below.
- If more than one lease is dedicated to the well, outline each and identify the ownership thereof (both as to working interest and royalty).
- If more than one lease of different ownership is dedicated to the well, have the interests of all owners been consolidated by communitization, unitization, force-pooling, etc?
☐ Yes ☐ No If answer is "yes," type of consolidation _____

If answer is "no," list the owners and tract descriptions which have actually been consolidated. (Use reverse side of this form if necessary.) _____

No allowable will be assigned to the well until all interests have been consolidated (by communitization, unitization, forced-pooling, or otherwise) or until a non-standard unit, eliminating such interests, has been approved by the Commission.

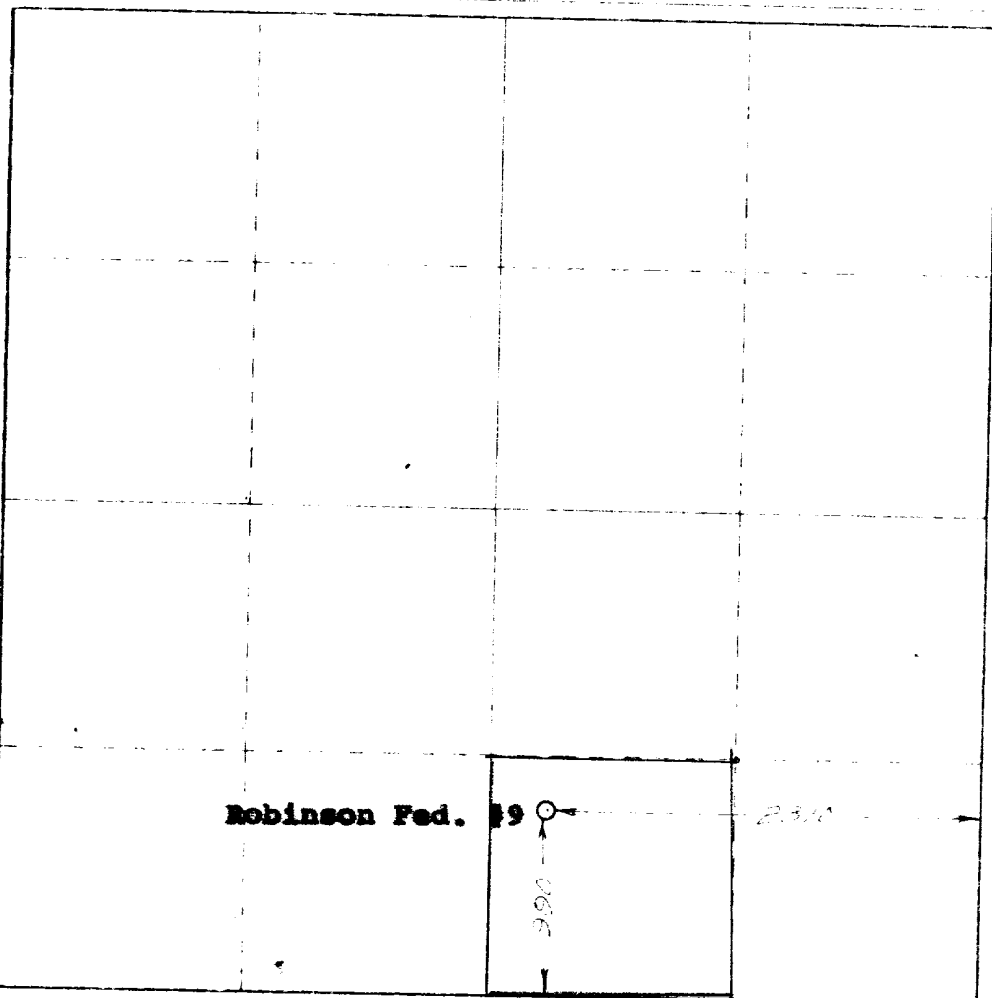

CERTIFICATION

I hereby certify that the information contained herein is true and complete to the best of my knowledge and belief.

T. M. Boyd

T. M. Boyd

Agent

Murphy Minerals Corp.

November 19, 1975

I hereby certify that the location shown on this plat was plotted on field notes made by **HERSCHEL JONES** under my supervision and that the same is true and correct to the best of my knowledge and belief.



July 2, 1975

Herschel Jones

3640

DEVELOPMENT PLAN FOR SURFACE USE

UNITED STATES GEOLOGICAL SURVEY

Southern Rocky Mountain Area

Date: November 19, 1975

Well Robinson Federal #9 Location Sw/4, SE/4 Sec. 25 T16S, R31E

1. Existing roads including location of the exit from the main highway, See attached maps.
2. Planned access roads. See attached maps.
3. Location of existing wells. See attached maps.
4. Lateral roads to well locations. See attached maps.
12' wide approximately 400' long.
5. Location of tank batteries and flow lines. See attached maps.
Utilize present tank battery site. Flow lines directly to tank battery.
6. Location and type of water supply (rivers, creeks, lakes, ponds, well, etc.).
Water Flood Associates, Inc. water line approximately 125' NW
of this location. Ogalla water.
7. Methods for handling waste disposal. A separate waste disposal pit will be
dug to bury trash not less than two feet.
8. Location of camps. None
9. Location of airstrips. None

10. Location of layout to include position of the rig, mud tanks, reserve pits, burn pits, pipe racks, etc. WEK Drilling Rig 2. See attached plat.
-
-
11. Plans for restoration of the surface. All surface on roads and locations not utilized in producing this well will be ripped and re-seeded.
-
-
12. Any other information that may be used in evaluating the impact on environment. Include general description of the topography, vegetation, and other aspects of the area. This is an area of development with plans to initiate a water-flood. No additional.
-
-
-
-

Company MURPHY MINERALS CORPORATION

Representative T. M. Boyd

Phone: Office 623-6044 Home 623-6400

Address Boyd Operating Company
Petroleum Building - Tower Suite
Roswell, New Mexico 88201

W E A DRILLING CO. INC.

Rig #1 Location & Mud Pit Specs.

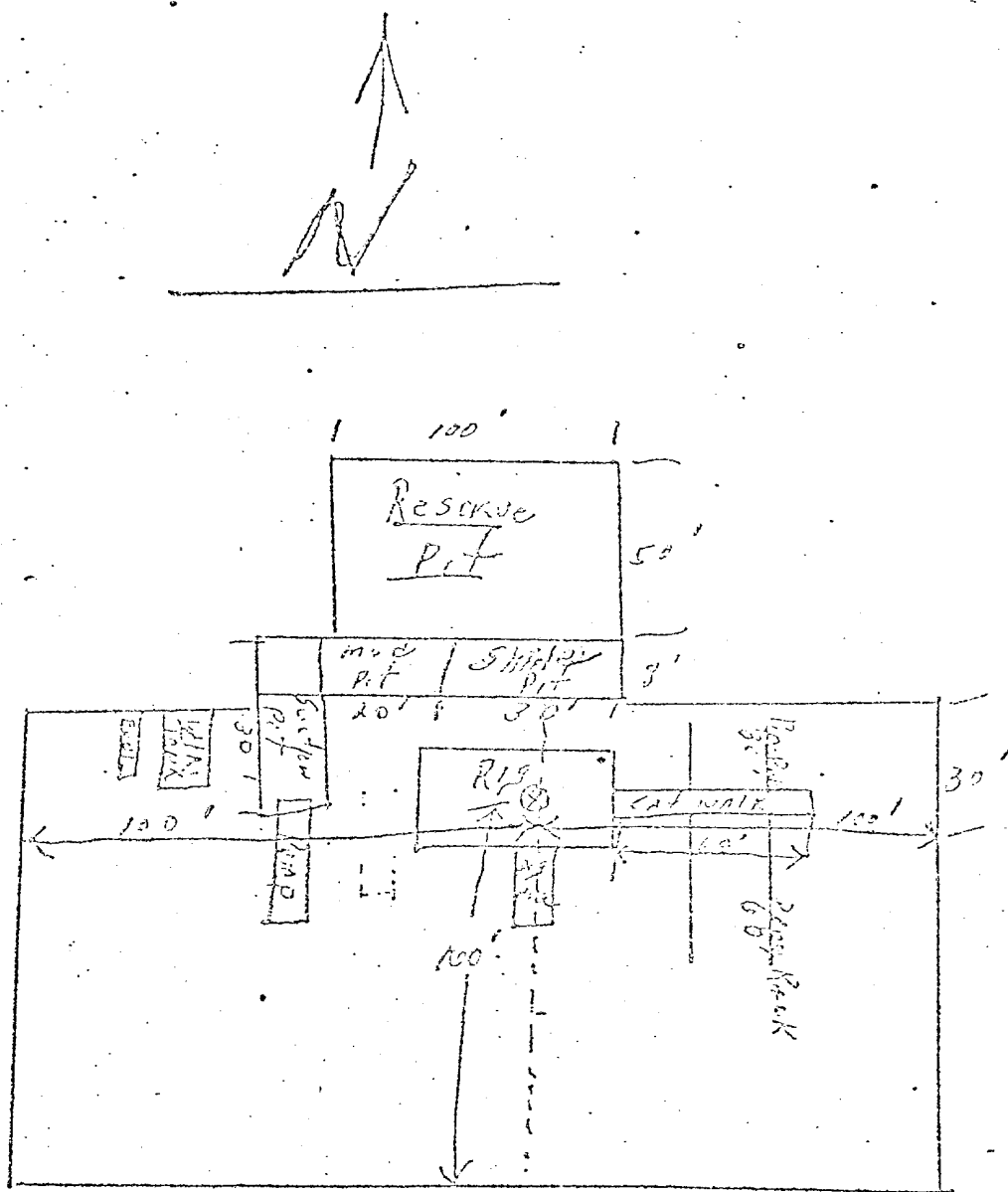

Schaeffer Type E 10" Series 900 Hydraulic BOP. The waste and debris from this well will be disposed of in a reserve pit and covered up.

Eddy & Lea Counties
New Mexico

