

N. M. O. C. C. COPY
UNITED STATESSUBMIT IN TRIPPLICATE
Other instructions on
reverseForm Approved
Budget Bureau No. 42-R1425.DEPARTMENT OF THE INTERIOR
GEOLOGICAL SURVEY615-72056
3. LEASE DESIGNATION AND SERIAL NO.

NM 025604

4. IF INDIAN, ALLOTTEE OR TRIBE NAME

APPLICATION FOR PERMIT TO DRILL, DEEPEN, OR PLUG BACK

1a. TYPE OF WORK

DRILL ☒DEEPEN ☐PLUG BACK ☐

b. TYPE OF WELL

OIL
WELL ☒GAS
WELL ☐

OTHER

SINGLE
ZONE ☒MULTIPLE
ZONE ☐

2. NAME OF OPERATOR

Atlantic Richfield Company

3. ADDRESS OF OPERATOR

Box 1710, Hobbs, New Mexico 88240

4. LOCATION OF WELL (Report location clearly and in accordance with any State requirements.)*

At surface

1186' FSL & 1372' FEL (Unit letter O)

At proposed prod. zone

14. DISTANCE IN MILES AND DIRECTION FROM NEAREST TOWN OR POST OFFICE

Approx 13 miles East of Artesia, New Mexico

15. DISTANCE FROM PROPOSED

LOCATION TO NEAREST

PROPERTY

TOWN OR POST OFFICE

16. NO. OF ACRES IN LEASE

17. NO.

ACRES ASSIGNED

TO WELL

40

18.

19. PROPOSED DEPTH

20.

21. DATE WORK WILL START*

21. ELEVATIONS (Show whether DF, RT, GR, etc.)

3516.7' GR

23.

24. PROPOSED DRILLING AND CEMENTING PROGRAM

SIZE OF CEMENT	WEIGHT OF CEMENT	DEPTH	QUANTITY OF CEMENT
11"	8-5/8" OD	24# K-55	1000'
7-7/8"	6-1/2" OD	14 & 15.0	1725 sx
			Circ to surface
			Circ to surface

Propose to drill an infill development well within the Empire Abo Unit area to more economically recover additional oil reserves and conserve reservoir pressure in accordance with OCC Rules & Regulations.

RECEIVED

JAN 24 1977

U.S. GEOLOGICAL SURVEY
ARTESIA, NEW MEXICO

preventer program, if any.

24.

SIGNED

[Signature]

TITLE

Dist. Drlg. Supt.

DATE

1/24/77

(This space for Federal or State office use)

PERMIT NO.

APPROVAL DATE

APPROVED BY

CONDITIONS OF APPROVAL, IF ANY:

TITLE

DATE

ACTING DISTRICT ENGINEER

THIS APPROVAL IS REVOKED IF CONDITIONS
ARE NOT COMPLIED WITH IN 145.
EXPIRES
*See Instructions On Reverse Side

NEW MEXICO OIL CONSERVATION COMMISSION
WELL LOCATION AND ACREAGE DEDICATION PLAT

Form No. 1
Superseded by Form No. 1-1
Date 1-1-75

All distances must be from the outer boundaries of the Section

ATLANTIC RICHFIELD COMPANY			Empire Abo Unit "L"			112		
Section	Well No.	Township	Range	Meridian				
0	3	18 South	27 East	Eddy				
Location of Well:								
1186		feet from the	south	line and	1372	feet from the	east	
Ground Elev.	Producing Formation		For					
3516.7	Abo Reef		Empire Abo		40			

1. Outline the acreage dedicated to the subject well by colored pencil or hatchure marks on the plat below.
2. If more than one lease is dedicated to the well, outline each and identify the owner (up to the well as to working interest and royalty).
3. If more than one lease of different ownership is dedicated to the well, have the well dedicated by communitization, unitization, force-pooling, etc?

☒ Yes ☐ No If answer is "yes," type of consolidation Unitization

If answer is "no," list the owners and tract descriptions which have actually been consolidated (on reverse side of this form if necessary.)

No allowable will be assigned to the well until all interests have been consolidated (by communitization, unitization, force-pooling, or otherwise) or until a non-standard unit, eliminating such interests, has been approved by the Commission.

RECEIVED
JAN 27 1977
U.S. GEOLOGICAL SURVEY
ARTESIA, NEW MEXICO

CERTIFICATION

I hereby certify that the information furnished herein is true and complete to the best of my knowledge and belief.

John W. West
Dist. Dir. Supt.

Atlantic Richfield Company

1/24/77

I hereby certify that the well location shown on this plat was plotted from field notes of actual surveys made by me or under my supervision and that the same is true and correct to the best of my knowledge and belief.

Sept 30, 1976

John W. West
676

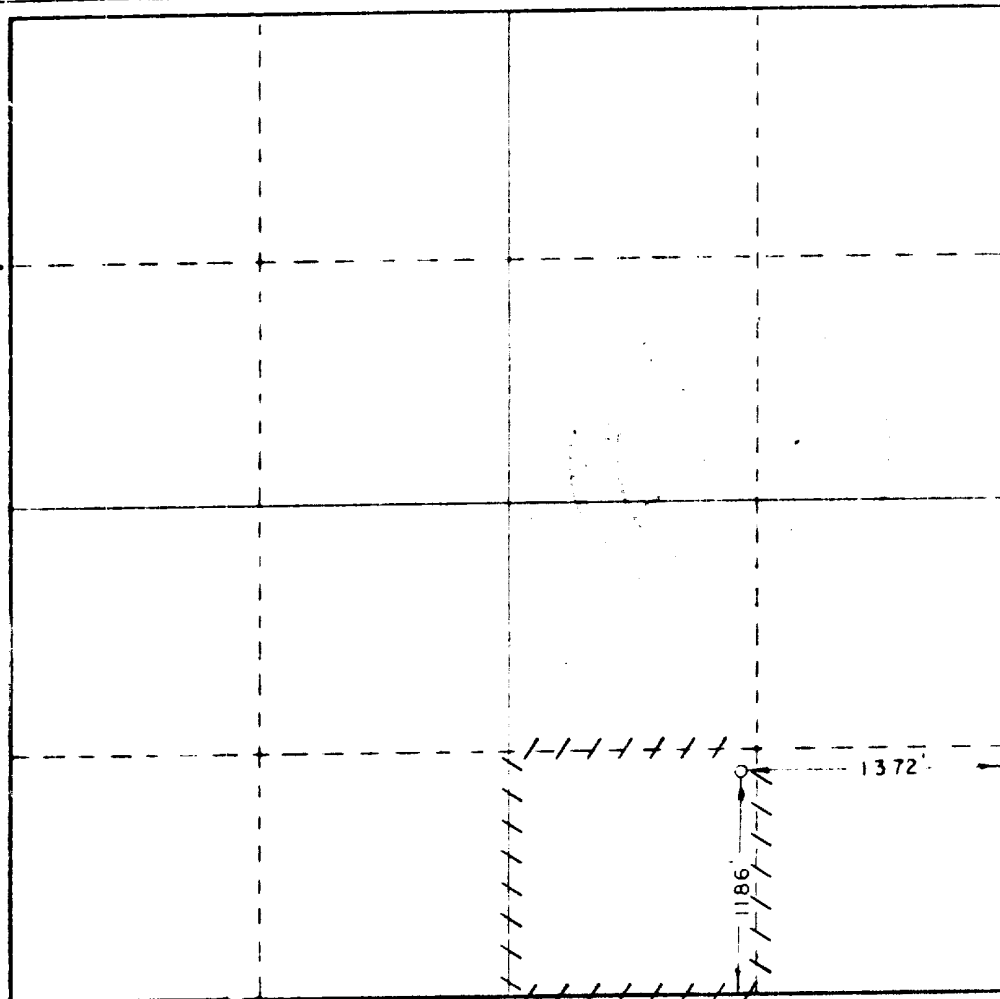

330 660 990 1320 1650 1980 2310 2640 2970 3300 3630 3960 4290 4620 4950 5280 5610 5940 6270 6600 6930 7260 7590 7920 8250 8580 8910 9240 9570 9900

To supplement USGS Form 9-331-C, "Application for Permit to Drill, Deepen, or Plugback" the following additional information is submitted:

Operator: Atlantic Richfield Company
Lease & Well No: Empire Abo Unit "L" #112
Location: Unit letter O, 1186' FSL & 1372' FEL
Section 3-18S-27E, Eddy County, New Mexico

RECEIVED

FEB 03 1977

U.S. GEOLOGICAL SURVEY
ARTESIA, NEW MEXICO

1. See Form 9-331C
2. See Form 9-331C
3. The geologic name of the surface formation is: Tertiary with some Triassic exposed.
4. See Form 9-331C
5. See Form 9-331C
6. The estimated tops of important geologic markers are: Queen 940', San Andres 1867', Glorieta 3335', Abo 5252'.
7. The estimated depths at which anticipated water, oil, gas or other mineral bearing formations are expected to be encountered are:
Santa Rosa Water Formation $\pm 300'$ brackish.
Empire Yates Seven Rivers $\pm 340'$ Oil & Gas.
Artesia Grayburg Queen SA 940' Oil & Gas.
Abo 5252' Oil & Gas.
8. The proposed casing program, including the size, grade and weight-per-foot of each string has been indicated on Form 9-331C. All strings of casing will be new.
9. See Form 9-331C for amount of cement. Cl C cement cont'g 4% gel, $\frac{1}{4}$ # floccle, 6# salt/sk & 2% CaCl will be used for cmtg surface csg. Cl C cement 50:50 pozmix cont'g 2% gel, .6% CFR-2, 8# salt/sk & 5# gilsonite/sk will be used to cmt 1st stage on production string and HLW cmt cont'g 8#/sk salt, followed by Cl C cmt cont'g 8#/sk salt will be used to cement 2nd stage.
10. The pressure control diagram is attached to Form 9-331C. The following additional information is as follows: Size - 10"-900 Series Dbl Hyd Pipe and Blind Rams.

Pressure ratings (or API Series): 3000# WP, 6000# T.

Testing Procedures: Pressure up to 1500# PSIG before drilling out of casing.

Testing Frequency: Upon installation, daily and on all trips.

11. The type and characteristics of the proposed circulating medium or mediums to be employed for rotary drilling and the quantities and types of mud and weighting material to be maintained will be as follows:

0-1000' spud mud; 1000-5150' brackish water; 5150-6100' SWG 34-48
Vis, 5-8 WL; 30,000 PPM salinity.

12. The auxiliary equipment to be used will consist of:

Kelly cocks and a sub on floor with full opening valve to be used when needed. No mud logging to be performed.

13. The testing, logging and coring programs will be:

GR-DLL w/RXO (MSFL) & caliper, GR-Calibrated Neutron, CNL-FDC, Sonic, Tape logs for Coriband Analysis. No coring or DST will be run.

14. No abnormal pressures or temperatures are expected to be encountered.

15. The starting date will be approx 3/15/77 and will be completed approx 3/30/77.

A handwritten signature in dark ink, appearing to be "J. P. ...", is located below the text of item 15.

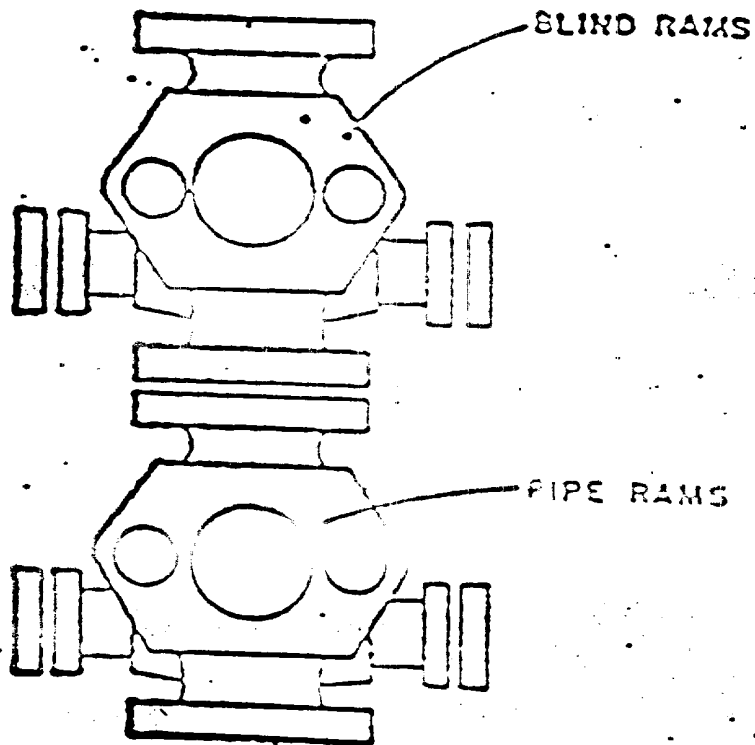

ATLANTIC RICHFIELD COMPANY
Blow Out Preventer Program

Lease Name No Unit "L"

Well No. 111

Location 1186' FSL & 1372' FEL

BOP to be tested before installed on well and will be maintained in good working condition during drilling. All wellhead fittings to be of sufficient pressure to operate in a safe manner.

Multi-Point Surface Use and Operations Plan

Atlantic Richfield Company
Well No. "L" 112 Empire Abo Unit
1186' FSL & 1372' FEL Sec 3-T18S-R27E
Eddy County, New Mexico
Lease, New Mexico 025604
(Development Well)

RECEIVED

JAN 27 1977
U.S. GEOLOGICAL SURVEY
ARTESIA, NEW MEXICO

This plan is submitted with the Application for Permit to Drill the above described well. The purpose of the plan is to describe the location of the proposed well, the proposed construction activities and operations plan, the magnitude of necessary surface disturbance involved and the procedures to be followed in rehabilitating the surface after completion of the operation so that a complete appraisal can be made of the environmental effects associated with the operation.

1. Existing Roads:

- A. Exhibit "A" From Artesia, go East 9 miles on U.S. Highway 82, turn South off Highway 82 on AMOCO Gasoline Plant block top road 2.2 miles, turn South off block top road 1.0 mile, go West .2 mile, then Southwest approximately 200 feet along staked and flagged proposed new road to location.
- B. Exhibit "B" is a plat showing all existing roads within a one mile radius of the well site and the planned access road.

2. Planned Access Roads:

- A. Length & Width: New roads required will be approximately 200' long and 12' wide. This road is labeled and color coded red on Exhibit "B". The center line of road has been staked and flagged with the stakes being visible from any one to the next.
- B. Turnouts: none
- C. Culverts: none
- D. Cuts and Fills: none, level pad only.
- E. Gates, Cattleguards: none

3. Location of Existing Wells:

- A. See Exhibit "B" for existing wells within a 1 mile radius of location.

4. Location of Existing and/or Proposed Facilities:

- A. Location of the existing tank battery and flow lines from well "L" 112 are shown on Exhibit "C". The gas injection and salt water disposal lines are buried. The flow lines are not buried.
- B. When the proposed well is completed for production the location of the new flow line to the existing battery is shown on Exhibit "C". The line will not be buried. The proposed flow line has not been staked and flagged.

5. Location and Type of Water Supply:

- A. Water for drilling will be from a fresh water supply well within the Empire Abo Unit boundaries located in Section 6-18S-28E and transported by pipeline to well site. The water line will not cause additional surface disturbance and will be removed after drilling is completed.

6. Source of Construction Materials:

- A. Johnson Construction Co., P. O. Box 837, Eddy, New Mexico, will be furnishing caliche for surfacing the road and well pad. The source of caliche will be from an existing pit located in SW1/4, Sec 34-18S-27E, Eddy County and royalty fees will be paid by Johnson Construction Company.

7. Methods of Handling Waste Disposal:

- A. Drill cuttings will be disposed of in the drilling pits.
- B. Drilling fluids will be allowed to evaporate in the drilling pits until pits are dry.
- C. Water produced during test will be disposed of in the drilling pits. Oil produced during tests will be stored in test tanks until sold.
- D. Current laws and regulations pertaining to the disposal of human waste will be complied with.
- E. Trash, wastepaper, garbage and junk will be covered with a minimum of 24 inches of dirt. All waste material will be contained to prevent scattering by the wind.
- F. All trash and debris will be buried or removed from the well site within 30 days. After finishing drilling and/or completion operations.

8. Ancillary Facilities: none

9. Wellsite Layout:

- A. Exhibit "D" show the relative location & dimensions of the well pad, mud pits, reserve pit and location of major rig components.
- B. Only minor levelling of the well site will be required. No significant cuts & fills will be necessary.
- C. The reserve pit will be plastic lined.
- D. The pad & pit area has been staked and flagged.

10. Plans for Restoration of the Surface:

- A. After completion of drilling and/or completion operations all equipment and other material not needed for operations will be removed. Pits will be filled and location cleaned of all trash and junk to leave the well site in an aesthetically pleasing condition as possible.
- B. Any unguarded pits containing fluids will be fenced until they are filled.
- C. On Federal surface - after abandonment, any special revegetation or surface revegetation requirements of the surface management agency will be complied with and accomplished as expeditiously as possible. All pits to be abandoned within 90 days.

11. Other Information:

- A. Topography: rolling hills
- B. Soil: Caliche and Sand
- C. Flora and Fauna: Flora consists of cockle burr, needle grass, rag weed, grease bush and cat claw and native grasses. Fauna consists of coyotes, jack rabbits, cotton tails, hawks, dove field larks and rattlesnakes.
- D. Ponds and Streams: none
- E. Residences and Other Structures: none
- F. Land Use: Oil & Gas Production, grazing and hunting in season.
- G. Surface Ownership: BLM

12. Operator's Representative:

The field representative responsible for assuring compliance with the approved surface use and operations plan are as follows:

Name: Jack D. Jones
Address: P. O. Box 1710, Hobbs, New Mexico 88240

Office Phone: 505 - 393-7163
Home Phone: 505 - 392-5268

13. Certification:

I hereby certify that I, or persons under my direct supervision, have inspected the proposed drillsite and access route; that I am familiar with the conditions which presently exist; that the statements made in this plan are, to the best of my knowledge, true and correct; and, that the work associated with the operations proposed herein will be performed by Atlantic Richfield Company and its contractors and subcontractors in conformity with this plan and the terms and conditions under which it is approved.

Date

J. D. Jones
District Drilling Supervisor

R 27 E

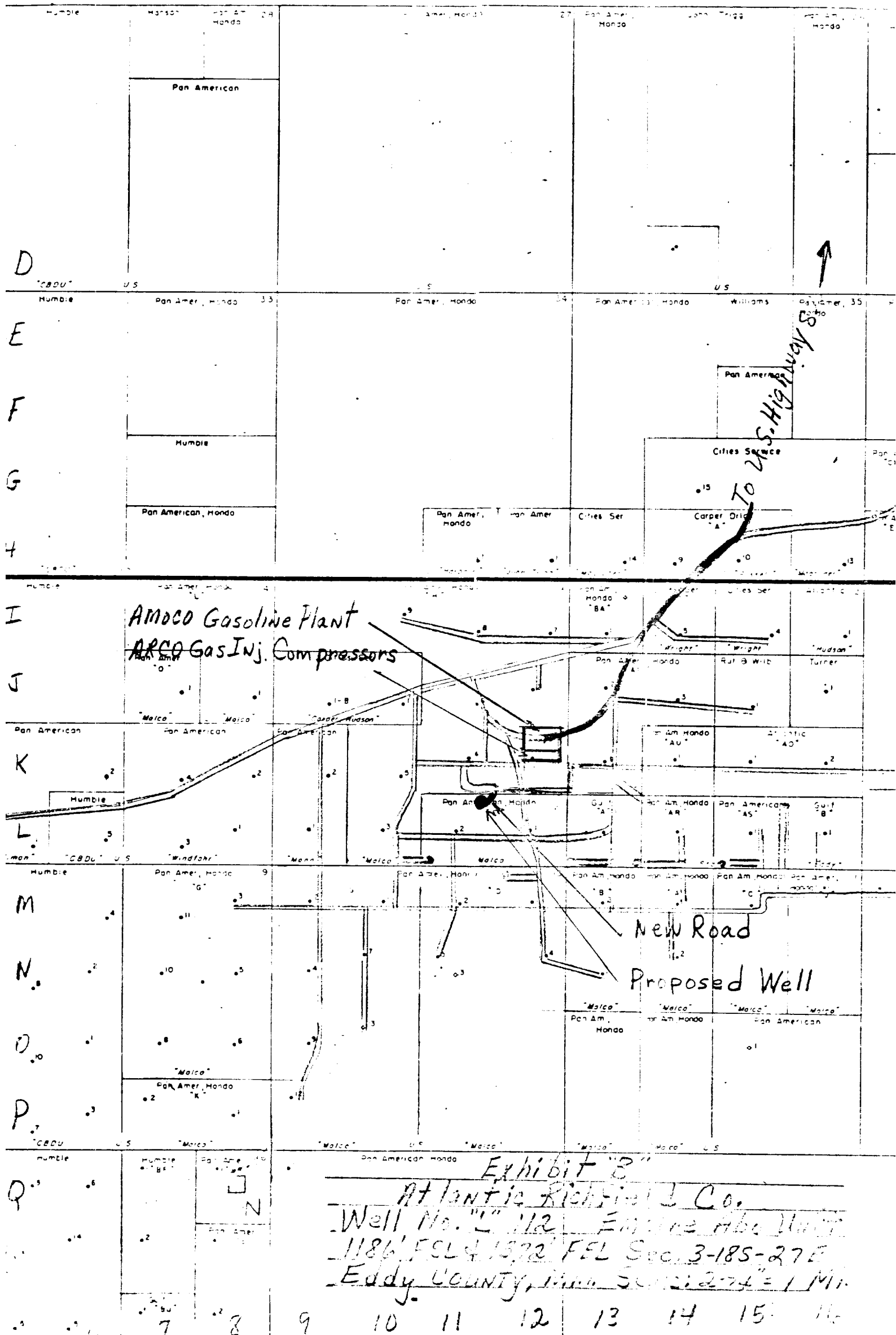
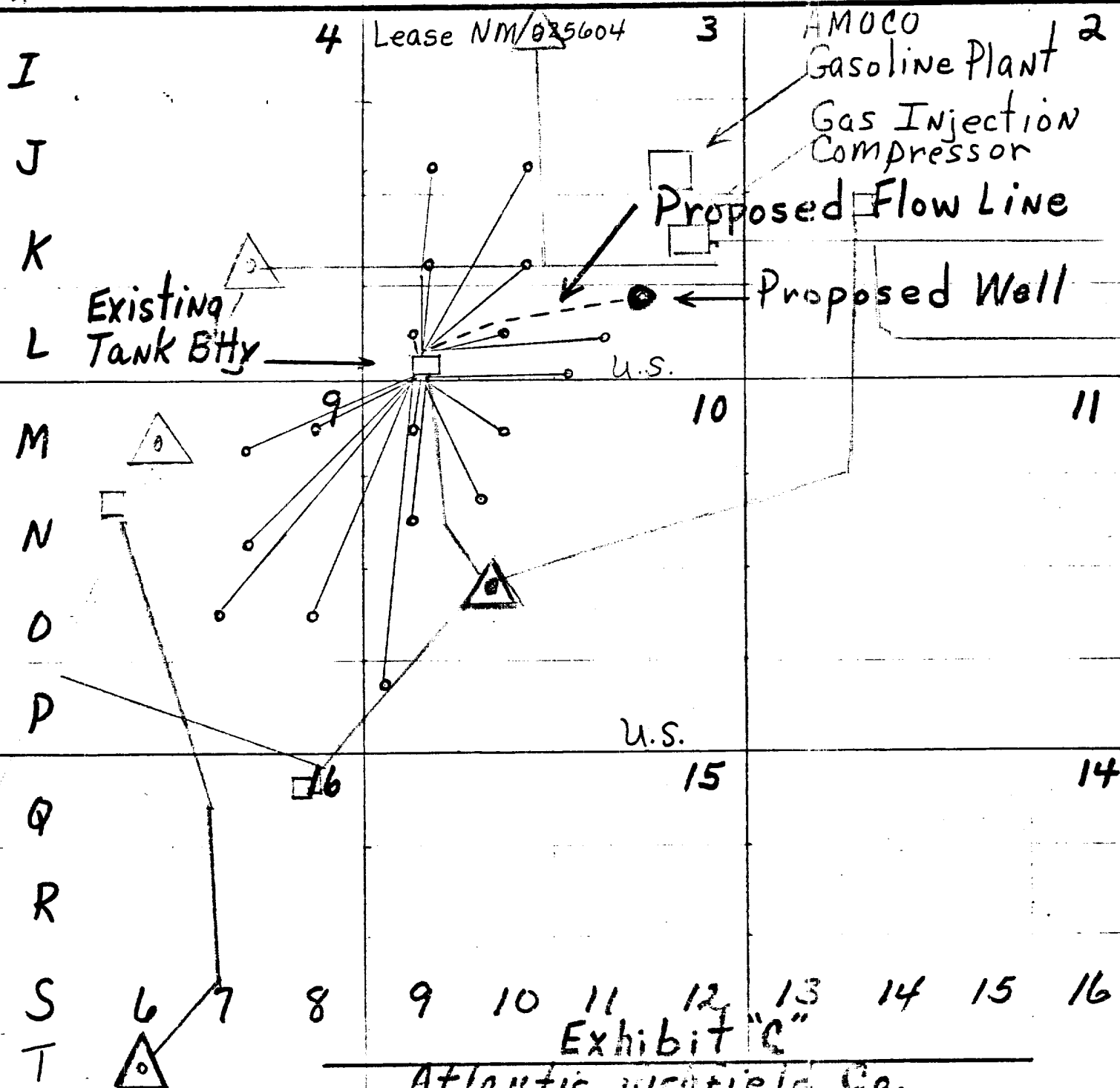

Exhibit "B"
Atlantic Richfield Co.
Well No. "L" 112 - Engine Abu Unit
1186' FSL & 1372' FEL Sec. 3-185-27E
Eddy County, N.M. Sec. 2-74 = 1 Mi.

--- Gas Injection Lines
 ▲ Salt Water Disposal Wells
 H Salt Water Disposal Lines



Atlantic Montfield Co.
Well No "L" 112 Empire H.S. Unit
1186' FSL & 1372' FEL Sec. 3-18S-27E
Eddy County, N.M. Scale: 2-3/4" = 1 Mi.

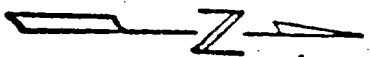

Exhibit "D"
Atlantic Richfield Co.
Rig Layout
Well No. 2112 Empire Abo W.
1186 FSL & 1372 FEL Sec. 3-185
Eddy County, N.M.

Atlantic Richfield Company
Engineering and Construction Dept.
STANDARD DRILLING MAT
FOR WELLS LESS THAN 3000 FEET
Atlantic Richfield Co.
P.O. Box 1000
Houston, Texas 77001
1974