

NEW MEXICO OIL CONSERVATION COMMISSION
WELL LOCATION AND ACREAGE DEDICATION PLAT

Form C-102
Supersedes C-128
Effective 1-1-75

All distances must be from the outer boundaries of the Section

Operator Depco Inc.		Lease State 648		Well No. 225
Unit Letter P	Section 25	Township 18 South	Range 27 East	County Eddy
Actual Footage Location of Well: 990 feet from the South line and 930 feet from the East line				
Ground Level Elev. 3547.2	Producing Formation Grayburg	Fluid Artesia (Qn, Grb, S.A.)	Dedicated Acreage: 40 Acres	

1. Outline the acreage dedicated to the subject well by colored pencil or hatchure marks on the plat below.
2. If more than one lease is dedicated to the well, outline each and identify the ownership thereof (both as to working interest and royalty).
3. If more than one lease of different ownership is dedicated to the well, have the interests of all owners been consolidated by communitization, unitization, force-pooling, etc?

☐ Yes ☐ No If answer is "yes," type of consolidation _____

If answer is "no," list the owners and tract descriptions which have actually been consolidated. (Use reverse side of this form if necessary.) _____

No allowable will be assigned to the well until all interests have been consolidated (by communitization, unitization, forced-pooling, or otherwise) or until a non-standard unit, eliminating such interests, has been approved by the Commission.

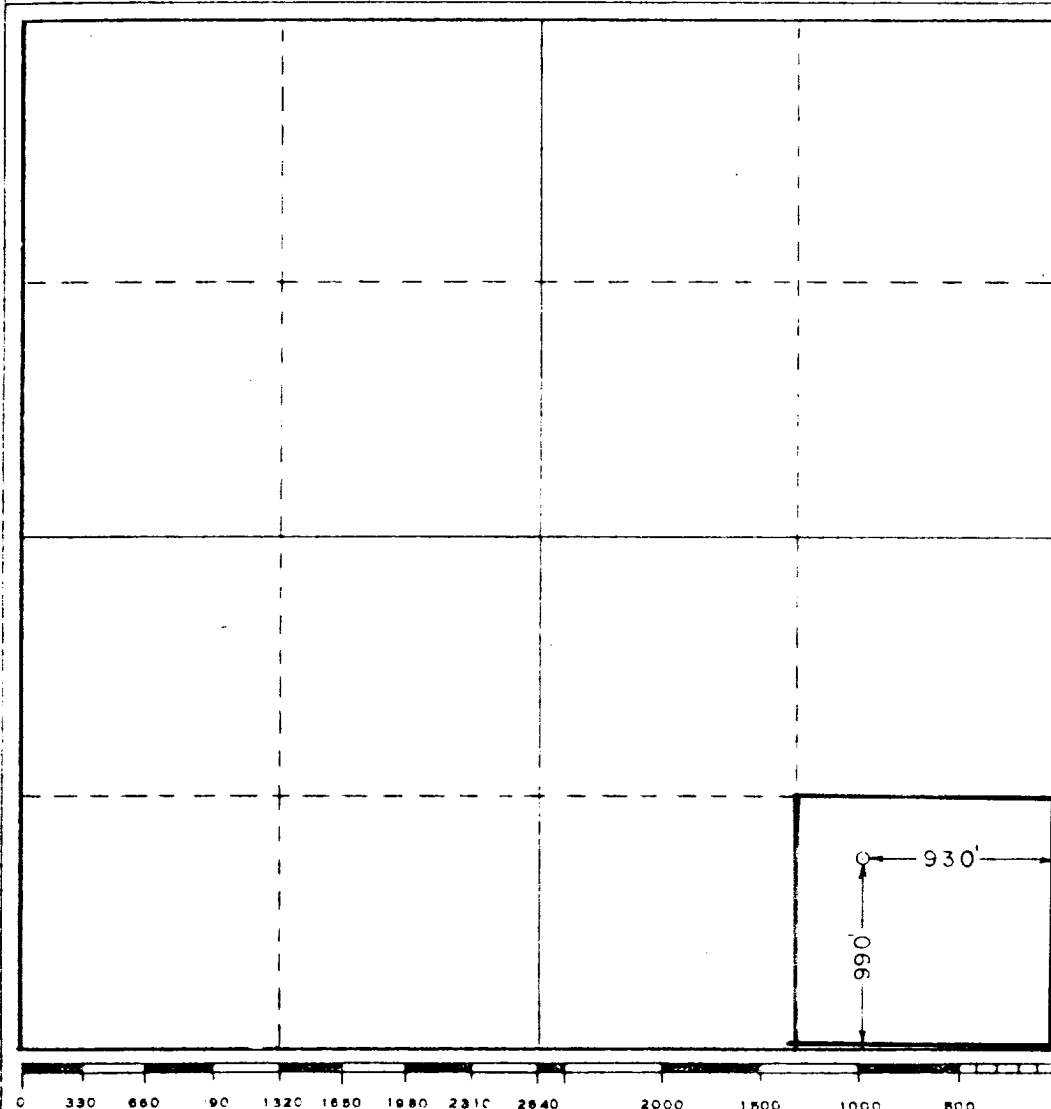

CERTIFICATION

I hereby certify that the information contained herein is true and complete to the best of my knowledge and belief.

D. R. Mason
Name

D. R. Mason

Position

Chief Clerk

Company

DEPCO, Inc.

Date

12-29-77

I hereby certify that the well location shown on this plat was plotted from field notes of actual surveys made by me or under my supervision, and that the same is true and correct to the best of my knowledge and belief.

Date Surveyed

December 17, 1977

Registered Professional Engineer
and/or Land Surveyor

James W. West
Certificate No.

676