

NO. OF COPIES RECEIVED	5
DISTRIBUTION	
SANTA FE	1
FILE	1
U.S.G.S.	2
LAND OFFICE	
OPERATOR	1

RECEIVED

NEW MEXICO OIL CONSERVATION COMMISSION
JUN 27 1978

O. C. C.
ARTESIA, OFFICE

30-015-22596
Form C-101
Revised 1-1-65

5A. Indicate Type of Lease	STATE <input type="checkbox"/>	FEE <input checked="" type="checkbox"/>
5. State Oil & Gas Lease No.		

APPLICATION FOR PERMIT TO DRILL, DEEPEN, OR PLUG BACK

1a. Type of Work		7. Unit Agreement Name	
b. Type of Well DRILL <input checked="" type="checkbox"/> DEEPEN <input type="checkbox"/> PLUG BACK <input type="checkbox"/> OIL WELL <input checked="" type="checkbox"/> GAS WELL <input type="checkbox"/> OTHER <input type="checkbox"/> SINGLE ZONE <input checked="" type="checkbox"/> MULTIPLE ZONE <input type="checkbox"/>		8. Farm or Lease Name Pardue Farms	
2. Name of Operator Amoco Production Company		9. Well No. 2	
3. Address of Operator P.O. Drawer A, Levelland, Texas 79336		10. Hold and Oper., or Willent -Bone Springs	
4. Location of Well UNIT LETTER <u>G</u> LOCATED <u>1650</u> FEET FROM THE <u>north</u> LINE AND <u>1650</u> FEET FROM THE <u>east</u> LINE OF SEC. <u>26</u> TWP. <u>23-S</u> RGE. <u>28-E</u> NMPM		12. County Eddy	
18. Proposed Depth 6400'		19A. Formation Bone Springs	
20. Rotary or C.T. Rotary		21. Elevations (Show whether DE, RT, etc.) 3007.4 GR	
21A. Kind & Status Plug. Bend Blanket-on file		21B. Drilling Contractor Landis	
22. Approx. Date Work will start 7-10-78			

23.

PROPOSED CASING AND CEMENT PROGRAM

SIZE OF HOLE	SIZE OF CASING	WEIGHT PER FOOT	SETTING DEPTH	SACKS OF CEMENT	EST. TOP
12 1/4"	8 5/8"	24#	400'	Circulated to	surface
7 7/8"	5 1/2"	14#	6400'	Circulated to	top of Delaware

After drilling well, logs will be run and evaluations made, perforating and/or stimulating as necessary in attempting commercial production.

Mud Program: 0' - 400' - Native mud and fresh water.
400' - 6400' - Native mud and brine water.

BOP Program attached.

APPROVAL VALID
FOR 90 DAYS UNLESS
DRILLING COMMENCED,

EXPIRES, 9-30-78

IN ABOVE SPACE DESCRIBE PROPOSED PROGRAM: IF PROPOSAL IS TO DEEPEN OR PLUG BACK, GIVE DATA ON PRESENT PRODUCTIVE ZONE AND PROPOSED NEW PRODUCTIVE ZONE. GIVE BLOWOUT PREVENTER PROGRAM, IF ANY.

I hereby certify that the information above is true and complete to the best of my knowledge and belief.

Signed A. V. Hardy Title Admin. Analyst Date 6-26-78

(This space for State Use)

APPROVED BY W. A. Gressett TITLE SUPERVISOR, DISTRICT II DATE JUN 30 1978

CONDITIONS OF APPROVAL, IF ANY:

0+4-NMOCC-A; 1-Div; 1-Susp; 1-AVH

NEW MEXICO OIL CONSERVATION COMMISSION
WELL LOCATION AND ACREAGE DEDICATION PLAT

Form O-122
Superseded O-128
Effective 1-1-65

All distances must be from the outer boundaries of the Section

Operator Amoco Production Co.		Lease Pardue Farms		Area 4 2	
Section G	Range 26	Township 23 South	Range 28 East	County Eddy	
Acres of Section Dedicated to Well		Feet from the North line and		Feet from the East line	
1650		1650			
Section 3007.4		Containing Acreage TELEDYNE AREA		Containing Acreage BONE SPRINGS 40	

- Outline the acreage dedicated to the subject well by colored pencil or hatchure marks on the plat below.
- If more than one lease is dedicated to the well, outline each and identify the ownership thereof (both as to working interest and royalty).
- If more than one lease of different ownership is dedicated to the well, have the interests of all owners been consolidated by communitization, unitization, force-pooling, etc?

☐ Yes ☐ No If answer is "yes," type of consolidation _____

If answer is "no," list the owners and tract descriptions which have actually been consolidated (use reverse side of this form if necessary.) _____

No allowable will be assigned to the well until all interests have been consolidated (by communitization, unitization, forced-pooling, or otherwise) or until a non-standard unit, eliminating such interests, has been approved by the Commission.

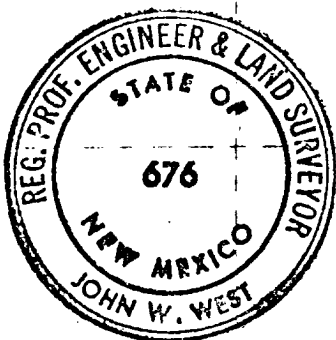
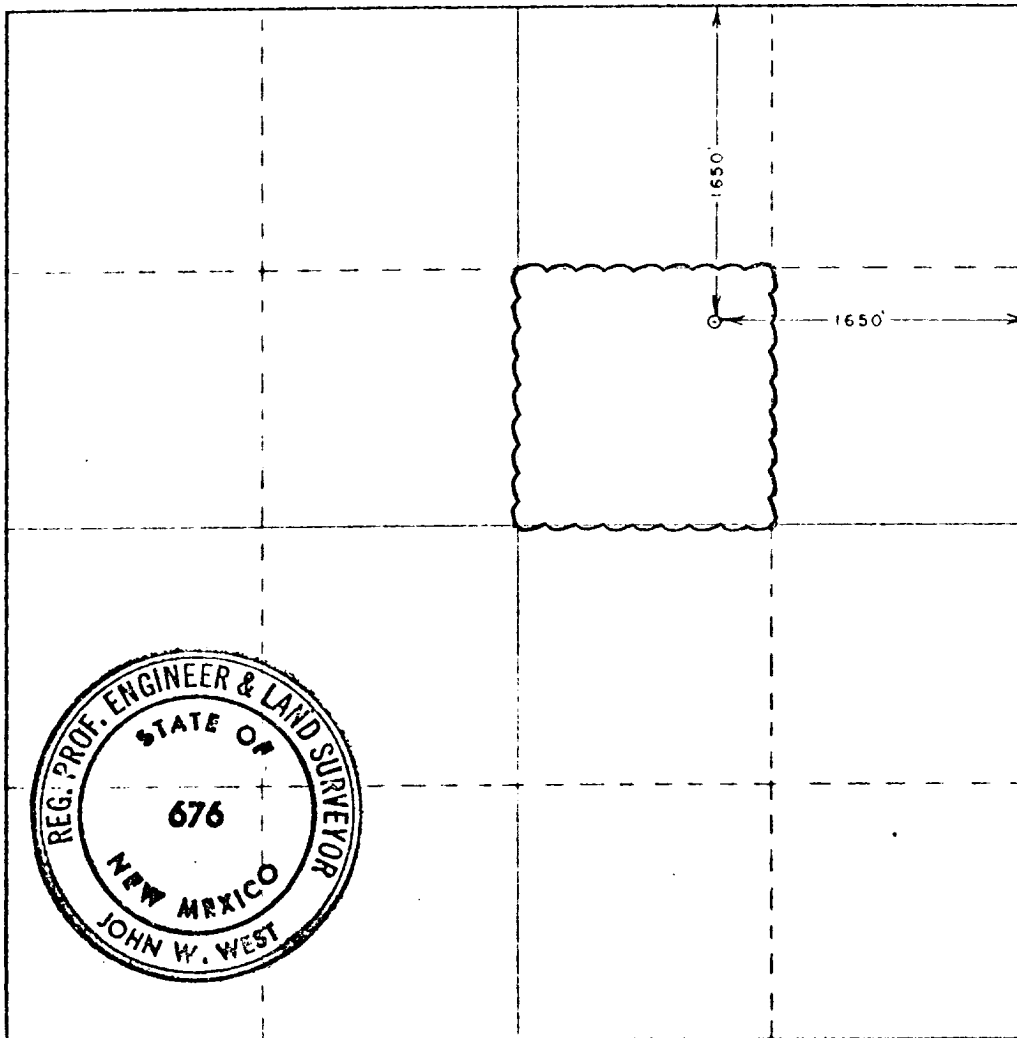

CERTIFICATION

I hereby certify that the information contained herein is true and complete to the best of my knowledge and belief.

Allen V. Hundley
Administrative Analyst
Amoco Production Co.
6-26-78

I hereby certify that the well location shown on this plat was plotted from field notes of actual surveys made by me or under my supervision, and that the same is true and correct to the best of my knowledge and belief.

Date Surveyed
June 22, 1978

Registered Professional Engineer and Land Surveyor

John W. West

Certificate No **John W. West** 676

Revised 1-1-65

ATTACHMENT "B"
NOTES

1. Blow-out preventers and master valve to be fluid operated and oil fittings must be in good condition, 3,000# W.P. (6,000 p.s.i. test), minimum.
2. Equipment through which bit must pass shall be as large as the inside diameter of the casing that is being drilled through.
3. Nipple above blow-out preventer shall be same size as casing being drilled through.
4. Kelly cock required, 3,000# W.P. (6,000 p.s.i. test) minimum.
5. OMSCO or comparable safety valve must be available on rig floor at all times with proper connection or sub, 3,000# W.P. (6,000 p.s.i. test), minimum.
6. Blow-out preventers and master valve while drilling intermediate hole to 6000' may be 2,000# W.P. (4,000 p.s.i. test), minimum.
7. Choke assembly, beyond second valve from cross, may be positioned (Optional) outside of derrick foundation.
8. Spool or cross may be eliminated if connections are available in the lower part of the blow-out preventer body.
9. Plug valves - gate valves are optional. Valves shown as 2" are minimum size.
10. Casing head and casing head spool, including attached valves, to be furnished by Amoco.
11. Rams in preventers will be installed as follows:

<p>When drilling, use:</p> <p>Top Preventer - Drill pipe rams</p> <p>Bottom Preventer - Blind rams or master valve</p>	<p>When running casing, use:</p> <p>Top Preventer - Casing rams</p> <p>Bottom Preventer - Blind rams or master valve</p>
--	--

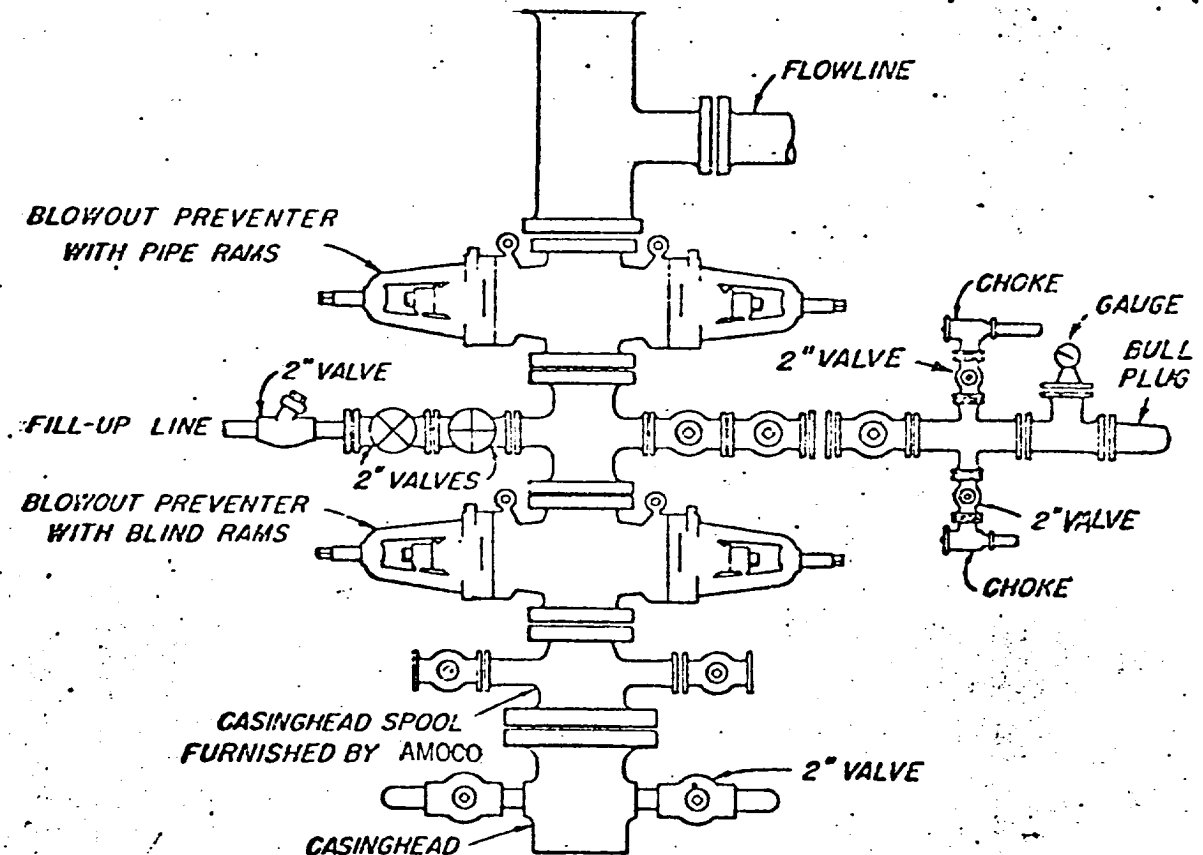

BLOWOUT PREVENTER HOOK-UP

AMOCO PRODUCTION COMPANY

EXHIBIT D-I MODIFIED

JUNE 1, 1962