

XMOCC COPY

SUBMIT IN T. ATE\*  
(Other instructions on  
reverse side)30-015-22873  
Form approved.  
Budget Bureau No. 42-R1425.UNITED STATES  
DEPARTMENT OF THE INTERIOR  
GEOLOGICAL SURVEY

Copy to 87

## APPLICATION FOR PERMIT TO DRILL, DEEPEN, OR PLUG BACK

## 1a. TYPE OF WORK

DRILL ☒DEEPEN ☐PLUG BACK ☐

## b. TYPE OF WELL

OIL  
WELL ☐GAS  
WELL ☒

OTHER

SINGLE  
ZONE ☒MULTIPLE  
ZONE ☐

## 2. NAME OF OPERATOR

Mark D. Wilson ✓

## 3. ADDRESS OF OPERATOR

1705 Briscoe Ave., Artesia, New Mexico 88210

## 4. LOCATION OF WELL (Report location clearly and in accordance with any State requirements.)\*

At surface

1980' FSL and 660' FEL

At proposed prod. zone

Same

## 14. DISTANCE IN MILES AND DIRECTION FROM NEAREST TOWN OR POST OFFICE\*

45 miles south and west of Artesia, New Mexico

## 15. DISTANCE FROM PROPOSED\*

LOCATION TO NEAREST  
PROPERTY OR LEASE LINE, FT.  
(Also to nearest drlg. unit line, if any)

660'

## 16. NO. OF ACRES IN LEASE

160

## 18. DISTANCE FROM PROPOSED\*

TO NEAREST WELL, DRILLING, COMPLETED,  
OR APPLIED FOR, ON THIS LEASE, FT.

None

## 19. PROPOSED DEPTH

6325'

## 21. ELEVATIONS (Show whether DF, RT, GR, etc.)

4254' GR

## 23.

## PROPOSED CASING AND CEMENTING PROGRAM

SIZE OF HOLE	SIZE OF CASING	WEIGHT PER FOOT	SETTING DEPTH	QUANTITY OF CEMENT
17-1/2"	13-3/8"	48# K-55	120'	300 sx
12-1/4" - 11	8-5/8"	24# K-55	1800'	Circulate
7-7/8"	4-1/2"	11.6# & 13.5#	6000'	300 sx

Mud Program: Fresh water to intermediate casing point (1800')  
F. W. gel intermediate casing point to TD w/1-2% KCl if necessary.

BOP Program: See Exhibit D.

All of the gas under the NE/4 of Section 4, and 39% of the gas in the SE/4 is  
dedicated to El Paso Natural Gas Company.

RECEIVED

FEB 21 1979

U.S. GEOLOGICAL SURVEY

ARTESIA, NEW MEXICO

IN ABOVE SPACE DESCRIBE PROPOSED PROGRAM: If proposal is to deepen or plug back, give data on present production and new productive zone. If proposal is to drill or deepen directionally, give pertinent data on subsurface locations and measured and true vertical depths. Give blowout preventer program, if any.

## 24.

SIGNED

TITLE Owner

DATE 2/19/79

(This space for Federal or State office use)

PERMIT NO.

APPROVAL DATE

3-12-79

APPROVED BY

TITLE

DATE

CONDITIONS OF APPROVAL, IF ANY:

\*See Instructions On Reverse Side

NEW MEXICO OIL CONSERVATION COMMISSION  
WELL LOCATION AND ACREAGE DEDICATION PLAT

Form C-102  
Supersedes C-128  
Effective 1-1-65

All distances must be from the outer boundaries of the Section.

Operator <b>MARK WILSON</b>			Lease <b>Rocky Arroyo Federal</b>		Well No. <b>1</b>
Unit Letter <b>J</b>	Section <b>4</b>	Township <b>22 South</b>	Range <b>22 East</b>	County <b>Eddy</b>	
Actual Footage Location of Well: <b>1980</b> feet from the <b>South</b> line and <b>660</b> feet from the <b>East</b> line					
Ground Level Elev. <b>4254</b>	Producing Formation <b>Wildcat - Wolfcamp</b>		Pool <b>Wildcat</b>	Dedicated Acreage: <b>320</b> Acres	

1. Outline the acreage dedicated to the subject well by colored pencil or hachure marks on the plat below.
2. If more than one lease is dedicated to the well, outline each and identify the ownership thereof (both as to working interest and royalty).
3. If more than one lease of different ownership is dedicated to the well, have the interests of all owners been consolidated by communitization, unitization, force-pooling, etc?

☐ Yes ☐ No If answer is "yes," type of consolidation Will be communitized.

If answer is "no," list the owners and tract descriptions which have actually been consolidated. (Use reverse side of this form if necessary.)

No allowable will be assigned to the well until all interests have been consolidated (by communitization, unitization, forced-pooling, or otherwise) or until a non-standard unit, eliminating such interests, has been approved by the Commission.

**RECEIVED**  
**FEB 21 1979**  
**U.S. GEOLOGICAL SURVEY**  
**ARTESIA, NEW MEXICO**

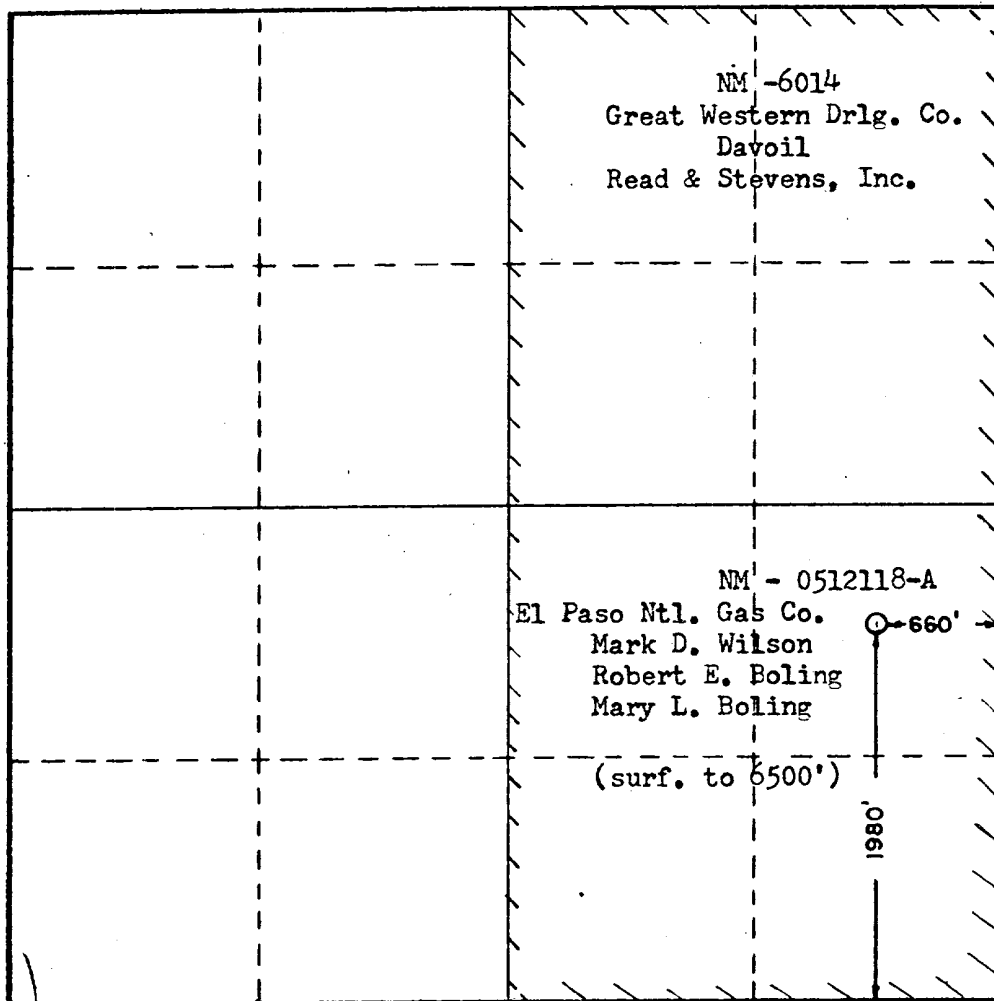

**CERTIFICATION**

I hereby certify that the information contained herein is true and complete to the best of my knowledge and belief.

**Mark D. Wilson**

Name

Position

Company

**Independent Geologist**

Date

**2-19-79**

I hereby certify that the well location shown on this plat was plotted from field notes of actual surveys made by me or under my supervision, and that the same is true and correct to the best of my knowledge and belief.

Date Surveyed

**February 8, 1979**

Registered Professional Engineer and/or Land Surveyor

Certificate No.

**3640**



NMOCC COPY

# United States Department of the Interior

GEOLOGICAL SURVEY  
P. O. Drawer U  
Artesia, New Mexico 88210

MAR 12 1979

Mark D. Wilson  
1705 Briscoe Avenue  
Artesia, New Mexico 88210

MARK D. WILSON Rocky Arroyo Fed. Com. 4 Well No. 1 1980 FSL 660 FEL Sec. 4, T22S, R22E Eddy County Lease No. NM-0512118-A
--

Gentlemen:

Above Data Required on Well Sign
----------------------------------

Your APPLICATION FOR PERMIT TO DRILL the above-described well to a depth of 6,325 feet to test the Wolfcamp is hereby approved subject to compliance with the OIL AND GAS OPERATING REGULATIONS (30 CFR 221) and the following conditions:

1. Drilling operations authorized are subject to compliance with the attached General Requirements for Oil and Gas Operations on Federal Leases, dated July 1, 1978.
2. Prior to commencing construction of road, pad, or other associated developments, operator will provide the dirt contractor with a copy of the Surface Use Plan and these Conditions of Approval including the attached General Requirements.
3. Submit a Daily Report of Operations from spud date until the well is completed and the Well Completion Report (form 9-330) is filed. The report should be not less than 8" x 5" in size and each page should identify the well.
4. All permanent above-ground structures and equipment shall be painted in accordance with the attached Painting Guidelines. The color used should simulate sandstone brown (Federal Standard Color No. 595A, color 20318 or 30318).
5. Before drilling below the 8-5/8" casing, the blowout preventer assembly will consist of a minimum of one annular type and two ram type preventers.
6. A kelly cock will be installed and maintained in operable condition.
7. After setting the 8-5/8" casing string and before drilling into the Wolfcamp formation, the blowout preventers and related control equipment shall be pressure tested to rated working pressures by an independent service company. Any equipment failing to test satisfactorily shall be repaired or replaced. This office should be notified in sufficient time for a representative to witness the tests and shall be furnished a copy of the pressure test report.

8. Mud system monitoring equipment, with derrick floor indicators and visual and audio alarms, shall be installed and operating before drilling into the Wolfcamp formation and used until production casing is run and cemented. Monitoring equipment shall consist of the following:
  - (1) A recording pit level indicator to determine pit volume gains and losses.
  - (2) A mud volume measuring device for accurately determining mud volume necessary to fill the hole on trips.
  - (3) A flow sensor on the flow-line to warn of any abnormal mud returns from the well.
9. Notify the Survey in sufficient time to witness the cementing of the 8-5/8" casing.
10. Cement behind the 13-3/8" and 8-5/8" casing must be circulated.

Sincerely yours,

(Orig. Sign.) ALBERT R. STALL

Albert R. Stall  
Acting District Engineer

Rotating head if necessary  
2" Fill up Line

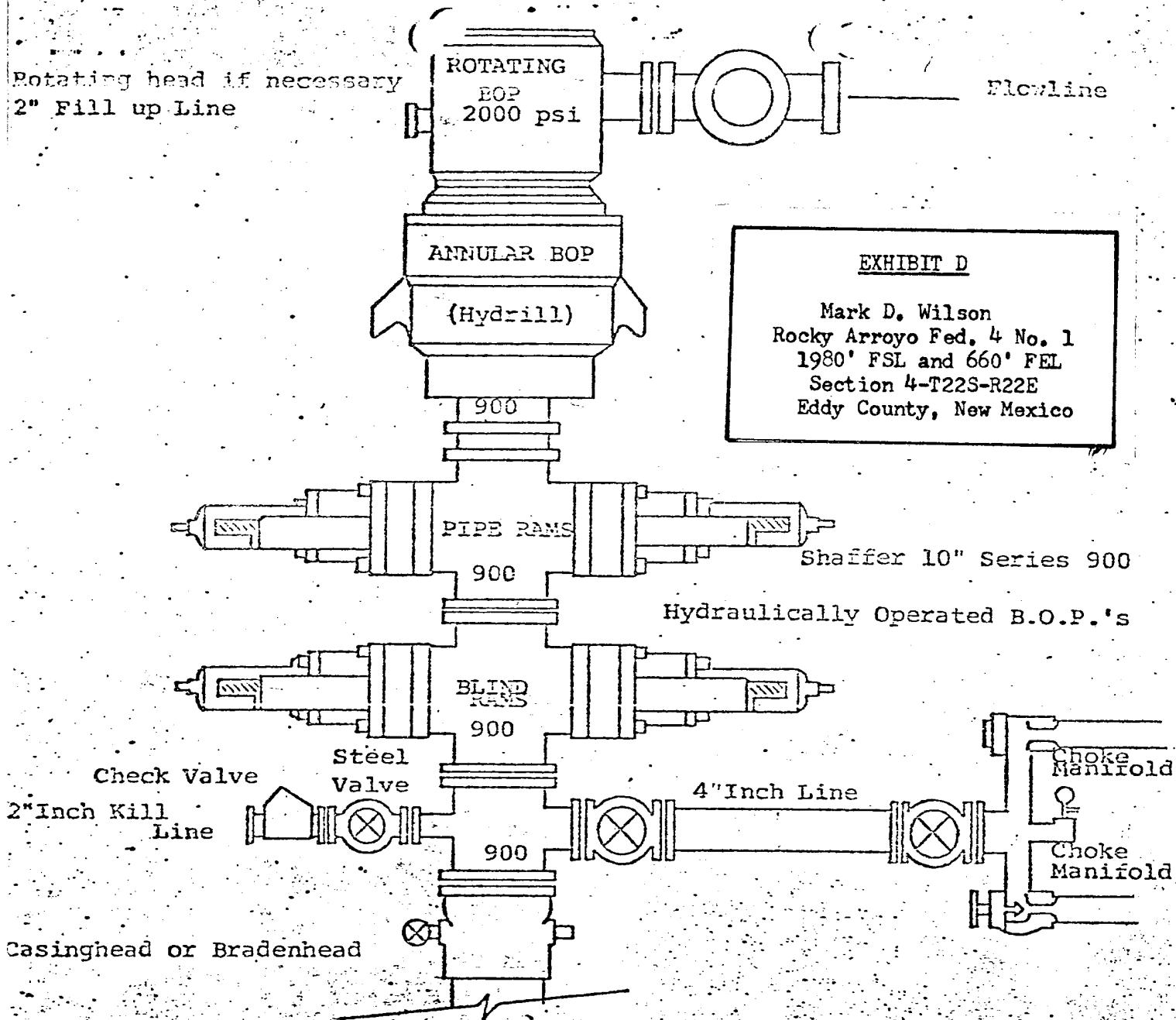

THE FOLLOWING CONSTITUTE MINIMUM BLOWOUT PREVENTER REQUIREMENTS

1. All preventers to be hydraulically operated with secondary manual controls installed prior to drilling out from under casing.
2. Choke outlet to be a minimum of 4" diameter.
3. Kill line to be of all steel construction of 2" minimum diameter.
4. All connections from operating manifolds to preventers to be all steel. hole or tube a minimum of one inch in diameter.
5. The available closing pressure shall be at least 15% in excess of that required with sufficient volume to operate the B.O.P.'s.
6. All connections to and from preventer to have a pressure rating equivalent to that of the B.O.P.'s.
7. Inside blowout preventer to be available on rig floor.
8. Operating controls located a safe distance from the rig floor.
9. Hole must be kept filled on trips below intermediate casing. Operator not responsible for blowouts resulting from not keeping hole full.
10. D. P. float must be installed and used below zone of first gas intrusion.