

AN ARCHAEOLOGICAL RECONNAISSANCE FOR

Harry Ptasynski

80-157

Nola Federal No. 1

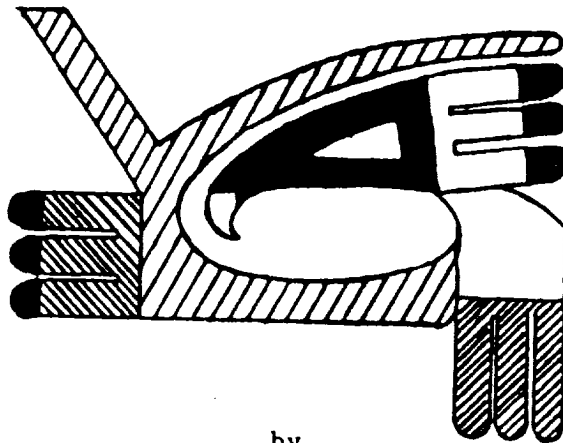

by
Rodrick B. MacLennan

Edited and Submitted by

Dr. Peter S. Miller
Director
AGENCY FOR CONSERVATION ARCHAEOLOGY

Llano Estacado Center for Advanced
Professional Studies and Research

Eastern New Mexico University
Portales, New Mexico 88130

(505) 562-3332

November 21, 1979

WELL LOCATION AND ACREAGE DEDICATION AT

Supersedes L-1
Effective 1-1-65

All distances must be from the outer boundaries of the Section.

NAME Hary Ptasynski		Lease Nola Federal		Well No. #1
Section SW $\frac{1}{4}$ SW $\frac{1}{4}$	3	Township 23S	Range 31E	County Eddy
Footage Location of Well: 990 feet from the West line and 660 feet from the South line				
Level Elev.	Producing Formation	Pool	Dedicated Acreage	

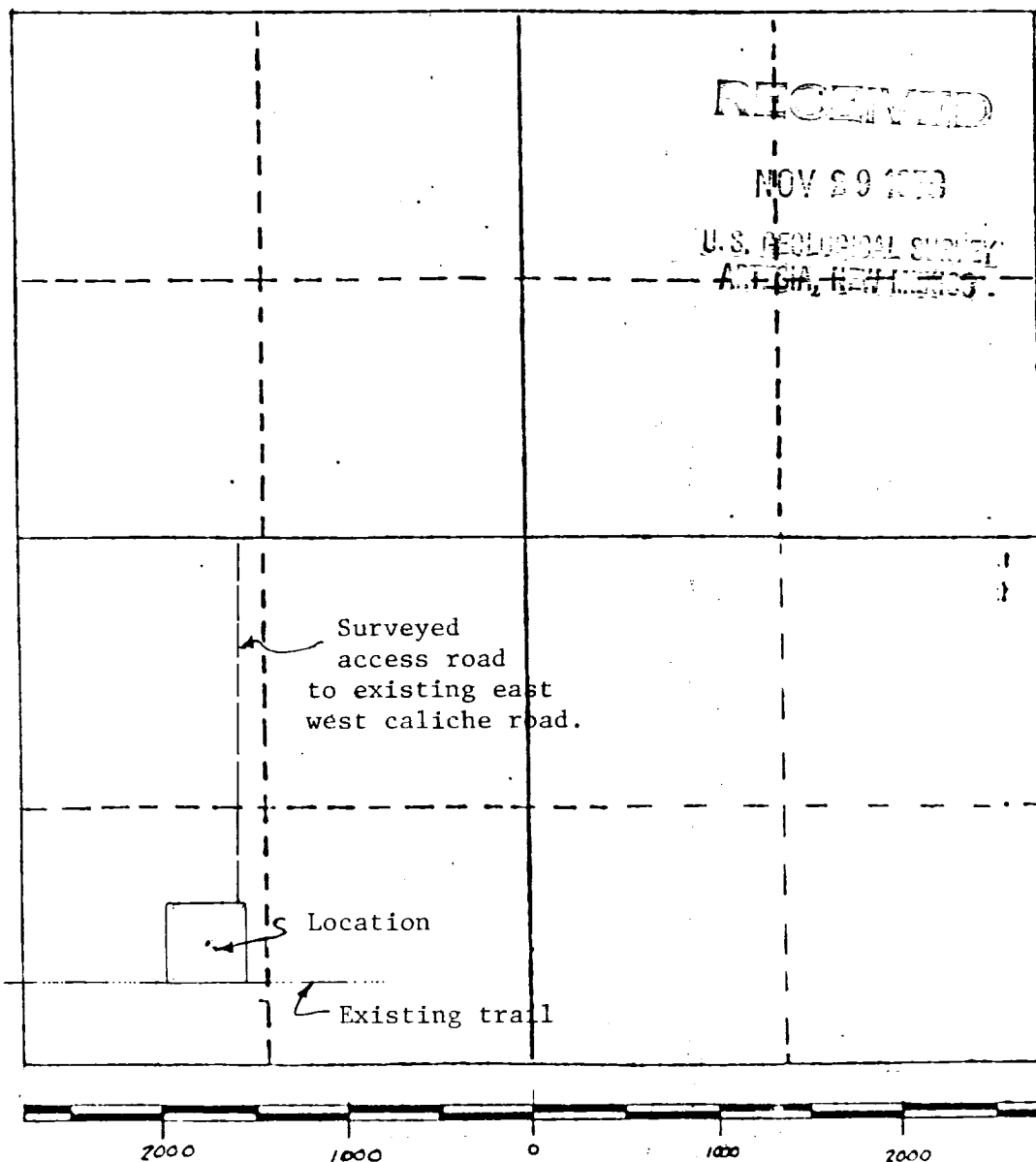

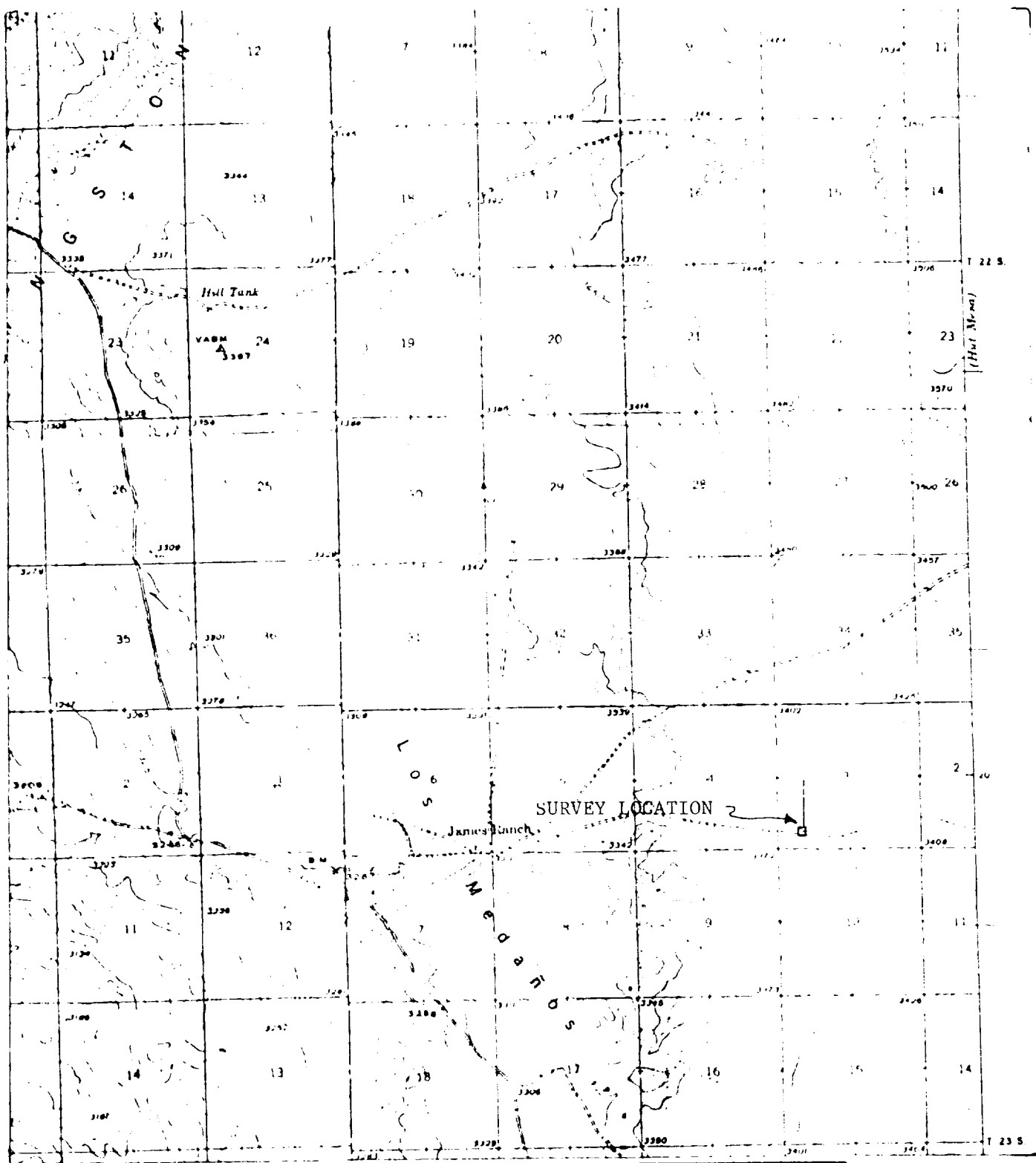
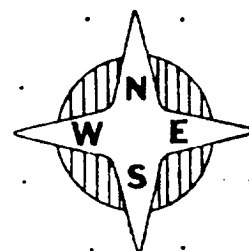
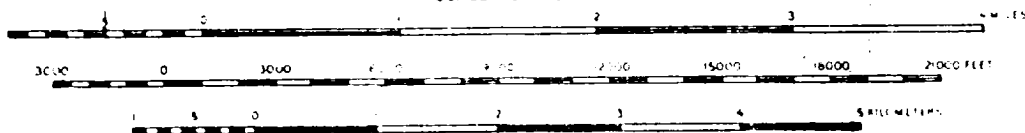

Figure 1: Location of Nola Federal No. 1
Section 3, T23S, R31E, NMPM, Eddy County, NM

ap Reference: USGS Nash Draw Quadrangle 15 Minute Series, 1939.

15 MINUTE
SERIES

SCALE 1:62500



RECEIVED

NOV 20 1979

INTRODUCTION

An archaeological reconnaissance was recently completed by the Agency for Conservation Archaeology, Eastern New Mexico University for Harry Ptasynski Company in Eddy County, New Mexico. The reconnoitered area will be impacted by the construction of a well pad and access road. The project was administered by Mr. Burt Muncy for Harry Ptasynski Company and Dr. Peter S. Miller, Director, for ACA. This report was prepared by the Roswell Office of ACA, Rod MacLennan, Manager.

The field work was conducted on November 20, 1979 by Rod MacLennan. This survey was conducted under Federal Antiquity Permit Number 79-NM-049. A search of the National Register has been made and properties within this area are not listed with the National Register. Field and weather conditions were good during the course of the survey.

SURVEY TECHNIQUE

Visual inspection of the well pad was completed by walking a series of parallel transects. Each transect was covered in a tightly spaced zigzag pattern. The access road was examined as an individual transect, with tightly spaced zigzag patterns covering the length and breadth. The distance between transects was 3 meters. This method maximized the opportunity of observing any cultural resources within or near the proposed area of impact.

Nola Federal No. 1

The proposed well pad and access line is located 20 miles east northeast of Loving, New Mexico, within the Los Medanos area. The pad measures 400 X 400 feet and the access road measures 50 X 2000 feet. They are situated as follows:

SW $\frac{1}{4}$ SW $\frac{1}{4}$, Section 3, T23S, R31E, NMPM, Eddy County, NM (BLM)
NW $\frac{1}{4}$ SW $\frac{1}{4}$, Section 3, T23S, R31E, NMPM, Eddy County, NM (BLM)

Map Reference: USGS Nash Draw Quadrangle 15 Minute Series, 1939
(Figures 1 and 2).

TERRAIN

The proposed well pad and access line is located within the Los Medanos area and is 4600 feet east of James Ranch. It is situated in a 5 to 6 foot high set of dune fields, that trend with a 1.9% slope in a southwesterly direction. The elevation is 3980 feet. The soils encountered in the area are predominantly pink sands. Lithic inclusions within this soil consist of about 1% small caliche pebbles. Taxonomically this soil can be classified as a member of the Haplargids-Torripsamments association.

FLORISTICS

ACA encountered a sparse floral assemblage in this vicinity. The density of the vegetation in the area is approximately 8 percent. The floral community consists of shrubs. Among the species present are engleman pricklypear (Opuntia phaeacantha), mesquite (Prosopis juliflora), the dominant species is oak brush (Quercus havardii), sand sage (Artemisia filifolia), soaptree yucca (Yucca elata), cane bluestem (Andropogon barbinodis), gyp sunflower (Helianthus paradoxus), and indian wheat (Plantago purshii).

CULTURAL RESOURCES

ACA did not encounter any archaeological sites or isolated manifestations, either within or near the proposed facilities. A review of the National Register did not find any properties listed for this location.

RECOMMENDATIONS

ACA recommends clearance for the well pad and access line and suggests that construction be allowed to proceed as currently planned.