

NO. OF COPIES RECEIVED	
DISTRIBUTION	
SANTA FE	1
FILE	1 ✓
U.S.G.S.	2
LAND OFFICE	1
OPERATOR	1

NEW MEXICO OIL CONSERVATION COMMISSION

RECEIVED

JUL 9 1980

O. C. D.  
ARTESIA, OFFICE

30-015-23410

Form C-101  
Revised 1-1-65

5A. Indicate Type of Lease
STATE <input type="checkbox"/> FEE <input checked="" type="checkbox"/>
5. State Oil & Gas Lease No.

APPLICATION FOR PERMIT TO DRILL, DEEPEN, OR PLUG BACK

1a. Type of Work		7. Unit Agreement Name	
b. Type of Well DRILL <input checked="" type="checkbox"/> DEEPEN <input type="checkbox"/> PLUG BACK <input type="checkbox"/> OIL WELL <input checked="" type="checkbox"/> GAS WELL <input type="checkbox"/> OTHER <input type="checkbox"/> SINGLE ZONE <input checked="" type="checkbox"/> MULTIPLE ZONE <input type="checkbox"/>		8. Farm or Lease Name Veraguth Com.	
2. Name of Operator Amoco Production Company ✓		9. Well No. 1	
3. Address of Operator P. O. Box 68 Hobbs, NM 88240		10. Field and Pool, or Wildcat Wildcat Und. Delaware	
4. Location of Well UNIT LETTER 0 LOCATED 990 FEET FROM THE South LINE AND 1650 FEET FROM THE East LINE OF SEC. 18 TWP. 23-S RGE. 28-E NMPM		12. County Eddy	
19. Proposed Depth 3700'		19A. Formation Delaware	
20. Rotary or C.R. Rotary		21. Elevations (Show whether DP, RL, etc.) 3065.8 GL	
21A. Kind & Status Plug. Bond Blanket-on-file		21B. Drilling Contractor NA	
22. Approx. Date Work will start 7-14-80			

PROPOSED CASING AND CEMENT PROGRAM

SIZE OF HOLE	SIZE OF CASING	WEIGHT PER FOOT	SETTING DEPTH	SACKS OF CEMENT	EST. TOP
12-1/4"	9-5/8"	36#	400'	Circ.	Surf.
8-3/4"	7"	23#, 26# or 29#	3700'	Circ.	Surf.

Propose to drill and equip well in the Delaware formation. After reaching TD logs will be run and evaluated; perforate and stimulate as necessary in attempting commercial production.

MUD PROGRAM: 0'- 400' Native mud and fresh water.  
400'- TD Native mud and brine with minimum properties for safe hole conditions.

BOP PROGRAM ATTACHED

APPROVAL VAND  
FOR 90 DAYS UNLESS  
DRILLING COMMENCED,  
EXPIRES 10-11-80

0+5-NMOCD, A 1-Hou 1-Susp 1-BG 1-Cities Serv. 1-McKay 1-Pecos Irr.

IN ABOVE SPACE DESCRIBE PROPOSED PROGRAM; IF PROPOSAL IS TO DEEPEN OR PLUG BACK, GIVE DATA ON PRESENT PRODUCTIVE ZONE AND PROPOSED NEW PRODUCTIVE ZONE. GIVE BLOWOUT PREVENTER PROGRAM, IF ANY.

I hereby certify that the information above is true and complete to the best of my knowledge and belief.

Signed Bob Davis Title Admin. Analyst Date 7-8-80

(This space for State Use)

APPROVED BY W.A. Gressett TITLE SUPERVISOR, DISTRICT II DATE JUL 11 1980

CONDITIONS OF APPROVAL, IF ANY:

**N MEXICO OIL CONSERVATION COMMISS**  
**WELL LOCATION AND ACREAGE DEDICATION PLAT**

Form C-102  
 Supersedes C-128  
 Effective 1-1-65

All distances must be from the outer boundaries of the Section

Operator <b>AMOCO Production Co.</b>			Lease <b>Veraguth Com.</b>		Well # <b>1</b>
Unit Letter <b>O</b>	Section <b>18</b>	Township <b>23 South</b>	Range <b>28 East</b>	County <b>Eddy</b>	
Actual Footage Location of Well: <b>990</b> feet from the <b>South</b> line and <b>1650</b> feet from the <b>East</b> line					
Ground Level Elev. <b>3065.8</b>	Producing Formation <b>Delaware</b>	Pool <b>Unit, Delaware</b>		Dedicated Acreage: <b>40</b>	Acres

1. Outline the acreage dedicated to the subject well by colored pencil or hachure marks on the plat below.
2. If more than one lease is dedicated to the well, outline each and identify the ownership thereof (both as to working interest and royalty).
3. If more than one lease of different ownership is dedicated to the well, have the interests of all owners been consolidated by communitization, unitization, force-pooling, etc?

☐ Yes ☒ No If answer is "yes," type of consolidation Communitization

If answer is "no," list the owners and tract descriptions which have actually been consolidated. (Use reverse side of this form if necessary.) \_\_\_\_\_

No allowable will be assigned to the well until all interests have been consolidated (by communitization, unitization, forced-pooling, or otherwise) or until a non-standard unit, eliminating such interests, has been approved by the Commission.

<u>WI</u>  Amoco 62.0732 Pecos 19.26208 McKay 18.6656 Cities Serv. Non consent	
	Cities Svc. 1650' Cities Svc. 990' Carter Farms G.H. Whisse

**CERTIFICATION**

I hereby certify that the information contained herein is true and complete to the best of my knowledge and belief.

Name Bob Davis  
 Position Admin. Analyst  
 Company Amoco Production Company  
 Date 7-8-80

I hereby certify that the well location shown on this plat was plotted from field notes of actual surveys made by me or under my supervision, and that the same is true and correct to the best of my knowledge and belief.

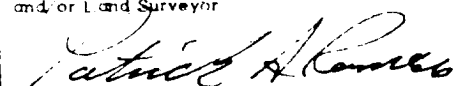
Date Surveyed April 24, 1980  
 Registered Professional Engineer and/or Land Surveyor  
  
 Certificate No. **JOHN W. WEST 676**  
**PATRICK A. ROMERO 6663**  
**Ronald J. Eidson 3239**

1. Blow-out preventers and master valve to be fluid operated and oil fittings must be in good condition, 3,000# W.P. (6,000 p.s.i. test), minimum.
2. Equipment through which bit must pass shall be as large as the inside diameter of the casing that is being drilled through.
3. Nipple above blow-out preventer shall be same size as casing being drilled through.
4. Kelly cock required, 3,000# W.P. (6,000 p.s.i. test) minimum.
5. OMSCO or comparable safety valve must be available on rig floor at all times with proper connection or sub, 3,000# W.P. (6,000 p.s.i. test), minimum.
6. Blow-out preventers and master valve while drilling intermediate hole to 6000' may be 2,000# W.P. (4,000 p.s.i. test), minimum.
7. Choke assembly, beyond second valve from cross, may be positioned (Optional) outside of derrick foundation.
8. Spool or cross may be eliminated if connections are available in the lower part of the blow-out preventer body.
9. Plug valves - gate valves are optional. Valves shown as 2" are minimum size.
10. Casing head and casing head spool, including attached valves, to be furnished by Amoco.
11. Rams in preventers will be installed as follows:
 

When drilling, use:	When running casing, use:
Top Preventer - Drill pipe rams	Top Preventer - Casing rams
Bottom Preventer - Blind rams or master valve	Bottom Preventer - Blind rams or master valve

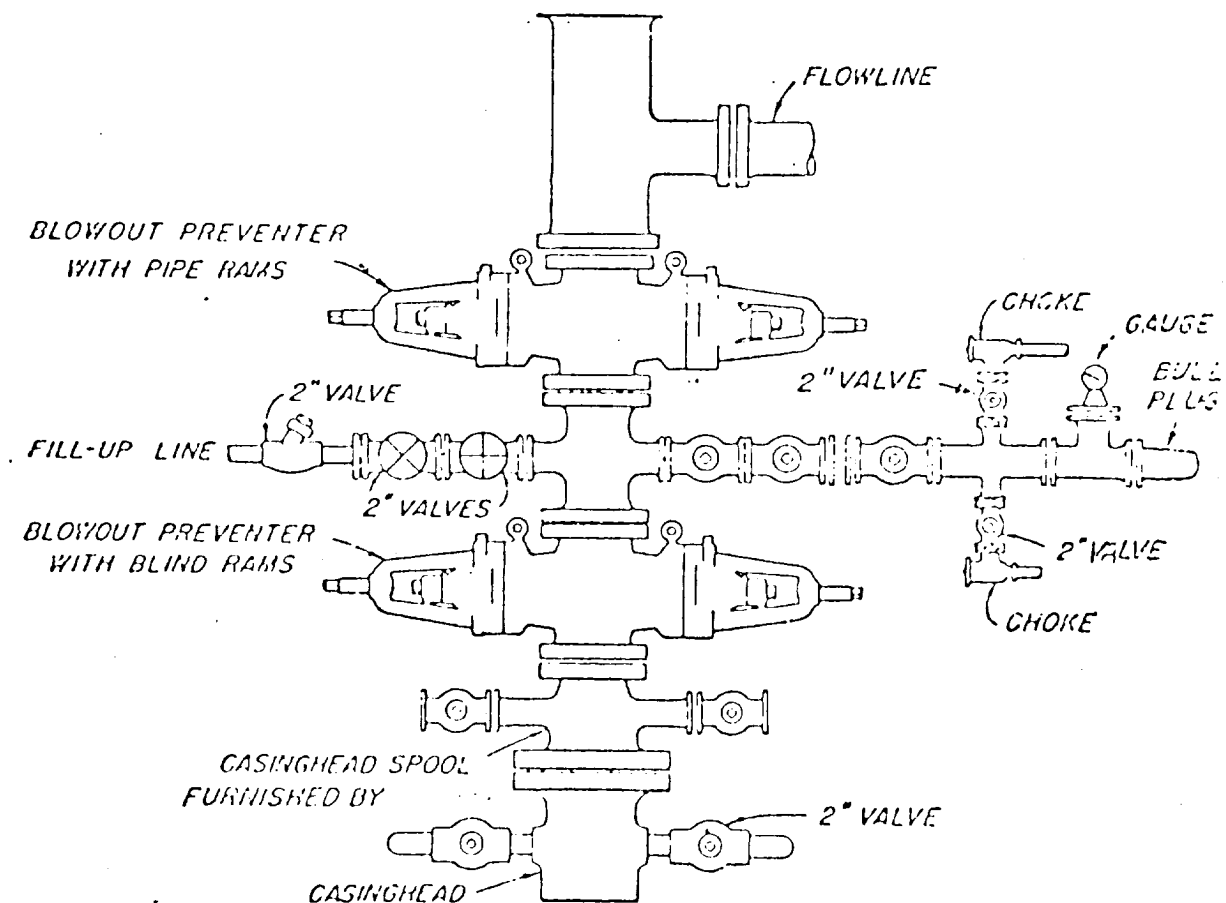

## BLOWOUT PREVENTER HOOK-UP

AMOCO PROC. 11-1000-10-1-1

## EXHIBIT D - I MODIFIED

JUNE 1, 1962