

NO. OF COPIES RECEIVED	6
DISTRIBUTION	
SANTA FE	1
FILE	1
U.S.G.S.	
LAND OFFICE	
OPERATOR	

# NEW MEXICO OIL CONSERVATION COMMISSION

JAN 15 1981

O. C. D.  
ARRESTA, OFFICE

30-015-23616

Form C-101  
Revised 1-1-65

5A. Indicate Type of Lease STATE <input checked="" type="checkbox"/> FEE <input type="checkbox"/>
5. State Oil & Gas Lease No. L-4397

## APPLICATION FOR PERMIT TO DRILL, DEEPEN, OR PLUG BACK

1a. Type of Work DRILL <input checked="" type="checkbox"/> DEEPEN <input type="checkbox"/> PLUG BACK <input type="checkbox"/>		7. Unit Agreement Name -----
b. Type of Well OIL WELL <input checked="" type="checkbox"/> GAS WELL <input type="checkbox"/> OTHER <input type="checkbox"/> SINGLE ZONE <input type="checkbox"/> MULTIPLE ZONE <input type="checkbox"/>		8. Farm or Lease Name Merchant State
2. Name of Operator Bass Enterprises Production Co. ✓		9. Well No. 2
3. Address of Operator P.O. Box 2760, Midland, Texas 79702		10. Field and Pool, or Wildcat Undesignated (Wolfcamp)
4. Location of Well UNIT LETTER <u>G</u> LOCATED <u>1980'</u> FEET FROM THE <u>North</u> LINE AND <u>2080</u> FEET FROM THE <u>East</u> LINE OF SEC. <u>1</u> TWP. <u>19-S</u> RGE. <u>28E</u> NMPM		12. County Eddy
19. Proposed Depth 9400'		19A. Formation Wolfcamp
20. Rotary or C.T. Rotary		21. Elevations (Show whether DE, RT, etc.) 3386.4' GL
21A. Kind & Status Plug. Bond Blanket		21B. Drilling Contractor Unknown
22. Approx. Date Work will start Upon Approval		

## PROPOSED CASING AND CEMENT PROGRAM

SIZE OF HOLE	SIZE OF CASING	WEIGHT PER FOOT	SETTING DEPTH	SACKS OF CEMENT	EST. TOP
15"	11-3/4"	42	500'	400	surface
11"	8-5/8"	24	3350'	1250	surface
7-7/8"	5-1/2"	14, 15.5 & 17	TD	450	7600

BOP diagram attached (BEPCO II & BEPCO IV)

Gas is dedicated.

APPROVAL VALID FOR 180 DAYS  
PERMIT EXPIRES 7-21-81  
UNLESS DRILLING UNDERWAY

IN ABOVE SPACE DESCRIBE PROPOSED PROGRAM; IF PROPOSAL IS TO DEEPEN OR PLUG BACK, GIVE DATA ON PRESENT PRODUCTIVE ZONE AND PROPOSED NEW PRODUCTIVE ZONE. GIVE BLOWOUT PREVENTER PROGRAM, IF ANY.

hereby certify that the information above is true and complete to the best of my knowledge and belief.

Signed Stephen Smith Title Engineering Assistant Date January 5, 1981

(This space for State Use)

APPROVED BY W. A. Grossett TITLE SUPERVISOR, DISTRICT 11 DATE JAN 21 1981

CONDITIONS OF APPROVAL, IF ANY:

Set surface casing @ Top of hole  
at approx. 400'

MEXICO OIL CONSERVATION COMMISSION  
WELL LOCATION AND ACREAGE DEDICATION PLAT

Form C-102  
Supersedes C-128  
Effective 1-1-65

All distances must be from the outer boundaries of the Section

Operator Bass Enterprises Production Co.			Lease Merchant State		Well No. 2
Unit Letter G	Section 1	Township 19 South	Range 28 East	County Eddy	
Actual Footage Location of Well: 2080 feet from the east line and 1980 feet from the north line					
Ground Level Elev. 3386.4	Producing Formation Wolfcamp		Pool Undesignated Wolfcamp	Dedicated Acreage: 40 Acres	

1. Outline the acreage dedicated to the subject well by colored pencil or hatchure marks on the plat below.
2. If more than one lease is dedicated to the well, outline each and identify the ownership thereof (both as to working interest and royalty).
3. If more than one lease of different ownership is dedicated to the well, have the interests of all owners been consolidated by communitization, unitization, force-pooling, etc?

☐ Yes ☐ No If answer is "yes," type of consolidation \_\_\_\_\_

If answer is "no," list the owners and tract descriptions which have actually been consolidated. (Use reverse side of this form if necessary.) \_\_\_\_\_

No allowable will be assigned to the well until all interests have been consolidated (by communitization, unitization, forced-pooling, or otherwise) or until a non-standard unit, eliminating such interests, has been approved by the Commission.

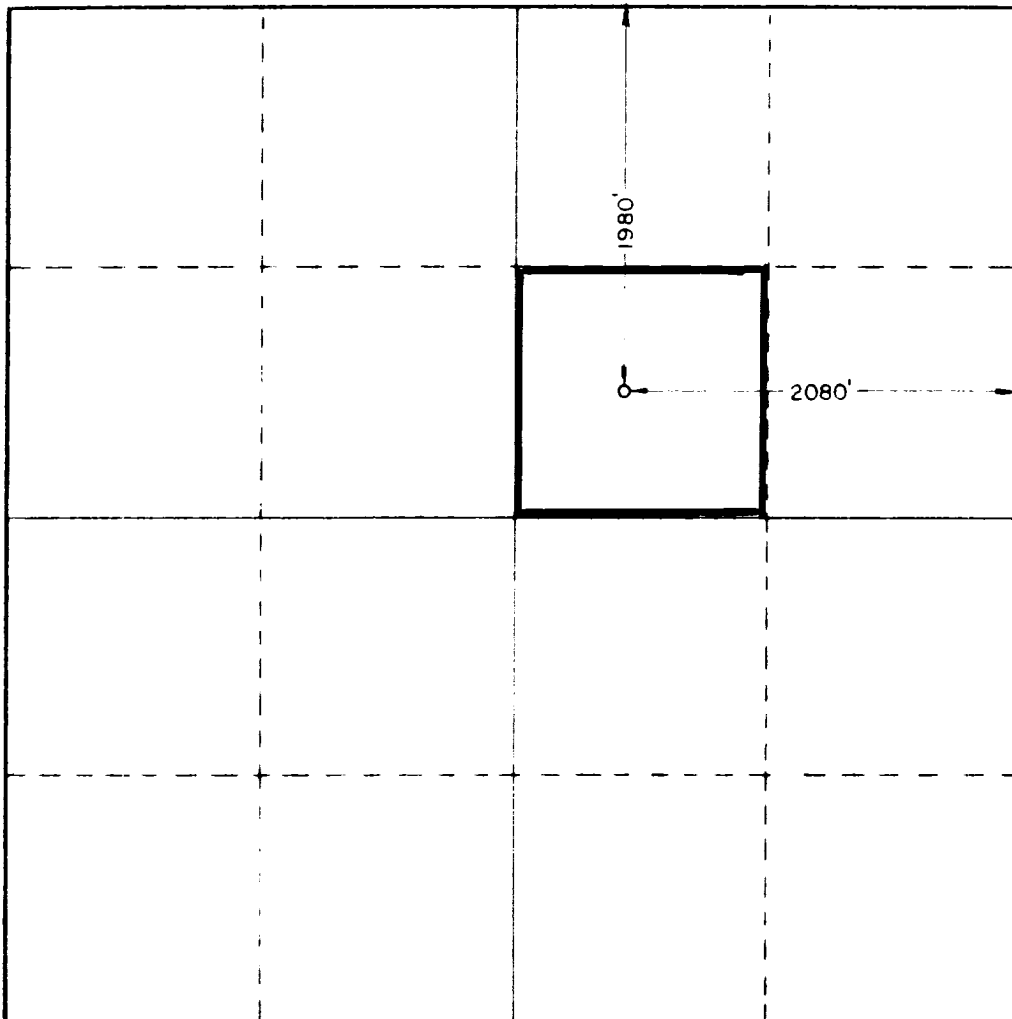

CERTIFICATION

I hereby certify that the information contained herein is true and complete to the best of my knowledge and belief.

*Stephen Smith*

Name  
Stephen Smith  
Position  
Engineering Assistant  
Company  
Bass Enterprises Prod. Co.

Date  
January 5, 1981

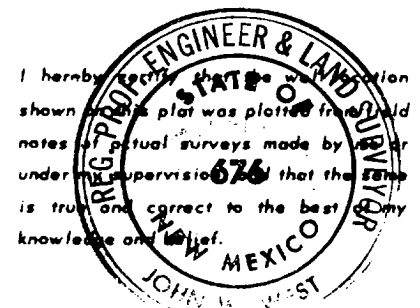

Date Surveyed  
Dec. 29, 1980

Registered Professional Engineer  
and/or Land Surveyor

*John W. West*

Certificate No. JOHN W. WEST 676  
PATRICK A. ROMERO 6465  
Ronald J. Eidson 3239

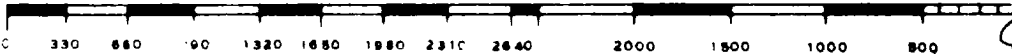

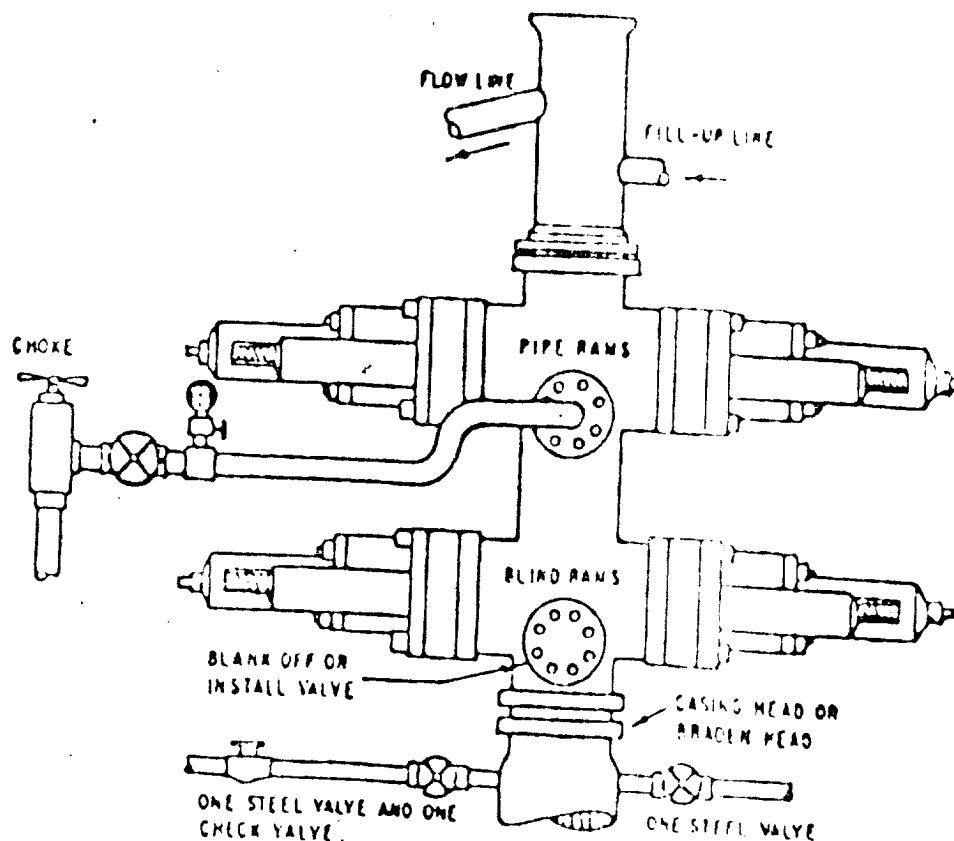

## THE FOLLOWING CONSTITUTE MINIMUM BLOWOUT PREVENTER REQUIREMENTS

- A. ONE DOUBLE GATE BLOWOUT PREVENTER WITH LOWER RAMS BLIND AND UPPER RAMS FOR PIPE, ALL HYDRAULICALLY CONTROLLED, OPENING ON PREVENTERS BETWEEN RAMS.
- B. OPENING TO BE FLANGED, STUDDED OR CLAMPED AND AT LEAST TWO INCHES DIAMETER.
- C. ALL CONNECTIONS FROM OPERATING MANIFOLD TO PREVENTERS TO BE ALL STEEL HOSE OR TUBE A MINIMUM OF ONE INCH IN DIAMETER.
- D. THE AVAILABLE CLOSING PRESSURE SHALL BE AT LEAST 15% IN EXCESS OF THAT REQUIRED WITH SUFFICIENT VOLUME TO OPERATE THE PREVENTERS.
- E. ALL CONNECTIONS TO AND FROM PREVENTERS TO HAVE A PRESSURE RATING EQUIVALENT TO THAT OF THE B.O.P.'s.
- F. MANUAL CONTROLS TO BE INSTALLED BEFORE DRILLING CEMENT PLUG. —
- G. VALVE TO CONTROL FLOW THROUGH DRILL PIPE TO BE LOCATED ON PIG FLOOR. —
- H. CHOKE MAY BE EITHER POSITIVE OR ADJUSTABLE. choke spool may be used between rams.

REPCO II  
 ONE HYDRAULIC DUAL BLOWOUT PREVENTER  
 1000# WP  
 1000# TEST PRESSURE

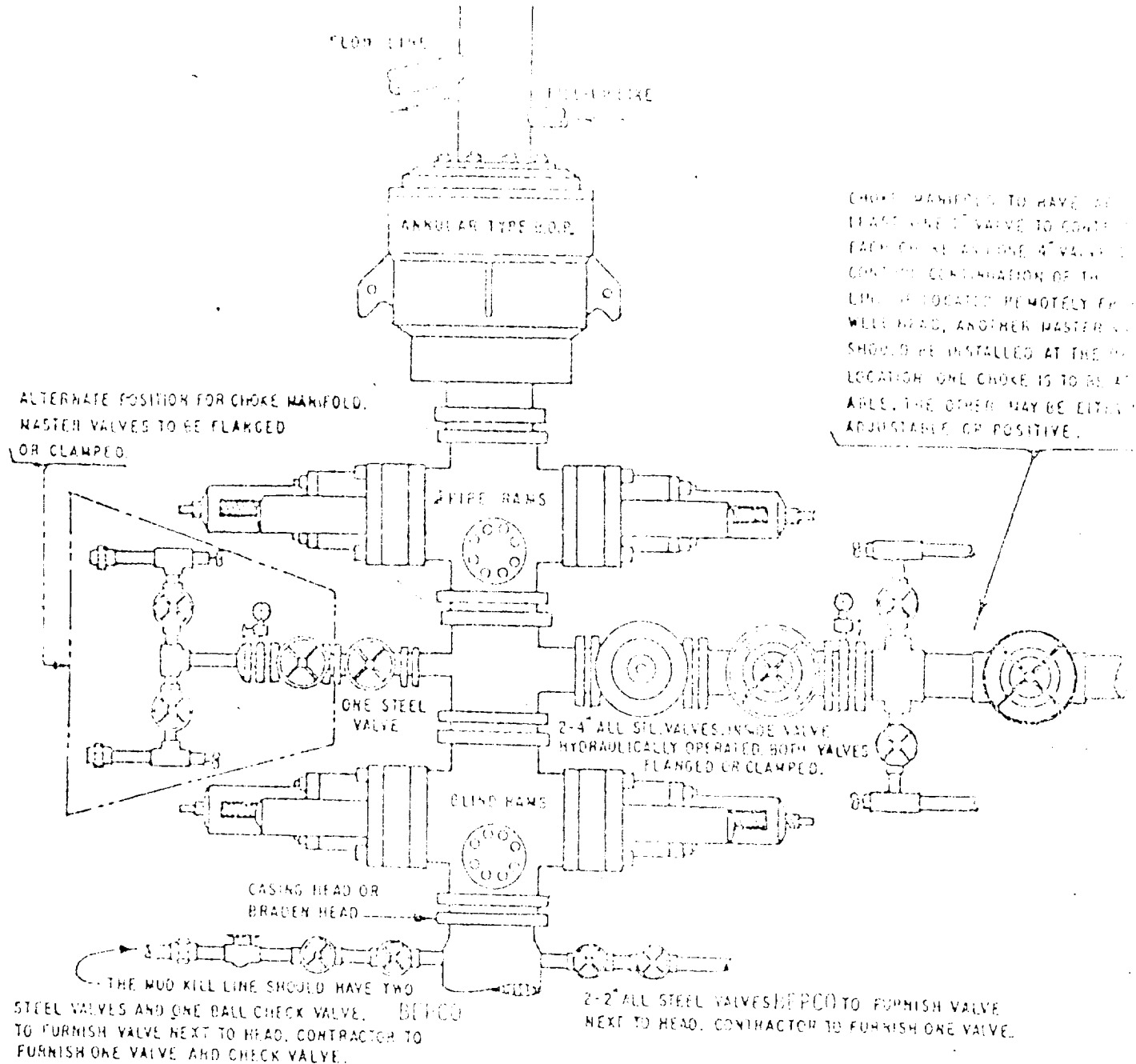

## THE FOLLOWING CONSTITUTE MINIMUM BLOWOUT PREVENTER REQUIREMENTS

- CONDITIONS MAY BE MET BY AN ANNULAR TYPE BLOWOUT PREVENTER ON TOP AND A CHOKE SPOOL BELOW AND EITHER
  - TWO RAM TYPE BLOWOUT PREVENTERS BELOW THE SPOOL, THE LOWER UNIT CONTAINING BLIND RAMS AND THE UPPER UNIT CONTAINING PIPE RAMS, OR
  - A DUAL BLOWOUT PREVENTER BELOW THE SPOOL WITH BLIND RAMS ON BOTTOM AND PIPE RAMS ON TOP.
- OPENING ON CHOKE SPOOL TO BE FLANGED, STUDDED OR CLAMPED.
- ALL CONNECTIONS FROM OPERATING MANIFOLDS TO PREVENTERS TO BE ALL STEEL HOSE OR TUBE A MINIMUM OF ONE INCH IN DIAMETER.
- THE AVAILABLE CLOSING PRESSURE SHALL BE AT LEAST 15% IN EXCESS OF THAT REQUIRED WITH SUFFICIENT VOLUME TO OPERATE THE BOP.
- ALL CONNECTIONS TO AND FROM PREVENTER TO HAVE A PRESSURE RATING EQUIVALENT TO THAT OF THE BOP RATING.
- MANUAL CONTROLS TO BE INSTALLED BEFORE GRINDING CEMENT PLUG.
- KELLY COCK TO BE INSTALLED ON KELLY.
- INSIDE BLOWOUT PREVENTER TO BE AVAILABLE ON RIG FLOOR.
- DUAL OPERATING CONTROLS ONE LOCATED BY DRILLING POSITION AND THE OTHER LOCATED A SAFE DISTANCE FROM THE RIG FLOOR.

BEPCO TV

THREE CLOSURE HYDRAULIC BLOWOUT PREVENTERS

3000# WP

3000# TEST PRESSURE