

RECEIVED

SUBMIT IN 1 LIGATE*
(Other instructions on
reverse side)Form approved.
Budget Bureau No. 42-R1425.UNITED STATES
DEPARTMENT OF THE INTERIOR
GEOLOGICAL SURVEY

30-015-23813

5. LEASE DESIGNATION AND SERIAL NO.
LC 068905

6. IF INDIAN, ALLOTTEE OR TRIBE NAME

7. UNIT AGREEMENT NAME
POKER LAKE UNIT

8. FARM OR LEASE NAME
POKER LAKE UNIT

9. WELL NO.
52

10. FIELD AND POOL, OR WILDCAT
X WILDCAT

11. SEC., T., R., M., OR BLK.
AND SURVEY OR AREA
ULB SEC 10, T24S, R30E

12. COUNTY OR PARISH
Eddy

13. STATE
NM

APPLICATION FOR PERMIT TO DRILL, DEEPEN, OR PLUG BACK

1a. TYPE OF WORK
DRILL ☒ DEEPEN ☐ PLUG BACK ☐

b. TYPE OF WELL
OIL WELL ☐ GAS WELL ☒ OTHER ☐

SINGLE ZONE ☒ MULTIPLE ZONE ☐

2. NAME OF OPERATOR
PERRY R. BASS ✓

3. ADDRESS OF OPERATOR
P. O. BOX 2760, MIDLAND, TEXAS 79702

4. LOCATION OF WELL (Report location clearly and in accordance with any State requirements.)
At surface
1980' FEL, 660' FNL, SEC. 10, T24S, R30E
At proposed prod. zone

14. DISTANCE IN MILES AND DIRECTION FROM NEAREST TOWN OR POST OFFICE*
11 miles east from Malaga, New Mexico

15. DISTANCE FROM PROPOSED*
LOCATION TO NEAREST
PROPERTY OR LEASE LINE, FT.
(Also to nearest drlg. unit line, if any) 660'

18. DISTANCE FROM PROPOSED LOCATION*
TO NEAREST WELL, DRILLING, COMPLETED,
OR APPLIED FOR, ON THIS LEASE, FT.

21. ELEVATIONS (Show whether DF, RT, GR, etc.)
GL 3454.2

23. PROPOSED CASING AND CEMENTING PROGRAM

SIZE OF HOLE	SIZE OF CASING	WEIGHT PER FOOT	SETTING DEPTH	QUANTITY OF CEMENT
24"	20"	94#	500'+	500 sx + . Circ. to surface.
17-1/2"	13-3/8"	68,61 & 54.5#	4,000'+	1100 sx + . Circ. to surface.
12-1/4"	9-5/8"	47,43.5 & 40#	12,000'+	500 sx +
8-1/2"	7-5/8" Liner	39#	14,500'+	400 sx +
6-1/2"	5" Liner	18#	15,400'+	400 sx +

Drilling procedure, BOPE diagrams, anticipated formation tops, surface use plans, and casing design program are attached.

Gas is dedicated.

RECEIVED
MAY 24 1981

IN ABOVE SPACE DESCRIBE PROPOSED PROGRAM: If proposal is to deepen or plug back, give data on present productive zone and proposed new productive zone. If proposal is to drill or deepen directionally, give pertinent data on subsurface locations and measured and true vertical depths. Give blowout preventer program, if any.

24. SIGNED Stephen Smith TITLE Engineering Assistant DATE 3-2-81

(This space for Federal or State office use)

PERMIT NO. _____ APPROVAL DATE 5-29-81

APPROVED BY _____ TITLE _____ DATE _____

CONDITIONS OF APPROVAL, IF ANY:

RECEIVED

MAR 23 1931

U.S. GEOLOGICAL SURVEY
ARTESIA, NEW MEXICO

**MEXICO OIL CONSERVATION COMMISSION
WELL LOCATION AND ACREAGE DEDICATION PLAT**

Form C-102
Supersedes C-128
Effective 1-1-65

All distances must be from the outer boundaries of the Section.

Operator Perry R. Bass			Lease Poker Lake Unit		Well No. 52
Unit Letter B	Section 10	Township 24 South	Range 30 East	County Eddy	
Actual Footage Location of Well: <div style="display: flex; justify-content: space-between;"> 660 feet from the North line and 1980 feet from the East line </div>					
Ground Level Elev. 3454.2	Producing Formation Morrow	Pool Wildcat Morrow		Dedicated Acreage: 320 Acres	

1. Outline the acreage dedicated to the subject well by colored pencil or hatchure marks on the plat below.
2. If more than one lease is dedicated to the well, outline each and identify the ownership thereof (both as to working interest and royalty).
3. If more than one lease of different ownership is dedicated to the well, have the interests of all owners been consolidated by communitization, unitization, force-pooling, etc?

☒ Yes ☐ No If answer is "yes," type of consolidation Unit

If answer is "no," list the owners and tract descriptions which have actually been consolidated. (Use reverse side of this form if necessary.) _____

No allowable will be assigned to the well until all interests have been consolidated (by communitization, unitization, forced-pooling, or otherwise) or until a non-standard unit, eliminating such interests, has been approved by the Commission.

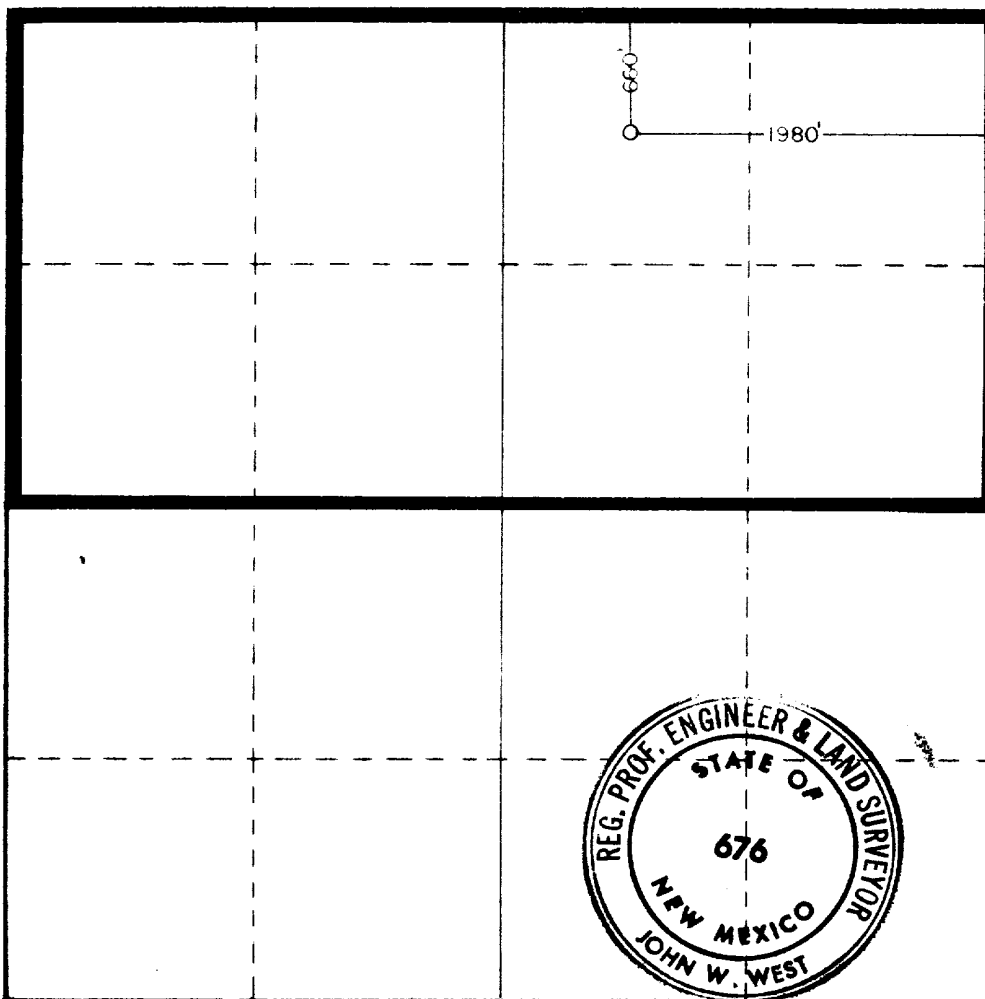

CERTIFICATION

I hereby certify that the information contained herein is true and complete to the best of my knowledge and belief.

Stephen Smith
Name

Stephen Smith

Position

Engineering Assistant

Company

Perry R. Bass

Date

2/20/81

I hereby certify that the well location shown on this plat was plotted from field notes of actual surveys made by me or under my supervision and that the same is true and correct to the best of my knowledge and belief.

Date Surveyed

2-14-81

Registered Professional Engineer and/or Land Surveyor

John W. West

Certificate No. **JOHN W. WEST 676**
PATRICK A. ROMERO 6663
Ronald J. Eidson 3239

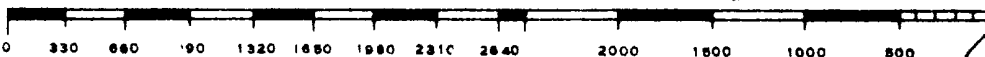



UNITED STATES
DEPARTMENT OF THE INTERIOR
GEOLOGICAL SURVEY
South Central Region
P.O. Box 26124
Albuquerque, New Mexico 87125

IN REPLY REFER TO:

RECEIVED

JUN 2 1981

O. C. D.
ARTESIA, OFFICE

MAY 29 1981

Perry R. Bass
P.O. Box 2760
Midland, Texas 79702

Gentlemen:

Your application for Permit to Drill well No. 52 Poker Lake Unit in the NW¹/4 sec. 10, T. 24 S., R. 30 E., Eddy County, New Mexico, lease LC-068905, to a depth of 15,800 feet to test the Morrow formation in the oil-potash area, is hereby approved as amended by stipulations attached to the application.

One copy of the application is returned herewith. Please notify the District Supervisor, Geological Survey, Roswell, New Mexico, in sufficient time for a representative to witness all cementing operations.

Sincerely yours,

(ORIG. SGD) JAMES W. SHELTON
(FOR
Gene F. Daniel
Oil and Gas

Enclosure

cc:

NMOCD (2)

BLM-Carlsbad

AMUOCD
GREASET-ARTESIA

South Central Region
P.O. Box 20124
Albuquerque, New Mexico 87123

William 5-14-81
John Burlew
5/24/81
Stewart 5/26/81
Trinidad 5/28/81
Stephens 5-28-81

MAY 29 1981

Ferry R. Bass
P.O. Box 2700
Midland, Texas 79702

Gentlemen:

Your application for Permit to Drill Well No. 52 Peter Lake Unit in the NE1/4 sec. 10, T. 24 N., R. 30 E., Pecos County, New Mexico, lease 10-088901, to a depth of 15,000 feet to test the Morrow formation in the oil-potash area, is hereby approved as amended by stipulations attached to the application.

One copy of the application is returned herewith. Please notify the District Supervisor, Geological Survey, Roswell, New Mexico, in sufficient time for a representative to witness all drilling operations.

Sincerely yours,

(ORIG. SGD.) JAMES W. SHELTON

FOR : Gene F. Daniel
Oil and Gas

Enclosure

cc:

AMUOCD (2)
BLM-Carlsbad

DM, SCR

DCM-Mining (2)

Regional Files (2)

Artesia ✓ (District copy)

ARF

RCP

CFlaherty:cg:5/13/81

RECEIVED
JUN 2 1981
O. C. D.
ARTESIA, OFFICE

CASING DESIGN

Poker Lake Unit No. 52

SURFACE CASING

<u>Segment</u>	<u>Size</u>	<u>Grade</u>	<u>Thread</u>	<u>Weight</u>	<u>Top</u>	<u>Bottom</u>	<u>Length</u>
1	20"	H-40	ST&C	94#	0'±	500'±	500'±

INTERMEDIATE CASING

<u>Segment</u>	<u>Size</u>	<u>Grade</u>	<u>Thread</u>	<u>Weight</u>	<u>Top</u>	<u>Bottom</u>	<u>Length</u>
1	13-3/8"	S-80	ST&C	68#	3,800'±	4,000'±	200'±
2	13-3/8"	S-80	ST&C	61#	2,800'±	3,800'±	1,000'±
3	13-3/8"	K-55	ST&C	61#	1,400'±	2,800'±	1,400'±
4	13-3/8"	K-55	ST&C	54.5#	0'±	1,400'±	1,400'±

INTERMEDIATE CASING

<u>Segment</u>	<u>Size</u>	<u>Grade</u>	<u>Thread</u>	<u>Weight</u>	<u>Top</u>	<u>Bottom</u>	<u>Length</u>
1	9-5/8"	S-95	LT&C	47#	10,360'±	12,000'±	1,640'±
2	9-5/8"	S-95	LT&C	43.5#	7,400'±	10,360'±	2,960'±
3	9-5/8"	S-95	LT&C	40#	2,820'±	7,400'±	4,580'±
4	9-5/8"	N-80	LT&C	40#	1,040'±	2,820'±	1,780'±
5	9-5/8"	S-95	LT&C	40#	0'±	1,040'±	1,040'±

DRILLING LINER

<u>Segment</u>	<u>Size</u>	<u>Grade</u>	<u>Thread</u>	<u>Weight</u>	<u>Top</u>	<u>Bottom</u>	<u>Length</u>
1	7-5/8"	S-95	LT&C	39#	11,500'±	14,500'±	3,000'±

PRODUCTION LINER

<u>Segment</u>	<u>Size</u>	<u>Grade</u>	<u>Thread</u>	<u>Weight</u>	<u>Top</u>	<u>Bottom</u>	<u>Length</u>
1	5"	N-80	Super Flush	18#	14,000'±	15,400'±	1,400'±

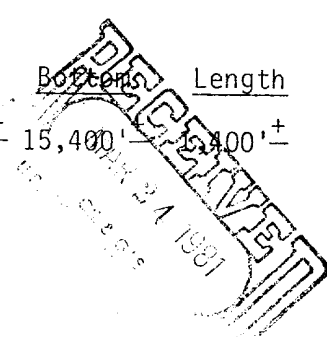

POKER LAKE UNIT NO. 52

Anticipated Formation Tops (GL 3454')

T/Rustler	450'	(+ 3,004')
T/Salt	850'	(+ 2,604')
B/Salt	3,750'	(- 296')
T/Delaware	3,950'	(- 496')
T/Bone Springs	7,750'	(- 4,296')
T/Wolfcamp	11,350'	(- 7,896')
T/Strawn	13,450'	(- 9,996')
T/Atoka	13,650'	(-10,196')
T/M. Morrow	14,750'	(-11,296')
T/L. Morrow	15,200'	(-11,746')

Stephen Smith
Stephen Smith



DRILLING PROCEDURE
POKER LAKE UNIT NO. 52

Location:

1980' FEL, 660' FNL, Sec. 10, T24S, R30E

Conductor Casing:

40' + of 30" conductor casing will be set with a rathole machine and cemented to the surface with ready mix.

Surface Hole:

A 24" O.H. will be drilled to 500' + (Rustler) and 20" 94#/ft H-40 casing run to total depth. The surface casing will be cemented with + 500 sx Class "C" plus 2% CaCl₂. Cement must be circulated to the surface.

Total WOC time is 8 hours.

Nippling Up 20" Casing:

After waiting 4 hours, "nippling up" procedures may begin. A 20" SW 3000# WP x 20" 2000# WP casinghead will be welded in place. A set of hydraulic operated pipe and blind rams will then be installed (see BEPCO II attached) and tested to 1000 psi with the rig pump.

The results of this test must be reported in the daily driller's log.

Intermediate Hole:

A 17-1/2" O.H. will then be drilled to 4000'+ with 10 ppg BW (T/Delaware Mtn. Group); 13-3/8" casing will be run to total depth and cemented with approximately 800 sxs Halliburton Lite plus 8# NaCl/sx plus 1/4#/sx floccel, "tailed-in" with 200 sx Class "C" with 2% CaCl₂ plus 1/4#/sx floccel. Cement will be circulated to the surface.

Total WOC time for this casing string will be 12 hours.

Nippling Up the 13-3/8" Casing:

After waiting 4 hours, "nippling up" procedures may begin. The 20" casinghead will be removed and a 13-3/8" SW 5000# WP x 12" 5000# WP casinghead installed.

A BOP stack consisting of hydril, pipe rams and blind rams will be installed as per BEPCO Drawing IV (attached). This BOP stack will be hydrostatically tested to 5000 psi (Hydril 1500#) by Yellow Jacket. The USGS will be notified in sufficient time to witness the testing of the 13-3/8" BOP stack. A copy of the test results will also be furnished to the USGS.

The results of this test will be recorded in the daily drillers log.

Production Hole:

A 12-1/4" O.H. will then be drilled to 12,000'. The drilling fluid will be fresh water to 11,300'+ and 10 ppg brine from T/Wolfcamp to 12,000', with variations in mud weight as dictated by formation pressures. A PVT recorder, flowshow sensor and rotating head will be installed before drilling the Wolfcamp.

9-5/8" casing will be run to 12,000'. This casing string will be cemented with approximately 900 sx Class "H" plus 0.3% CFR-2, plus 0.6% Halad 22. The cement volume should be sufficient to bring the cement top 1000' above the Wolfcamp.

After waiting on cement 4 hours, the 9-5/8" casing can be cut off and a 12" 5000# x 10" 5000# casing spool installed. The same BOP stack, i.e. 2 sets of rams and hydril as per BEPCO IV (attached) will be installed. The stack will again be tested to 5000 psi (hydril 1500 psi) with Yellow Jacket.

8-1/2" OH will then be drilled to 14,500' with a 10.1-13.0 ppg brine water fluid. At 14500' a 7-5/8" liner will be run and cemented with approximately 500 sx Class "H" plus 0.3% HR-4.

After testing this liner top to 2000 psi, a 6-1/4" OH will be drilled to TD (15400'+) and a 5" liner set. The 5" liner will be cemented with \pm 400 sx Class "H" plus 0.3% HR-4.

Time: This well is estimated to take 99 days from spud to TD.

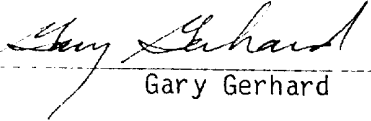

Gary Gerhard

GEG/jj

POKER LAKE UNIT #52

Mud Program

<u>Interval</u>	<u>Type</u>	<u>Wt. (Approx.)</u>	<u>Vis.</u>	<u>Wtr. Loss</u>
0' - 500' <u>±</u>	Fresh Wtr.	8.4 - 8.8#	34 - 40	NC
500' <u>±</u> - 4,000' <u>±</u>	Brine Wtr.	10.0#	28 - 30	NC
4,000' <u>±</u> - 11,350' <u>±</u>	Fresh Wtr.	8.4 - 8.9#	28 - 32	NC
11,350' <u>±</u> - 12,000' <u>±</u>	Brine Wtr.	9.2 - 9.4#	28 - 32	NC
12,000' <u>±</u> - 13,650' <u>±</u>	Brine Wtr.	10.0 - 10.3#	28 - 30	NC
13,650' <u>±</u> - 14,500' <u>±</u>	Brine Wtr.	12.5 - 14.0#	34 - 40	15 CC
14,500' <u>±</u> - TD	Brine Wtr.	10.1 - 10.3#	32 - 34	10 CC or Less