

Drawer DD

Artesia, NM 88210

SUBMIT IN LOCATE* (Other instructions on reverse side)

Form approved. Budget Bureau No. 42-R1425.

UNITED STATES DEPARTMENT OF THE INTERIOR GEOLOGICAL SURVEY

APPLICATION FOR PERMIT TO DRILL, DEEPEN, OR PLUG BACK

1a. TYPE OF WORK

DRILL ☒

DEEPEN ☐

PLUG BACK ☐

b. TYPE OF WELL

OIL WELL ☐

GAS WELL ☒

OTHER

SINGLE ZONE ☒

MULTIPLE ZONE ☐

2. NAME OF OPERATOR

Amoco Production Company

3. ADDRESS OF OPERATOR

P. O. Box 68, Hobbs, New Mexico 88240

RECEIVED

4. LOCATION OF WELL (Report location clearly and in accordance with any State requirements.)*

At surface

1980' FNL X 660' FWL

At proposed prod. zone (Unit letter E, SW/4,NW/4)

JAN 14 1983

O. C. D.

ARTESIA, OFFICE

14. DISTANCE IN MILES AND DIRECTION FROM NEAREST TOWN OR POST OFFICE*

15. DISTANCE FROM PROPOSED*

LOCATION TO NEAREST PROPERTY OR LEASE LINE, FT. (Also to nearest drlg. unit line, if any)

18. DISTANCE FROM PROPOSED LOCATION* TO NEAREST WELL, DRILLING, COMPLETED, OR APPLIED FOR, ON THIS LEASE, FT.

16. NO. OF ACRES IN LEASE

19. PROPOSED DEPTH

12,300

17. NO. OF ACRES ASSIGNED TO THIS WELL

320

20. ROTARY OR CABLE TOOLS

Rotary

21. ELEVATIONS (Show whether DF, RT, GR, etc.)

3361.3' GL

23.

PROPOSED CASING AND CEMENTING PROGRAM

SIZE OF HOLE	SIZE OF CASING	WEIGHT PER FOOT	SETTING DEPTH
17-1/2	13-3/8	48#	400'
11-12-1/4	8-5/8	32,28,32#	5600'
7-7/8	5-1/2	20,17,15.5,17 20#	12300'

circulate to surface
circulate to surface
tie back to 8-5/8"

significant

Propose to drill and equip well in the Morrow formation. After reaching TD, logs will be run and evaluated. Perforate & stimulate as necessary in attempting commercial production.

Mud Program: 0-400' Fresh water and Native mud.
400-5600' Cut brine.
5600-12300' Cut brine. Mud up with Klafree-KCl before entering Morrow.

BOP Diagram attached.
Archaeological survey Attached.
Gas is not dedicated.

RECEIVED
JAN 11 1983

IN ABOVE SPACE DESCRIBE PROPOSED PROGRAM: If proposal is to deepen or plug back, give data on present productive zone and proposed new productive zone. If proposal is to drill or deepen directionally, give pertinent data on subsurface locations and measured and true vertical depths. Give blowout preventer program, if any.

24.

SIGNED

Charles M. Searing

TITLE

OIL & GAS
GEOLOGICAL SURVEY
ROSWELL, NEW MEXICO
Assist. Admin. Analyst

DATE

12-28-82

(This space for Federal or State office use)

PERMIT NO.

(Orig. Sgd.) GEORGE H. STEWART

APPROVAL DATE

APPROVED BY

JAN 12 1983

TITLE

CONDITIONS OF APPROVAL, IF ANY:

JAMES A. GILLHAM
DISTRICT SUPERVISOR

*See Instructions On Reverse Side

MEXICO OIL CONSERVATION COMMISSION
WELL LOCATION AND ACREAGE DEDICATION PLAT

Form C-102
 Supersedes C-128
 Effective 1-1-85

All distances must be from the outer boundaries of the Section.

Operator AMOCO PRODUCTION CO.			Lease SLAUGHTER CANYON FEDERAL UNIT		Well No. 1
Unit Letter E	Section 24	Township 26 SOUTH	Range 26 EAST	County EDDY	
Actual Footage Location of Well: 1980 feet from the NORTH line and 660 feet from the WEST line					
Ground Level Elev. 3361.3	Producing Formation Morrow	Pool Wildcat Morrow	Dedicated Acreage: 320 Acres		

1. Outline the acreage dedicated to the subject well by colored pencil or hachure marks on the plat below.
2. If more than one lease is dedicated to the well, outline each and identify the ownership thereof (both as to working interest and royalty).
3. If more than one lease of different ownership is dedicated to the well, have the interests of all owners been consolidated by communitization, unitization, force-pooling, etc?

☒ Yes ☐ No If answer is "yes," type of consolidation unitization

If answer is "no," list the owners and tract descriptions which have actually been consolidated. (Use reverse side of this form if necessary.) _____

No allowable will be assigned to the well until all interests have been consolidated (by communitization, unitization, forced-pooling, or otherwise) or until a non-standard unit, eliminating such interests, has been approved by the Commission.

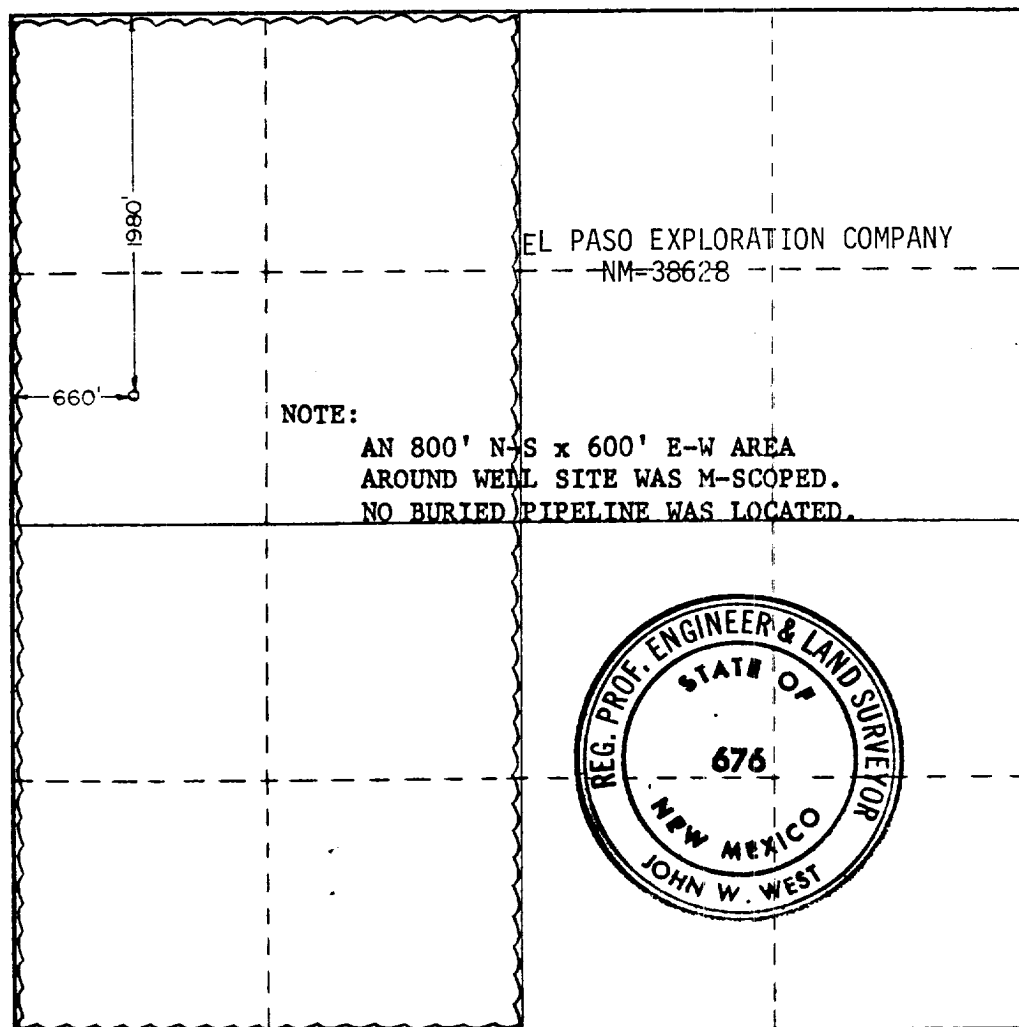

CERTIFICATION

I hereby certify that the information contained herein is true and complete to the best of my knowledge and belief.

Name Charles M. Lerring
 Position Assist. Admin. Analyst
 Company Amoco Production Company
 Date January 3, 1983

I hereby certify that the well location shown on this plat was plotted from field notes of actual surveys made by me or under my supervision, and that the same is true and correct to the best of my knowledge and belief.

Date Surveyed 12/28/82
 Registered Professional Engineer and/or Land Surveyor

John W. West
 Certificate No JOHN W. WEST NO. 676

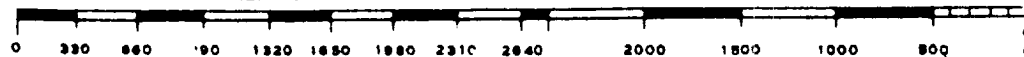

DESIGNATION OF OPERATOR

The undersigned is, on the records of the Bureau of Land Management, holder of lease

DISTRICT LAND OFFICE: Santa Fe, New Mexico
SERIAL No.: NM 38628

and hereby designates

NAME: Amoco Production Company
ADDRESS: P. O. Box 3092, Houston, Texas 77253

as his operator and local agent, with full authority to act in his behalf in complying with the terms of the lease and regulations applicable thereto and on whom the supervisor or his representative may serve written or oral instructions in securing compliance with the Operating Regulations with respect to (describe acreage to which this designation is applicable):

Township 26 South, Range 26 East, N.M.P.M., Eddy County, New Mexico
Section 24: All

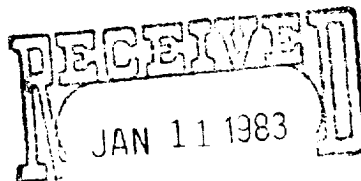

It is understood that this designation of operator does not relieve the lessee of responsibility for compliance with the terms of the lease and the Operating Regulations. It is also understood that this designation of operator does not constitute an assignment of any interest in the lease.

In case of default on the part of the designated operator, the lessee will make full and prompt compliance with all regulations, lease terms, or orders of the Secretary of the Interior or his representative.

The lessee agrees promptly to notify the supervisor of any change in the designated operator.

El Paso Exploration Company

By:

D. N. Canfield
(Signature of lessee)

D. N. Canfield, Vice President

December 30, 1982
(Date)

P. O. Box 1492, El Paso, Texas 79978
(Address)



10,000 PSI BOP STACK
Safety String Size 4 7/8"

Well Name
Rio

ROTATING HEAD
Fill on Line
NOTE: USE WELL-TEST
PLUG IN 10' 10" UP TO
TEST STACK - TEST 1572
FLOOD WITH FLOO DUMP.
DO NOT USE Ret.
Bridges Plug in 9 5/8 Bsg.

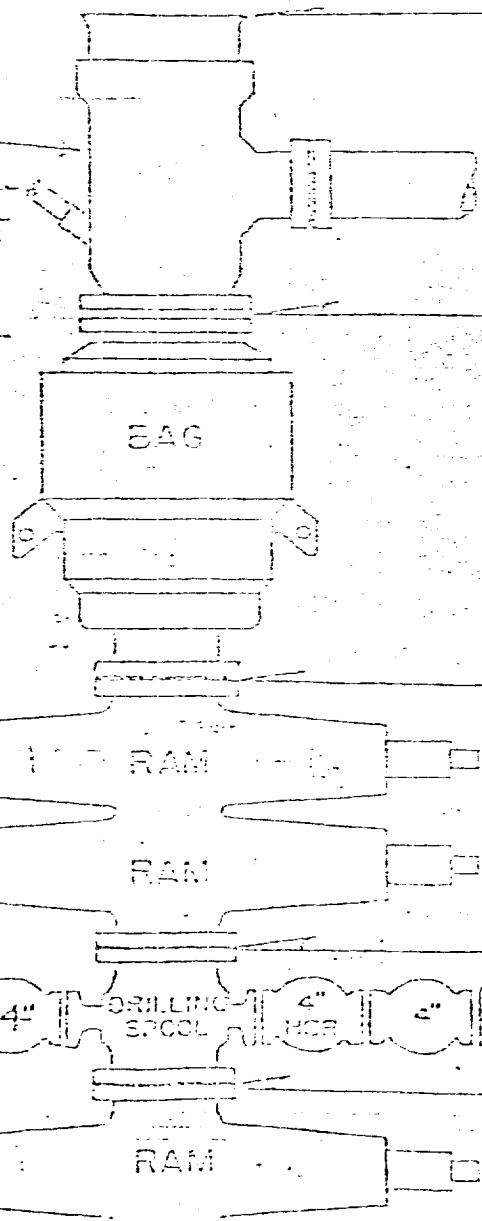

Cable 2' Long
Cut off 1 1/2" Plug

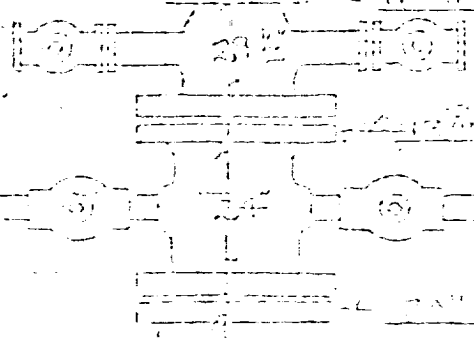

AMOCO EQUIPMENT
ONLY BELOW THIS
LINE

Attachment to "Application for Permit to Drill", Form 9-331 C

1. Location

See attached Form C-102

2. Elevation

See attached Form C-102

3. Geologic name of surface formation.

Permian Salado

4. Type of drilling tools and associated equipment to be utilized.

See Form 9-331 C

5. Proposed drilling depth.

See Form 9-331 C

6. Estimated tops of important geologic markers.

Delaware	1800'	Strawn	10,860'
Bone Springs	5437'	Atoka	11,100'
Wolfcamp	8650'	M. Morrow	12,018'

7. Estimated depths at which anticipated water, oil, gas or other mineral-bearing formations are expected to be encountered.

Strawn 10,860'
M. Morrow 12,018'

8. Proposed casing program, including size, grade, and weight of each string and whether it is new or used.

<u>Depth</u>	<u>Size</u>	<u>Weight</u>	<u>Grade</u>	<u>New or Used</u>
400'	13-3/8	48#	H-40	New
5600'	8-5/8	32,28,32	S-80	New
12300'	5-1/2	20,17,15.5,17,20#	N-80, K-55 N-80, S-95 N-80	New

9. Proposed cementing program.

13-3/8 - Circulate to surface
8-5/8 - Circulate to surface
5-1/2 - Tie back to 8-5/8

Lighter Canyon Fed. Ut. No.1
 1980' FNL X 660' FWL
 Sec. 24, T-26-S, R-26-E
 Eddy County, New Mexico
 Exhibit A

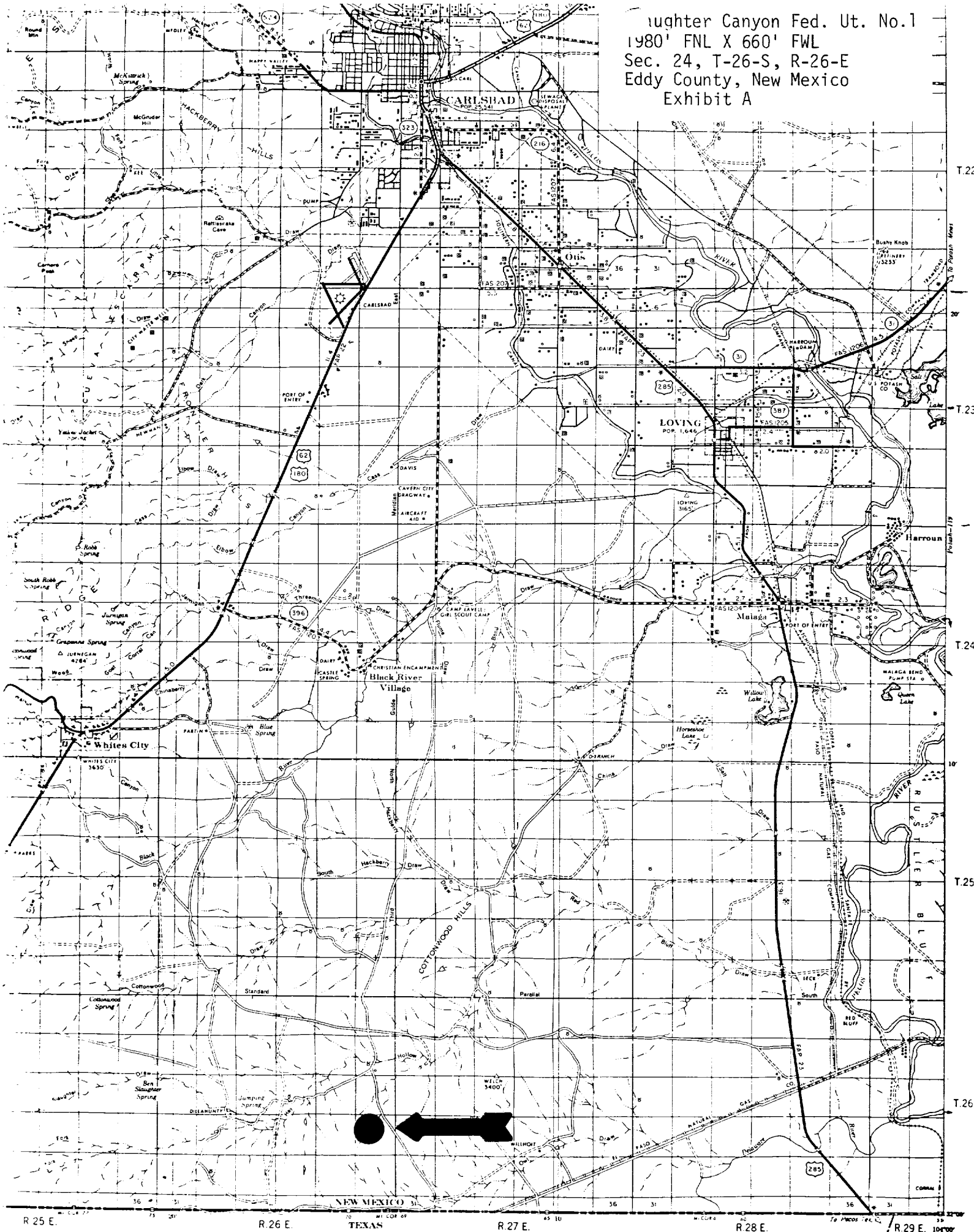

Scale 190000 or 1 Inch = 3 Miles

CARLSBAD QUADRANGLE

DRILL SITE DIMENSIONS

Slaughter Canyon Fed. Ut. No.1
 100' FNL X 660' FWL
 Sec. 24, T-26-S, R-26-E
 Eddy County, New Mexico
 Exhibit D

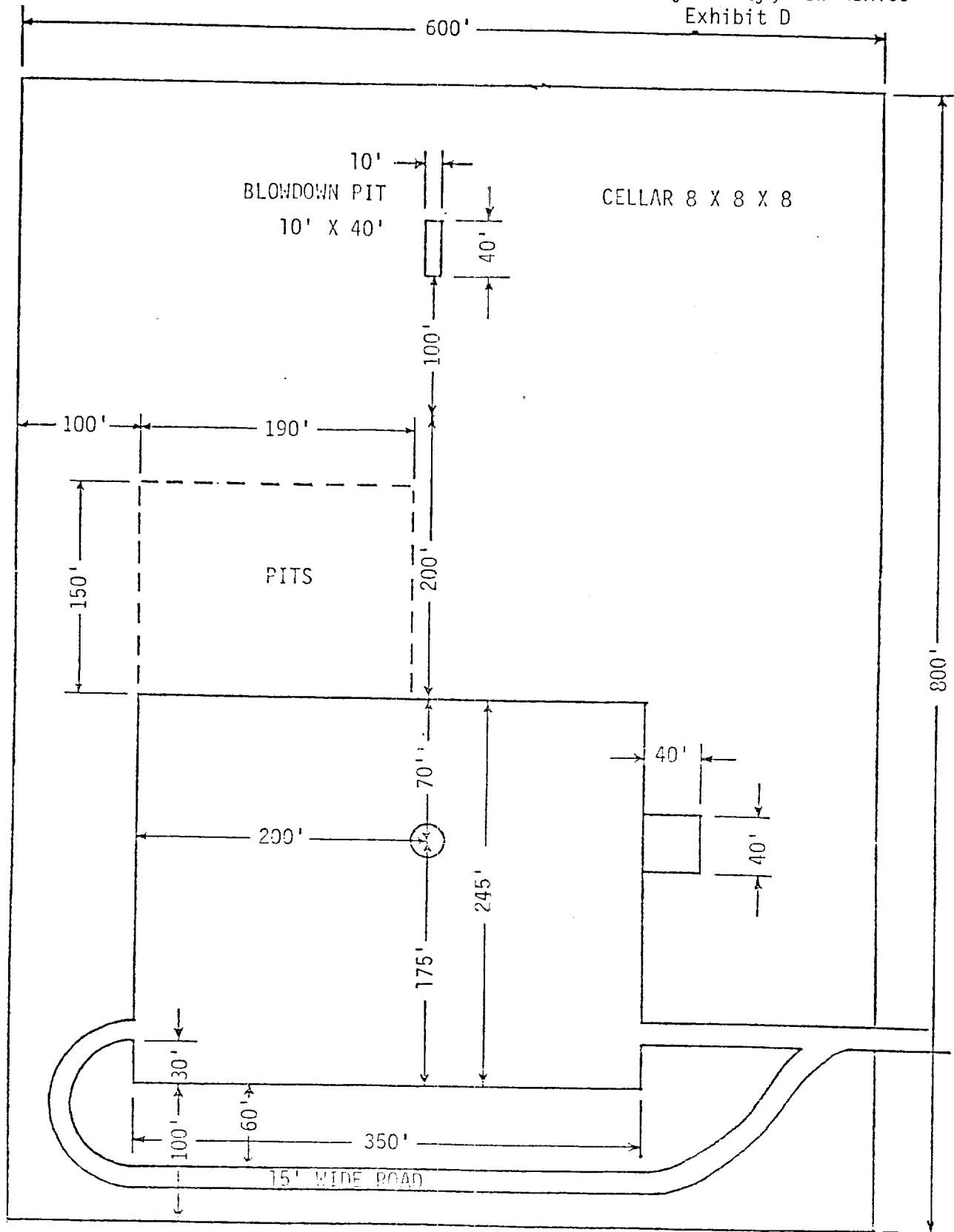

FOR WELL 8000' OR DEEPER