

STATE OF NEW MEXICO
ENERGY AND MINERALS DEPARTMENT

OIL CONSERVATION DIVISION

P. O. BOX 2088

SANTA FE, NEW MEXICO 87501

JUL 06 1983

O. C. D.

ARTESIA OFFICE

AMENDED

30-015-24494

Form C-101
Revised 10-1-78

NO. OF COPIES RECEIVED	
DISTRIBUTION	
SANTA FE	<input checked="" type="checkbox"/>
FILE	<input checked="" type="checkbox"/>
U.S.G.S.	<input checked="" type="checkbox"/>
LAND OFFICE	<input checked="" type="checkbox"/>
OPERATOR	<input checked="" type="checkbox"/>

5A. Indicate Type of Lease
STATE ☐ FEE ☒
5. State Oil & Gas Lease No.

APPLICATION FOR PERMIT TO DRILL, DEEPEN, OR PLUG BACK

1a. Type of Work b. Type of Well OIL WELL <input checked="" type="checkbox"/> GAS WELL <input type="checkbox"/> OTHER <input type="checkbox"/> SINGLE ZONE <input checked="" type="checkbox"/> MULTIPLE ZONE <input type="checkbox"/>		2. Name of Operator Mesa Petroleum Co.		7. Unit Agreement Name	
3. Address of Operator P. O. Box 2009 / Amarillo, Texas 79189		8. Farm or Lease Name Hondo Fee		9. Well No. 1	
4. Location of Well UNIT LETTER F LOCATED 2310 FEET FROM THE North LINE AND 1650 FEET FROM THE West LINE OF SEC. 32 TWP. 20S RGE. 28E NMPW		10. Field and Pool, or Wildcat Under Avalon Delaware		12. County Eddy	
21. Elevations (Show whether DF, KT, etc.) 3213' GR		21A. Kind & Status Plug. Bond Blanket		19. Proposed Depth 5000'	
21B. Drilling Contractor TMBR Drilling, Inc.		19A. Formation Delaware		20. Rotary or C.T. Rotary	
22. Approx. Date Work will start July 15, 1983					

PROPOSED CASING AND CEMENT PROGRAM

SIZE OF HOLE	SIZE OF CASING	WEIGHT PER FOOT	SETTING DEPTH	SACKS OF CEMENT	EST. TOP
17 1/2"	13 3/8"	48#	600	500	Surface
12 or 12 1/4"	8 5/8"	24#	2550*	600	Circulate
7 7/8"	5 1/2"	14.5#	5000	500	Cover all pay

(*or through bottom of Capitan Reef)

Propose to drill 17 1/2" hole with fresh water to approximately 600' and set 13 3/8" surface casing. Will circulate cement to surface; drill 12 or 12 1/4" hole with fresh water to approximately 2550 (bottom of Capitan Reef) and set 8 5/8" casing. Will circulate cement to surface, or at least 150' into surface casing; nipple up 3000 psi BOP's and drill 7 7/8" hole to TD.

NOTE: Original location was 1980' FNL & 1650' FWL.

APPROVAL VALID FOR 180 DAYS
PERMIT EXPIRES 1/8/84
UNLESS DRILLING UNDERWAY

Posted 7-15-83
w/ BOP

XC: NMOC-D-A (O+6), CEN RCDS, ACCTG, OPS(FILE), MAT CONT, RES ENG, MIDLAND, ROSWELL, PARTNERS

IN ABOVE SPACE DESCRIBE PROPOSED PROGRAM; IF PROPOSAL IS TO DEEPEN OR PLUG BACK, GIVE DATA ON PRESENT PRODUCTIVE ZONE AND PROPOSED NEW PRODUCTIVE ZONE. GIVE BLOWOUT PREVENTER PROGRAM, IF ANY.

I hereby certify that the information above is true and complete to the best of my knowledge and belief.

Signed R. E. Martin Title REGULATORY COORDINATOR Date 7-5-83

(This space for State Use)

APPROVED BY _____ TITLE _____ DATE JUL 12 1983

CONDITIONS OF APPROVAL, IF ANY:

Cement to be circulated to
surface to 13 3/8" casing

MEXICO OIL CONSERVATION COMMISSION
WELL LOCATION AND ACREAGE DEDICATION PLAT

Form C-102
 Supersedes C-128
 Effective 1-1-65

All distances must be from the outer boundaries of the Section

Mesa Petroleum Company			Hondo Fee		Area No. 1
F	32	20 South	28 East	Eddy County	
2310 feet from the North		1650 feet from the West			
3213.0	Delaware	Avalon Delaware		40 Acres	

- 1 Outline the acreage dedicated to the subject well by colored pencil or hatchure marks on the plat below.
- 2 If more than one lease is dedicated to the well, outline each and identify the ownership thereof (both as to working interest and royalty).
- 3 If more than one lease of different ownership is dedicated to the well, have the interests of all owners been consolidated by communitization, unitization, force-pooling, etc?

☒ Yes ☐ No If answer is "yes," type of consolidation _____

If answer is "no," list the owners and tract descriptions which have actually been consolidated (Use reverse side of this form if necessary.) _____

No allowable will be assigned to the well until all interests have been consolidated (by communitization, unitization, forced-pooling, or otherwise) or until a non-standard unit, eliminating such interests, has been approved by the Commission.

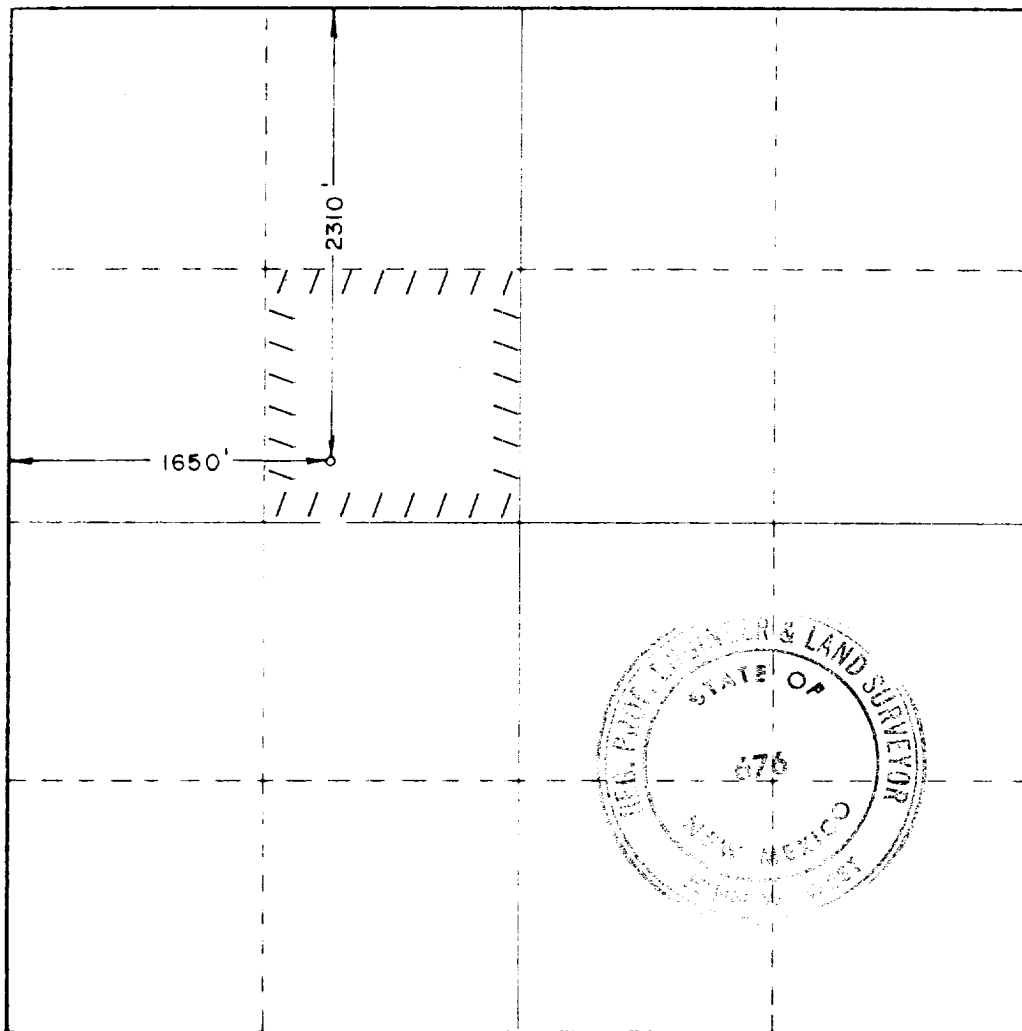

CERTIFICATION

I hereby certify that the information contained herein is true and complete to the best of my knowledge and belief.

R. E. Mathis

R. E. Mathis

Regulatory Coordinator

Mesa Petroleum Co.

7-5-83

I hereby certify that the well location shown on this plat was plotted from field notes of actual surveys made by me or under my supervision, and that the same is true and correct to the best of my knowledge and belief.

Date Surveyed:

June 29, 1983

Registered Professional Engineer and Land Surveyor

John W. West

Certificate No. JOHN W. WEST, 676
 RONALD J. EIDSON, 3239

330 660 990 1320 1650 1980 2310 2640 2970 3300 3630 3960 4290 4620 4950 5280 5610 5940 6270 6600