

RECEIVED

OCT 25 1983

O. C. D.
ARTESIA, OFFICE

NO. OF COPIES RECEIVED	
DISTRIBUTION	
SANTA FE	<input checked="" type="checkbox"/>
FILE	<input checked="" type="checkbox"/>
U.S.G.S.	<input checked="" type="checkbox"/>
LAND OFFICE	<input checked="" type="checkbox"/>
OPERATOR	<input checked="" type="checkbox"/>

5A. Indicate Type of Lease STATE <input type="checkbox"/> FEE <input checked="" type="checkbox"/>
5. State Oil & Gas Lease No.
7. Unit Agreement Name
8. Farm or Lease Name Gable "FV"
9. Well No. 3
10. Field and Pool, or Wildcat Und. Eagle Creek/SA
17. County Eddy

APPLICATION FOR PERMIT TO DRILL, DEEPEN, OR PLUG BACK

a. Type of Work

DRILL ☒DEEPEN ☐PLUG BACK ☐

b. Type of Well

OIL WELL ☒GAS WELL ☐OTHER ☐SINGLE ZONE ☐MULTIPLE ZONE ☐

2. Name of Operator

Yates Petroleum Corporation

3. Address of Operator

207 S. 4th, Artesia, New Mexico 88210

4. Location of Well

UNIT LETTER H

LOCATED 2310

FEET FROM THE North

LINE

AND 330 FEET FROM THE East

LINE OF SEC. 29

TWP. 17S

RGE. 25E

NMPM

21. Elevations (Show whether DF, RT, etc.)

3586' GL

21A. Kind & Status Plug. Bond

Blanket

19. Proposed Depth

1450'

19A. Formation

San Andres

20. Rotary or C.T.

Rotary

21B. Drilling Contractor

LaRue #2

22. Approx. Date Work will start

ASAP

23.

PROPOSED CASING AND CEMENT PROGRAM

SIZE OF HOLE	SIZE OF CASING	WEIGHT PER FOOT	SETTING DEPTH	SACKS OF CEMENT	EST. TOP
14 1/2"	10 3/4"	30#	appr. 320'	200 sx	circulated
9 1/2"	7"	23#	appr. 1100'	700 sx	circulated
6 1/4"	4 1/2"	9.5#	TD	150 sx	circulated

Proposed to drill a San Andres test with approximately 350' of surface casing to shut off gravel and caving. 7" intermediate casing will be run and set 100' below the Artesian Zone and if commercial production is encountered a string will be run, perforated and stimulated for production.

MUD PROGRAM: FW gel/LCM to 1150', (or dry drill), water to TD.

BOP PROGRAM: If needed, BOP's will be installed on 7" casing and tested daily.

GAS NOT DEDICATED.

APPROVAL VALID FOR 180 DAYS
PERMIT EXPIRES 4-26-84
UNLESS DRILLING UNDERWAY

Posted 10/25/83
J.D. 10/25/83

4. ABOVE SPACE DESCRIBE PROPOSED PROGRAM; IF PROPOSAL IS TO DEEPEN OR PLUG BACK, GIVE DATA ON PRESENT PRODUCTIVE ZONE AND PROPOSED NEW PRODUCTIVE ZONE. GIVE BLOWOUT PREVENTER PROGRAM, IF ANY.

hereby certify that the information above is true and complete to the best of my knowledge and belief.

Signed Shirley Roberts Title Regulatory Agent

Date 10/24/83

(This space for State Use)

APPROVED BY Mike Walker

TITLE

OIL AND GAS INSPECTOR

DATE

OCT 26 1983

CONDITIONS OF APPROVAL, IF ANY:

Notify N.M.O.C.C. in sufficient
time to witness cementing

the 7 casing

**NEW MEXICO OIL CONSERVATION COMMISSION
WELL LOCATION AND ACREAGE DEDICATION PLAT**

Form C-102
Supersedes C-128
Effective 1-1-6

All distances must be from the outer boundaries of the Section.

Operator YATES PETROLEUM CORPORATION			Lease Gable FV		Well No. 3
Unit Letter H	Section 29	Township 17 South	Range 25 East	County Eddy	
Actual Footage Location of Well: 2310 feet from the North line and 330 feet from the East line					
Ground Level Elev. 3586	Producing Formation SAN ANDRES	Pool Und.	Dedicated Acreage: 40		Acreage
EAGLE CREEK SA					

1. Outline the acreage dedicated to the subject well by colored pencil or hachure marks on the plat below.
2. If more than one lease is dedicated to the well, outline each and identify the ownership thereof (both as to working interest and royalty).
3. If more than one lease of different ownership is dedicated to the well, have the interests of all owners been consolidated by communitization, unitization, force-pooling, etc?

☐ Yes ☒ No If answer is "yes," type of consolidation _____

If answer is "no," list the owners and tract descriptions which have actually been consolidated. (Use reverse side of this form if necessary.) _____

No allowable will be assigned to the well until all interests have been consolidated (by communitization, unitization, forced-pooling, or otherwise) or until a non-standard unit, eliminating such interests, has been approved by the Commission.

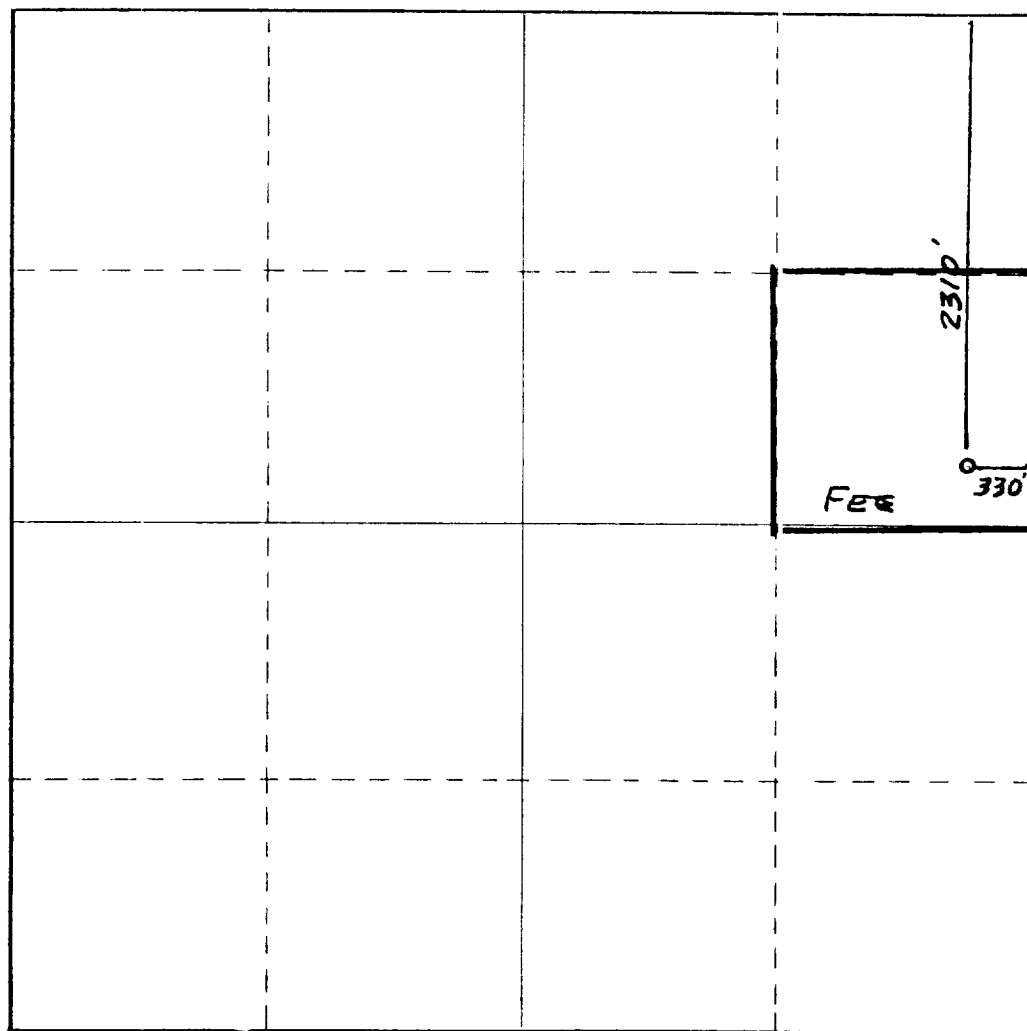

CERTIFICATION

I hereby certify that the information contained herein is true and complete to the best of my knowledge and belief.

Gliscro Rodriguez
Name
GLISCRO RODRIGUEZ
Position
REG. AGENT
Company
YATES PET. CORP
Date
9-20-83

I hereby certify that the well location shown on this plat was plotted from field notes of actual surveys made by me or under my supervision, and that the same is true and correct to the best of my knowledge and belief.

Date Surveyed
September 17, 1983

Registered Professional Engineer
and a Land Surveyor

Jan R. Reddy
Certificate No.

NM PE&LS #5412

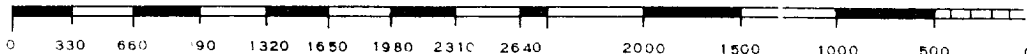

EXHIBIT B
BDP DIAGRAM
RATED 3000[#]

