

All distances must be from the outer boundaries of the Section.

Operator Fred Pool Operating Co.		Lease Arco Federal		Well No. #2
Unit Letter H	Section 21	Township 18 South	Range 29 East	County Eddy
Actual Postage Location of Well: 2310 feet from the North line and 940 feet from the East line				
Ground Level Elev. 3478'	Producing Formation QN/GRBG/SA	Pool Unit Loco Hills-A-G-SA	Dedicated Acreage 40 Acres	

- Outline the acreage dedicated to the subject well by colored pencil or hatchure marks on the plat below.
- If more than one lease is dedicated to the well, outline each and identify the ownership thereof (both as to working interest and royalty).
- If more than one lease of different ownership is dedicated to the well, have the interests of all owners been consolidated by communitization, unitization, force-pooling, etc?

☐ Yes ☐ No If answer is "yes," type of consolidation _____

If answer is "no," list the owners and tract descriptions which have actually been consolidated. (Use reverse side of this form if necessary.) _____

No allowable will be assigned to the well until all interests have been consolidated (by communitization, unitization, forced-pooling, or otherwise) or until a non-standard unit, eliminating such interests, has been approved by the Division

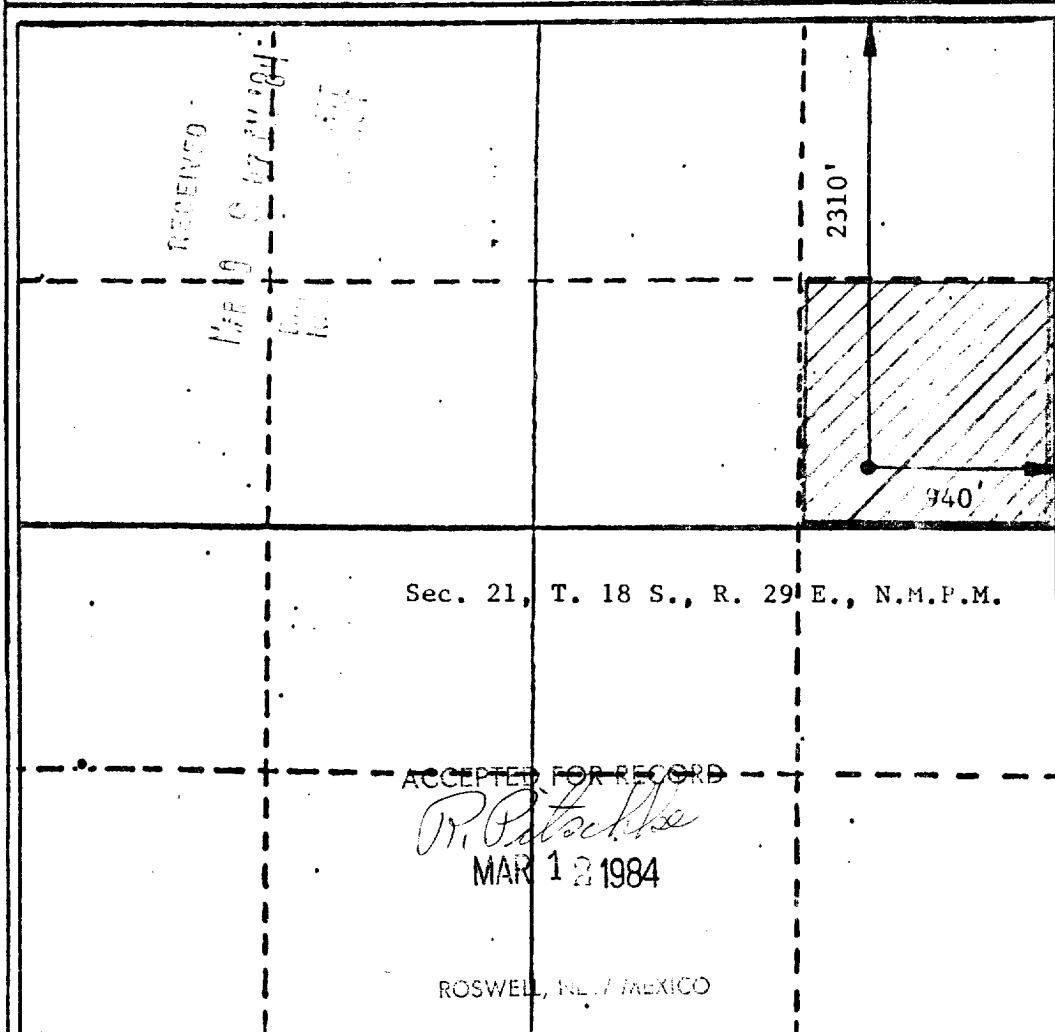

CERTIFICATION

I hereby certify that the information contained herein is true and complete to the best of my knowledge and belief.

Fred F. Pool III

Name
Fred F. Pool III

Position
Petroleum Engineer

Company
Fred Pool Operating Co.

Date
March 9, 1984

I hereby certify that the well location shown on this plat was plotted from field notes of actual surveys made by me or under my supervision, and that the same is true and correct to the best of my knowledge and belief.

John D. Jaques
Date Surveyed
March 8, 1984
Registered Professional Engineer
and/or Land Surveyor
John D. Jaques, P.E. & L.S.
Certificate No.
6290

330 660 990 1320 1650 1980 2310 2640 2970 3300 3630 3960

Post. 10-1-78
3-30-84