

30-015-24802

NO. OF COPIES RECEIVED		
DISTRIBUTION		
SANTA FE	✓	
FILE	✓	✓
U.S.G.S.	✓	
LAND OFFICE	✓	
OPERATOR	✓	

## NEW MEXICO OIL CONSERVATION COMMISSION

Form C-101  
Revised 1-1-65

<b>RECEIVED BY</b> <b>JAN 31 1984</b> O C D ARTESIA, OFFICE		SA. Indicate Type of Lease STATE <input checked="" type="checkbox"/> FEE <input type="checkbox"/>
		5. State Oil & Gas Lease No. <b>B - 2130</b>
7. Unit Agreement Name <b>Burnham Grayburg San Andres Unit</b>		8. Farm or Lease Name <b>Tract No. 4</b>
9. Well No. <b>2</b>		10. Field and Pool, or Wildcat <b>Square Lake-Grayburg-SA</b>
11. County <b>Eddy</b>		12. County <b>Eddy</b>
13. Proposed Depth <b>3250'</b>		14. Formation <b>Grayburg</b>
15. Rotary or C.T. <b>Rotary</b>		16. Drilling Contractor <b>W E K Drilling Co.</b>
17. Approx. Date Work will start <b>May 1, 1984</b>		18. Elevation (Show whether DT, RT, etc.) <b>3759.3' GL</b>
19. Kind & Status Plug. Bond <b>Blanket</b>		20. Kind & Status Plug. Bond <b>Blanket</b>

APPLICATION FOR PERMIT TO DRILL, DEEPEN, OR PLUG BACK

1a. Type of Work  
b. Type of Well  
 DRILL ☒ DEEPEN ☐ PLUG BACK ☐  
 OIL WELL ☒ GAS WELL ☐ OTHER ☐ SINGLE ZONE ☐ MULTIPLE ZONE ☐

2. Name of Operator  
**Anadarko Production Company**

3. Address of Operator  
**P. O. Drawer 130, Artesia, New Mexico 88210**

4. Location of Well  
 UNIT LETTER **P** LOCATED **1210** FEET FROM THE **South** LINE  
 AND **1220** FEET FROM THE **East** LINE OF SEC. **2** T. **17S** R. **30E** N. **40E**

5. Elevation (Show whether DT, RT, etc.)  
**3759.3' GL**

6. Kind & Status Plug. Bond  
**Blanket**

7. Drilling Contractor  
**W E K Drilling Co.**

8. Approx. Date Work will start  
**May 1, 1984**

## PROPOSED CASING AND CEMENT PROGRAM

SIZE OF HOLE	SIZE OF CASING	WEIGHT PER FOOT	SETTING DEPTH	SACKS OF CEMENT	EST. TOP
12-1/4"	8-5/8"	24.0#	500'	Approx. 250	Circulated
7-7/8"	5-1/2"	15.5#	3250'	Approx. 500	Circulated

1. Rig up rotary tool.
2. Drill 12-1/4" hole to approx. 500'; set & circulate or readymix cement to surface on 8-5/8" casing. Install & test Series 900 Double Ram Hydraulic Blowout Preventor.
3. Drill 7-7/8" hole to T D (approx. 3250'); run Open Hole Logs.
4. Set & circulate cement on 5-1/2" casing from T D to surface.
5. Perforate, acidize and fracture treat.
6. Run 2-3/8" tubing, rods and bottomhole pump; install pumping equipment and place well on production.

Note: This is an unorthodox location; a hearing has been scheduled in Santa Fe February 29, 1984 for approval of this location.

180 DAYS  
4-19-84  
W. E. K. DRILLING CO.

IN ABOVE SPACE DESCRIBE PROPOSED PROGRAM; IF PROPOSAL IS TO DEEPEN OR PLUG BACK, GIVE DATA ON PRESENT PRODUCTIVE ZONE AND PROPOSED NEW PRODUCTIVE ZONE. GIVE BLOWOUT PREVENTER PROGRAM, IF ANY.

I hereby certify that the information above is true and complete to the best of my knowledge and belief.

Signed Truman D. Jones Title Field Foreman Date January 30, 1984  
 (This space for State Use)

APPROVED BY Mike Walker TITLE OIL AND GAS INSPECTOR DATE MAR 14 1984  
 CONDITIONS OF APPROVAL, IF ANY:

Post-APB  
SD-107f BB.  
3-16-84

**NEW MEXICO OIL CONSERVATION COMMISSION  
WELL LOCATION AND ACREAGE DEDICATION PLAT**

Form C-102  
Supersedes C-128  
Effective 1-1-65

All distances must be from the outer boundaries of the Section.

Operator <b>ANADARKO PRODUCTION COMPANY</b>			Lease <b>Burnham Tract #4</b>		Well No. <b>2</b>
Unit Letter <b>P</b>	Section <b>2</b>	Township <b>17 South</b>	Range <b>30 East</b>	County <b>Eddy</b>	
Actual Footage Location of Well:					
<b>1220</b> feet from the <b>East</b> line and		<b>1210</b> feet from the <b>South</b> line			
Ground Level Elev. <b>3759.3</b>	Producing Formation <b>Grayburg</b>	Pool <b>Square Lake-Grayburg San Andres</b>		Dedicated Acreage: <b>40</b> Acres	

1. Outline the acreage dedicated to the subject well by colored pencil or hachure marks on the plat below.
2. If more than one lease is dedicated to the well, outline each and identify the ownership thereof (both as to working interest and royalty).
3. If more than one lease of different ownership is dedicated to the well, have the interests of all owners been consolidated by communitization, unitization, force-pooling, etc?

☐ Yes    ☐ No    If answer is "yes," type of consolidation \_\_\_\_\_

If answer is "no," list the owners and tract descriptions which have actually been consolidated. (Use reverse side of this form if necessary.) \_\_\_\_\_

No allowable will be assigned to the well until all interests have been consolidated (by communitization, unitization, forced-pooling, or otherwise) or until a non-standard unit, eliminating such interests, has been approved by the Commission.

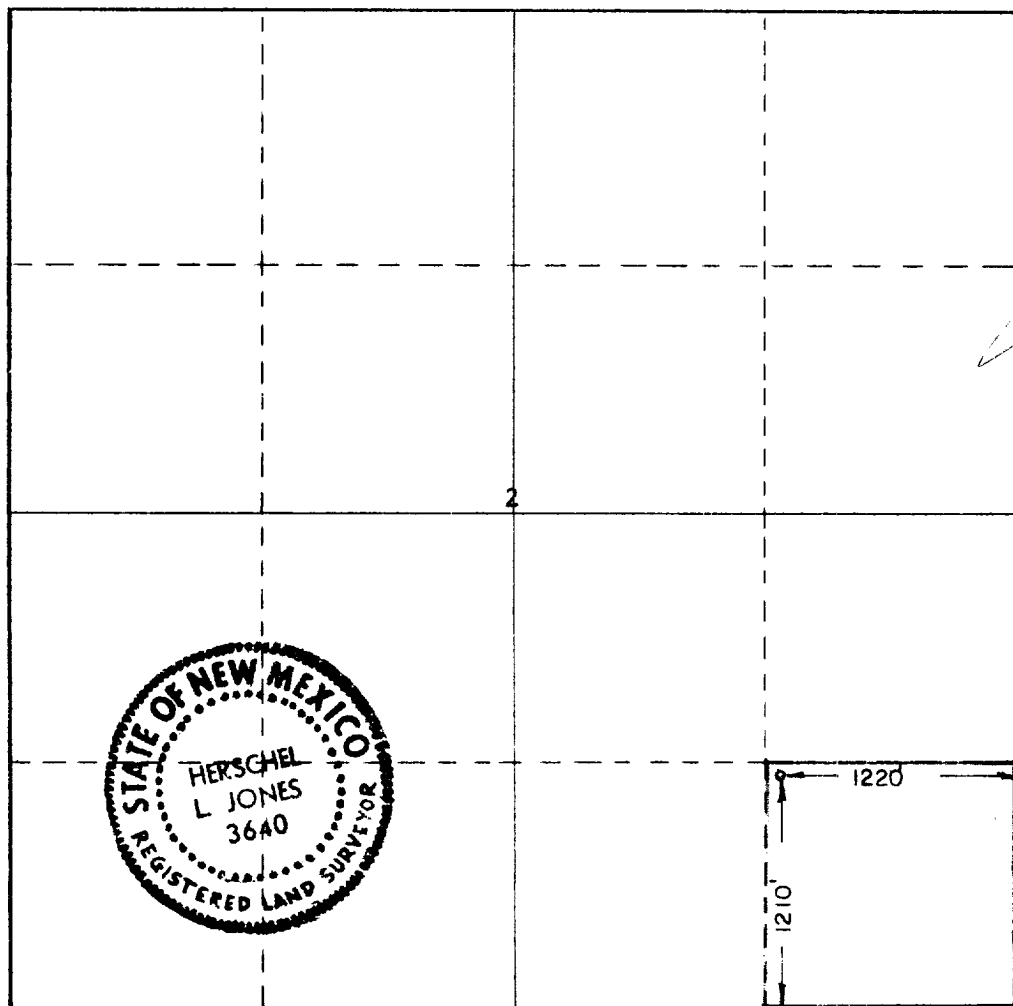

**CERTIFICATION**

I hereby certify that the information contained herein is true and complete to the best of my knowledge and belief.

*[Signature]*  
Name

**Jerry E. Buckles**

Position

**Area Supervisor**

Company

**Anadarko Production Company**

Date

**January 30, 1984**

I hereby certify that the well location shown on this plat was plotted from field notes of actual surveys made by me or under my supervision, and that the same is true and correct to the best of my knowledge and belief.

Date Surveyed

**1/26/84**

Registered Professional Engineer  
and/or Land Surveyor

*[Signature]*  
Certificate No.

**3640**

0 330 660 990 1320 1650 1980 2310 2640 2000 1500 1000 500 0