

NO. OF COPIES RECEIVED	
DISTRIBUTION	
SANTA FE	<input checked="" type="checkbox"/>
FILE	<input checked="" type="checkbox"/>
U.S.G.S.	<input checked="" type="checkbox"/>
LAND OFFICE	<input checked="" type="checkbox"/>
OPERATOR	<input checked="" type="checkbox"/>

NEW MEXICO OIL CONSERVATION COMMISSION

RECEIVED BY

JUN 12 1984

O. C. D.
ARTESIA, OFFICE

Form C-101 30-015-24894
Revised 1-1-85

5A. Indicate Type of Lease
STATE ☒ FEE ☐

5. State Oil & Gas Lease No.

7. Unit Agreement Name

8. Farm or Lease Name

Eddy GR State

9. Well No.

3

10. Field and Pool, or Wildcat

Undersignated Delaware

12. County

Eddy

APPLICATION FOR PERMIT TO DRILL, DEEPEN, OR PLUG BACK

1a. Type of Work

DRILL ☒

DEEPEN ☐

PLUG BACK ☐

b. Type of Well

OIL WELL ☒

GAS WELL ☐

OTHER

SINGLE ZONE ☒

MULTIPLE ZONE ☐

2. Name of Operator

Gulf Oil Corp.

3. Address of Operator

P.O. Box 670 Hobbs NM 88400

4. Location of Well

UNIT LETTER: N LOCATED 670 FEET FROM THE South LINE

AND 1659 FEET FROM THE West LINE OF SEC. 16 TWP. 23 S RGE. 28 E NMPM

19. Proposed Depth

6100

19A. Formation

Delaware

20. Rotary or C.T.

Rotary

21. Elevations (Show whether DF, RT, etc.)

GLE: 3022.7

21A. Kind & Status Plug. Bond

Blanket

21B. Drilling Contractor

not known at this time

22. Approx. Date Work will start

ASAP

23.

PROPOSED CASING AND CEMENT PROGRAM

SIZE OF HOLE	SIZE OF CASING	WEIGHT PER FOOT	SETTING DEPTH	SACKS OF CEMENT	EST. TOP
12 1/4"	8 7/8"	24 #	400	350	circulate
7 7/8"	5 1/2"	15.5 #	6100	1600	circulate

0-400' FW Spud Mud

BOP's will be

400-6100 10 ppg brine water

2000 psi WP w/

blinds, pipes and Annular

APPROVAL VALID FOR 180 DAYS
PERMIT EXPIRES 12-12-84
UNLESS DRILLING UNDERWAY

IN ABOVE SPACE DESCRIBE PROPOSED PROGRAM; IF PROPOSAL IS TO DEEPEN OR PLUG BACK, GIVE DATA ON PRESENT PRODUCTIVE ZONE AND PROPOSED NEW PRODUCTIVE ZONE. GIVE BLOWOUT PREVENTER PROGRAM, IF ANY.

I hereby certify that the information above is true and complete to the best of my knowledge and belief.

Signed

L. C. Under

Title

AREA PROD MGR

Date

6-5-84

(This space for State Use)

APPROVED BY

Mike Walker

TITLE

OIL AND GAS INSPECTOR

DATE

OIL AND GAS INSPECTOR

CONDITIONS OF APPROVAL, IF ANY:

Post-9 88
10-12-84
15-84

NEW MEXICO OIL CONSERVATION COMMISSION
WELL LOCATION AND ACREAGE DEDICATION PLAT

Form C-102
Supersedes C-128
Effective 1-1-65

All distances must be from the outer boundaries of the Section.

Operator GULF OIL CORPORATION			Lease EDDY G R STATE			Well No. 3		
Unit Letter N	Section 16	Township 23 SOUTH	Range 28 EAST	County EDDY				
Actual Footage Location of Well: 670 feet from the SOUTH line and 1659 feet from the WEST line								
Ground Level Elev. 3022.7	Producing Formation Delaware		Pool Under Delaware			Dedicated Acreage: 40 Acres		

1. Outline the acreage dedicated to the subject well by colored pencil or hachure marks on the plat below.
2. If more than one lease is dedicated to the well, outline each and identify the ownership thereof (both as to working interest and royalty).
3. If more than one lease of different ownership is dedicated to the well, have the interests of all owners been consolidated by communitization, unitization, force-pooling, etc?

☐ Yes ☐ No If answer is "yes," type of consolidation _____

If answer is "no," list the owners and tract descriptions which have actually been consolidated. (Use reverse side of this form if necessary.) _____

No allowable will be assigned to the well until all interests have been consolidated (by communitization, unitization, forced-pooling, or otherwise) or until a non-standard unit, eliminating such interests, has been approved by the Commission.

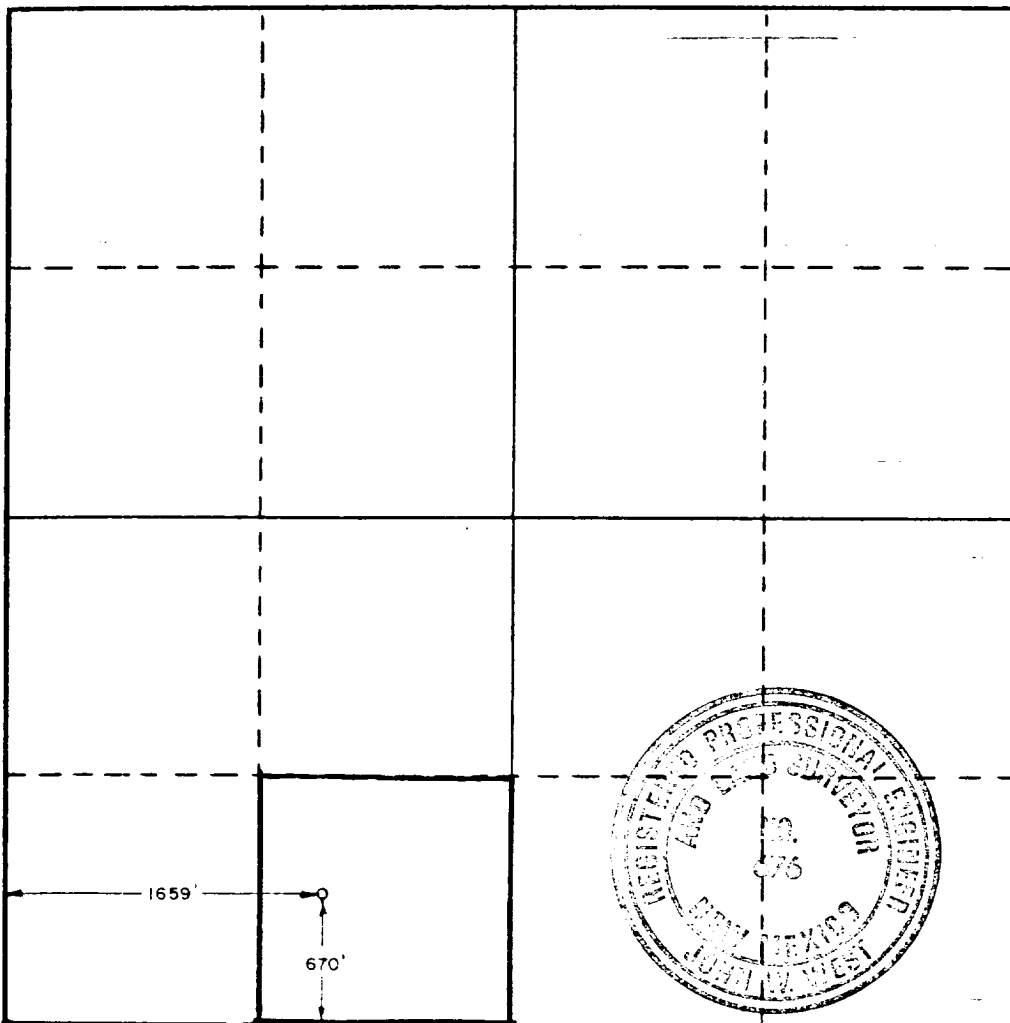

CERTIFICATION

I hereby certify that the information contained herein is true and complete to the best of my knowledge and belief.

R. C. Anderson

Name

R.C. ANDERSON

Position

AREA PROD MGR

Company

GULF OIL CORP

Date

6-5-84

I hereby certify that the well location shown on this plat was plotted from field notes of actual surveys made by me or under my supervision, and that the same is true and correct to the best of my knowledge and belief.

Date Surveyed

JUNE 1, 1984

Registered Professional Engineer and/or Land Surveyor

John W. West

Certificate No. JOHN W. WEST,

676

RONALD J. EIDSON, 3239

0 330 660 990 1320 1650 1980 2310 2640 2000 1800 1600 1400 1200 1000 800

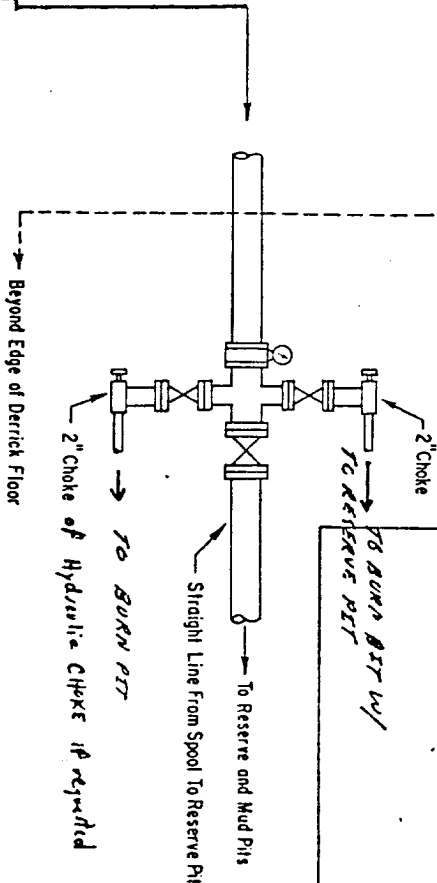
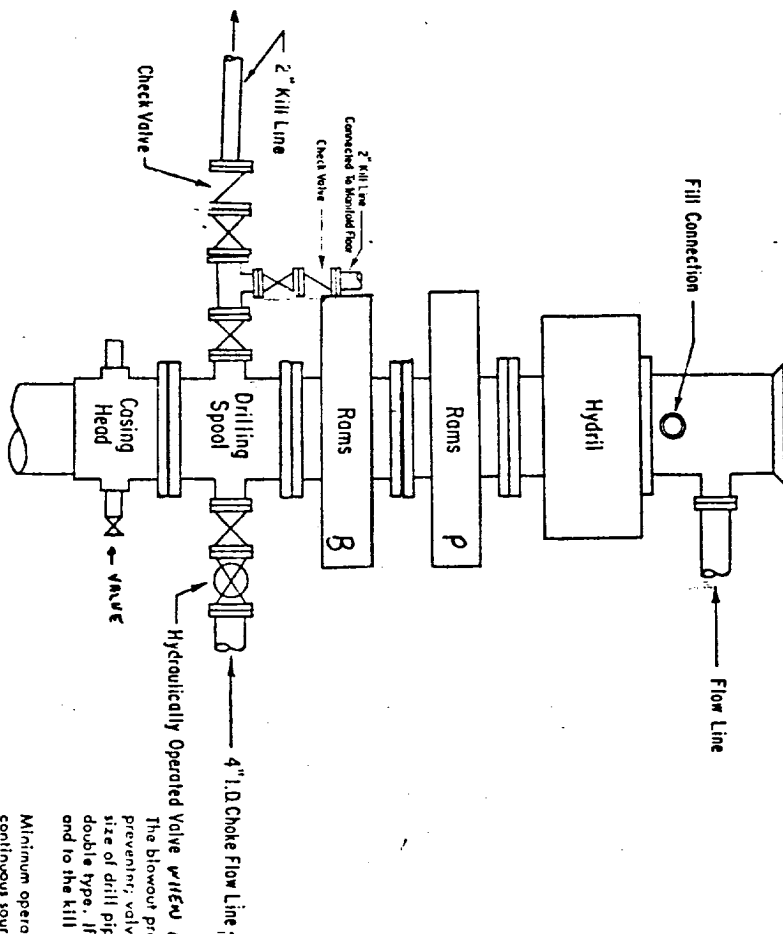

ADDITIONS - DELETIONS - CHANGES
SPECIFY

NOTE: "As per Requested" means at any time the BOP Supervisor can, may, or will require the equipment to be installed during operations.

2000-3000 PSI WORKING PRESSURE BOP HOOK-UP FOR LARGE CASINGS

SPECIFY WORKING PRESSURE

The closing manifold and remote closing manifold shall have a separate control for each pressure-operated device. Controls are to be labeled, with control handles to indicate open and closed positions. A pressure reducer and regulator must be provided for operating the Hydril preventer. When requested, a second pressure reducer shall be available to limit operating fluid pressures to ram preventers. Gulf Legion No. 38 hydraulic oil, or equivalent or better, is to be used as the fluid to operate the hydraulic equipment.

The choke manifold, the choke flow line, the choke lines and the relief lines are to be supported by metal stands and adequately anchored. The choke flow line, relief lines and choke lines shall be constructed as straight as possible and without sharp bends. Easy and safe access shall be maintained to the choke manifold. All valves are to be selected for operation in the presence of oil, gas, and drilling fluids. The choke flow line valves and valves of the relief lines connected to the drilling spool and all ram type preventers must be equipped with stem extensions, universal joints if needed, and hand wheels which are to extend beyond the edge of the derrick substructure. All other valves shall be equipped with handles.

Minimum operating equipment for the preventers and hydraulically operated valves shall be as follows: (1) multiple pumps, driven by a continuous source of power, capable of fluid charging the total accumulator volume from the nitrogen precharge pressure to its rated pressure within 2 minutes. Also, the pumps are to be connected to the hydraulic operating system which is to be a closed system. (2) accumulators with a precharge of nitrogen of not less than 750 PSI and connected so as to receive the aforementioned fluid charge. With the charging pumps shut down, the pressurized fluid volume stored in the accumulators shall be sufficient to close off the pressure-operated devices simultaneously within 1/2 seconds; after closure, the remaining accumulator pressure shall be not less than 1000 PSI with the remaining accumulator fluid volume at least 50 percent of the original. When requested, either an additional source of power, remote and equivalent, is to be available to operate the above pumps, or there shall be additional pumps operated by separate power and equal in performance capabilities.

The blowout preventer assembly shall consist of one blind ram preventer and one pipe ram preventer, both hydraulically operated; a Hydril preventer; valves, chokes and connections, as illustrated. If a tapered drill string is used, a ram preventer shall be provided for each size of drill pipe. Casing and tubing rams to fit the preventers are to be available as needed. The ram preventers may be two singles or a double type. If correct in size, the flanged outlets of the ram preventer may be used for connecting to the 4-inch I.D. choke flow line and to the kill line. The substructure height shall be sufficient to install a rotating blowout preventer.