

RECEIVED BY
BUREAU OF LAND MANAGEMENT

APPLICATION FOR PERMIT TO DRILL, DEEPEN, OR PLUG BACK

1a. TYPE OF WORK

DRILLED

DEEPEN ☐

PLUG BACK ☐

b. TYPE OF WELL ARTESIA, OFFICE

OIL
WELL ☒

GAS
WELL ☐

OTHER ☐

SINGLE
ZONE ☐

MULTIPLE
ZONE ☐

2. NAME OF OPERATOR

J.C. WILLIAMSON

3. ADDRESS OF OPERATOR

P.O. BOX 16 MIDLAND, TEXAS 79702

4. LOCATION OF WELL (Report location clearly and in accordance with any State requirements.)*

At surface

1980' FSL & 1650' FWL

At proposed prod. zone

1980' FSL & 1650' FWL

14. DISTANCE IN MILES AND DIRECTION FROM NEAREST TOWN OR POST OFFICE*

20 miles SW of Malaga, New Mexico

15. DISTANCE FROM PROPOSED*

LOCATION TO NEAREST
PROPERTY OR LEASE LINE, FT.
(Also to nearest drlg. unit line, if any)

660'

16. NO. OF ACRES IN LEASE

320

17. NO. OF ACRES ASSIGNED
TO THIS WELL

40

18. DISTANCE FROM PROPOSED LOCATION*
TO NEAREST WELL, DRILLING, COMPLETED,
OR APPLIED FOR, ON THIS LEASE, FT.

660'

19. PROPOSED DEPTH

7500'

20. ROTARY OR CABLE TOOLS

ROTARY

21. ELEVATIONS (Show whether DF, RT, GR, etc.)

3009.7 GR

22. APPROX. DATE WORK WILL START*

October 15, 1985

23.

PROPOSED CASING AND CEMENTING PROGRAM

SIZE OF HOLE	SIZE OF CASING	WEIGHT PER FOOT	SETTING DEPTH	QUANTITY OF CEMENT
17-1/2"	13-3/8"	54.5#	800'	800sx. to circulate
11"	8-5/8"	24# & 32#	3300'	150sx to tie back to base of
7-7/8"	5-1/2"	15.5#	6800'	1100sx in 2 stages

IN ABOVE SPACE DESCRIBE PROPOSED PROGRAM: If proposal is to deepen or plug back, give data on present productive zone and proposed new productive zone. If proposal is to drill or deepen directionally, give pertinent data on subsurface locations and measured and true vertical depths. Give blowout preventer program, if any.

24.

SIGNED

TITLE

Agent

DATE

July 30, 1985

(This space for Federal or State office use)

PERMIT NO.

APPROVAL DATE

APPROVED BY

TITLE

DATE

CONDITIONS OF APPROVAL, IF ANY:

APPROVAL SUBJECT TO
GENERAL REQUIREMENTS AND
SPECIAL STIPULATIONS

*See Instructions On Reverse Side

MEXICO OIL CONSERVATION COMMISSION
WELL LOCATION AND ACREAGE DEDICATION PLAT

Form C-101
 Supersedes C-128
 Effective 1-1-85

All distances must be from the outer boundaries of the Section

Owner J. C. WILLIAMSON			Lease ROSS DRAV UNIT		Well No. 16
Plot Letter E	Section 26	Township 26 SOUTH	Range 40 EAST	County EDGAR	
Actual Surface Location of Well: 1980 feet from the SOUTH line and 1650 feet from the WEST line					
Ground Level Elev. 3009.7	Producing Formation DELAWARE		Foot UNDESIGNATED DELAWARE		Dedicated Acreage 40 acres

- Outline the acreage dedicated to the subject well by colored pencil or hatchure marks on the plat below.
- If more than one lease is dedicated to the well, outline each and identify the ownership thereof (both as to working interest and royalty).

N/A
- If more than one lease of different ownership is dedicated to the well, have the interests of all owners been consolidated by communitization, unitization, force-pooling, etc?

☐ Yes ☐ No If answer is "yes," type of consolidation _____

If answer is "no," list the owners and tract descriptions which have actually been consolidated (Use reverse side of this form if necessary.) **N/A**

No allowable will be assigned to the well until all interests have been consolidated (by communitization, unitization, forced-pooling, or otherwise) or until a non-standard unit, eliminating such interests, has been approved by the Commission.

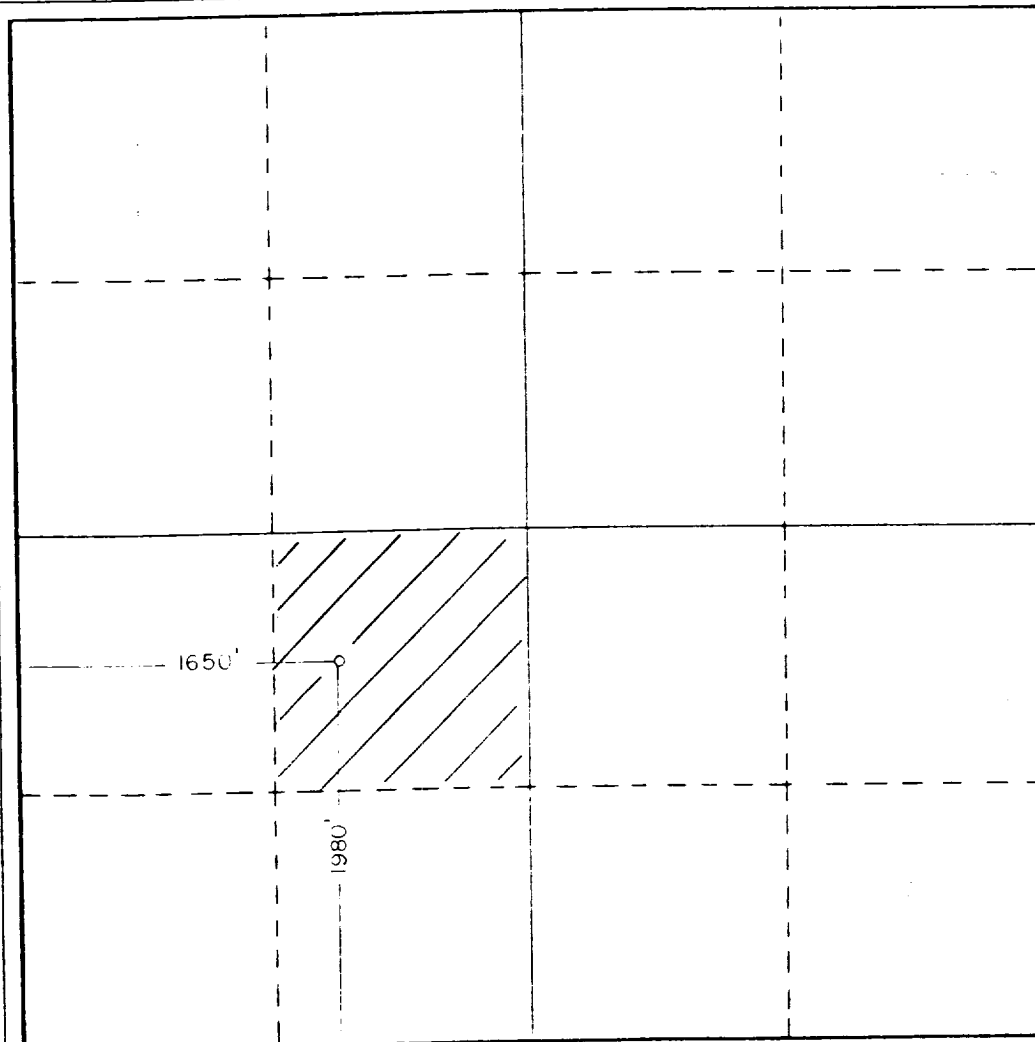

CERTIFICATION

I hereby certify that the information contained herein is true and complete to the best of my knowledge and belief.

[Signature]
 Name

JAN PEISTER

Position

AGENT

Company

J.C. WILLIAMSON

Date

JULY 30, 1985

I hereby certify that the well location shown on this plat was plotted from field notes of actual surveys made by me or under my supervision, and that the same is true and correct to the best of my knowledge and belief.

Date Surveyed

JULY 26, 1985

Registered Professional Engineer and/or Land Surveyor

[Signature]
 Certificate No. **JOHN W. WEST, 676**
RONALD J. EIDSON, 3239

EXHIBIT "E"

BOP Diagram

After 8-5/8" intermediate casing has been set and cement placed around bottom of this pipe, the 13-3/8" casing will be orange peeled into the 8-5/8" casing and then an 11" double ram BOP, as shown below will be put on the hole. This blowout preventer will be connected to a hydraulically controlled closing unit. The pressure rating on this BOP is 3000#, and will have blank and 5-1/2" pipe.

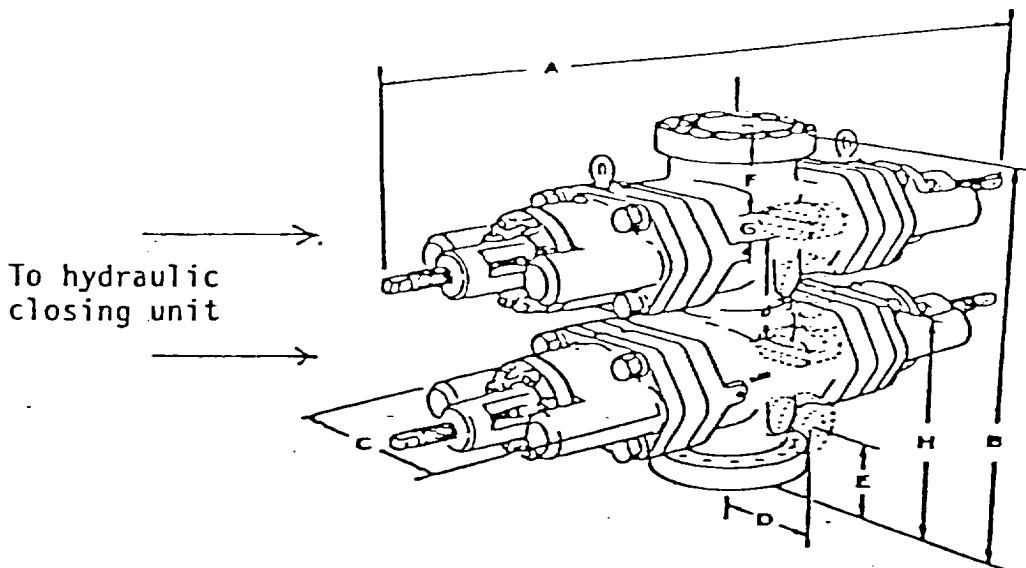

J.C. WILLIAMSON
ROSS DRAW UNIT #16
26-26-30
EDDY COUNTY, NEW MEXICO

SUPPLEMENTAL DRILLING DATA

J.C. WILLIAMSON
WELL ROSS DRAW #16

1. SURFACE FORMATION: Quaternary Alluvium

2. ESTIMATED TOPS OF GEOLOGIC MARKERS:

Rustler Anhydrite	750'
Lamar Shale	3300'
Ramsey Sand	3350'
Olds Sand	3400'
Top Cherry Canyon	4450'
Top Brushy Canyon	5500'

3. ANTICIPATED POSSIBLE WATER AND HYDROCARBON BEARING ZONES:

Fresh Water	above 300'
Delaware (oil)	3300' - 3400'
Brushy Canyon (oil)	5500' - 5800'

4. PROPOSED CASING AND CEMENTING PROGRAM:

Casing program is shown on Form 9-331 C.

Hole for surface casing will be drilled to a depth below fresh water zones. 13-3/8" surface casing will be run to 800 feet, below all fresh water zones and will be cemented to the surface with 800 sacks of Class "C" cement, which is sufficient to circulate cement on this pipe.

8-5/8" casing will be run and cemented at 3300 feet, prior to entering delaware section and will be cemented with 150 sacks of Class "C" cement at 3300 feet, tying same back into salt section.

5-1/2" casing will be run to total depth and will be cemented at a total depth if significant shows are encountered in the Brushy Canyon formation. The second stage of the cement procedure should tie the 5½ casing back into the 8-5/8 intermediate.

5. PRESSURE CONTROL EQUIPMENT:

Pressure control equipment will consist of a 3000# double ram hydraulically controlled blow out preventer and a 3000# choke manifold.

6. CIRCULATING MEDIUM:

The circulating medium will be fresh water down to 800 feet and brine water in the rest of the hole, once the water saturates itself naturally with salt.

7. AUXILARY EQUIPMENT:

Not Applicable.

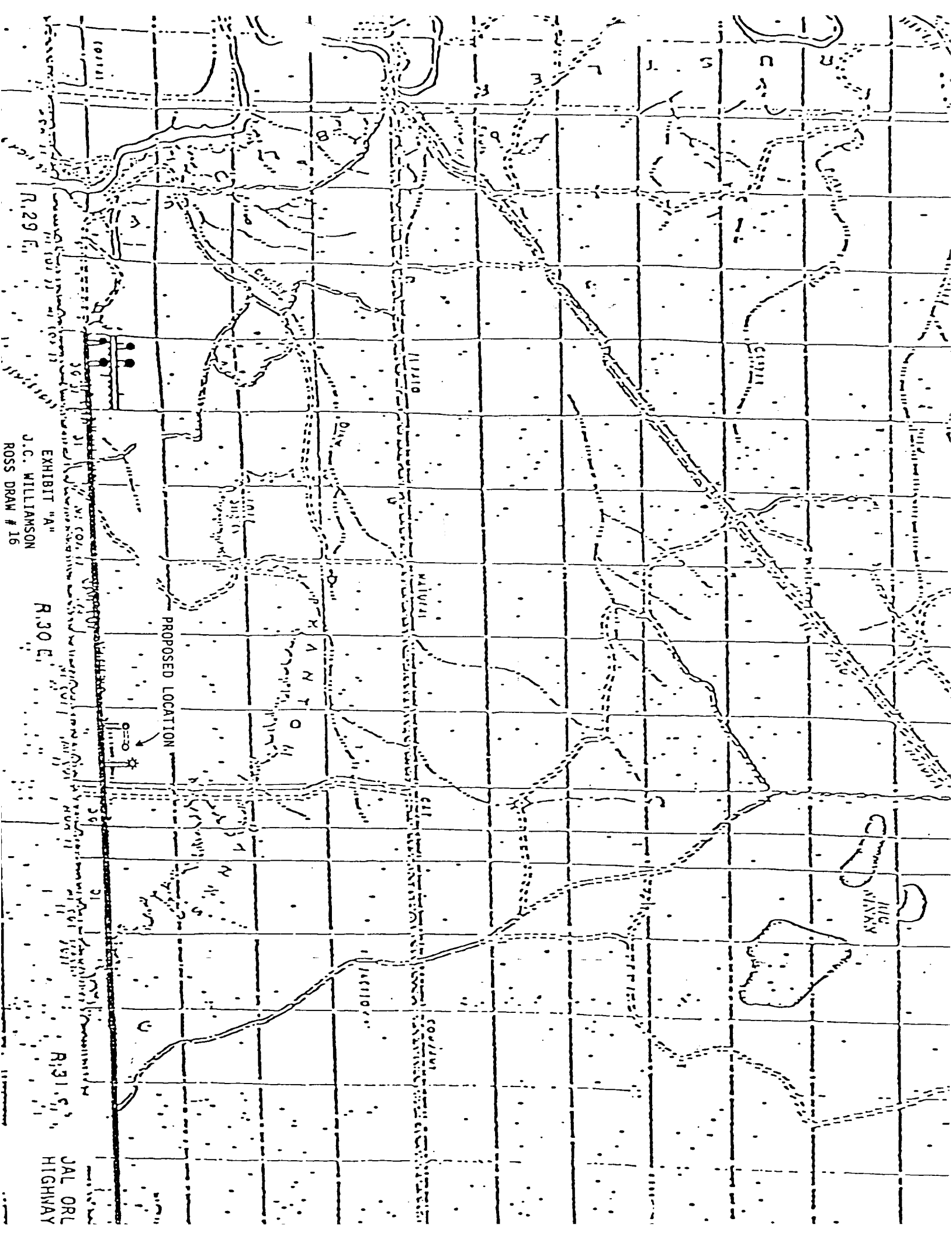

R.29 E.

J.C. WILLIAMSON
ROSS DRAW # 16

R.30 E.

R.31 E.

JAL ORL
HIGHWAY

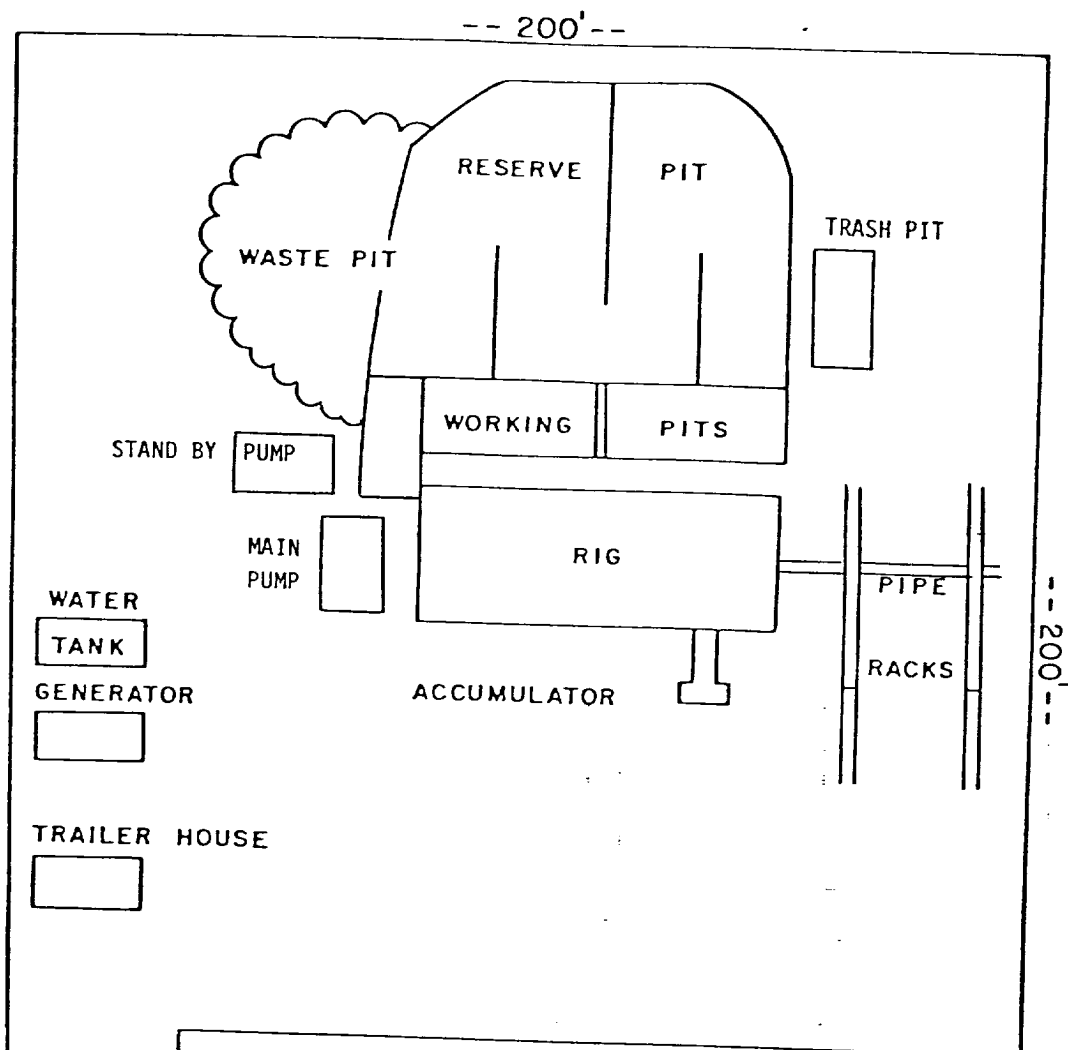

EXHIBIT "D"

J.C. WILLIAMSON
ROSS DRAW UNIT #16