

UNITED STATES
DEPARTMENT OF THE INTERIOR
GEOLOGICAL SURVEYNM 011 (reverse side) MISSION
Artesia, NM 88210

APPLICATION FOR PERMIT TO DRILL, DEEPEN, OR PLUG BACK

1a. TYPE OF WORK DRILL <input checked="" type="checkbox"/> DEEPEN <input type="checkbox"/> PLUG BACK <input type="checkbox"/>			5. LEASE DESIGNATION AND SERIAL NO. NM-06245	
b. TYPE OF WELL OIL WELL <input checked="" type="checkbox"/> GAS WELL <input type="checkbox"/> OTHER <input type="checkbox"/> SINGLE ZONE <input checked="" type="checkbox"/> MULTIPLE ZONE <input type="checkbox"/>			6. IF INDIAN, ALLOTTEE OR TRIBE NAME	
2. NAME OF OPERATOR Ray Westall			7. UNIT AGREEMENT NAME	
3. ADDRESS OF OPERATOR Box 4, Loco Hills, New Mexico 88255			8. FARM OR LEASE NAME Trigg Federal	
4. LOCATION OF WELL (Report location clearly and in accordance with any State requirements.) At surface 2310 FNL & 1650 FWL At proposed prod. zone same			9. WELL NO. 2	
14. DISTANCE IN MILES AND DIRECTION FROM NEAREST TOWN OR POST OFFICE* 7 miles south-west from Loco Hills			10. FIELD AND POOL, OR WILDCAT Shugart-4-SP-B-G	
15. DISTANCE FROM PROPOSED* LOCATION TO NEAREST PROPERTY OR LEASE LINE, FT. (Also to nearest drlg. unit line, if any) 4320 1650			11. SEC., T., R., M., OR BLK. AND SURVEY OR AREA sec. 35-T-18S-R30E	
18. DISTANCE FROM PROPOSED LOCATION* TO NEAREST WELL, DRILLING, COMPLETED, OR APPLIED FOR, ON THIS LEASE, FT. 1320			12. COUNTY OR PARISH 13. STATE Eddy NM	
16. NO. OF ACRES IN LEASE 320			17. NO. OF ACRES ASSIGNED TO THIS WELL 40	
19. PROPOSED DEPTH 3800			20. ROTARY OR CABLE TOOLS rt	
21. ELEVATIONS (Show whether DF, RT, GR, etc.) 3419 gr.			22. APPROX. DATE WORK WILL START* asap	

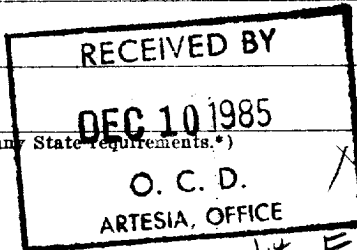

PROPOSED CASING AND CEMENTING PROGRAM

SIZE OF HOLE	SIZE OF CASING	WEIGHT PER FOOT	SETTING DEPTH	QUANTITY OF CEMENT
12 1/4	8 5/8	24	500	circulate
7 7/8	5 1/2	15.5	3800	circulate

We propose to drill and test the Grayburg and intermediate formations. Approx 500 feet of 8 5/8" casing will be set at top of salt and circulated. Fresh water will be used to drill the surface and brine water will be used to drill the production hole 5 1/2" production casing will be run, circulated and perforated for production.

Posted IDI
API-NL
12-20-85

IN ABOVE SPACE DESCRIBE PROPOSED PROGRAM: If proposal is to deepen or plug back, give data on present productive zone and proposed new productive zone. If proposal is to drill or deepen directionally, give pertinent data on subsurface locations and measured and true vertical depths. Give blowout preventer program, if any.

24. SIGNED Ray Westall TITLE Operator DATE 11/5/85
(This space for Federal or State office use)

PERMIT NO. _____ APPROVAL DATE _____

APPROVED BY _____ TITLE _____ DATE _____
CONDITIONS OF APPROVAL, IF ANY:APPROVAL SUBJECT TO
GENERAL REQUIREMENTS AND
SPECIAL STIPULATIONS
ATTACHED

NEW MEXICO OIL CONSERVATION COMMISSION
WELL LOCATION AND ACREAGE DEDICATION PLAT

Form C-102
Supersedes C-128
Effective 1-1-65

All distances must be from the outer boundaries of the Section.

Operator Ray Westall		Lease Trigg Federal		Well No. 2
Unit Letter F	Section 35	Township 18 South	Range 30 East	County Eddy
Actual Footage Location of Well: 2310 feet from the North line and 1650 feet from the West line				
Ground Level Elev. 3419	Producing Formation GCM Bulk	Pool Sugar #	Dedicated Acreage 40	

1. Outline the acreage dedicated to the subject well by colored pencil or hatchure marks on the plat below.
2. If more than one lease is dedicated to the well, outline each and identify the ownership thereof (both as to working interest and royalty).
3. If more than one lease of different ownership is dedicated to the well, have the interests of all owners been consolidated by communitization, unitization, force-pooling, etc?

☐ Yes ☐ No If answer is "yes," type of consolidation _____

If answer is "no," list the owners and tract descriptions which have actually been consolidated. (Use reverse side of this form if necessary.) _____

No allowable will be assigned to the well until all interests have been consolidated (by communitization, unitization, forced-pooling, or otherwise) or until a non-standard unit, eliminating such interests, has been approved by the Commission.

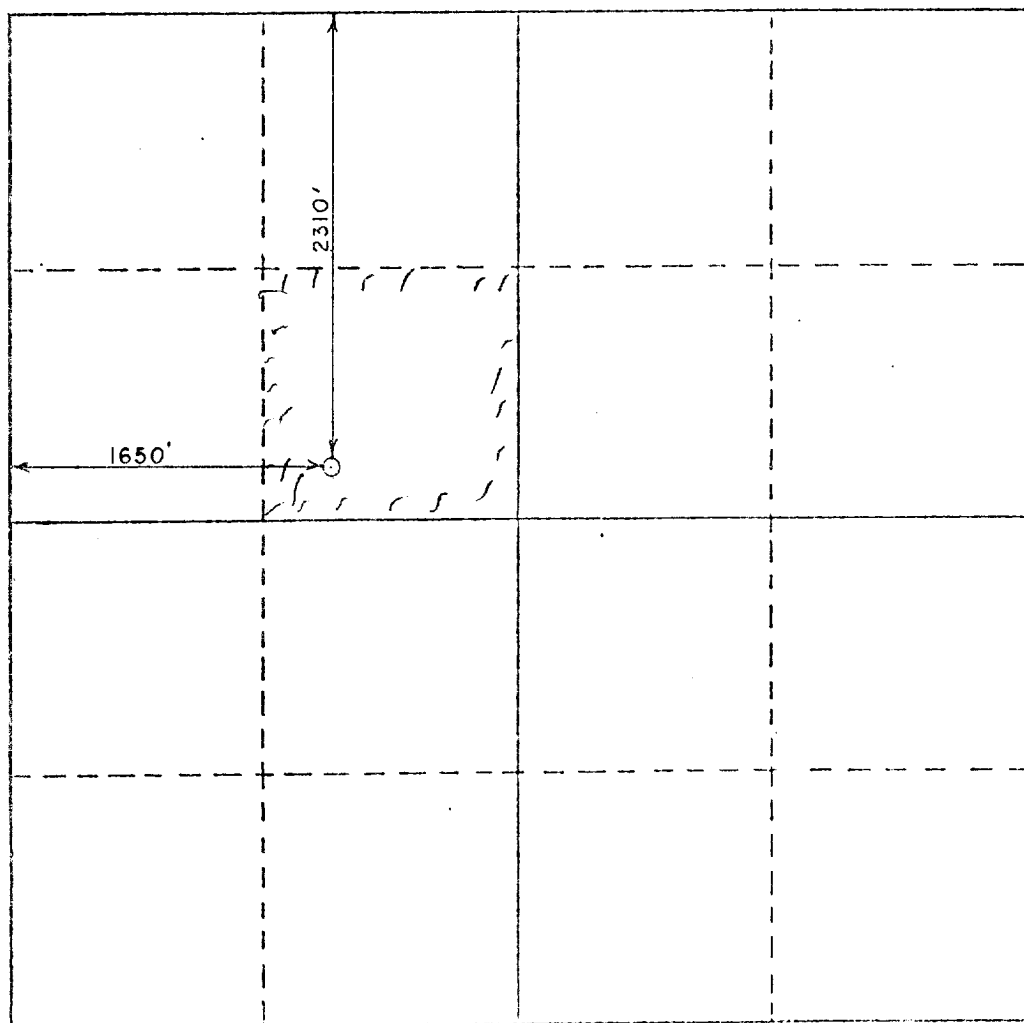

CERTIFICATION

I hereby certify that the information contained herein is true and complete to the best of my knowledge and belief.

Romance L. Harcus

Name

Geologist

Position

Ray Westall

Company

11/5/85

Date

I hereby certify that the well location shown on this plat was plotted from field notes of actual surveys made by me or under my supervision, and that the same is true and correct to the best of my knowledge and belief.

October 29, 1985

Date Surveyed

P. R. Patton

Registered Professional Engineer and/or Land Surveyor

8112

Certificate No.

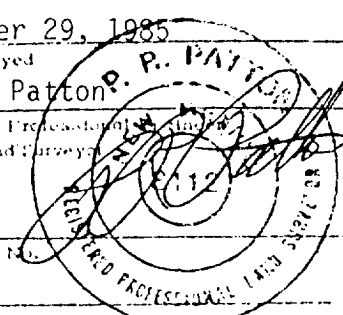

DESIGNATION OF OPERATOR

The undersigned is, on the records of the Bureau of Land Management, holder of lease

DISTRICT LAND OFFICE:

SERIAL No.: NM-06245

and hereby designates

NAME: Ray Westall
ADDRESS: P. O. Box 4
Loco Hills, New Mexico 88255

as his operator and local agent, with full authority to act in his behalf in complying with the terms of the lease and regulations applicable thereto and on whom the supervisor or his representative may serve written or oral instructions in securing compliance with the Operating Regulations with respect to (describe acreage to which this designation is applicable):

Township 18 South, Range 30 East, N.M.P.M.

Section 35: E $\frac{1}{2}$ NW $\frac{1}{4}$, SW $\frac{1}{2}$ NW $\frac{1}{4}$ and SW $\frac{1}{4}$ for
depths from the surface down to 4,500 feet
below the surface. Lea County, New Mexico.

It is understood that this designation of operator does not relieve the lessee of responsibility for compliance with the terms of the lease and the Operating Regulations. It is also understood that this designation of operator does not constitute an assignment of any interest in the lease.

In case of default on the part of the designated operator, the lessee will make full and prompt compliance with all regulations, lease terms, or orders of the Secretary of the Interior or his representative.

The lessee agrees promptly to notify the supervisor of any change in the designated operator.

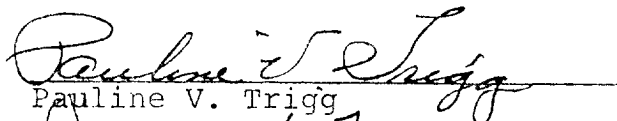
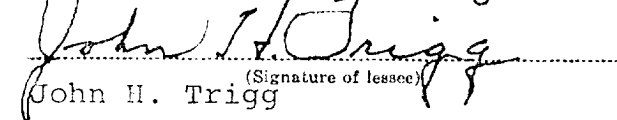

Pauline V. Trigg

John H. Trigg (Signature of lessee)

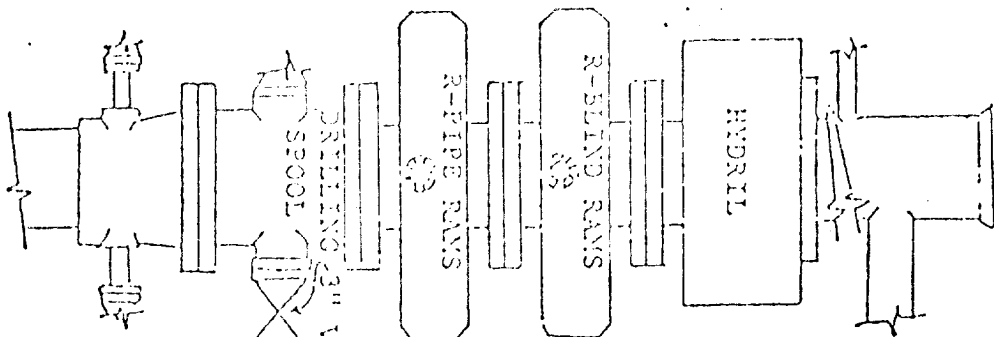
May 3, 1985
(Date)

201 East Hobbs, Roswell, NM 88201
(Address)

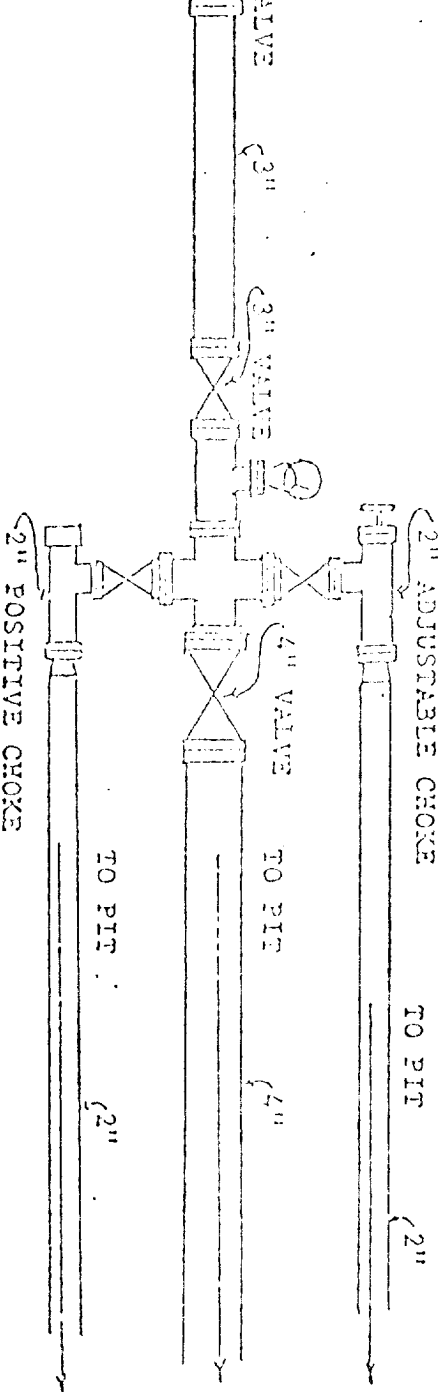

BLOW OUT PREVENTION EQUIPMENT
 10" 900s ALL FLANGED CONNECTIONS
 3,000# WORKING PRESSURE - 6,000# TEST



ATTACHMENT TO FORM C-101