

30-015-25564

RECEIVED BY
FEB 17 1986
O. C. D.
ARTESIA OFFICE

NEW MEXICO OIL CONSERVATION COMMISSION
RECEIVED BY
FEB 04 1986
O. C. D.
ARTESIA OFFICE

Form C-101
Revised 1-4-85

NO. OF COPIES RECEIVED	
DISTRIBUTION	
SANTA FE	<input checked="" type="checkbox"/>
FILE	<input checked="" type="checkbox"/>
U.S.G.S.	<input checked="" type="checkbox"/>
LAND OFFICE	<input checked="" type="checkbox"/>
OPERATOR	<input checked="" type="checkbox"/>

5A. Indicate Type of Lease
STATE FEE

5. State Oil & Gas Lease No.
V-1295

APPLICATION FOR PERMIT TO DRILL, DEEPEN, OR PLUG BACK

1a. Type of Work
b. Type of Well
DRILL DEEPEN PLUG BACK
OIL WELL GAS WELL OTHER
SINGLE ZONE MULTIPLE ZONE

2. Name of Operator
Southland Royalty Company

3. Address of Operator
21 Desta Drive, Midland, Texas 79705

4. Location of Well
UNIT LETTER E LOCATED 1980 FEET FROM THE North LINE
AND 660 FEET FROM THE West LINE OF SEC. 26 TWP. 19S RSE. 28E NMPM

7. Unit Agreement Name

8. Name of Lease
Remington "26" St Com

9. Well No.
1

10. Field and Pool, or Wildcat
Winchester (Morrow)

12. County
Eddy

19. Proposed Depth
11,400'

19A. Formation
Morrow

20. Rotary or C.T.
Rotary

21. Elevations (Show whether DF, RT, etc.)
3339.3' GR

21A. Kind & Status Plug. Bond

21B. Drilling Contractor

22. Approx. Date Work will start
2-14-86

PROPOSED CASING AND CEMENT PROGRAM

SIZE OF HOLE	SIZE OF CASING	WEIGHT PER FOOT	SETTING DEPTH	SACKS OF CEMENT	EST. TOP
17 1/2"	13 3/8"	48#	400'	400 sx.	Circulate
11"	8 5/8"	24#	2700'	1100 sx.	Circulate
7 7/8"	5 1/2"	17#	11,400'	1000 sx.	TOC by TS

Drill 17 1/2" hole to 400'. Set 13 3/8" csg @ 400'. Cmt w/400 sx. Circ to surface. Drill 11" hole to 2700'. Set 8 5/8" csg @ 2700'. Cmt w/1100 sx. Circulate to surface. Drill to TD. Set 5 1/2" csg @ 11,400'. Cmt w/sufficient volume to cover all prospective zones. Estimated top of cmt @ 7000'. Perf & stimulate Morrow for production.

MUD PROGRAM: 0-400' spud mud; 400-2700' brine water' 2700-10,000' cut brine; 10,000-TD cut brine, Drispac, X-C polymer. MW 9.2-9.4, VIS 32-36, 6-10 cc. BHP @ TD anticipated to be 4000 psi. No abnormal pressures expected.

BOP PROGRAM: BOP to be tested after each new installation & after setting 8 5/8" csg by Yellow Jacket, Inc. Install gas separator pit monitors and flow sensor @ 8000'.

RECEIVED BY
MAY 20 1986
FOR 180 DAYS
A-20-86
UNDERWAY

IN ABOVE SPACE DESCRIBE PROPOSED PROGRAM: IF PROPOSAL IS TO DEEPEN OR PLUG BACK, GIVE DATA ON PRESENT PRODUCTIVE ZONE AND PROPOSED NEW PRODUCTIVE ZONE, GIVE BLOWOUT PREVENTER PROGRAM, IF ANY.

I hereby certify that the information above is true and complete to the best of my knowledge and belief.

Signed Frank Roberts Title Drilling Engineer Date 1/30/86

(This space for State Use)

Original Signed By
Mike Williams
Oil & Gas Inspector

APPROVED BY _____ DATE FEB 20 1986
CONDITIONS OF APPROVAL, IF ANY: _____

**NEW MEXICO OIL CONSERVATION COMMISSION
WELL LOCATION AND ACREAGE DEDICATION PLAT**

Form C-102
Supersedes C-128
Effective 1-1-65

All distances must be from the outer boundaries of the Section.

Operator SOUTHLAND ROYALTY COMPANY		Lease REMINGTON 26 STATE COM.		Well No. 1
Unit Letter E	Section 26	Township 19 SOUTH	Range 28 EAST	County EDDY
Actual Footage Location of Well: 1980 feet from the NORTH line and 660 feet from the WEST line				
Ground Level Elev. 3339.3'	Producing Formation Morrow	Pool Winchester	Dedicated Acreage: 320 Acres	

1. Outline the acreage dedicated to the subject well by colored pencil or hachure marks on the plat below.
2. If more than one lease is dedicated to the well, outline each and identify the ownership thereof (both as to working interest and royalty).
3. If more than one lease of different ownership is dedicated to the well, have the interests of all owners been consolidated by communitization, unitization, force-pooling, etc?

Yes No If answer is "yes," type of consolidation Communitized

If answer is "no," list the owners and tract descriptions which have actually been consolidated. (Use reverse side of this form if necessary.) _____

No allowable will be assigned to the well until all interests have been consolidated (by communitization, unitization, forced-pooling, or otherwise) or until a non-standard unit, eliminating such interests, has been approved by the Commission.

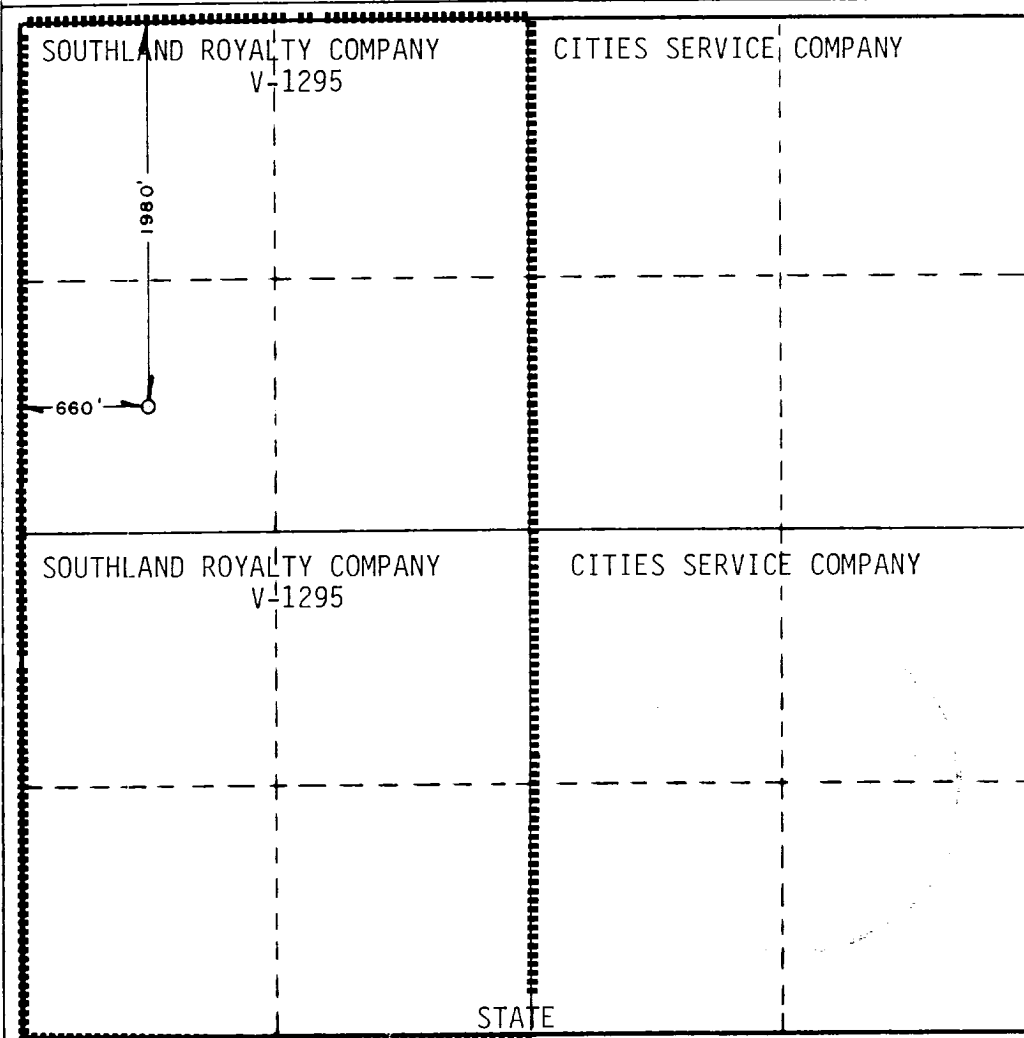

CERTIFICATION

I hereby certify that the information contained herein is true and complete to the best of my knowledge and belief.

Darrell Roberts
Name

Darrell Roberts

Position

Drilling Engineer

Company

Southland Royalty Company

Date

1-30-86

I hereby certify that the well location shown on this plat was plotted from field notes of actual surveys made by me or under my supervision, and that the same is true and correct to the best of my knowledge and belief.

Date Surveyed

JANUARY 24, 1986

Registered Professional Engineer and/or Land Surveyor

John W. West

Certificate No. JOHN W. WEST, 676

RONALD J. EIDSON, 3239