

UNITED STATES
DEPARTMENT OF THE INTERIOR
BUREAU OF LAND MANAGEMENT

SUBMIT IN TRIPLICATE
(Other instructions on reverse side)

30-015-25710
C/SF
Form approved.
Budget Bureau No. 1004-0136
Expires August 31, 1985

APPLICATION FOR PERMIT TO DRILL, DEEPEN, OR PLUG BACK

1a. TYPE OF WORK

DRILL ☒

DEEPEN ☐

PLUG BACK ☐

b. TYPE OF WELL

OIL WELL ☒

GAS WELL ☐

OTHER

SINGLE ZONE ☒

MULTIPLE ZONE ☐

2. NAME OF OPERATOR

Mobil Producing TX. & N.M. Inc.

3. ADDRESS OF OPERATOR

P. O. Box 633, Midland, Texas 79702, Attn: Lorraine Maroney

4. LOCATION OF WELL (Report location clearly and in accordance with any State requirements.)

At surface 772' FSL, 760' FEL

At proposed prod. zone Same

JAN - 2 1987

14. DISTANCE IN MILES AND DIRECTION FROM NEAREST TOWN OR POST OFFICE*

8.5 miles northeast from Carlsbad, New Mexico, OFFICE

15. DISTANCE FROM PROPOSED LOCATION TO NEAREST PROPERTY OR LEASE LINE, FT. (Also to nearest drlg. unit line, if any)

760' to east line
None

18. DISTANCE FROM PROPOSED LOCATION TO NEAREST WELL, DRILLING, COMPLETED, OR APPLIED FOR, ON THIS LEASE, FT. #15 @ 1375'

21. ELEVATIONS (Show whether DF, RT, GR, etc.)

3190' FR

5. LEASE DESIGNATION AND SERIAL NO.

NM-17095

6. IF INDIAN, ALLOTTEE OR TRIBE NAME

7. UNIT AGREEMENT NAME

8. FARM OR LEASE NAME

Government "D"

9. WELL NO.

17

10. FIELD AND POOL, OR WILDCAT

Undesignated Delaware

11. SEC., T., R., M., OR BLK. AND SURVEY OR AREA

Sec. 1, T-21-S, R-27-E

12. COUNTY OR PARISH

Eddy

13. STATE

New Mexico

PROPOSED CASING AND CEMENTING PROGRAM

SIZE OF HOLE	SIZE OF CASING	WEIGHT PER FOOT	SETTING DEPTH	QUANTITY OF CEMENT
17-1/2"	13-3/8"	48.00#	0 - 500'	Redi-Mix to surface
12-1/4"	10-3/4"	40.50#	0 - 1450'	425 CIRCULATE TLW & Class C
9-7/8"	7-5/8"	24.00#	1250 - 2450'	608.76 cu ft Class C
6-3/4"	5-1/2"	14.00#	2250 - 3200'	553.58 cu ft Class C
			or TD	

Casing Detail:

13-3/8" csg to be cmt'd to surface W/Redi-Mix

10-3/4" csg to be cmt'd to surface W/ 233 sx TLW and 100 sx Class C cmt

7-5/8" csg to be cmt'd W/TOC @ 1050' using 342 sx Class C cmt

5-1/2" csg to be cmt'd W/TOC @ 2050' using 311 sx Class C cmt

BOP Program:

Casing	Size	Depth	BOP Size	Min. ARR	Choke Rating	Rating
Surface	13-3/8"	500'	13-3/8"	SRRG	3000	3000
Inter.	10-3/4"	1450'	11"	SRRAG	3000	3000

IN ABOVE SPACE DESCRIBE PROPOSED PROGRAM: If proposal is to deepen or plug back, give data on present productive zone and proposed new productive zone. If proposal is to drill or deepen directionally, give pertinent data on subsurface locations and measured and true vertical depths. Give blowout preventer program, if any.

24.

SIGNED Lorraine Maroney TITLE M. E. Sweeney DATE 12-19-86
Env. & Reg. Manager

(This space for Federal or State office use)

PERMIT NO. 015-25710 Charles S. Delmon

APPROVAL DATE

APPROVED BY Area Manager

TITLE

DATE

12-31-86

CONDITIONS OF APPROVAL, IF ANY:

APPROVAL SUBJECT TO
GENERAL REQUIREMENTS AND
SPECIAL STIPULATIONS

*See Instructions On Reverse Side

Title 18 U.S.C. Section 1001, makes it a crime for any person knowingly and willfully to make to any department or agency of the United States any false, fictitious or fraudulent statements or representations as to any matter within its jurisdiction.

JIL CONSERVATION DIVISIO

STATE OF NEW MEXICO
ENERGY AND MINERALS DEPARTMENTP. O. BOX 2088
SANTA FE, NEW MEXICO 87501Form C-102
Revised 10-1-78

All distances must be from the outer boundaries of the Section.

Operator MOBIL PRODUCING TEXAS & NEW MEXICO INC.		Lease GOVERNMENT "D" LEASE		Well No. 17
Unit Letter X	Section 1	Township 21-S	Range 27-E	County EDDY
Actual Footage Location of Wells 772 feet from the SOUTH line and 760 feet from the EAST line				
Ground Level Elev. 3190	Producing Formation Delaware	Pool Undesignated	Dedicated Acreage 40 Acres	

1. Outline the acreage dedicated to the subject well by colored pencil or hatchure marks on the plat below.
2. If more than one lease is dedicated to the well, outline each and identify the ownership hereof (both as to working interest and royalty).
3. If more than one lease of different ownership is dedicated to the well, have the interests of all owners been consolidated by communitization, unitization, force-pooling, etc?

☐ Yes ☐ No If answer is "yes," type of consolidation _____

If answer is "no," list the owners and tract descriptions which have actually been consolidated. (Use reverse side of this form if necessary.) _____

No allowable will be assigned to the well until all interests have been consolidated (by communitization, unitization, forced-pooling, or otherwise) or until a non-standard unit, eliminating such interests, has been approved by the Division.

CERTIFICATION

I hereby certify that the information contained herein is true and complete to the best of my knowledge and belief.

Lerrain Sweeney
Name *for*
M. E. Sweeney
Position
Environmental & Reg. Manager
Company
Mobil Producing TX. & N.M. Inc.
Date
December 19, 1986

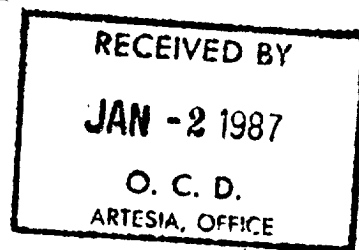

MOBIL PRODUCING TX. & N.M. INC.

LEASE: Government "D"

WELL: 17

FIELD: Undesignated-Delaware

COUNTY: Eddy

STATE: New Mexico

TEN POINT WELL CONTROL & RESOURCE PROTECTION DATA

1. The geologic name of the surface formation Quaternary

2. The estimated tops of important geologic markers.

<u>Formation Name</u>	<u>Depth (Top)</u>
<u>Capitan Reef</u>	<u>1300'</u>
<u>Delaware</u>	<u>2800'</u>
<u> </u>	<u> </u>
<u> </u>	<u> </u>

3. The estimated depth at which anticipated water, oil, gas or other mineral-bearing formations are expected to be encountered.

<u>Formation Name</u>	<u>Depth (Top)</u>	<u>Type of Mineral</u>
<u>Capitan Reef</u>	<u>1300'</u>	<u>Water</u>
<u>Delaware</u>	<u>2800'</u>	<u>Oil/Gas</u>
<u> </u>	<u> </u>	<u> </u>
<u> </u>	<u> </u>	<u> </u>

4. The proposed casing program, including the size, grade, and weight-per-foot of each string and whether new or used. (Shown on Form 3160-3).

5. The lessee's or operator's minimum specifications for pressure control equipment which is to be used, a schematic diagram thereof showing sizes, pressure ratings (or API series), and the testing procedures and testing frequency. (See attachment Form 3160-3).

6. The type and characteristics of the proposed circulating medium or mediums to be employed for rotary drilling and the quantities and types of mud and weighting material to be maintained.

<u>Depth Ft.</u>	<u>Type</u>	<u>Weight</u>	<u>Viscosity</u>	<u>Water Loss</u>
<u>0-500</u>	<u>Spud</u>	<u>8.8 - 9.4</u>	<u>34 - 40</u>	<u>NC</u>
<u>0-1450</u>	<u>BW</u>	<u>9.8 - 10.0</u>	<u>29</u>	<u>NC</u>
<u>1450-2450</u>	<u>FW</u>	<u>8.4 - 8.8</u>	<u>28 - 32</u>	<u>NC</u>
<u>2450-TD</u>	<u>FW-Gel</u>	<u>8.6 - 9.2</u>	<u>30 - 38</u>	<u>20</u>

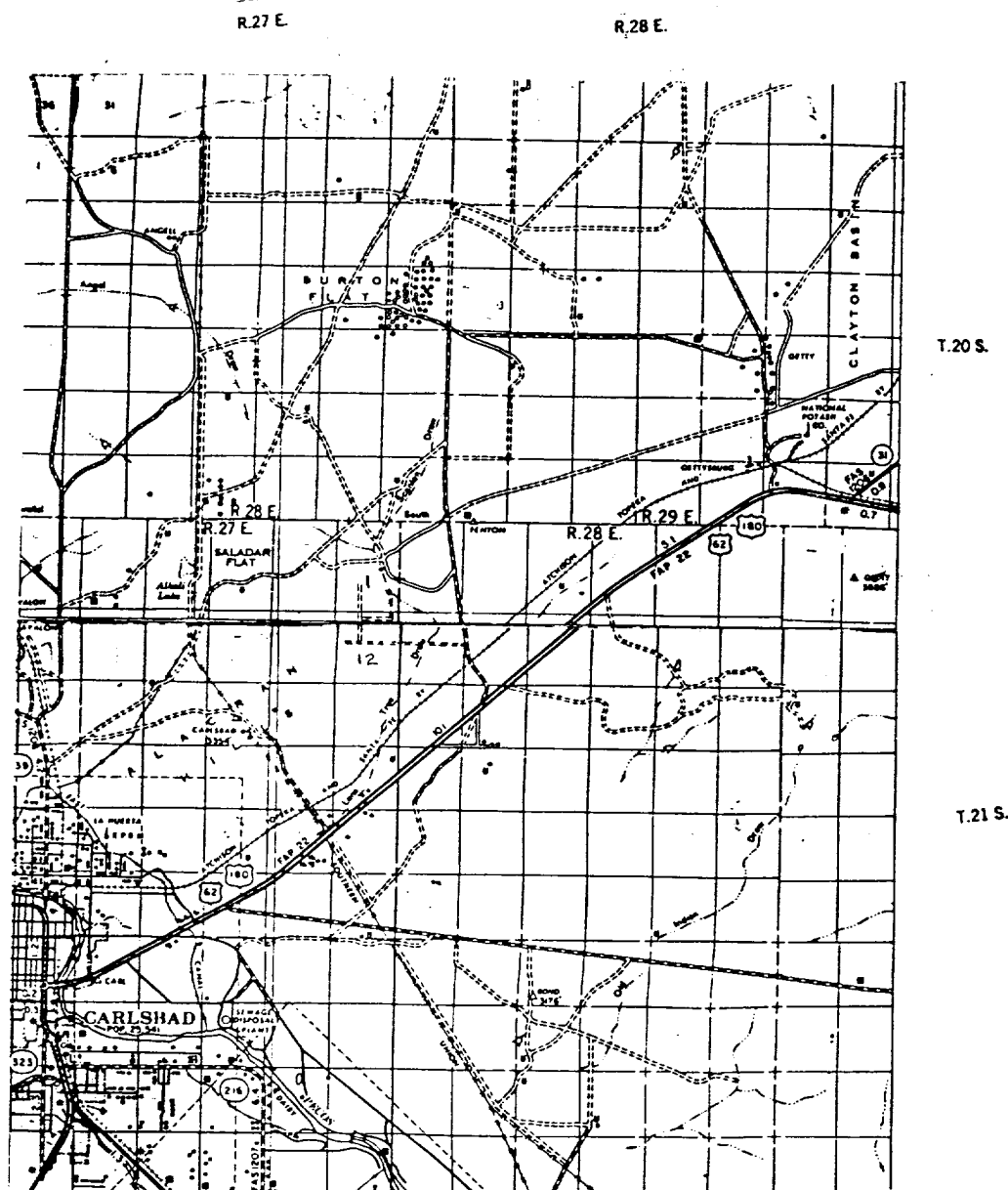

Scale $\frac{1}{250000}$ or 1 Inch = 3 Miles
 0 1 2 3 4
 STATUTE MILES

Mobil Producing Texas & New Mexico Inc.

Area Map Government "D" Lease
 Sections 1+12 T-21-S R-27-E
 Eddy County, New Mexico

DRAWN G.E.W.	SCALE 1"=3 miles
CHECKED	DATE 5-13-85
APPROVED	REVISED

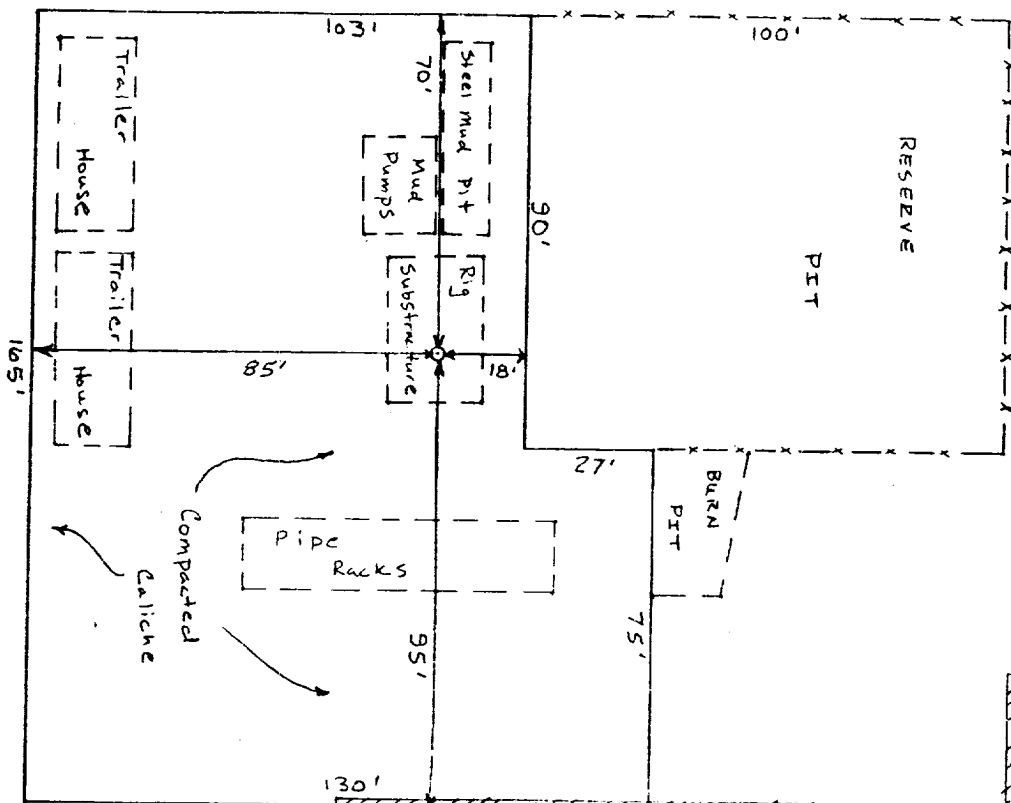

Well #13
EXISTING CALICHE PAD

Mobil Producing Texas & New Mexico Inc.

LOCATION LAYOUT MAP
GOVERNMENT "D" LOCATION #17
SECTION 1 T-21-S R-27-E
EDDY COUNTY, NEW MEXICO

DRAWN GEW	SCALE 1"=40'
CHECKED	DATE 7-1-96
APPROVED	REVISED