

RECEIVED  
CALIFORNIA  
AREA 44 1988

**RECEIVED**

DEC 05 '88

O. C. D.  
ARTESIA, OFFICE

State of New York  
J. J. Van Zandt  
Governor, at Albany

— *Journal of the American Medical Association*, 1997

2-100, to a depth of 5,000 feet the Colymar formation is the oil-bearing zone, is hereby attested and attested by stipulations officer to the application.

Two copies of this application is returned immediately. Please notify the Bureau of Land Management office closest to the site as soon as possible, in sufficient time for a representative to witness and document operations.

approval of this application does not warrant or certify that the applicant holds a full and equitable title to these rights in the subject lands which would entitle the applicant to conduct operations thereon.

— *Journal of the American Medical Association*, 1967, 201: 1009.

WILLIAM F. GERRY, Jr.  
Director

1. ENCLOSURE

cc:  
✓ REOCD - Artesia - 2  
IR (0667) - 2  
IR (0665) - 1

UNITED STATES  
DEPARTMENT OF THE INTERIOR  
BUREAU OF LAND MANAGEMENT

APPLICATION FOR PERMIT TO DRILL, DEEPEN, OR PLUG BACK

1a. TYPE OF WORK

DRILL ☒

DEEPEN ☐

PLUG BACK ☐

b. TYPE OF WELL

OIL  
WELL ☒

GAS  
WELL ☐

OTHER

SINGLE  
ZONE ☒

MULTIPLE  
ZONE ☐

2. NAME OF OPERATOR

Siete Oil & Gas Corporation

3. ADDRESS OF OPERATOR

P.O. Box 2523

Roswell, NM 88202-2523

4. LOCATION OF WELL (Report location clearly and in accordance with any State requirements.\*  
At surface

990' FSL & 660' FWL, SW $\frac{1}{4}$ SW $\frac{1}{4}$ , Unit Letter M

At proposed prod. zone

Same

14. DISTANCE IN MILES AND DIRECTION FROM NEAREST TOWN OR POST OFFICE\*

17 miles Northeast of Carlsbad, New Mexico

15. DISTANCE FROM PROPOSED\*

LOCATION TO NEAREST

PROPERTY OR LEASE LINE, FT.

(Also to nearest drlg. unit line, if any)

660'

16. NO. OF ACRES IN LEASE

1320

17. NO. OF ACRES ASSIGNED  
TO THIS WELL

40

18. DISTANCE FROM PROPOSED LOCATION\*

TO NEAREST WELL, DRILLING, COMPLETED,

OR APPLIED FOR, ON THIS LEASE, FT.

1320'

19. PROPOSED DEPTH

6000'

20. ROTARY OR CABLE TOOLS

Rotary

21. ELEVATIONS (Show whether DF, RT, GR, etc.)

3325' GR

22. APPROX. DATE WORK WILL START\*

ASAP

23. PROPOSED CASING AND CEMENTING PROGRAM

SIZE OF HOLE	SIZE OF CASING	WEIGHT PER FOOT	SETTING DEPTH	QUANTITY OF CEMENT
17 $\frac{1}{2}$ "	13 $\frac{3}{8}$ "	54.0#	350'	500 sks. <u>circ.</u>
12 $\frac{1}{2}$ "	8 $\frac{5}{8}$ "	24.0#	2500'	1200 sks. <u>circ.</u>
7 $\frac{7}{8}$ "	5 $\frac{1}{2}$ "	17.0#	6000'	1500 sks.

Selectively perforate and treat pay zones.

Attachments:

Survey plat (C-102)

Supplemental drilling data

Surface use plan

POST ID-1  
NL & API  
12-9-88

IN ABOVE SPACE DESCRIBE PROPOSED PROGRAM: If proposal is to deepen or plug back, give data on present productive zone and proposed new productive zone. If proposal is to drill or deepen directionally, give pertinent data on subsurface locations and measured and true vertical depths. Give blowout preventer program, if any.

24

SIGNED

*Laurel A. Johnston*

TITLE

V.P. Drilling/Production

DATE

11/01/88

(This space for Federal or State office use)

PERMIT NO.

APPROVAL DATE

APPROVED BY

TITLE

DATE

CONDITIONS OF APPROVAL, IF ANY:

\*See Instructions On Reverse Side

NEW MEXICO OIL CONSERVATION COMMISSION  
WELL LOCATION AND ACREAGE DEDICATION PLAT

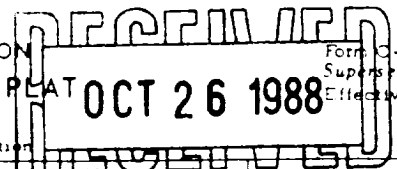

Form C-102  
Supersedes C-128  
Effective 1-1-85

All distances must be from the outer boundaries of the Section

Operator <b>SIETE OIL &amp; GAS CORPORATION</b>			Lease <b>Osage Federal</b>		Well No. <b>6</b>
Tract Letter <b>M</b>	Section <b>35</b>	Township <b>19 South</b>	Range <b>29 East</b>	County <b>Eddy County, N.M.</b>	
Actual Surface Location of Well:					
<b>660</b>	feet from the	<b>West</b>	line and	<b>990</b>	feet from the <b>South</b> line
Ground Level Elev. <b>3325.</b>	Producing Formation <b>Delaware</b>		Parkway Delaware		Dedicated Acreage <b>40</b>

1. Outline the acreage dedicated to the subject well by colored pencil or hatchure marks on the plat below.
2. If more than one lease is dedicated to the well, outline each and identify the ownership thereof (both as to working interest and royalty).
3. If more than one lease of different ownership is dedicated to the well, have the interests of all owners been consolidated by communitization, unitization, force-pooling, etc?

☐ Yes ☐ No If answer is "yes," type of consolidation \_\_\_\_\_

If answer is "no," list the owners and tract descriptions which have actually been consolidated. (Use reverse side of this form if necessary.) \_\_\_\_\_

No allowable will be assigned to the well until all interests have been consolidated (by communitization, unitization, forced-pooling, or otherwise) or until a non-standard unit, eliminating such interests, has been approved by the Commission.

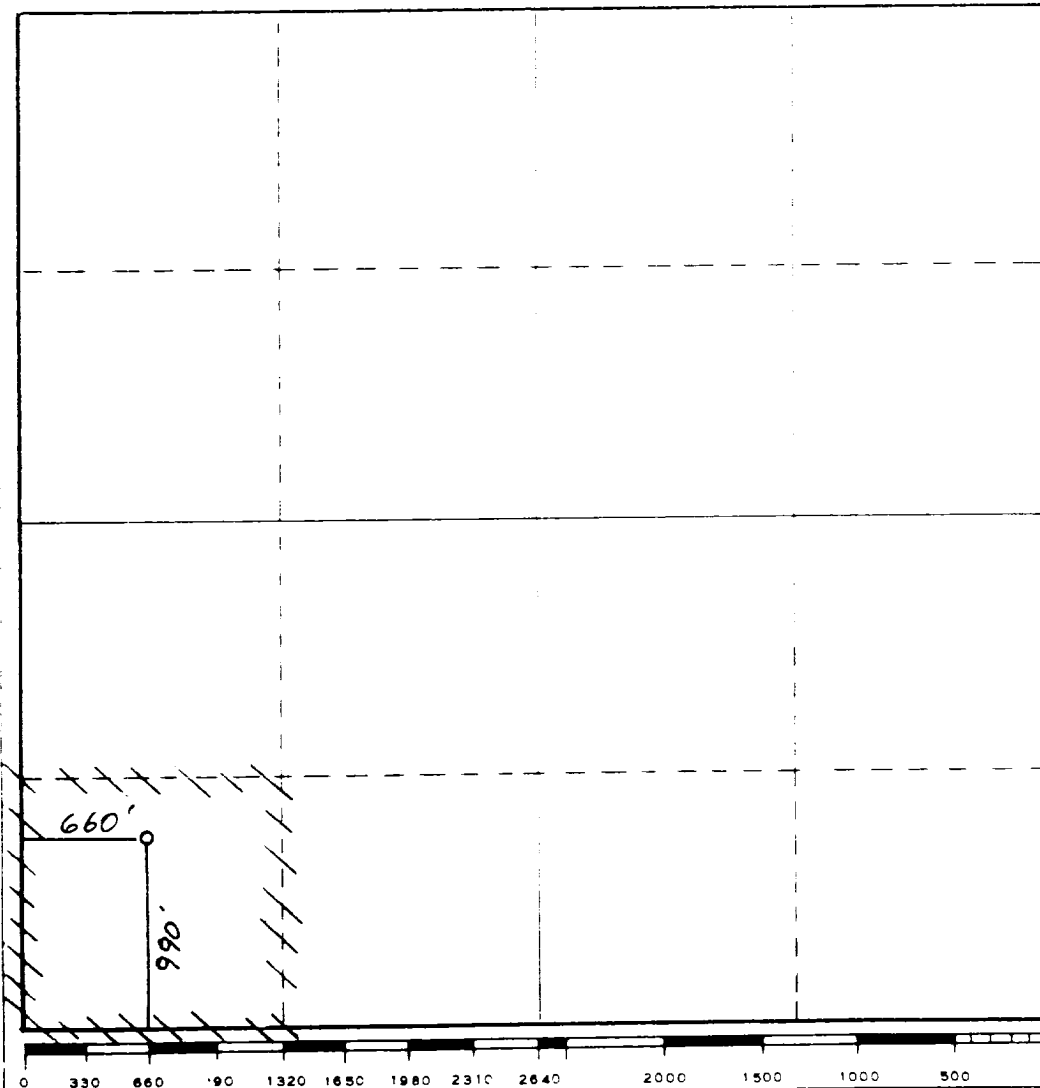

CERTIFICATION

I hereby certify that the information contained herein is true and complete to the best of my knowledge and belief.

*Harold D. Justice*

Harold D. Justice

V.P. Drilling/Production

Siete Oil & Gas Corporation

November 2, 1988

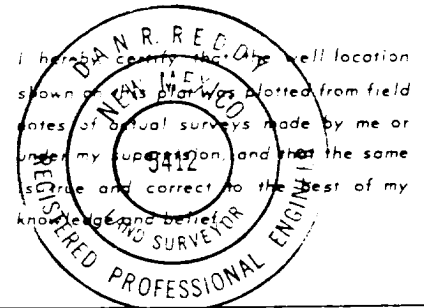

Date Surveyed

October 24, 1988

Registered Professional Engineer  
and/or Land Surveyor

*Dan R. Reedy*

Certificate No.

NM PE&LS NO. 5412

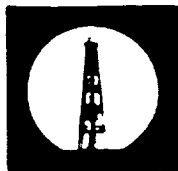

# SIETE OIL & GAS CORPORATION

Petroleum Building Suite 200  
P.O. Box 2523 Roswell, New Mexico 88202  
Telephone (505) 622-2202

May 31, 1988

Amax Chemical Corporation  
Minesite  
Carlsbad, NM 88220

Re: Notice of Intent to Drill  
Township 19 South, Range 29 East, NMPM  
Section 35: SW $\frac{1}{4}$ , W $\frac{1}{2}$ SE $\frac{1}{4}$   
Eddy County, New Mexico

Gentlemen:

In a conversation this morning with Lundeburg, we were notified that Amax Chemical was the operator of the Potash lease on State of New Mexico lands in the above described area. We have been notified by the Bureau of Land Management that the above location lies within a restricted potash area under which you have ongoing operations. Pursuant to potash stipulations referred to in NMOCD R-111-A, we are hereby giving you notice of our intent to drill at a location within the SW $\frac{1}{4}$ , W $\frac{1}{2}$ SE $\frac{1}{4}$  Section 35, T-19-S, R-29-E, Eddy County, New Mexico.

The test well would be drilled to a depth of 6200' to adequately test the Delaware formation, which if completed as a producer, would be classified as an oil well. The test well is located at a legal location on the above described property.

Pursuant to such regulations, we would respectfully request that you respond favorably to us within 10 days. For your convenience we have added at the end of this letter an approval for execution by an officer of your company. You may execute one copy and return it to us, keeping the other copy for your records. For your information we have under separate letter notified Lundeburg Ind. of our intent to drill in the area.

If you have any questions in regard to this matter, please do not hesitate to call.

Very truly yours,

SIETE OIL & GAS CORPORATION

  
GENE SHUMATE  
Vice President Land

The undersigned has no objections and approves the request by Siete Oil & Gas Corporation to drill an oil well to a depth of approximately 6200 feet at a legal location within the property referenced above.

AMAX CHEMICAL CORPORATION

June 2, 1988  
Date

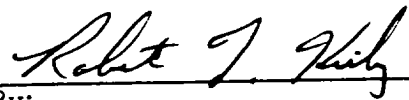
  
By: CHIEF MINE ENGINEER



# SIETE OIL & GAS CORPORATION

Petroleum Building Suite 200  
P.O. Box 2523 Roswell, New Mexico 88202  
Telephone (505) 622-2202

May 31, 1988

Lundeburg Ind.  
P. O. Box 31  
Carlsbad, NM 88220

Attention: Mr. Bob Krul

Re: Notice of Intent to Drill  
Township 19 South, Range 29 East, NMPM  
Section 35: SW $\frac{1}{4}$ , W $\frac{1}{2}$ SE $\frac{1}{4}$   
Eddy County, New Mexico

Dear Mr. Krul:

As per our conversation this morning, we have been notified by the Bureau of Land Management that the above location lies within a restricted potash area under which you have a lease on adjoining lands. Pursuant to potash stipulations referred to in NMOCD R-111-A, we are hereby giving you notice of our intent to drill at a location within the SW $\frac{1}{4}$ , W $\frac{1}{2}$ SE $\frac{1}{4}$  Section 35, T-19-S, R-29-E, Eddy County, New Mexico.

The test well would be drilled to a depth of 6200' to adequately test the Delaware formation, which if completed as a producer, would be classified as an oil well. The test well is located at a legal location on the above described property.

Pursuant to such regulations, we would respectfully request that you respond favorably to us within 10 days. For your convenience we have added at the end of this letter an approval for execution by an officer of your company. You may execute one copy and return it to us, keeping the other copy for your records.

If you have any questions in regard to this matter, please do not hesitate to call.

Very truly yours,

SIETE OIL & GAS CORPORATION

  
GENE SHUMATE  
Vice President Land

The undersigned has no objections and approves the request by Siete Oil & Gas Corporation to drill an oil well to a depth of approximately 6200 feet at a legal location within the property referenced above.

LUNDEBURG IND.

6-2-88  
Date

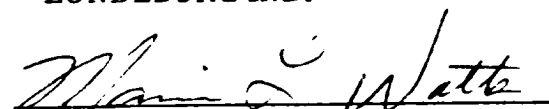
  
By: Marvin L. Watts

**BOP DIAGRAM**

**RATED 30001**

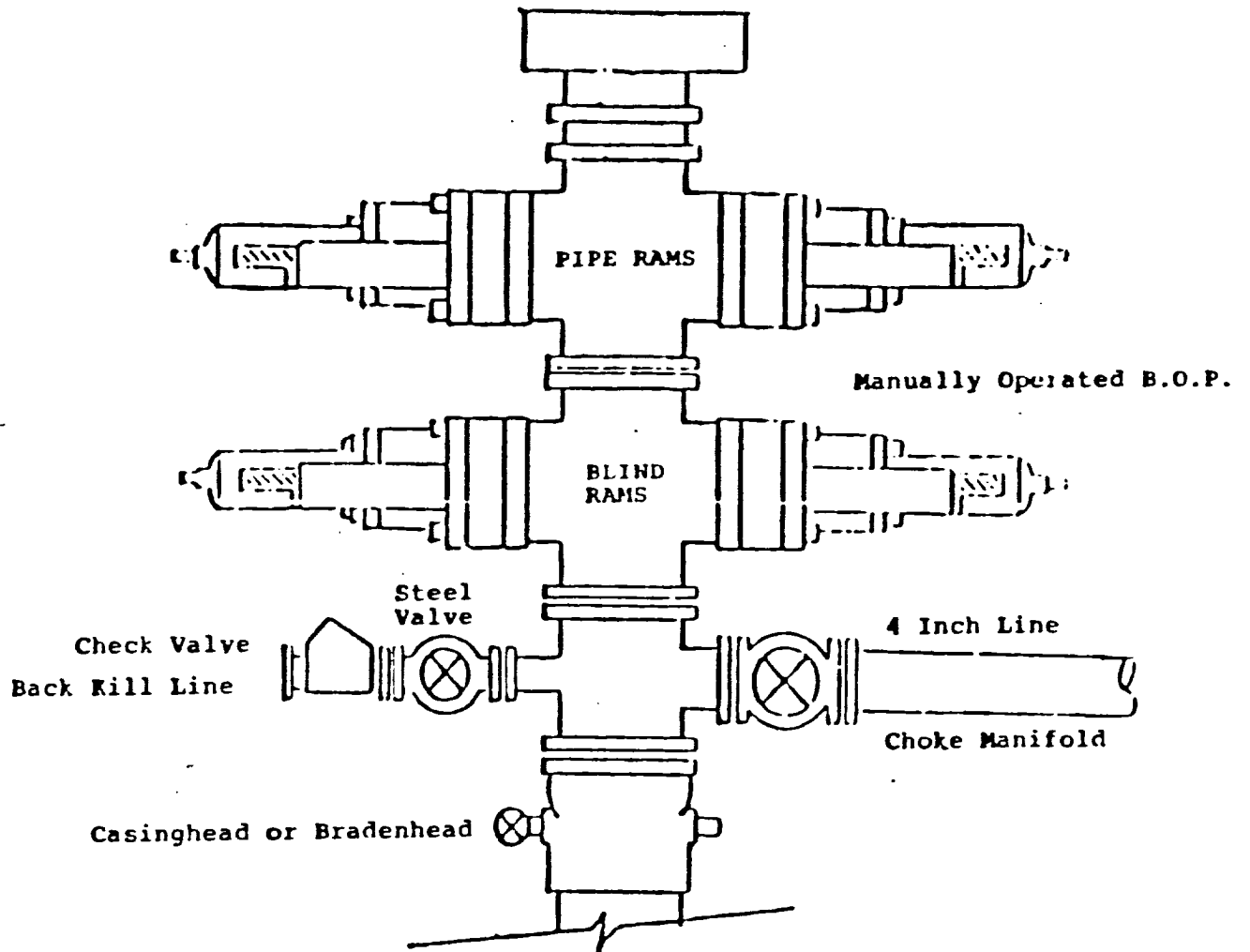

SUPPLEMENTAL DRILLING DATA  
SIETE OIL AND GAS CORPORATION  
OSAGE FEDERAL NO. 6  
990' FSL & 660' FWL  
Section 35: T19S, R29E  
Eddy County, New Mexico  
Lease Number: NM-24160

The following items supplement "Onshore Oil and Gas Order No. 1":

1. The geologic surface is quaternary.
2. The estimated geological marker tops:

B/Salt	1300'
Queen	2500'
T/Del.	3200'
T/Bone Spring	5800'

3. Estimated depths to water, oil or gas:

Water: Approximately 220'  
Oil or Gas: 3300' - 6000'

4. Proposed casing program:

<u>Size</u>	<u>Interval</u>	<u>Weight</u>	<u>Grade</u>	<u>Joint</u>	<u>New or Used</u>
13 3/8"	0 - 350'	54.5#	J-55	ST&C	New
8 5/8"	0 - 2500'	24 & 32#	J-55	ST&C	New
5 1/2"	0 - T.D.'	15.5#	J-55	ST&C	New

5. Pressure Control Equipment: The blowout preventer will be a double ram type preventer. A sketch is attached.
6. Mud Program:  
0-350': Native mud adding gel and lime for sufficient viscosity to insure clean hole for running casing.  
350' - 2500': Drill out with native becoming brine.  
2500' - T.D.: Drill out of intermediate with a cut brine system to T.D.
7. Auxiliary Equipment: A kelly cock will be installed on the rig floor while drilling operations are in progress.
8. Testing, Logging and Coring Programs: Possible drill stem tests and/or coring is not planned.  
Logging: Compensated Neutron - Formation Density - Gamma Ray - Caliper Dual Laterolog - RXO.
9. No abnormal pressures or temperature zones are anticipated.
10. Anticipated starting date: Commence drilling operations ASAP.

**SURFACE USE PLAN  
FOR  
DRILLING, COMPLETING AND PRODUCING**

**SIETE OIL AND GAS CORPORATION  
Osage Federal No. 6  
990' FSL & 660' FWL  
Section 35: T19S, R29E  
Eddy County, New Mexico  
Lease Number: NM-24160**

LOCATED: 17.0 miles Northeast of Carlsbad, New Mexico

FEDERAL LEASE NUMBER: NM-24160

LEASE ISSUED: February 1, 1975

RECORD LESSEE: Conoco, Inc.

BOND COVERAGE: \$25,000 Bond of Siete Oil and Gas Operator

ACRES IN LEASE: 1320

SURFACE OWNERSHIP: Federal

CRAZING PERMITTEE: Snyder Ranches  
c/o Larry Squires  
P.O. Box 726  
Lovington, NM 88260  
Telephone: 393-7544

POOL: Undesignated Parkway Delaware

EXHIBITS:

- A. Area Road Map
- B. Topographic Map Showing Access Route
- C. Lease Map Showing Well Tests
- D. Sketch of Well Pad



ROAD LOG TO PROPOSED DRILLSITE

Starting point being Pecos River Bridge - Carlsbad, New Mexico on Highway 62-180:

- 0.0      Proceed East-Northeast on Highway 62-180 for 13.5 miles.
- 13.50    Turn North (4/10 mile past mile marker 49) on County Road 238 and proceed North for 2.1 miles (end of County Road North).
- 15.60    Proceed North off County Road (Conoco - Tuesday Federal Sign) and proceed 4.1 miles.
- 19.70    Turn East and proceed 1/2 mile.
- 20.20    Turn South and proceed for 2/10 mile.
- 20.40    Location.

## THIRTEEN POINT PROGRAM

### 1. EXISTING ROADS:

- A. Existing roads, which lead to the proposed drillsite, are shown on Exhibits "A" & "B".

### 2. PROPOSED NEW ROAD:

- A. The new access road will be 14' wide by approximately 950' in length. New access road will enter the Northwest corner of the well pad as displayed on Exhibit "B".
- B. Surfacing Materials: Caliche
- C. Maximum Grade: Less than 1%
- D. Turnouts: None required
- E. Drainage Design: None required
- F. Culverts: None required
- G. Cuts and Fills: Less than 3'
- H. Gates, Cattleguards: None required

### 3. LOCATION OF EXISTING WELLS:

- A. Existing wells are shown on Exhibit "C".

### 4. LOCATION OF EXISTING AND/OR PROPOSED FACILITIES:

- A. If the well is productive, we will construct a flowline parallel to the access road to a tank battery located at the Osage Federal No. 1 (NW $\frac{1}{4}$ SE $\frac{1}{4}$ ).

### 5. LOCATION AND TYPE OF WATER SUPPLY:

- A. A water supply well is not planned. Water will be purchased and hauled to the well site over existing and proposed roads.

### 6. SOURCE OF CONSTRUCTION MATERIALS

- A. Construction material will be obtained from an existing federal pit in the SW $\frac{1}{4}$ NE $\frac{1}{4}$  of Section 3: T20S, R29E.

### 7. METHODS OF HANDLING WASTE DISPOSAL:

- A. Drill cuttings will be disposed of in the drilling pits.
- B. Drilling fluids will be allowed to evaporate in the drilling pits until the pits are dry.
- C. Water produced during tests will be disposed of in the drilling pits.
- D. Oil produced during tests will be produced into temporary test tanks.

- E. Trash, waste paper, garbage and junk will be buried in a trash pit and covered with a minimum of 24" of dirt. All waste material will be contained to prevent scattering by the wind. Location of the trash pit is shown on Exhibit "D".

8. ANCILLARY FACILITIES:

- A. None anticipated.

9. WELLSITE LAYOUT:

- A. The drill site has been surveyed, staked and flagged.
- B. The dimensions and relative location of the drill pad, mud pits and the trash pits with respect to the wellbore are shown on Exhibit "D".
- C. The wellsite is nearly level and will not require any cut or fill. The drill pad will be surfaced with caliche.

10. PLANS FOR RESTORATION OF THE SURFACE:

- A. After completion of drilling and/or completion operations, all equipment and other materials not needed for operations will be removed. Pits will be filled and the location cleansed of all trash and junk to leave the wellsite in an aesthetically pleasing condition as possible.
- B. Any unguarded pits containing fluids will be fenced until they are filled.
- C. After abandonment, all equipment, trash and junk will be removed and the location cleaned. Any special rehabilitation and/or special revegetation requirements of the surface management agency will be complied with and accomplished as expeditiously as possible.

11. OTHER INFORMATION:

- A. Topography: The surface is relatively flat. Drainage to the Southwest.
- B. Soil: Kermit Berino fine sands.
- C. Flora and Fauna: Vicinity surrounding the drillsite is semi-arid desert rangeland. Vegetation is thinly scattered with desert shrubs interspersed with a small amount of native grasses. No wildlife was observed, rodents, coyotes, dove or quail.
- D. Ponds and Streams: None
- E. Residences and other Structures: A ranch house is located approximately 2 1/2 miles Northeast of location.
- F. Archaeological, Historical and Other Cultural Sites: None were observed in this area. The pad area was archaeologized on October 24, 1988.
- G. Land Use: Grazing and occasional hunting.

12. OPERATOR'S REPRESENTATIVE:

Representative responsible for assuring compliance with the approved Surface Use Plan:

Harold D. Justice  
Petroleum Building, Suite 200  
200 West First  
Roswell, New Mexico 88202  
Office: 622-2202  
Home: 625-0072

13. CERTIFICATION:

I hereby certify that I, or persons under my supervision have inspected the proposed drillsite and access road; that I am familiar with the conditions which presently exist; that the statements made in this plan are, to the best of my knowledge true and correct; and that the work associated with operations proposed herein will be performed by SIETE OIL AND GAS CORPORATION, and its subcontractors in conformity with this plan and the terms and conditions under which it is approved.

SIETE OIL AND GAS CORPORATION

Date: 4/02/88

BY: Harold D. Justice  
Harold D. Justice  
V.P. Drilling & Production



Exhibit 'A'  
Siete Oil & Gas Corporation  
Osage Federal No. 6  
990' FSL & 660' FWL  
Sec. 35, T19S, R29E  
Eddy County, N.M.

ILLINOIS CAM  
NEW ME  
7.5 MINUTE SER

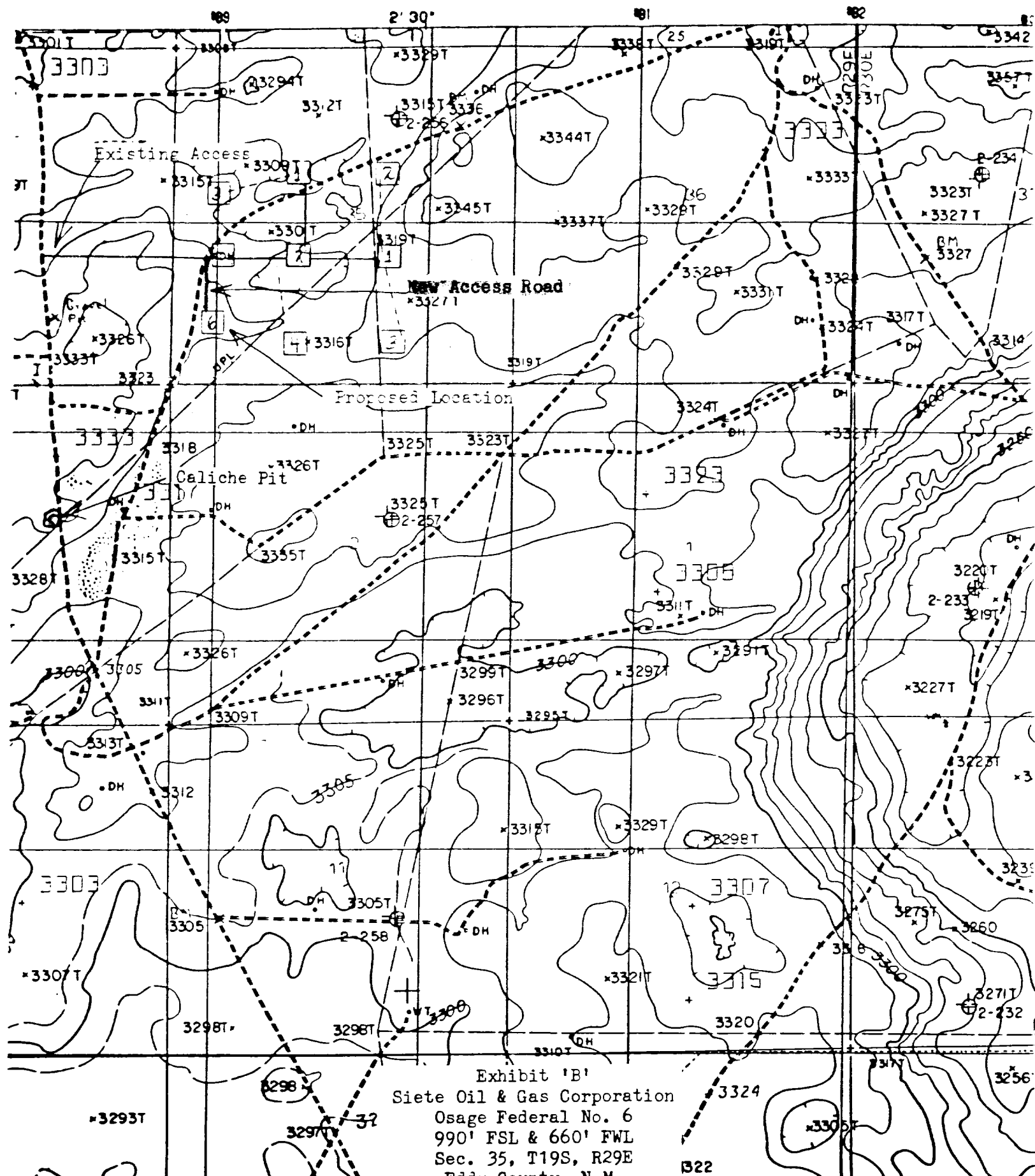

1

1000

31

2

Mr. O'Connell  
6

--	--

100

Siete Oil & Gas Corporation  
Osage Federal No. 6  
990' FSL & 660' FWL  
Sec. 35, T19S, R29E  
Eddy County, N.M.

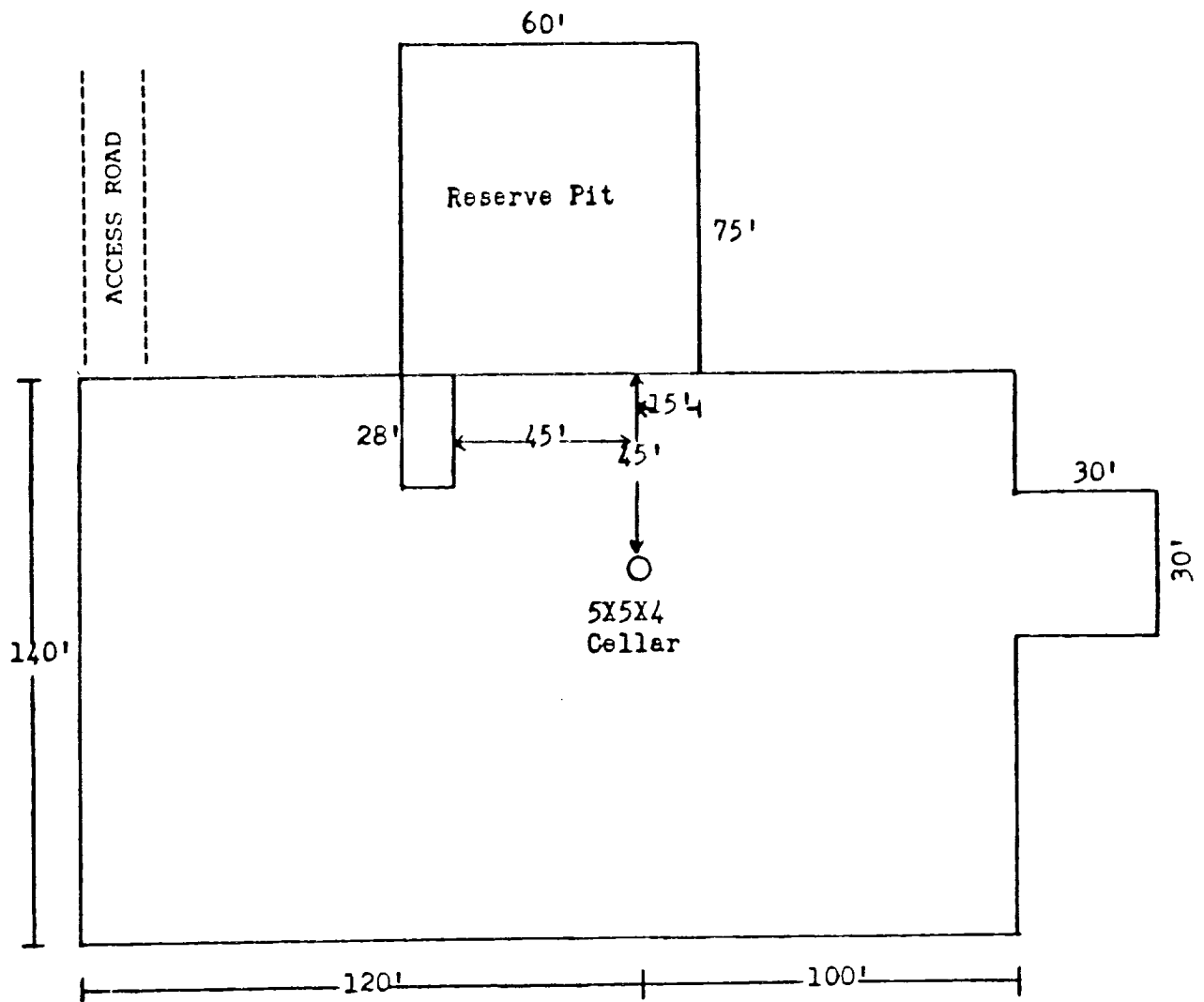

L&M Drilling Rig No. 1

Exhibit 'D'  
 Siete Oil & Gas Corporation  
 Osage Federal No. 6  
 990' FSL & 660' FWL  
 Sec. 35, T19S, R29E