

All distances must be from the outer boundaries of the Section.

Operator Hondo Oil & Gas Company		Lease H.E. West "B"		Well No. 44
Unit Letter N	Section 3	Township 17 South	Range 31 East	County Eddy
Actual Footage Location of Well: 720 feet from the South line and 1980 feet from the West line				
Ground Level Elev. 3935	Producing Formation Grayburg	Pool Grayburg Jackson	Dedicated Acreage: 40 Acres	

1. Outline the acreage dedicated to the subject well by colored pencil or hachure marks on the plat below.

2. If more than one lease is dedicated to the well, outline each and identify the ownership thereof (both as to working interest and royalty).

3. If more than one lease of different ownership is dedicated to the well, have the interests of all owners been consolidated by communitization, unitization, force-pooling, etc?

☐ Yes ☒ No If answer is "yes," type of consolidation _____

If answer is "no," list the owners and tract descriptions which have actually been consolidated. (Use reverse side of this form if necessary.) _____

No allowable will be assigned to the well until all interests have been consolidated (by communitization, unitization, forced-pooling, or otherwise) or until a non-standard unit, eliminating such interests, has been approved by the Division.

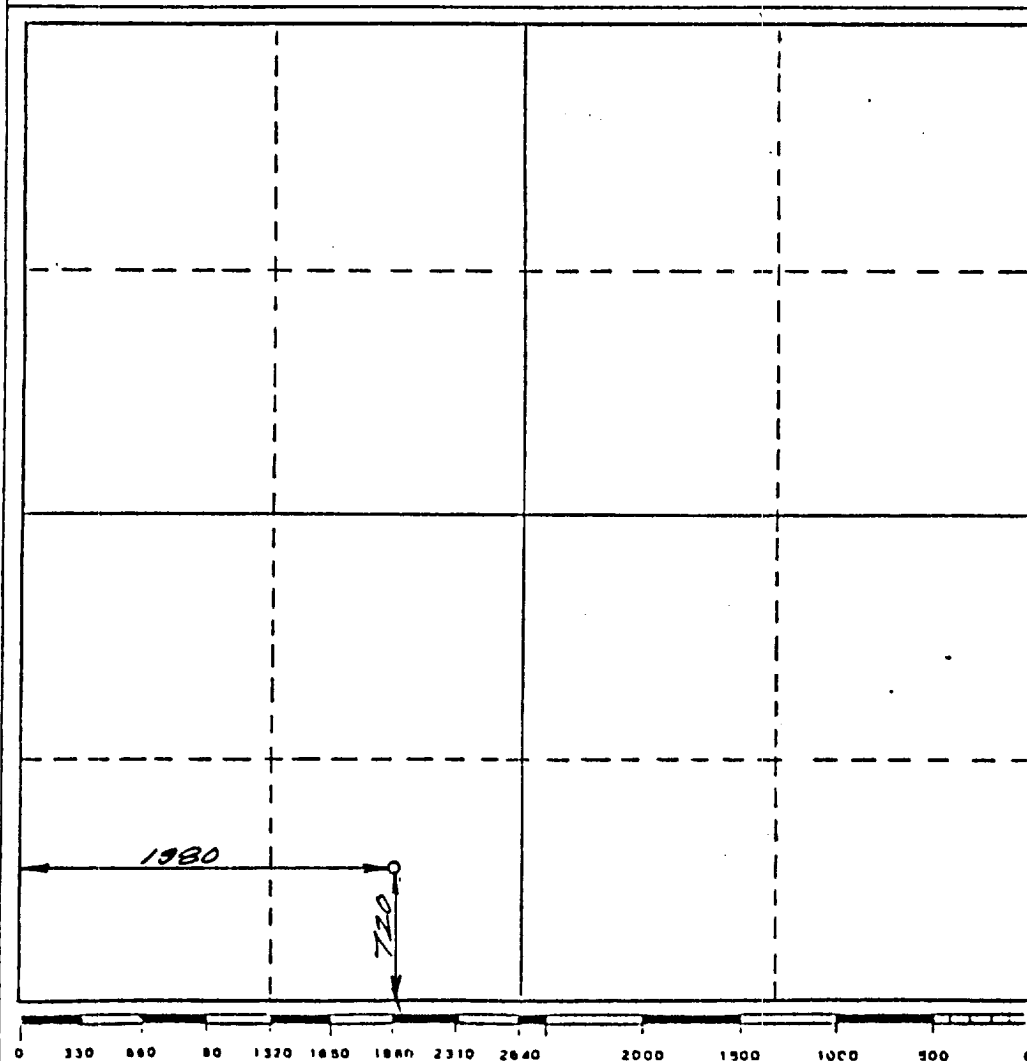

CERTIFICATION	
I hereby certify that the information contained herein is true and complete to the best of my knowledge and belief.	
Name	Ron Brown
Position	Engineer
Company	Hondo Oil & Gas Company
Date	4/27/89
I hereby certify that the well location shown on this plat was plotted from field notes of actual surveys made by me or under my supervision, and that the same is true and correct to the best of my knowledge and belief.	
Date Surveyed	22 September 1989
Registered Land Surveyor	P.R. Patton
8112	8112
Certificate No.	8112